

PLAN VIEW

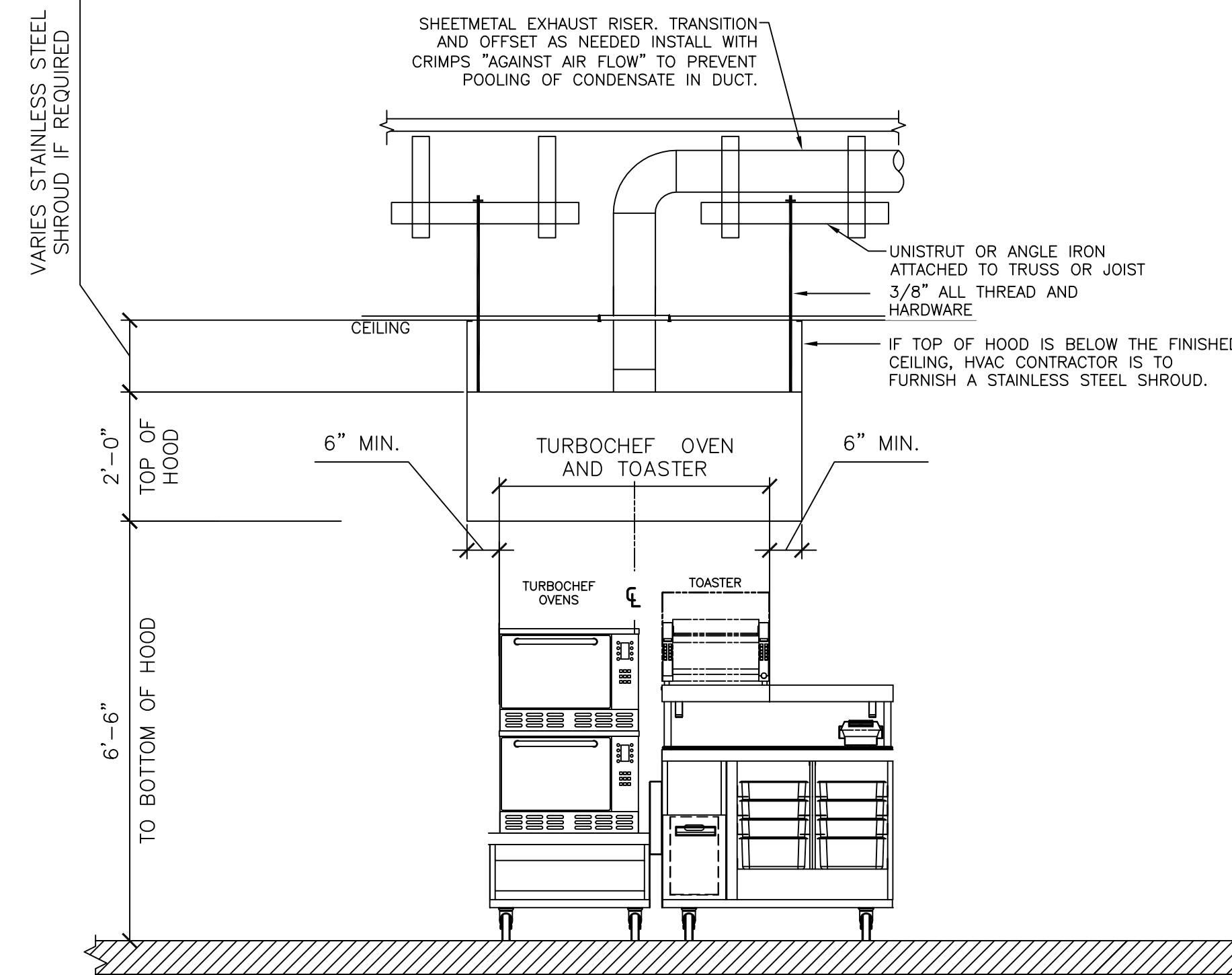

ELEVATION VIEW

DESIGN PROFESSIONAL TO DESIGN HOOD FOR EVERY LOCATION PER CRITERIA SHOWN

GENERAL NOTES:

- A. ALL ELECTRICAL "FIELD" CONNECTIONS AND RELATED INTERCONNECTIONS BY ELECTRICAL CONTRACTOR.
- B. ALL PLUMBING "FIELD" CONNECTIONS AND RELATED INTERCONNECTIONS BY PLUMBING CONTRACTOR.
- C. ALL ASSOCIATED HANGER MATERIALS BY INSTALLING CONTRACTOR.
- D. ANY LIGHTS SHOWN INSTALLED BY THE MANUFACTURER, AND FACTORY PREWIRED PER THE PLANS. INTERCONNECTIONS BETWEEN HOODS AND TO SWITCHES BY ELECTRICAL CONTRACTOR.
- E. SEISMIC RESTRAINTS ARE RESPONSIBILITY OF INSTALLING CONTRACTOR.
- F. INSTALLING CONTRACTOR ASSUMES ALL RELATED RESPONSIBILITY FOR VERIFICATION OF DIMENSIONAL DATA CONTAINED ON THESE DOCUMENTS FOR ACCURACY, INTEGRATION, AND ADMINISTRATION OF CODE REQUIREMENTS IN EFFECT PRIOR TO ANY RELEASE FOR PRODUCTION OF EQUIPMENT SHOWN.
- G. SIGNED AND "APPROVED" COPIES OF THIS DOCUMENT MUST BE RECEIVED BY THE FACTORY PRIOR TO COMMENCEMENT OF FABRICATION.
- H. NOMINAL HOOD DIMENSIONS AS SHOWN ON DRAWINGS.
- I. THE HOODS INDICATED SHALL BE CAPTIVE-AIRE MODEL VHB OR APPROVED EQUAL. THE HOOD SHALL BE SINGLE WALL TYPE HOOD WITH NO BUILT-IN MAKE-UP AIR CAPABILITIES. THE HOOD COMPONENTS SHALL BE FABRICATED OF TYPE 304 STAINLESS STEEL WITH A #3 OR #4 POLISH, ON ALL EXPOSED SURFACES. THE HOOD SHALL BE PROVIDED WITH HANGING ANGLES ON EACH END OF THE HOOD. NOMINAL HOOD DIMENSIONS SHALL BE AS SHOWN ON DRAWINGS.

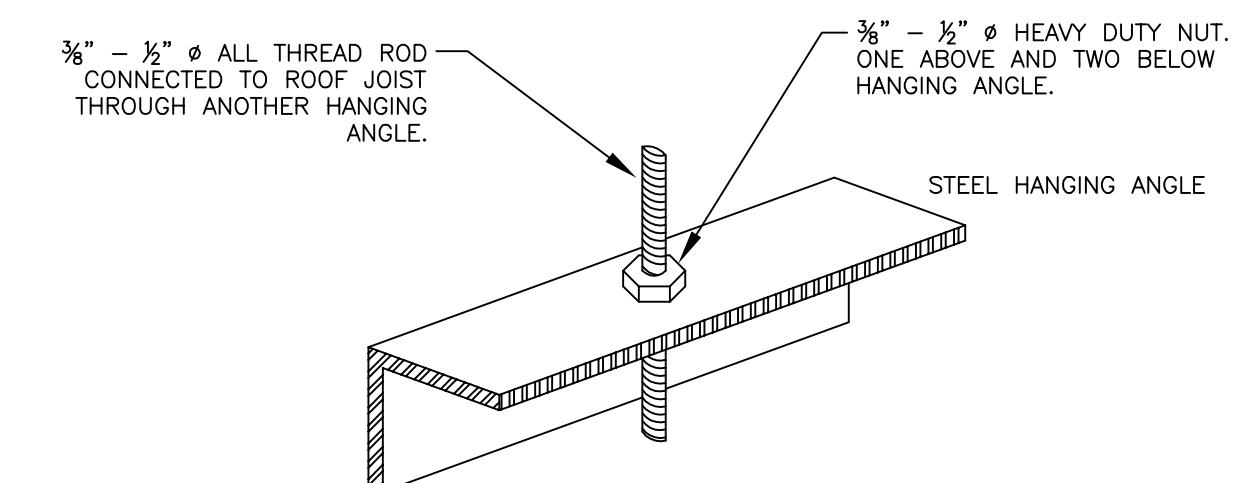

3 HANGING ANGLE DETAIL

1 NOT USED

2 HOOD ELEVATION AND PLAN

N.T.S. SANDWICH STATION HOOD

NONE

FAN SCHEDULE

FAN SCHEDULE													
UNIT ID	MANUFACTURER	MODEL	CFM	TYPE	DRIVE	FAN RPM	S.P. (IN. W.G.)	MOTOR HP	VOLTS	PHASE	SERVICE	INTERLOCKED WITH	NOTES / ACCESSORIES
EF-1					EXISTING						OVEN	EXISTING	EXISTING
EF-2	CAPTIVE-AIRE	DR30HFA	600	ROOF	DIRECT	1313	0.75	1/4	120	1	TOASTER AND TURBO	HOOD MOUNTED SWITCH	1-6
EF-3					EXISTING						RESTROOM	EXISTING	EXISTING
NOTES / ACCESSORIES:													
1. Aluminized Birdscreen													
2. Safety Disconnect Switch													
3. Gravity Backdraft Damper													
4. AMCA Seal & UL Certified													
5. Speed Control Switch Mounted To Fan Cabinet For Exact Balancing.													
6. Coordinate With Manufacturer For Final Selection													

HOOD SCHEDULE

HOODS									
UNIT ID	MANUFACTURER	MODEL	LENGTH	SERVICE	COOKING TEMPERATURE	EXHAUST AIR COLLAR	SP	CONSTRUCTION	WEIGHT
HOOD	CAPTIVE-AIRE	3624 VHB	7'-8"	TOASTER / TURBO	700 DEG F	600	10"	0.069	430 STAINLESS STEEL 232 LBS

HOODS SHALL BE BUILT IN COMPLIANCE WITH

NFPA #96
NSF
UL 710 & ULC710 STANDARDS
E.T.L. LISTED 3054804-001

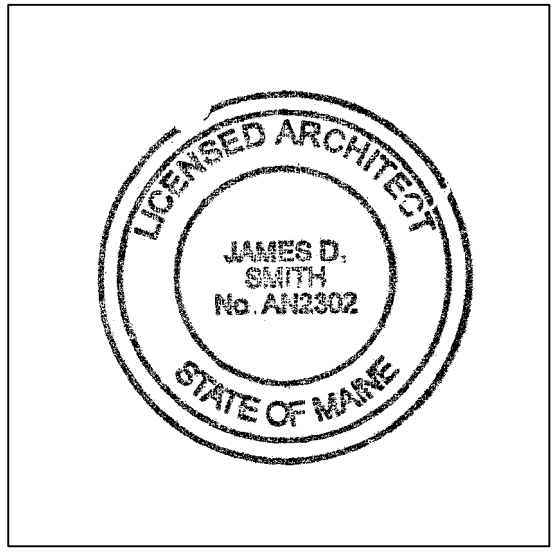

JAMES D. SMITH, ARCHITECT, AIA
35 LOTHROP'S LANE
WEST BARNSTABLE, MA 02668
PHONE: 508-367-8920
JAMESDSMITH1@COMCAST.NET

DATE	SCALE	NOTED	DRAWN	JOB #	C.M.
02-29-16			ARL	D15098	R. MAHONEY

STORE LOCATION: **PORTLAND, ME**
598 WARREN AVE.

MECHANICAL DETAILS

P.C. #: 339010
FRESH/BREW/IMAGE: "DARK/ROAST"

M-3