

City of Portland, Maine – Building or Use Permit Application 389 Congress Street, 04101, Tel: (207) 874-8703, FAX: 874-8716

Location of Construction: 633 Warren Ave		Owner: Pine Tree Paper Co		Phone: 774-7261	
Owner Address: 633 Warren Ave - Portland, ME		Leasee/Buyer's Name:		Phone:	
Contractor Name:		Address:		Phone:	
Past Use:		Proposed Use: commercial & temp sign		COST OF WORK: \$	
Proposed Project Description: erect temporary sign - 40x 4'x8' from 4/18/95 to 7/13/95		FIRE DEPT. <input type="checkbox"/> Approved <input type="checkbox"/> Denied		PERMIT FEE: \$	
		Signature:		INSPECTION: Use Group: Type: MOCA 9B Signature: [Signature]	
		PEDESTRIAN ACTIVITIES DISTRICT (P.A.D.)		Action: <input type="checkbox"/> Approved <input type="checkbox"/> Approved with Conditions <input type="checkbox"/> Denied	
Permit Taken By: L Chase		Date Applied For: 4/18/95			

Permit No. **950356**

PERMIT ISSUED

Permit Issued:
APR 19 1995

CITY OF PORTLAND

Zone: CBL: 314-A-005

Zoning Approval:

Special Zone or Reviews:

Shoreland
 Wetland
 Flood Zone
 Subdivision
 Site Plan maj minor mm

Zoning Appeal

Variance
 Miscellaneous
 Conditional Use
 Interpretation
 Approved
 Denied

1. This permit application doesn't preclude the Applicant(s) from meeting applicable State and Federal rules.
2. Building permits do not include plumbing, septic or electrical work.
3. Building permits are void if work is not started within six (6) months of the date of issuance. False information may invalidate a building permit and stop all work..

Historic Preservation

Not in District or Landmark
 Does Not Require Review
 Requires Review

CERTIFICATION

I hereby certify that I am the owner of record of the named property, or that the proposed work is authorized by the owner of record and that I have been authorized by the owner to make this application as his authorized agent and I agree to conform to all applicable laws of this jurisdiction. In addition, if a permit for work described in the application issued, I certify that the code official's authorized representative shall have the authority to enter all areas covered by such permit at any reasonable hour to enforce the provisions of the code(s) applicable to such permit

SIGNATURE OF APPLICANT: _____ ADDRESS: _____ DATE: _____ PHONE: _____

RESPONSIBLE PERSON IN CHARGE OF WORK, TITLE: _____ PHONE: _____

White-Permit Desk Green-Assessor's Canary-D.P.W. Pink-Public File Ivory Card-Inspector

Action:

Approved
 Approved with Conditions
 Denied

Date: 4/18/95

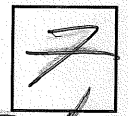
CEO DISTRICT 

Mr. Jordan

COMMENTS

4-20-95 sign is up for time of 4-18-95 to 7-18-95

3-B-96 - Request to remove temp portable signage

Inspection Record

Type	Date
Foundation: _____	_____
Framing: _____	_____
Plumbing: _____	_____
Final: _____	_____
Other: _____	_____



4' x 8' (approx)
advertises sale
products

DRIVEWAY

Parking

WALKWAY

RAMP

BUILDING

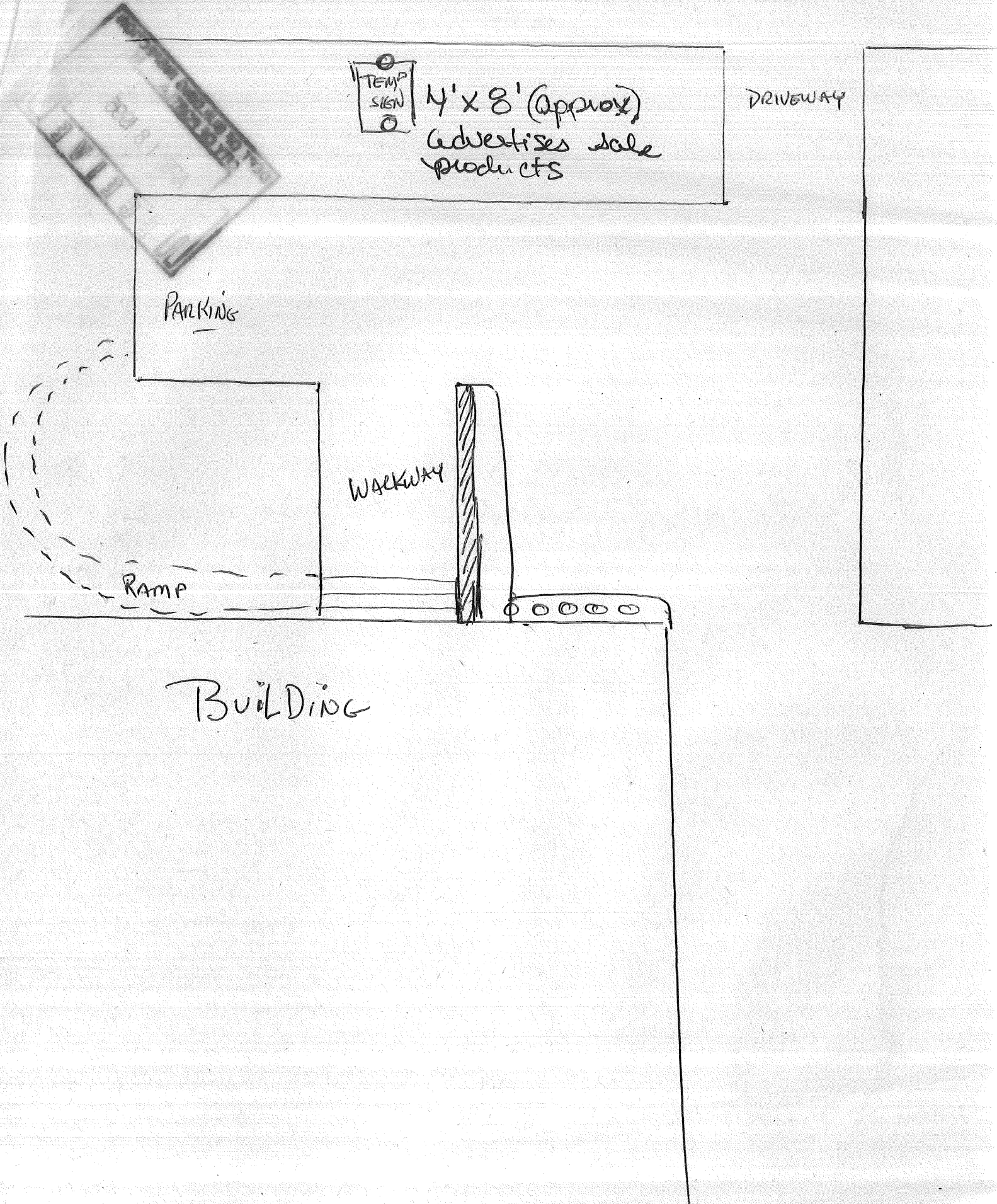

Inspection Services
P. Samuel Hoffses
Chief

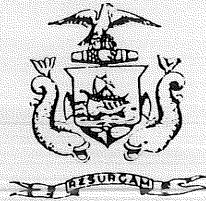

Planning and Urban Development
Joseph E. Gray Jr.
Director

CITY OF PORTLAND

March 1, 1996

Pine Tree Papers
533 Warren Avenue
Portland, Maine 04103

RE: 533 Warren Avenue
Temporary Signage

Dear Sir,

On April 19, 1995 a temporary sign permit was issued for the above referenced address. This property is located in an I-2 Zone and according to the City of Portland Municipal Codes, Section 14-369.5(a), Table 1, this permit should not have been issued as all temporary/portable signs are prohibited in an I-2 Zone.

Since this temporary sign permit expired on July 18, 1995 you are requested, at this time, to remove referenced signage. According to Marge Schmuckal, Zoning Administrator, the possibility does exist that, with some modifications, a permanent sign could be issued for this property. This would require a permit and approval from this office.

Should you have any questions regarding this matter, please do not hesitate to contact this office.

Sincerely,

David Jordan
Code Enforcement Officer
City of Portland

cc: M. Schmuckal, Zoning Admin