

DISPLAY THIS CARD ON PRINCIPAL FRONTAGE OF WORK CITY OF PORTLAND

BUILDING INSPECTION

PERMIT

Permit Number: 070166

Please Read Application And Notes, If Any, Attached

This is to certify that CP & S ASSOCIATES LLC Design Contractor

has permission to Install a 6x6 sf freestanding structure

AT 583 WARREN AVE

314 A004001

PERMIT ISSUED
APR - 9 2007
CITY OF PORTLAND

provided that the person or persons who perform or supervise the construction of this permit shall comply with all of the provisions of the Statutes of this State and of the Ordinances of the City of Portland regulating the construction, maintenance and use of buildings and structures, and of the application on file in this department.

Apply to Public Works for street line and grade if nature of work requires such information.

Notification of inspection must be given and when permission is procured before this building or part thereof is loaded or closed-in. 24 HOUR NOTICE IS REQUIRED.

A certificate of occupancy must be procured by owner before this building or part thereof is occupied.

OTHER REQUIRED APPROVALS

Fire Dept. _____
Health Dept. _____
Appeal Board _____
Other _____
Department Name

Thomas M. McElroy 3/5/07
Director - Building & Inspection Services

PENALTY FOR REMOVING THIS CARD

City of Portland, Maine - Building or Use Permit Application

389 Congress Street, 04101 Tel: (207) 874-8703, Fax: (207) 874-8716

Permit No: 07-0166	Issue Date:	CBL: 314 A004001
-----------------------	-------------	---------------------

Location of Construction: 583 WARREN AVE	Owner Name: CP & S ASSOCIATES LLC	Owner Address: 583 WARREN AVE	Phone:
Business Name:	Contractor Name: Sign Concepts	Contractor Address: 9 Storm Dr Windham	Phone: 2078996454
Lessee/Buyer's Name	Phone:	Permit Type: Signs - Permanent	Zone: B4

Past Use: Commerical / Car Wash	Proposed Use: Commercial / Car Wash install 96 ⁶⁵ sf freestanding sign	Permit Fee: \$222.00	Cost of Work: \$222.00	CEO District: 5
Proposed Project Description: Install a 96 ⁶⁵ sf freestanding sign		FIRE DEPT: <input type="checkbox"/> Approved <input type="checkbox"/> Denied	INSPECTION: Use Group: Commercial Type: SB IBC 2003	
		Signature:	Signature: <i>Jm 3/5/07</i>	
PEDESTRIAN ACTIVITIES DISTRICT (P.A.D.)				
Action: <input type="checkbox"/> Approved <input type="checkbox"/> Approved w/Conditions <input type="checkbox"/> Denied				
Signature: _____ Date: _____				

Permit Taken By: dmartin	Date Applied For: 02/12/2007	Zoning Approval		
-----------------------------	---------------------------------	------------------------	--	--

- This permit application does not preclude the Applicant(s) from meeting applicable State and Federal Rules.
- Building permits do not include plumbing, septic or electrical work.
- Building permits are void if work is not started within six (6) months of the date of issuance. False information may invalidate a building permit and stop all work..

Special Zone or Reviews	Zoning Appeal	Historic Preservation
<input type="checkbox"/> Shoreland	<input type="checkbox"/> Variance	<input checked="" type="checkbox"/> Not in District or Landmark
<input type="checkbox"/> Wetland	<input type="checkbox"/> Miscellaneous	<input type="checkbox"/> Does Not Require Review
<input type="checkbox"/> Flood Zone	<input type="checkbox"/> Conditional Use	<input type="checkbox"/> Requires Review
<input type="checkbox"/> Subdivision	<input type="checkbox"/> Interpretation	<input type="checkbox"/> Approved
<input type="checkbox"/> Site Plan	<input type="checkbox"/> Approved	<input type="checkbox"/> Approved w/Conditions
Maj <input type="checkbox"/> Minor <input type="checkbox"/> MM <input type="checkbox"/>	<input type="checkbox"/> Denied	<input type="checkbox"/> Denied
Date: <i>2/26/07</i> <i>APM</i>	Date: _____	Date: _____

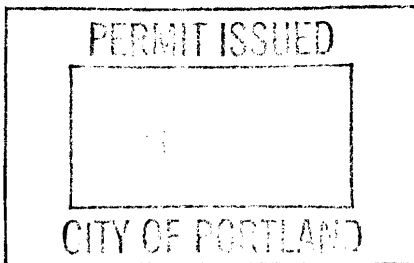

CERTIFICATION

I hereby certify that I am the owner of record of the named property, or that the proposed work is authorized by the owner of record and that I have been authorized by the owner to make this application as his authorized agent and I agree to conform to all applicable laws of this jurisdiction. In addition, if a permit for work described in the application is issued, I certify that the code official's authorized representative shall have the authority to enter all areas covered by such permit at any reasonable hour to enforce the provision of the code(s) applicable to such permit.

SIGNATURE OF APPLICANT	ADDRESS	DATE	PHONE
RESPONSIBLE PERSON IN CHARGE OF WORK, TITLE		DATE	PHONE

City of Portland, Maine - Building or Use Permit

389 Congress Street, 04101 Tel: (207) 874-8703, Fax: (207) 874-8716

Permit No: 07-0166	Date Applied For: 02/12/2007	CBL: 314 A004001
------------------------------	--	----------------------------

Location of Construction: 583 WARREN AVE	Owner Name: CP & S ASSOCIATES LLC	Owner Address: 583 WARREN AVE	Phone:
Business Name:	Contractor Name: Sign Concepts	Contractor Address: 9 Storm Dr Windham	Phone (207) 899-6454
Lessee/Buyer's Name	Phone:	Permit Type: Signs - Permanent	

Proposed Use: Commercial / Car Wash install 65 sf freestanding sign "Wash "N" Go Touchless Car Wash"	Proposed Project Description: Install a 65 sf freestanding sign
---	---

Dept: Zoning	Status: Approved	Reviewer: Ann Machado	Approval Date: 02/26/2007
Note:	Ok to Issue: <input checked="" type="checkbox"/>		
Dept: Building	Status: Approved with Conditions	Reviewer: Tom Markley	Approval Date: 03/05/2007
Note:	Ok to Issue: <input checked="" type="checkbox"/>		
1) Signage Installation to comply with Chapter 31 of the IBC 2003 building code. 2) Application approval based upon information provided by applicant. Any deviation from approved plans requires separate review and approval prior to work.			

Comments:
2/15/2007-amachado: Spoke to Andrew Earle at Sign Concepts. Section 14-369.5, Table 2.10 allows a 65 sf max. for a freestanding sign since the street frontage is 122'. The application is for a 96 sf sign. Andrew said that they would submit a revised sign that meets the ordinance.



Signage/Awning Permit Application

If you or the property owner owes real estate or personal property taxes or user charges on any property within the City, payment arrangements must be made before permits of any kind are accepted.

Location/Address of Construction: 583 Warren Ave.		
Tax Assessor's Chart# 314	Block# A	Lot# 004
Owner: Peter Bouchard		Telephone: 714-9500
Lessee/Buyer's Name (If Applicable) Peter Bouchard	Contractor name, address & telephone: Sign Concepts 75 Bishop Street Portland, ME 04103 207.699.2920	Total s.f. of signage x \$2.00 Per s.f. plus \$30.00/\$65.00 96 SF For I.I.D. signage= Total Fee: \$ _____ Awning Fee= cost of work N/A Total Fee: \$ _____
Who should we contact when the permit is ready: Andrew Earle phone: 699-2920		
Tenant/allocated building space frontage (feet): Length: ~50 Height: ~20 Lot Frontage (feet) ~150 (122') Single Tenant or Multi Tenant Lot single		
Current Specific use: car wash If vacant, what was prior use: _____ Proposed Use: _____		
Information on proposed sign(s): Freestanding (e.g., pole) sign? Yes <input checked="" type="checkbox"/> No _____ Dimensions proposed: 2/26/06 revised 9'7.5" x 6'9 1/8" Height from grade: 18'10" Bldg. wall sign? (attached to bldg) Yes _____ No <input checked="" type="checkbox"/> Dimensions proposed: 17'8" x 8'2"		
Proposed awning? Yes _____ No _____ Is awning backlit? Yes _____ No _____ Height of awning: _____ Length of awning: _____ Depth: _____ Is there any communication, message, trademark or symbol on it? Yes _____ No _____ If yes, total s.f. of panels w/communications, message, trademark or symbol: _____ s.f.		
Information on existing and previously permitted sign(s): Freestanding (e.g., pole) sign? Yes _____ No _____ Dimensions: N/A Bldg. wall sign? (attached to bldg) Yes _____ No _____ Dimensions: N/A Awning? Yes _____ No _____ Sq. ft. area of awning w/communication: N/A		
A site sketch and building sketch showing exactly where existing and new signage is located must be provided. Sketches and/or pictures of proposed signage and existing building are also required.		

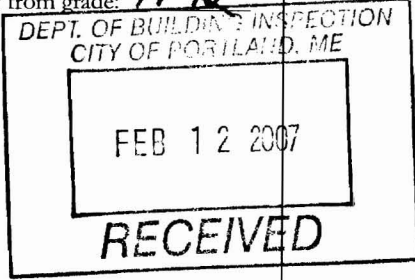

Please submit all of the information outlined in the Sign/Awning Application Checklist. Failure to do so may result in the automatic denial of your permit.

In order to be sure the City fully understands the full scope of the project, the Planning and Development Department may request additional information prior to the issuance of a permit. For further information visit us on-line at www.portlandmaine.gov, stop by the Building Inspections office, room 315 City Hall or call 874-8703.

I hereby certify that I am the Owner of record of the named property, or that the owner of record authorizes the proposed work and that I have been authorized by the owner to make this application as his/her authorized agent. I agree to conform to all applicable laws of this jurisdiction. In addition, if a permit for work described in this application is issued, I certify that the Code Official's authorized representative shall have the authority to enter all areas covered by this permit at any reasonable hour to enforce the provisions of the codes applicable to this permit.

Signature of applicant: Date: **2/7/07**

This is not a permit; you may not commence ANY work until the permit is issued.

frontage < 200'
65ft max
25ft max ht.
5' setback.

45.77' revised 65' OK
17'8" 18'10"
5' shown

81.13



SIGN Concepts
SIGNAL COMMUNICATIONS & SERVICE

Date: 2/2/07	Scale: 3/8" = 1'
Drawing #: 1	Sales Rep: AE
Rev #: xx	Rev Date: 00/00/06

Appr'd by:

Wash N Go Car Wash

Y/D/F internally illuminated
 freestanding pylon sign
 Y radiused corner aluminum sign
 cabinet w/ lexan faces
 Y digitally printed graphics on
 translucent white vinyl film
 Y .063 aluminum pole w/ cap
 Y cabinet & pole w/ cap painted red w/
 navy blue oval

This design is the exclusive property of Sign
 Concepts, LLC, and cannot be copied,
 exhibited or shown to anyone outside of your
 organization without the prior consent of Sign
 Concepts, LLC. Copyright © 2006

revised - ^{proposed} size of sign

9370.52 \$ = 65¢

DEPT. OF BUILDING INSPECTION
 CITY OF PORTLAND, ME

FEB 26 2007

RECEIVED

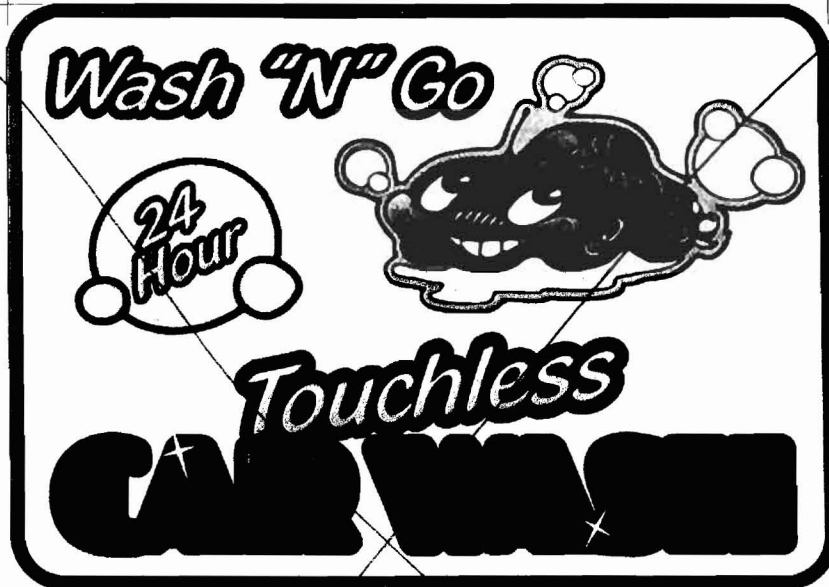

11'-7 3/8" 1'40"

8'-2"

9'-1"

19'-10"

3'-2"

6" x 40" reveal

11'-8"

8'-0"



4'-0"

Approval
Indicates
permission
from
owner

13720 ill = 95.27%

original

not doing
this sign

SIGNConcepts
VISUAL COMMUNICATION EXPERTS

Date: 2/2/07	Scale: 3/8" = 1'
Drawing #: 1	Sales Rep: AE
Rev #: xx	Rev Date: 00/00/06
Apprv'd by:	

Wash N Go Car Wash

- D/F internally illuminated freestanding pylon sign
 - radiused corner aluminum sign cabinet w/ lexan faces
 - digitally printed graphics on translucent white vinyl film
- .063 aluminum pole wrap
- cabinet & pole wrap painted red w/ navy blue reveal

This design is the exclusive property of **Sign Concepts, LLC**, and cannot be copied, exhibited, or shown to anyone outside of your organization without the prior consent of **Sign Concepts, LLC**. Copyright © 2006

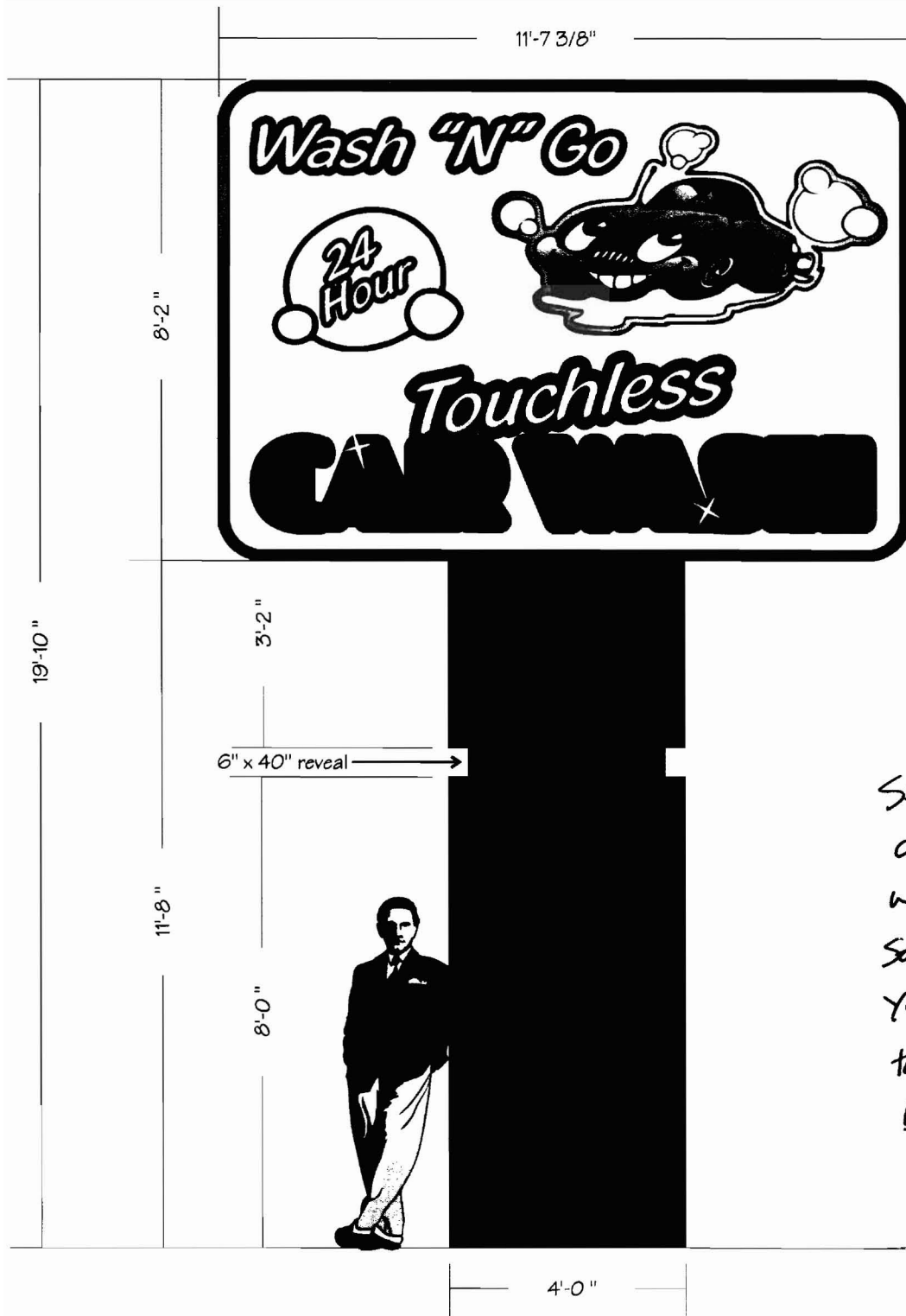

See new size submitted 2/26/07.

Steel pole within aluminum pole wrap to be set in 4 cubic yards of concrete that is ~4' below grade.



Date: 2/2/07	Scale: 3/8" = 1'
Drawing #: 1	Sales Rep: AE
Rev #: xx	Rev Date: 00/00/06
Apprv'd by:	

Wash N Go Car Wash

- D/F internally illuminated freestanding pylon sign
- radiused corner aluminum sign cabinet w/ lexan faces
- digitally printed graphics on translucent white vinyl film
- .063 aluminum pole wrap cabinet & pole wrap painted red w/ navy blue reveal

This design is the exclusive property of Sign Concepts, LLC, and cannot be copied, exhibited, or shown to anyone outside of your organization without the prior consent of Sign Concepts, LLC. Copyright © 2006

ACORD™ CERTIFICATE OF LIABILITY INSURANCE		DATE (MM/DD/YYYY) 02/11/2007
PRODUCER C P Curtis Insurance Agency P.O. Box 129 18 Main Street Bowdoinham ME 04008	THIS CERTIFICATE IS ISSUED AS A MATTER OF INFORMATION ONLY AND CONFERS NO RIGHTS UPON THE CERTIFICATE HOLDER. THIS CERTIFICATE DOES NOT AMEND, EXTEND OR ALTER THE COVERAGE AFFORDED BY THE POLICIES BELOW.	
INSURED Sign Concepts LLC 75 Bishop Street Windham, ME 04062	INSURERS AFFORDING COVERAGE INSURER A: Hanover Insurance INSURER B: INSURER C: INSURER D: INSURER E:	NAIC #

COVERAGES

THE POLICIES OF INSURANCE LISTED BELOW HAVE BEEN ISSUED TO THE INSURED NAMED ABOVE FOR THE POLICY PERIOD INDICATED. NOTWITHSTANDING ANY REQUIREMENT, TERM OR CONDITION OF ANY CONTRACT OR OTHER DOCUMENT WITH RESPECT TO WHICH THIS CERTIFICATE MAY BE ISSUED OR MAY PERTAIN, THE INSURANCE AFFORDED BY THE POLICIES DESCRIBED HEREIN IS SUBJECT TO ALL THE TERMS, EXCLUSIONS AND CONDITIONS OF SUCH POLICIES. AGGREGATE LIMITS SHOWN MAY HAVE BEEN REDUCED BY PAID CLAIMS.

INSR ADD'L	TYPE OF INSURANCE	POLICY NUMBER	POLICY EFFECTIVE DATE (MM/DD/YY)	POLICY EXPIRATION DATE (MM/DD/YY)	LIMITS
A	<input checked="" type="checkbox"/> GENERAL LIABILITY <input checked="" type="checkbox"/> COMMERCIAL GENERAL LIABILITY <input type="checkbox"/> CLAIMS MADE <input checked="" type="checkbox"/> OCCUR	ZDP8184278 00	11/12/2006	11/12/2007	EACH OCCURRENCE \$ 1,000,000
					DAMAGE TO RENTED PREMISES (EA OCCURRENCE) \$ 100,000
					MED EXP (Any one person) \$ 5,000
					PERSONAL & ADV INJURY \$ 1,000,000
					GENERAL AGGREGATE \$ 2,000,000
					PRODUCTS - COM/OP AGG \$ 2,000,000
	GEN'L AGGREGATE LIMIT APPLIES PER: <input checked="" type="checkbox"/> POLICY <input type="checkbox"/> PRO-JECT <input type="checkbox"/> LOC				
	AUTOMOBILE LIABILITY <input type="checkbox"/> ANY AUTO <input type="checkbox"/> ALL OWNED AUTOS <input type="checkbox"/> SCHEDULED AUTOS <input type="checkbox"/> HIREG AUTOS <input type="checkbox"/> NON-OWNED AUTOS				COMBINED SINGLE LIMIT (EA ACCIDENT) \$ BODILY INJURY (Per person) \$ BODILY INJURY (Per accident) \$ PROPERTY DAMAGE (Per accident) \$
	GARAGE LIABILITY <input type="checkbox"/> ANY AUTO				AUTO ONLY - EA ACCIDENT \$ OTHER THAN AUTO ONLY: EA ACC \$ AGG \$
	EXCESS/UMBRELLA LIABILITY <input type="checkbox"/> OCCUR <input type="checkbox"/> CLAIMS MADE DEDUCTIBLE RETENTION \$				EACH OCCURRENCE \$ AGGREGATE \$ \$ \$
	WORKERS COMPENSATION AND EMPLOYERS' LIABILITY ANY PROPRIETOR/PARTNER/EXECUTIVE OFFICER/MEMBER EXCLUDED? If yes, describe under SPECIAL PROVISIONS below				WC STATUTORY LIMITS OTHER E.L. EACH ACCIDENT \$ E.L. DISEASE - EA EMPLOYEE \$ E.L. DISEASE - POLICY LIMIT \$
	OTHER				

DESCRIPTION OF OPERATIONS / LOCATIONS / VEHICLES / EXCLUSIONS ADDED BY ENDORSEMENT / SPECIAL PROVISIONS

Sign Installation

City of Portland is being added as Additional Insured

CERTIFICATE HOLDER City of Portland 389 Congress Street Portland, ME 04101	CANCELLATION SHOULD ANY OF THE ABOVE DESCRIBED POLICIES BE CANCELLED BEFORE THE EXPIRATION DATE THEREOF, THE ISSUING INSURER WILL ENDEAVOR TO MAIL <u>10</u> DAYS WRITTEN NOTICE TO THE CERTIFICATE HOLDER NAMED TO THE LEFT, BUT FAILURE TO DO SO SHALL IMPOSE NO OBLIGATION OR LIABILITY OF ANY KIND UPON THE INSURER, ITS AGENTS OR REPRESENTATIVES. AUTHORIZED REPRESENTATIVE <i>Robert J. Small</i> <BS>
--	---

IMPORTANT

If the certificate holder is an ADDITIONAL INSURED, the policy(ies) must be endorsed. A statement on this certificate does not confer rights to the certificate holder in lieu of such endorsement(s).

If SUBROGATION IS WAIVED, subject to the terms and conditions of the policy, certain policies may require an endorsement. A statement on this certificate does not confer rights to the certificate holder in lieu of such endorsement(s).

DISCLAIMER

The Certificate of Insurance on the reverse side of this form does not constitute a contract between the issuing insurer(s), authorized representative or producer, and the certificate holder, nor does it affirmatively or negatively amend, extend or alter the coverage afforded by the policies listed thereon.

North's ←

Pioneer Telephone ↑

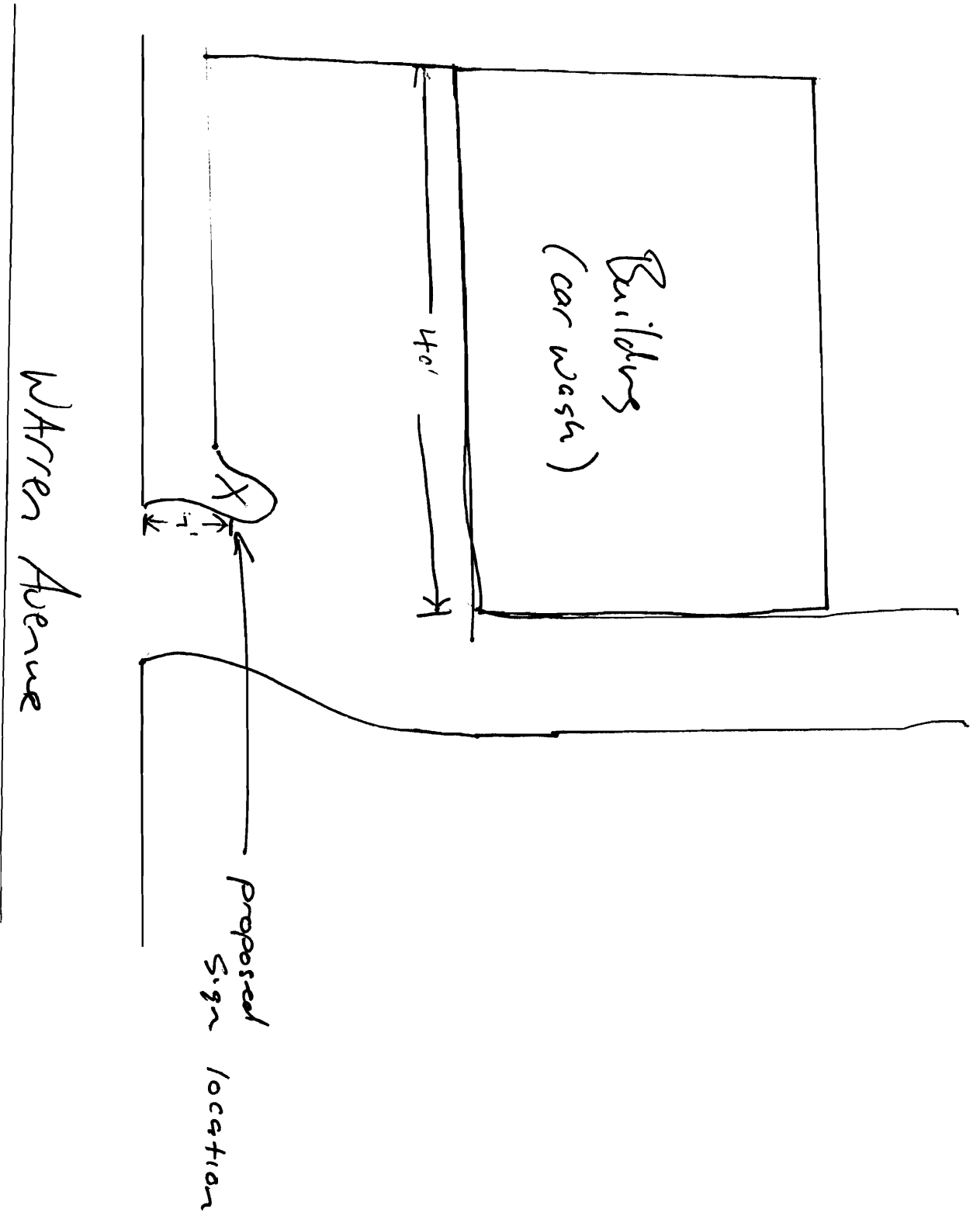



Signage/Awning Permit Application Checklist

All of the following information is required and must be submitted. Checking off each item as you prepare your application package will ensure your package is complete and will help to expedite the permitting process.

- N/A* Certificate of Liability listing the City as additional insured if any portion of the sign abuts or encroaches on any public right of way, or can fall into any public right of way.
- Letter of permission from the owner indicating the permissions granted and the tenant/space building frontage. *owner of property is owner of sign. SEE installed drawing from owner.*
- A sketch plan of lot indicating location of buildings, driveways and any abutting streets or rights of way, lengths of building frontages, street frontages and all existing setbacks. Please indicate on the plan all existing and proposed signs with their dimensions and specific locations. Be sure to include distance from the ground and building façade dimensions for any signage attached to the building.
- A sketch or photo of any proposed sign(s) indicating content, dimensions, materials, source of illumination, construction method as well as specifics of installation/attachment.
- N/A* Certificate of flammability required for awning or canopy.
- A UL# is required for lighted signs at the time of final inspection.
- Pre-application questionnaire completed and attached.
- N/A* Photos of existing signage
- Details for sign fastening, attachment or mounting in the ground.

Permit fee for signage or awning-with-signage: \$30.00 plus \$2.00 per square foot of sign.

Permit fee for awning-without-signage is based on cost of work:
\$30.00 for the first \$1,000.00, \$9.00 per additional \$1,000.00 of cost.

Base application fee for any Historic District signage is \$65.00.