

CODE REQUIREMENTS

ARTICLE 1 - ADMINISTRATION BY ENFORCEMENT

ARCHITECTURAL SERVICES SHALL BE IN ACCORDANCE WITH ARTICLE 1, SECTION 1.6 CONSTRUCTION CONTROLS OF THE BOCA NATIONAL BUILDING CODE 1999 EDITION.

ARTICLE 3 - USE GROUP CLASSIFICATION

USE GROUP S-1 STORAGE MODERATE HAZZARD - WAREHOUSE.

ARTICLE 5 - GENERAL BUILDING LIMITATIONS

AREAS	EXISTING	NEW
OFFICE & WAREHOUSE	29,288 SQ.FT.	645 SQ.FT.
STORAGE CANOPY	3,200 SQ.FT.	19,573 SQ.FT.
MEZZANINE	1,352 SQ.FT.	3,448 SQ.FT.
TOTAL	33,840 SQ.FT.	23,666 SQ.FT.

TABLE 503 AREA & HEIGHT LIMITATIONS

USE GROUP S-1
CONSTRUCTION TYPE 3B COMBUSTIBLE/ NON-COMBUSTIBLE
2 STORIES 30'-0"
8,400 SQ. FT.

SECTION 507, UNLIMITED AREA

AUTOMATIC SPRINKLER SYSTEM, AREA INCREASE IS UNLIMITED FOR ONE STORY AND LESS THAN 85 FEET IN HEIGHT.

ARTICLE 6 - TYPES OF CONSTRUCTION

TYPE 3B COMBUSTIBLE/ NON-COMBUSTIBLE, UNPROTECTED.
FIRE SEPARATIONS CORRIDORS 1 HOUR RATING
STRUCTURAL ELEMENTS. 0 HOUR RATING

ARTICLE 10 - MEANS OF EGRESS

OCCUPANCY LOADS PER TABLE 1008.1.2.
ALLOWABLE 1 PERSON PER 300 GROSS S.F.

SPACE	OCCUPANTS
OFFICE AREA	20
WAREHOUSE	10
TOTAL	30

SECTION 1006 - LENGTH OF TRAVEL

PERMITTED 250 FEET WITH SPRINKLER SYSTEM
MAXIMUM-ACTUAL 160 FEET

SECTION 1009 - CAPACITY OF EXITS WITH SPRINKLER SYSTEM

DOORS REQUIRED 0.15 INCHES PER PERSON
DOOR WIDTHS 3 @ 36" = 108 INCHES

ACTUAL DOOR WIDTHS 30 x 0.15 = 4.5 INCHES

CODE REFERENCES

- 1 - THE BOCA NATIONAL BUILDING CODE 1999 EDITION
- 2 - ADAAG GUIDELINES FOR BUILDINGS AND FACILITIES.

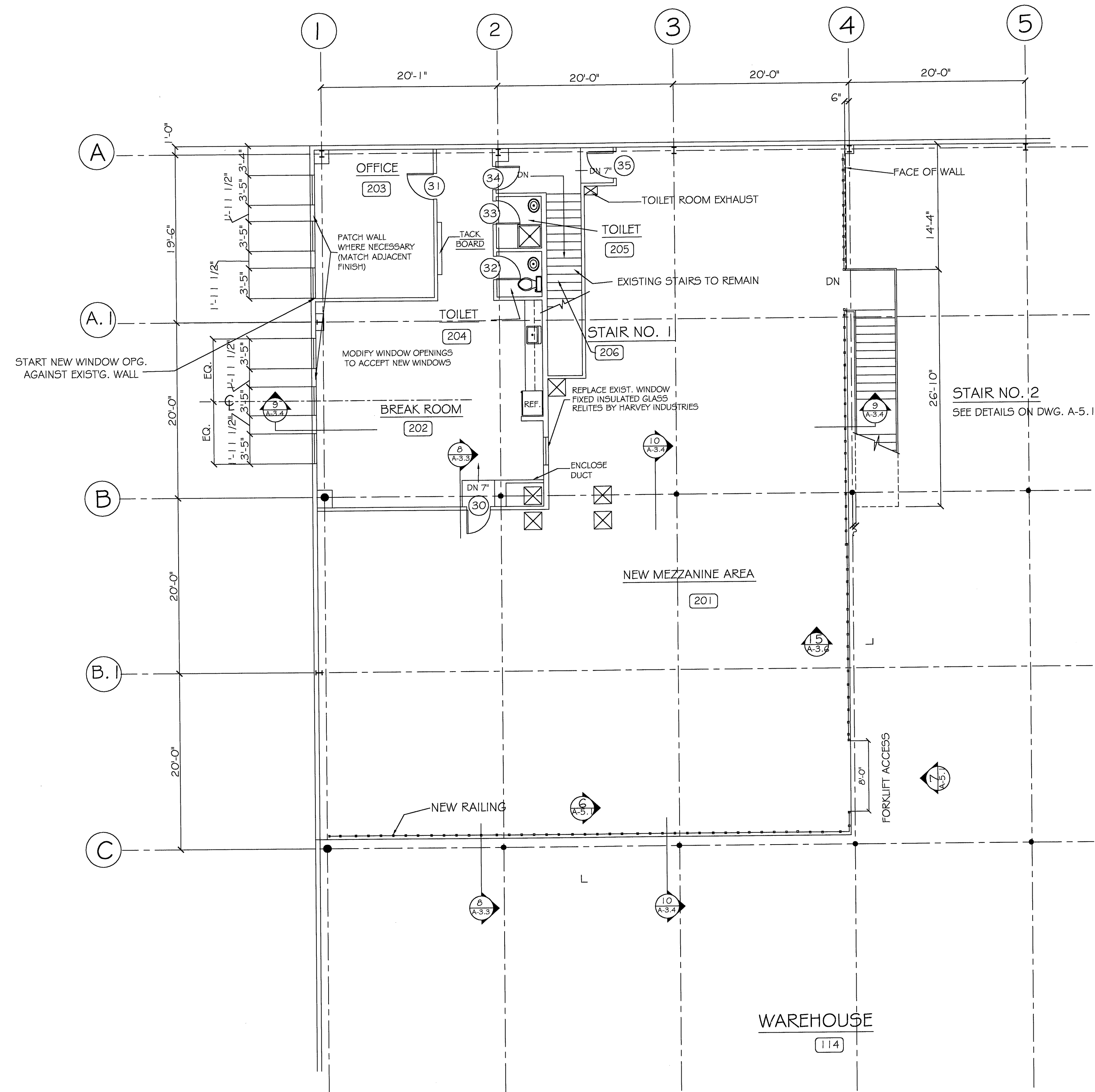

ENLARGED MEZZANINE PLAN

SCALE: 1/8" = 1'-0"

KEY:	
EXISTING:	—————
TO BE REMOVED:	- - - - -
NEW CONSTRUCTION:	///////

NOTE:
ALL WOOD SHAL BE FIRE RETARDANT

SUDBURY, MA

DION & SOKOL, INC. • ARCHITECTS

ENLARGED MEZZANINE FLOOR PLANS

WAREHOUSE FACILITY
401 RIVERSIDE ST. PORTLAND, ME



project no.	01-20
drawn	JMH
checked	RD
dated	01-21-06

A-1.4