

DISPLAY THIS CARD ON PRINCIPAL FRONTAGE OF WORK

CITY OF PORTLAND

BUILDING INSPECTION

PERMIT

Permit Number: 100249

Please Read Application And Notes, If Any, Attached

This is to certify that Roper Benjamin G/Sign Design Inc

has permission to Erect freestanding 5' x 5' sign.

AT 577 Riverside St CBL 312 B006001

provided that the person or persons, firm or corporation accepting this permit shall comply with all of the provisions of the Statutes of Maine and of the Ordinances of the City of Portland regulating the construction, maintenance and use of buildings and structures, and of the application on file in this department.

Apply to Public Works for street line and grade if nature of work requires such information.

Notification of inspection must be given and written permission procured before this building or part thereof is lathed or otherwise closed-in. 24 HOUR NOTICE IS REQUIRED.

A certificate of occupancy must be procured by owner before this building or part thereof is occupied.

PERMIT ISSUED

OTHER REQUIRED APPROVALS

Fire Dept. APR - 1 2010

Health Dept. _____

Appeal Board _____

Other _____

CITY OF PORTLAND

Department Name

[Handwritten Signature]
Director - Building & Inspection Services

PENALTY FOR REMOVING THIS CARD

City of Portland, Maine - Building or Use Permit Application

389 Congress Street, 04101 Tel: (207) 874-8703, Fax: (207) 874-8716

Permit No: 10-0249	Issue Date:	CBL: 312 B006001
-----------------------	-------------	---------------------

Location of Construction: 577 Riverside St	Owner Name: Roper Benjamin G	Owner Address: 117 Florida Ave	Phone: 207-2529470
Business Name: Superior Roofing Co.	Contractor Name: Sign Design Inc	Contractor Address: PO Box 207 Westbrook	Phone: 2078562600
Lessee/Buyer's Name	Phone:	Permit Type: Signs - Side Walk	Zone: IM

Past Use: Single Family / Office (Superior Roofing)	Proposed Use: Single Family / Office; Erect freestanding 5' x 5' sign.	Permit Fee: \$80.00	Cost of Work: \$30.00	CEO District: 5
		FIRE DEPT: <input type="checkbox"/> Approved <input type="checkbox"/> Denied <i>N/A</i>	INSPECTION: Use Group: <i>U</i> Type: <i>Sign</i> <i>IBC 2003</i>	

Proposed Project Description: Erect freestanding 5' x 5' sign. - "Superior Roofing"	Signature: <i>[Signature]</i>	Signature: <i>[Signature]</i>
PEDESTRIAN ACTIVITIES DISTRICT (P.A.D.)		
Action: <input type="checkbox"/> Approved <input type="checkbox"/> Approved w/Conditions <input type="checkbox"/> Denied		
Signature:	Date:	

Permit Taken By: gg	Date Applied For: 03/15/2010	Zoning Approval	
------------------------	---------------------------------	------------------------	--

- This permit application does not preclude the Applicant(s) from meeting applicable State and Federal Rules.
- Building permits do not include plumbing, septic or electrical work.
- Building permits are void if work is not started within six (6) months of the date of issuance. False information may invalidate a building permit and stop all work..

Special Zone or Reviews	Zoning Appeal	Historic Preservation
<input type="checkbox"/> Shoreland	<input type="checkbox"/> Variance	<input checked="" type="checkbox"/> Not in District or Landmark
<input type="checkbox"/> Wetland	<input type="checkbox"/> Miscellaneous	<input type="checkbox"/> Does Not Require Review
<input type="checkbox"/> Flood Zone	<input type="checkbox"/> Conditional Use	<input type="checkbox"/> Requires Review
<input type="checkbox"/> Subdivision	<input type="checkbox"/> Interpretation	<input type="checkbox"/> Approved
<input type="checkbox"/> Site Plan	<input type="checkbox"/> Approved	<input type="checkbox"/> Approved w/Conditions
Maj <input type="checkbox"/> Minor <input type="checkbox"/> MM <input type="checkbox"/>	<input type="checkbox"/> Denied	<input type="checkbox"/> Denied
OK Date: 3/16/10 <i>ABN</i>	Date:	Date: <i>ABN</i>



CERTIFICATION

I hereby certify that I am the owner of record of the named property, or that the proposed work is authorized by the owner of record and that I have been authorized by the owner to make this application as his authorized agent and I agree to conform to all applicable laws of this jurisdiction. In addition, if a permit for work described in the application is issued, I certify that the code official's authorized representative shall have the authority to enter all areas covered by such permit at any reasonable hour to enforce the provision of the code(s) applicable to such permit.

SIGNATURE OF APPLICANT	ADDRESS	DATE	PHONE
RESPONSIBLE PERSON IN CHARGE OF WORK, TITLE		DATE	PHONE

City of Portland, Maine - Building or Use Permit

389 Congress Street, 04101 Tel: (207) 874-8703, Fax: (207) 874-8716

Permit No: 10-0249	Date Applied For: 03/15/2010	CBL: 312 B006001
-----------------------	---------------------------------	---------------------

Location of Construction: 577 Riverside St	Owner Name: Roper Benjamin G	Owner Address: 117 Florida Ave	Phone: 207-2529470
Business Name: Superior Roofing Co.	Contractor Name: Sign Design Inc	Contractor Address: PO Box 207 Westbrook	Phone: (207) 856-2600
Lessee/Buyer's Name	Phone:	Permit Type: Signs - Side Walk	

Proposed Use: Single Family / Office; Erect freestanding 5' x 5' sign.	Proposed Project Description: Erect freestanding 5' x 5' sign. - "Superior Roofing"
---	--

Dept: Zoning	Status: Approved	Reviewer: Ann Machado	Approval Date: 03/16/2010
Note: Change of use for office - permit #09-0682.			Ok to Issue: <input checked="" type="checkbox"/>
Dept: Building	Status: Approved with Conditions	Reviewer: Tammy Munson	Approval Date: 03/17/2010
Note: 1) Signage Installation to comply with Chapters 31 & 32 of the IBC 2003 building code.			Ok to Issue: <input checked="" type="checkbox"/>

BUILDING PERMIT INSPECTION PROCEDURES

Please call 874-8703 or 874-8693 (ONLY)

to schedule your inspections as agreed upon

Permits expire in 6 months, if the project is not started or ceases for 6 months.

The Owner or their designee is required to notify the inspections office for the following inspections and provide adequate notice. Notice must be called in 48-72 hours in advance in order to schedule an inspection:

By initializing at each inspection time, you are agreeing that you understand the inspection procedure and additional fees from a "Stop Work Order" and "Stop Work Order Release" will be incurred if the procedure is not followed as stated below.

A Pre-construction Meeting will take place upon receipt of your building permit.

Footing/Building Location Inspection: Prior to pouring concrete or setting precast piers

Final inspection required at completion of work.

Certificate of Occupancy is not required for certain projects. Your inspector can advise you if your project requires a Certificate of Occupancy. All projects DO require a final inspection.

If any of the inspections do not occur, the project cannot go on to the next phase, REGARDLESS OF THE NOTICE OR CIRCUMSTANCES.

CERIFICATE OF OCCUPANICES MUST BE ISSUED AND PAID FOR, BEFORE THE SPACE MAY BE OCCUPIED.

Signature of Applicant/Designee

Date

Signature of Inspections Official

Date



10 0 249 Signage/Awning Permit Application

If you or the property owner owes real estate or personal property taxes or user charges on any property within the City, payment arrangements must be made before permits of any kind are accepted.

Location/Address of Construction: <u>577 Riverside St Portland, ME 04103</u>		
Tax Assessor's Chart, Block & Lot Chart# Block# Lot# <u>312 B 006</u>	Owner: <u>Ben Roper</u>	Telephone: <u>cell (207) 252-9470</u>
Lessee/Buyer's Name (If Applicable)	Contractor name, address & telephone: <u>Sign Design, Inc. P.O. Box 207 Westbrook, ME 04098 856-2600</u>	Total s.f. of signage \times \$2.00 <u>50</u> Per s.f. plus \$30.00/\$65.00 <u>30</u> For H.D. signage= Total <u>80</u> Fee: \$ _____ Awning Fee= cost of work _____ Total Fee: \$ _____
Who should we contact when the permit is ready: <u>Roger/Diana</u> phone: <u>856-2600</u> <u>25 + 30 = 50</u>		
Tenant/allocated building space frontage (feet): Length: <u>27'</u> Height: <u>22' PEAK.</u> <u>+ 30</u>		
Lot Frontage (feet) <u>61'</u> Single Tenant or Multi Tenant Lot <u>1 Business only</u> <u>\$80.00</u>		
Current Specific use: <u>OFFICE / Storage</u>		
If vacant, what was prior use: _____		
Proposed Use: <u>OFFICE</u> <u>- 25' SQ FT</u>		
Information on proposed sign(s):		
Freestanding (e.g., pole) sign? Yes <input checked="" type="checkbox"/> No _____ Dimensions proposed: <u>5'x5'</u> Height from grade: <u>13'</u>		
Bldg. wall sign? (attached to bldg) Yes _____ No _____ Dimensions proposed: _____		
Proposed awning? Yes _____ No <input checked="" type="checkbox"/> Is awning backlit? Yes _____ No _____		
Height of awning: _____ Length of awning: _____ Depth: _____		
Is there any communication, message, trademark or symbol on it? Yes _____ No _____		
If yes, total s.f. of panels w/communications, message, trademark or symbol: _____ s.f.		
Information on existing and previously permitted sign(s):		
Freestanding (e.g., pole) sign? Yes <input checked="" type="checkbox"/> No <input checked="" type="checkbox"/> Dimensions: <u>3'x3' 3'x3'</u> Post/Panel sign <u>4' Grade</u> <u>Going to take Down !!</u>		
Bldg. wall sign? (attached to bldg) Yes _____ No <input checked="" type="checkbox"/> Dimensions: _____		
Awning? Yes _____ No _____ Sq. ft. area of awning w/communication: _____		
A site sketch and building sketch showing exactly where existing and new signage is located must be provided. Sketches and/or pictures of proposed signage and existing building are also required.		

RECEIVED

MAR 15 2010

Dept. of Building Inspections
City of Portland Maine

Please submit all of the information outlined in the Sign/Awning Application Checklist. Failure to do so may result in the automatic denial of your permit.

In order to be sure the City fully understands the full scope of the project, the Planning and Development Department may request additional information prior to the issuance of a permit. For further information visit us on-line at www.portlandmaine.org stop by the Building Inspections office, room 315 City Hall or call 874-8703.

I hereby certify that I am the Owner of record of the named property, or that the owner of record authorizes the proposed work and that I have been authorized by the owner to make this application as his/her authorized agent. I agree to conform to all applicable laws of this jurisdiction. In addition, if a permit for work described in this application is issued, I certify that the Code Official's authorized representative shall have the authority to enter all areas covered by this permit at any reasonable hour to enforce the provisions of the codes applicable to this permit.

Signature of applicant: <u>Diana Olmstead</u>	Date: <u>3/15/10</u>
---	----------------------

This is not a permit; you may not commence ANY work until the permit is issued.

*IM - multi-head, freestanding
allowed to φ
height 15'
setback 5' -*

*proposed 5x5 = 25' (OK)
proposed height 13'
setback 12' from curb (OK)*

X Rainmaker Pylon.
Business Park.
12' Set Back
14' OAH
SIDEWALK

RAINMAKER DR.

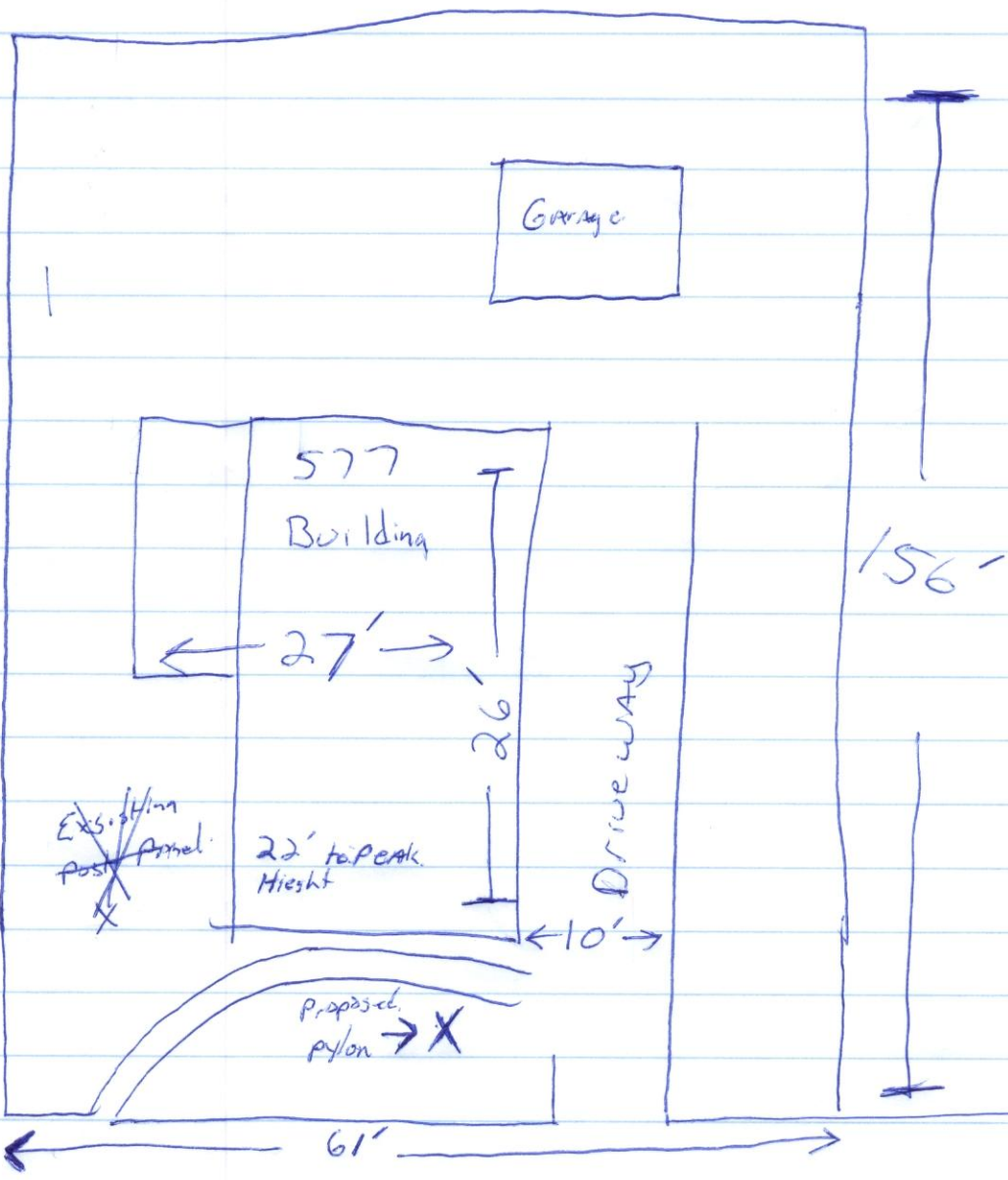

17'
From
Street

SIDEWALKS

Riverside St.

This Design Is The Property Of
Sign Design Inc.

306 Warren Ave. Portland, ME
Phone: 207.856.2600 Fax: 207.856.7600
signdesi@maine.rr.com

60" X 60" Double Sided, Interior Illuminated Cabinet
(Green Ref. Pms 355c Appx.) W/ Lexan Faces & Vinyl Print Graphics

Overall Height 156"



Text Heights

9"

7 1/2"

6"

577

96" X 24" Skirt,
Green (Ref. PMS 355c Appx.)
6" Number In 220 White Vinyl

This proof may reflect color shifts due to the color conversion from ink to paint and or vinyl. Also, PMS colors will be approximated to the best of our ability.

Customer supplied artwork files (300 dpi required) will be used as is, and Sign Design Inc. is not responsible for any faults in the design.

Any black outlines appearing on this proof are for representation only. They are to distinguish sign components such as borders, retainers, faces and reveals. Unless otherwise specified, they are not considered as part of the sign graphics.

Customer approval is a signed confirmation that dimensions, colors, spelling, graphics and all other job specifics are correct.

Sign Design Inc. is not responsible for errors occurring due to improper review of this submitted proof.

Client: Superior rev. 3
File: superior comp. 2
Date: 3.4.10

Approval:

Pylon 12' Set Back
From Street (curb)



01/17/2004



Going Away
Not to Exist

ACORD CERTIFICATE OF LIABILITY INSURANCE

DATE (MM/DD/YYYY)
03/09/2010

PRODUCER 207.283.1486 FAX 207.283.4258
Paquin & Carroll Insurance
260 Main St.
P.O. Box 356
Biddeford, ME 04005

THIS CERTIFICATE IS ISSUED AS A MATTER OF INFORMATION ONLY AND CONFERS NO RIGHTS UPON THE CERTIFICATE HOLDER. THIS CERTIFICATE DOES NOT AMEND, EXTEND OR ALTER THE COVERAGE AFFORDED BY THE POLICIES BELOW.

INSURED Ben Roper
577 Riverside Street
Portland, ME 04103

INSURERS AFFORDING COVERAGE	NAIC #
INSURER A Peerless Insurance Company	24198
INSURER B	
INSURER C	
INSURER D	
INSURER E	

COVERAGES

THE POLICIES OF INSURANCE LISTED BELOW HAVE BEEN ISSUED TO THE INSURED NAMED ABOVE FOR THE POLICY PERIOD INDICATED. NOTWITHSTANDING ANY REQUIREMENT, TERM OR CONDITION OF ANY CONTRACT OR OTHER DOCUMENT WITH RESPECT TO WHICH THIS CERTIFICATE MAY BE ISSUED OR MAY PERTAIN, THE INSURANCE AFFORDED BY THE POLICIES DESCRIBED HEREIN IS SUBJECT TO ALL THE TERMS, EXCLUSIONS AND CONDITIONS OF SUCH POLICIES. AGGREGATE LIMITS SHOWN MAY HAVE BEEN REDUCED BY PAID CLAIMS.

INSR ADD'L LTR INSRD	TYPE OF INSURANCE	POLICY NUMBER	POLICY EFFECTIVE DATE (MM/DD/YYYY)	POLICY EXPIRATION DATE (MM/DD/YYYY)	LIMITS
	GENERAL LIABILITY		TBD	03/08/2010 03/08/2011	EACH OCCURRENCE \$ 2,000,000
	<input checked="" type="checkbox"/> COMMERCIAL GENERAL LIABILITY				DAMAGE TO RENTED PREMISES (Each occurrence) \$ 50,000
	CLAIMS MADE <input checked="" type="checkbox"/> OCCUR				MED EXP (Any one person) \$ 5,000
A					PERSONAL & ADV INJURY \$ 2,000,000
					GENERAL AGGREGATE \$ 4,000,000
					PRODUCTS - COV/OP AGG \$ 4,000,000
	GEN'L AGGREGATE LIMIT APPLIES PER				
					POLICY PRO. SUBCT. LOG.
	AUTOMOBILE LIABILITY				COMBINED SINGLE LIMIT (Per accident) \$
	<input type="checkbox"/> ANY AUTO				BODILY INJURY (Per person) \$
	<input type="checkbox"/> ALL OWNED AUTOS				BODILY INJURY (Per accident) \$
	<input type="checkbox"/> SCHEDULED AUTOS				PROPERTY DAMAGE (Per accident) \$
	<input type="checkbox"/> HIRED AUTOS				
	<input type="checkbox"/> NON-OWNED AUTOS				
	GARAGE LIABILITY				ALTO ONLY - FA ACCIDENT \$
	<input type="checkbox"/> ANY AUTO				OTHER THAN EA ACC \$
					ALTO ONLY AGG \$
	EXCESS/UMBRELLA LIABILITY				EACH OCCURRENCE \$
	<input type="checkbox"/> OCCUR <input type="checkbox"/> CLAIMS MADE				AGGREGATE \$
					\$
					\$
					\$
					\$
	WORKERS COMPENSATION AND EMPLOYERS' LIABILITY				WC STATE/OTL LIMITS \$
	ANY PROPRIETOR/PARTNER/EXECUTIVE OFFICER/MEMBER EXCLUDED?				E.L. EACH ACCIDENT \$
	(If yes, describe under SPECIAL PROVISIONS below)				E.L. DISEASE - FA EMPLOYEE \$
					E.L. DISEASE - POLICY LIMIT \$
	OTHER				

DESCRIPTION OF OPERATIONS / LOCATIONS / VEHICLES / EXCLUSIONS ADDED BY ENDORSEMENT / SPECIAL PROVISIONS
As respects general liability, certificate holder and City of Portland are an additional insured when required by contract, agreement or permit.

CERTIFICATE HOLDER

Sign Design
PO Box 207
Westbrook, ME 04098

CANCELLATION

SHOULD ANY OF THE ABOVE DESCRIBED POLICIES BE CANCELLED BEFORE THE EXPIRATION DATE THEREOF, THE ISSUING INSURER WILL ENDEAVOR TO MAIL 10 DAYS WRITTEN NOTICE TO THE CERTIFICATE HOLDER NAMED TO THE LEFT. BUT FAILURE TO MAIL SUCH NOTICE SHALL IMPOSE NO OBLIGATION OR LIABILITY OF ANY KIND UPON THE INSURER, ITS AGENTS OR REPRESENTATIVES.

AUTHORIZED REPRESENTATIVE
Joshua Fearon

Sign Design Inc.

Sign Contractors

P.O. Box 207
Westbrook, ME 04098
(207) 856-2600 * FAX: (207) 856-7600
1-800-949-9037
signdesi@maine.rr.com
A Full Service Sign Company

RE:

To Whom It May Concern:

As the owner (or owner representative) of the property located at:

577 RIVERSIDE ST

PORTLAND, ME 04103

I authorize Sign Design Inc. to install signs/sign face replacements as detailed on attached paperwork.

W.R.
Signature

3/4/2010
Date

BEN ROOPER
Print Name