

Addition to
 28 Farnham Street

Portland, Maine

MATERIALS SCHEDULE

- A Cast in Place Concrete
- A1 Concrete Slab on Grade
- A2 Concrete Pavers
- B Wood Framing
- B1 Plywood Sheathing
- B2 Wood Blocking
- B3 Exterior Trim
- B4 Interior Wood Trim
- B5 Fir V-Match Siding
- B6 Structural Member
- C Cement-Fiber Lap Siding
- C1 Vinyl Lap Siding
- C2 Fiberglass Insulation
- D Rigid Insulation
- D1 Dampproofing
- D2 Roofing Underlayment
- D3 Asphalt Fiberglass Roof Shingles
- D4 Metal Roof Edge
- D5 Metal Soffit Vent
- E Metal Flashing
- E1 Vapor Barrier
- E2 Air Infiltration Barrier
- F Vinyl Window
- F1 Masonite Door
- F2 Wood Door
- F3 Fiberglass Door
- G Gypsum Board
- G1 Tite Backer Board
- G2 Moisture Resistant Gypsum Board
- H Fire Retardant Gypsum Board
- J Wood Strip Flooring
- J2 Ceramic Tile
- K Concrete Slab Sealer
- K1 Custom Millwork
- K2 Solid Surface Countertop
- K3 Wood Louver
- K4 Painted Finish
- L Stain and Clear Finish
- M Crushed Stone
- M Compacted Fill
- M1 Foundation Drain
- N Pine V-Match Siding
- N1 Sealant
- O Bituminous Asphalt Paving
- O1 Light Fixture
- P Heat Exchanger
- Q Ceiling Fan
- R Lawn Area
- R1 Plant Bed Area
- R2 Existing Tree to Remain
- S Composite Decking
- S1 Manufactured Wood Cabinets

NOTE: All material designations shown on drawings are for new materials unless noted otherwise.

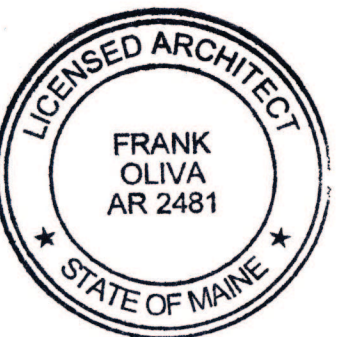

Revision:

Issue: CONSTRUCTION DRAWING

Title

Proposed
 Site Plan

Scale: Date: 11/10/2014

Drawn By:
 Checked By:
 Approved By:
 Project No: 2014

DWG NO: L1.0

FARNHAM STREET

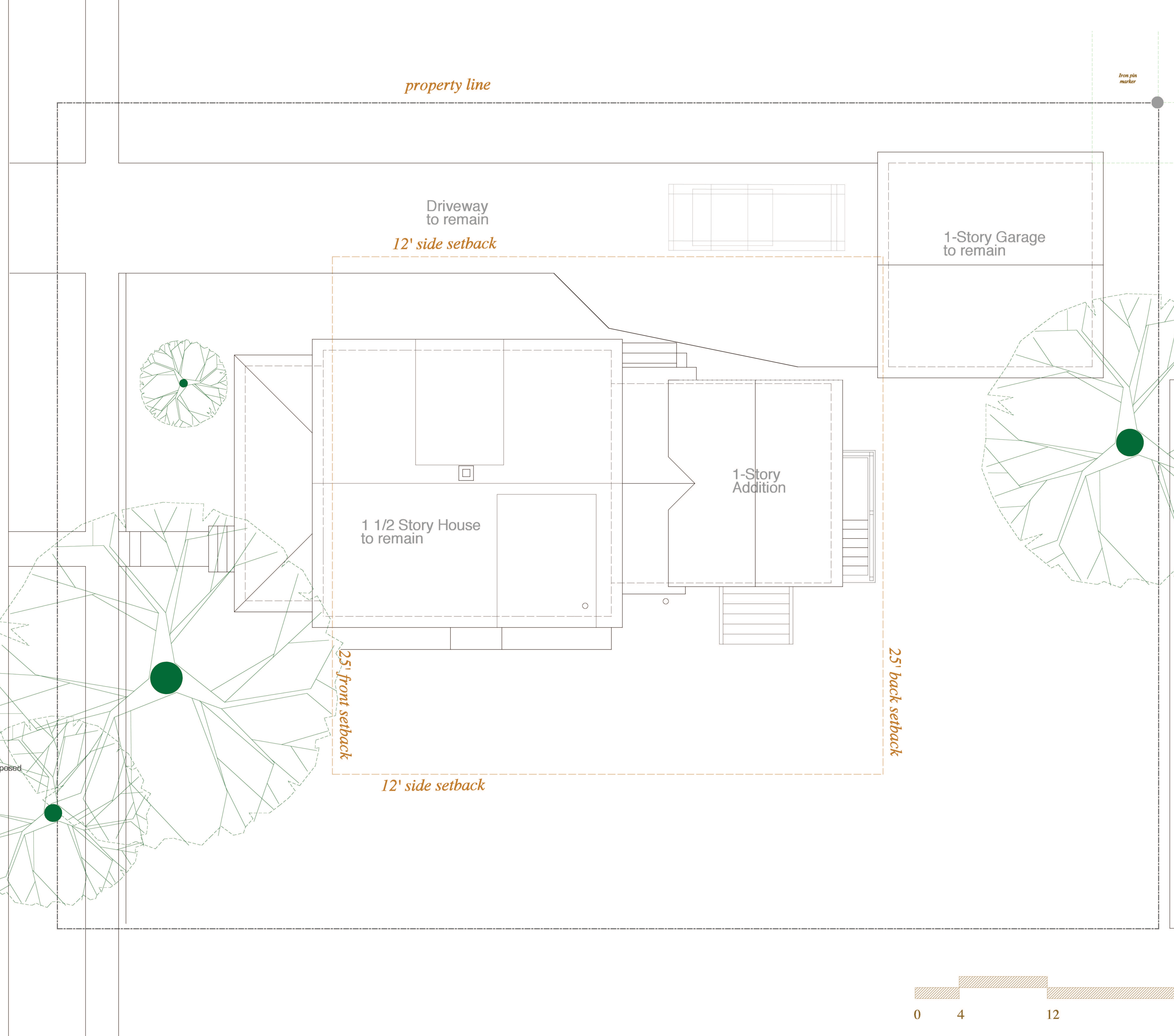

SITE NOTES

1. SITE PLAN BASED ON FIELD MEASUREMENTS AND SITE INSPECTION PERFORMED BY: FRANK OLIVA ARCHITECT, DATED 3/25/2014

2. LOT INFO:

ADDRESS: 28 FARNHAM STREET
 PARCEL #: 310-F16
 LOT AREA: 7,500 SF, 0.167 A
 LOT COVERAGE: 35 % MAX, 34.6% proposed
 ZONE: R3 RESIDENTIAL
 ZONE SETBACKS: FRONT 25 FEET
 SIDE 12 FEET
 SIDE 12 FEET
 BACK 25 FEET

CITY WATER AND SEWER

NOTE WELL

Information on this site plan concerning utilities was taken from site inspection. Locations indicated are approximations. Prior to any new construction, the General Contractor shall consult local utility companies, the city of portland, and Dig Safe #1-888-344-7233, for information about this site.

