

DISPLAY THIS CARD ON PRINCIPAL FRONTAGE OF WORK
CITY OF PORTLAND

PERMIT ISSUED
PERMITS SECTION
MAY 16 2005
Permit Number: 050587
CITY OF PORTLAND

Please Read
Application And
Notes, If Any,
Attached

PERMIT

This is to certify that Day Sandra /self
has permission to Install a 10' x 10' shed
AT 92 Lane Ave 310 E007001

provided that the person or persons, firm or corporation accepting this permit shall comply with all of the provisions of the Statutes of Maine and of the ordinances of the City of Portland regulating the construction, maintenance and use of buildings and structures, and of the application on file in this department.

Notification of inspection must
give and written permission procured
before this building or part thereof
landed or enclosed-in.
HEAR NOTICE IS REQUIRED.

Apply to Public Works for street line and grade if nature of work requires such information.

A certificate of occupancy must be procured by owner before this building or part thereof is occupied.

OTHER REQUIRED APPROVALS

Fire Dept. _____
Health Dept. _____
Appeal Board _____
Other _____
Department Name

Janice Bourke 5/16/05
Director - Building & Inspection Services

PENALTY FOR REMOVING THIS CARD

City of Portland, Maine - Building or Use Permit Application

389 Congress Street, 04101 Tel: (207) 874-8703, Fax: (207) 874-8716

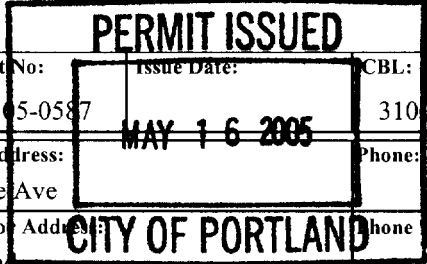

Permit No: 05-0587	Issue Date: MAY 16 2005	CBL: 310 E007001
-----------------------	----------------------------	---------------------

Location of Construction: 92 Lane Ave	Owner Name: Day Sandra	Owner Address: 92 Lane Ave	Phone:
Business Name:	Contractor Name: self	Contractor Address: Portland	Phone:
Lessee/Buyer's Name	Phone:	Permit Type: Sheds	Zone: R3

Past Use: Single Family	Proposed Use: Single Family w/10' x 10' shed	Permit Fee: \$30.00	Cost of Work: \$1,000.00	CEO District: 5
Proposed Project Description:		FIRE DEPT: <input type="checkbox"/> Approved <input type="checkbox"/> Denied	INSPECTION: Use Group: R3 Type: Accessory Shed N/A Signature: JMB 5/16/05	
		PEDESTRIAN ACTIVITIES DISTRICT (P.A.D.) Action: <input type="checkbox"/> Approved <input type="checkbox"/> Approved w/Conditions <input type="checkbox"/> Denied Signature: _____ Date: _____		

Permit Taken By: jmb	Date Applied For: 0511612005	Zoning Approval	
--------------------------------	--	------------------------	--

Special Zone or Reviews <input type="checkbox"/> Shoreland <input type="checkbox"/> Wetland <input type="checkbox"/> Flood Zone <input type="checkbox"/> Subdivision <input type="checkbox"/> Site Plan Maj <input type="checkbox"/> Minor <input type="checkbox"/> MM <input type="checkbox"/> Date: JMB 5/16/05	Zoning Appeal <input type="checkbox"/> Variance <input type="checkbox"/> Miscellaneous <input type="checkbox"/> Conditional Use <input type="checkbox"/> Interpretation <input type="checkbox"/> Approved <input type="checkbox"/> Denied Date: _____	Historic Preservation <input checked="" type="checkbox"/> Not in District or Landmark <input type="checkbox"/> Does Not Require Review <input type="checkbox"/> Requires Review <input type="checkbox"/> Approved <input type="checkbox"/> Approved w/Conditions <input type="checkbox"/> Denied Date: JMB
---	---	--

CERTIFICATION

I hereby certify that I am the owner of record of the named property, or that the proposed work is authorized by the owner of record and that I have been authorized by the owner to make this application as his authorized agent and I agree to conform to all applicable laws of this jurisdiction. In addition, if a permit for work described in the application is issued, I certify that the code official's authorized representative shall have the authority to enter all areas covered by such permit at any reasonable hour to enforce the provision of the code(s) applicable to such permit.

SIGNATURE OF APPLICANT	ADDRESS	DATE	PHONE
RESPONSIBLE PERSON IN CHARGE OF WORK, TITLE		DATE	PHONE

This page contains a detailed description of the Parcel ID you selected. Press the **New Search** button at the bottom of the screen to submit a new query.

Current Owner Information

Card Number	1 of 1
Parcel ID	310 E007001
Location	92 LANE AVE
Land Use	SINGLE FAMILY
Owner Address	DAY SANDRA 92 LANE AVE PORTLAND ME 04103
Book/Page	22121/152
Legal	310-E-7-8 LANE AVE 90-96 10800 SF

587

Current Valuation Information

Land	Building	Total
\$34,150	\$77,810	\$112,460

New Estimated Valuation Information

Land	Building	Total	Phase-In Value
\$66,200	\$120,300	\$186,500	\$149,480

Property Information

Year Built	Style	Story Height	sq. Ft.	Total Acres		
1985	Cape	1.5	1547	0.248		
Bedrooms	Full Baths	Half Baths	Total Rooms	Attic	Basement	
4	1	1	6	None	Full	

Outbuildings

Type	Quantity	Year Built	Size	Grade	Condition
------	----------	------------	------	-------	-----------

Sales Information

Date	Type	Price	Book/Page
12/14/2004	LAND + BLDING	\$220,000	22121-152
07/16/2001	LAND + BLDING	\$150,000	16527-203
03/18/1999	LAND + BLDING	\$105,000	14619-257
02/24/1999	LAND + BLDING		14565-094

Picture and Sketch

Picture	Sketch	Tax Map
---------	--------	---------

[Click here to view Tax Roll Information.](#)

Any information concerning tax payments should be directed to the Treasury office at 874-8490 or e-mailed.

[Click here to view comparable sales or below to view by:](#)

All Purpose Building Permit Application

If you or the property owner owes real estate or personal property taxes or user charges on any property within the City, payment arrangements must be made before permits of any kind are accepted.

Location/Address of Construction: <u>92 Lane Ave Portland ME 04103</u>		
Total Square Footage of Proposed Structure <u>10ft X 10ft</u>	Square Footage of Lot	
Tax Assessor's Chart, Block & Lot Chart# <u>316</u> Block# <u>E</u> Lot# <u>7</u>	Owner: <u>Sandra Day</u>	Telephone: <u>671-5468 cell</u> <u>797-8110 home</u>
Lessee/Buyer's Name (If Applicable)	Applicant name, address & telephone: <u>Sandra Day 92 Lane Ave Portland ME 04103</u>	Cost Of Work: \$ <u>750.00</u> Fee: \$ <u>30.00</u>
Current use: <u>SF Home</u>		
If the location is currently vacant, what was prior use: _____		
Approximately how long has it been vacant: _____		
Proposed use: <u>SF Home</u>		
Project description: <u>10 x 10 Shed</u>		
Contractor's name, address & telephone: _____		
Who should we contact when the permit is ready: <u>Sandra Day 797-8110 home</u>		
Mailing address: <u>92 Lane Ave Portland ME 04103</u> <u>671 5468 cell</u>		
We will contact you by phone when the permit is ready. You must come in and pick up the permit and review the requirements before starting any work, with a Plan Reviewer. A stop work order will be issued and a \$100.00 fee if any work starts before the permit is picked up. PHONE:		

IF THE REQUIRED INFORMATION IS NOT INCLUDED IN THE SUBMISSIONS THE PERMIT WILL BE AUTOMATICALLY DENIED AT THE DISCRETION OF THE BUILDING/PLANNING DEPARTMENT, WE MAY REQUIRE ADDITIONAL INFORMATION IN ORDER TO APPROVE THIS PERMIT.

I hereby certify that I am the Owner of record of the named property, or that the owner of record authorizes the proposed work and that I have been authorized by the owner to make this application as his/her authorized agent. I agree to conform to all applicable laws of this jurisdiction. In addition, if a permit for work described in this application is issued, I certify that the Code Official's authorized representative shall have the authority to enter all areas covered by this permit at any reasonable hour to enforce the provisions of the codes applicable to this permit.

Signature of applicant: <u>Sandra Day</u>	Date: <u>1/5/05</u>
---	---------------------

This is NOT a permit, you may not commence ANY work until the permit is issued.
If you are in a Historic District you may be subject to additional permitting and fees with the Planning Department on the 4th floor of City Hall

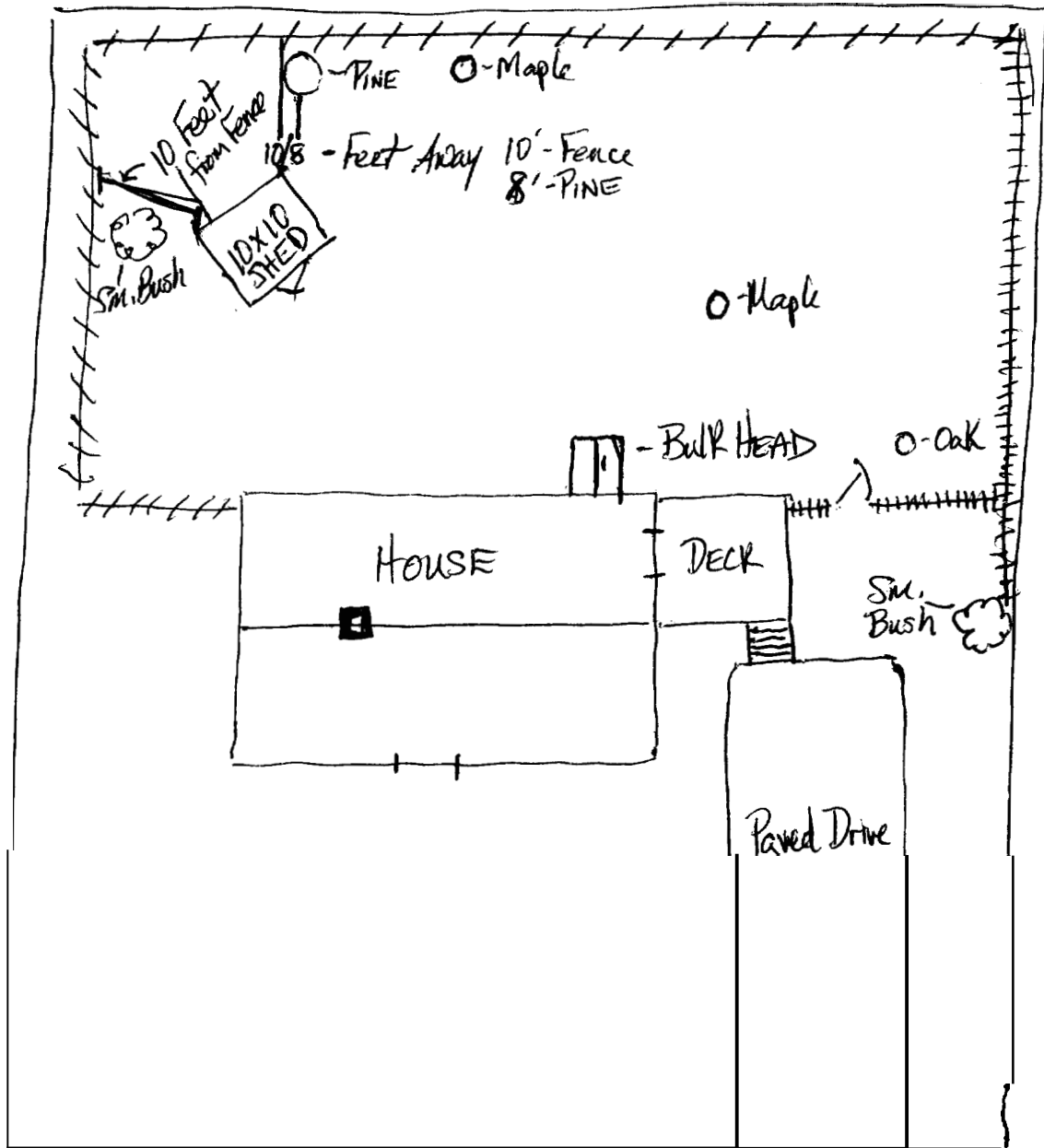

#92 - LANE AVE, PORT
 R3 Zone
 min 5' from Pines



SHOP GIFT CENTER KNOW-HOW SERVICES

Register

Home Shop Garden Center Storage Buildings

Back to previous products

Handy Home Products
Princeton 10 Ft. x 10 Ft. Storage Building
W/Floor Frame Kit
Model 18250-1



PRODUCT IMAGE



HANDY HOME PRODUCTS
The Handy Home Company

€3

Price: \$749.00/ea

Qty: 1

ADD TO CART

Quantity: 1
Price: \$749.00
Total: \$749.00

Keyword or item #

SEARCH

REGISTER CART

CUSTOMER SUPPORT SIGN IN STORE FINDER

BUILDING PERMIT INSPECTION PROCEDURES

Please call 874-8703 or 874-8693 to schedule your inspections as agreed upon

Permits expire in 6 months, if the project is not started or ceases for 6 months.

The Owner or their designee is required to notify the inspections office for the following inspections and provide adequate notice. Notice must be called in 48-72 hours in advance in order to schedule an inspection:

By initializing at each inspection time, you are agreeing that you understand the inspection procedure and additional fees from a "Stop Work Order" and "Stop Work Order Release" will be incurred if the procedure is not followed as stated below.

A Pre-construction Meeting will take place upon receipt of your building permit.

- Footing/Building Location Inspection:** Prior to pouring concrete
- Re-Bar Schedule Inspection: Prior to pouring concrete
- Foundation Inspection: Prior to placing ANY backfill
- Framing/Rough Plumbing/Electrical: Prior to any insulating or drywalling
- Final/Certificate of Occupancy: Prior to any occupancy of the structure or use. ~~NOTE: There is a \$75.00 fee per inspection at this point.~~

Certificate of Occupancy is not required for certain projects. Your inspector can advise you if your project requires a Certificate of Occupancy. All projects DO require a final inspection

If any of the inspections do not occur, the project cannot go on to the next phase, REGARDLESS OF THE NOTICE OR CIRCUMSTANCES.

NA CERTIFICATE OF OCCUPANCIES MUST BE ISSUED AND PAID FOR, BEFORE THE SPACE MAY BE OCCUPIED

Chanda L. [Signature]
Signature of Applicant/Designee

5/16/05
Date

[Signature]
Signature of Inspections Official

5/16/05
Date

CBL: 310-F-7

Building Permit #: 05-0587

BUILDING PERMIT INSPECTION PROCEDURES

Please call 874-8703 or 874-8693 to schedule your inspections as agreed upon

Permits expire in 6 months, if the project is **not** started or ceases for 6 months.

The Owner or their designee is required to notify the inspections office for the following inspections and provide adequate notice. Notice must be called in **48-72** hours in advance in order to schedule an inspection:

By initializing at each inspection time, you are agreeing that you understand the inspection procedure and additional fees from a "Stop Work Order" and "Stop Work Order Release" **will** be incurred if the procedure is not followed as stated below.

A Pre-construction Meeting will take place upon receipt of your building permit.

- NA Footing/Building Location Inspection: Prior to pouring concrete
- NA Re-Bar Schedule Inspection: Prior to pouring concrete
- NA Foundation Inspection: Prior to placing ANY backfill
- Framing/Rough Plumbing/Electrical: Prior to any insulating or drywalling
- NA Final/Certificate of Occupancy: Prior to any occupancy of the structure or use. NOTE: There is a \$75.00 fee per inspection at this point.

Certificate of Occupancy is not required for certain projects. Your inspector can advise you if your project requires a Certificate of Occupancy. All projects DO require a final inspection

If any of the inspections do not occur, the project cannot go on to the next phase, REGARDLESS OF THE NOTICE OR CIRCUMSTANCES.

NA CERTIFICATE OF OCCUPANICES MUST BE ISSUED AND PAID FOR, BEFORE THE SPACE MAY BE OCCUPIED

[Signature]
Signature of Applicant/Designee

5/16/05
Date

[Signature]
Signature of Inspections Official

5/16/05
Date

CBL 15-F-22 Building Permit #: 05-0585