

**City of Portland, Maine - Building or Use Permit Application**  
 389 Congress Street, 04101 Tel: (207) 874-8703, Fax: (207) 874-8716

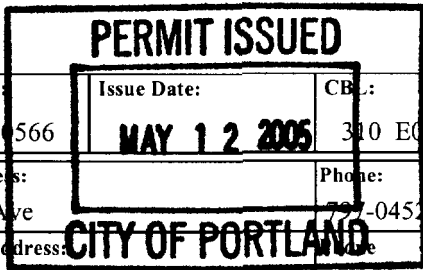

<b>Location of Construction:</b> 110 Lane Ave		<b>Owner Name:</b> Saucier Paul M &		<b>Permit No:</b> 05-0566		<b>Issue Date:</b> MAY 12 2005		<b>CB#:</b> 310 E03001	
<b>Business Name:</b>		<b>Contractor Name:</b> National Pool & Spa		<b>Owner Address:</b> 110 Lane Ave		<b>Phone:</b> 737-0452		<b>Contractor Address:</b> CITY OF PORTLAND	
<b>Lessee/Buyer's Name</b>		<b>Phone:</b>		<b>Zone:</b> R3		\$66.00   \$4,700.00   5   1		<b>FIRE DEPT:</b> <input type="checkbox"/> Approved <input type="checkbox"/> Denied	
<b>Past Use:</b> Single Family		<b>Proposed Use:</b> Single Family w/21' x 52" above ground pool		<b>INSPECTION:</b> Use Group: R3 Type: Pool IRC-2003		Signature:		Signature: JMB 5/12/05	
<b>Proposed Project Description:</b> Instal 21' x 52" above ground pool wiremovable ladder		<b>PEDESTRIAN ACTIVITIES DISTRICT (P.A.D.)</b>		Action: <input type="checkbox"/> Approved <input type="checkbox"/> Approved w/Conditions <input type="checkbox"/> Denied		Signature:		Date:	

<b>Permit Taken By:</b> jmb		<b>Date Applied For:</b> 05/12/2005		<b>Zoning Approval</b>			
1.		<b>Special Zone or Reviews</b>		<b>Zoning Appeal</b>		<b>Historic Preservation</b>	
2.		<input type="checkbox"/> Shoreland		<input type="checkbox"/> Variance		<input checked="" type="checkbox"/> Not in District or Landmark	
3.		<input type="checkbox"/> Wetland		<input type="checkbox"/> Miscellaneous		<input type="checkbox"/> Does Not Require Review	
		<input type="checkbox"/> Flood Zone		<input type="checkbox"/> Conditional Use		<input type="checkbox"/> Requires Review	
		<input type="checkbox"/> Subdivision		<input type="checkbox"/> Interpretation		<input type="checkbox"/> Approved	
		<input type="checkbox"/> Site Plan		<input type="checkbox"/> Approved		<input type="checkbox"/> Approved w/Conditions	
		Maj <input type="checkbox"/> Minor <input type="checkbox"/> MM <input type="checkbox"/>		<input type="checkbox"/> Denied		<input type="checkbox"/> Denied	
		Date: JMB 5/12/05		Date:		Date: JMB	

**CERTIFICATION**

I hereby certify that I am the owner of record of the named property, or that the proposed work is authorized by the owner of record and that I have been authorized by the owner to make this application as his authorized agent and I agree to conform to all applicable laws of this jurisdiction. In addition, if a permit for work described in the application is issued, I certify that the code official's authorized representative shall have the authority to enter all areas covered by such permit at any reasonable hour to enforce the provision of the code(s) applicable to such permit.

SIGNATURE OF APPLICANT ADDRESS DATE PHONE

RESPONSIBLE PERSON IN CHARGE OF WORK, TITLE DATE PHONE

**City of Portland, Maine - Building or Use Permit**

389 Congress Street, 04101 Tel: (207) 874-8703, Fax: (207) 874-8716

<b>Permit No:</b> 05-0566	<b>Date Applied For:</b> 05/12/2005	<b>CBL:</b> 310 E003001
------------------------------	--	----------------------------

<b>Location of Construction:</b> 110 Lane Ave	<b>Owner Name:</b> Saucier Paul M &	<b>Owner Address:</b> 110 Lane Ave	<b>Phone:</b> ( ) 797-0452
<b>Business Name:</b>	<b>Contractor Name:</b> National Pool & Spa	<b>Contractor Address:</b> Portland	<b>Phone:</b>
<b>Tenant/Lessee/Buyer's Name</b>	<b>Phone:</b>	<b>Permit Type:</b> Swimming Pools	

<b>Proposed Use:</b> Single Family w/2 1' x 52" above ground pool	<b>Proposed Project Description:</b> Instal 21' x 52" above ground pool wiremovable ladder
--	---

**Note:****Ok to Issue:** **Dept:** Building**Status:** Approved**Reviewer:** Jeanine Bourke**Approval Date:** 05/12/2005**Note:****Ok to Issue:** 

1) Pool installation shall meet the code requirements in Appendix G of the IRC 2003

# Pool Installation/Construction Permit Application

If you or the property owner owes real estate or personal property taxes or user charges on any property within the City, payment arrangements must be made before permits of any kind are accepted.

Location/Address of Construction: <u>110 Lane Ave</u>		
Total Square Footage of Proposed Structure <u>"Round Pool"</u>	Square Footage of Lot <u>7500 sq ft</u>	
Tax Assessor's Chart, Block & Lot Chart# <u>310</u> Block# <u>E</u> Lot# <u>3</u>	Owner: <u>Paul + Mary Sancier</u>	Telephone: <u>797-0452</u>
Lessee/Buyer's Name (If Applicable)	Applicant name, address & telephone: <u>110 Lane Ave</u> <u>Portland Maine 04103</u> <u>Paul Sancier 797 0452</u>	Cost Of Work: \$ <u>4,700</u> Fee: \$ <u>66.00</u>
Dimensions of pool: <u>21' x 52"</u> Above or below ground: <u>Above</u>		
Dimensions of decking and/or any platforms, sheds, or other structures: <u>None</u>		
Contractor's name, address & telephone: <u>National Pool and Spa, 39 Roosevelt Trail</u> <u>Windham Maine 04062 207 893 0004</u>		
Whom should we contact when the permit is ready: <u>Paul M Sancier</u>		
Mailing address: <u>110 Lane Ave Portland, Me 04103 207 797 0452</u>		
We will contact you by phone when the permit is ready. You must come in and pick up the permit and review the requirements before starting any work, with a Plan Reviewer. A stop work order will be issued and a \$100.00 fee if any work starts before the permit is picked up. PHONE: <u>207 797-0452</u>		

IF THE REQUIRED INFORMATION IS NOT INCLUDED IN THE SUBMISSIONS THE PERMIT WILL BE AUTOMATICALLY DENIED AT THE DISCRETION OF THE BUILDING/PLANNING DEPARTMENT, WE MAY REQUIRE ADDITIONAL INFORMATION IN ORDER TO APPROVE THIS PERMIT.

Signature of applicant: <u>Paul M Sancier</u>	Date: <u>5-11-05</u>
---	----------------------

This page contains a detailed description of the Parcel ID you selected. Press the **New Search** button at the bottom of the screen to submit a new query.

*5/12  
10 AM*

**Current Owner Information**

Card Number 1 of 1  
 Parcel ID 310 E003001  
 Location 110 LANE AVE  
 Land Use SINGLE FAMILY  
  
 Owner Address SAUCIER PAUL M & MARY M JTS  
 110 LANE AVE  
 PORTLAND ME 04103  
  
 Book/Page 7300/265  
 Legal 310-E-3  
 LANE AVE 110-114  
 8400 SF

*# 566  
23*

**Current Valuation Information**

Land	Building	Total
\$32,870	\$79,480	\$112,350

**New Estimated Valuation Information**

Land	Building	Total	Phase-In Value
\$62,900	\$130,500	\$193,400	\$152,875

**Property Information**

Year Built 1985	Style Cape	Story Height 1.5	sq. Ft. 1344	Total Acres 0.186		
Bedrooms 3	Full Baths 1	Half Baths 1	Total Rooms 6	Attic None	Basement Full	

**Outbuildings**

Type	Quantity	Year Built	Size	Grade	Condition
SHED-FRAME	1	1985	8X12	C	A
GARAGE-WD/CB	1	1996	22X24	C	A

**Sales Information**

Date	Type	Price	Book/Page
------	------	-------	-----------

**Picture and Sketch**

Picture	Sketch	Tax Map
---------	--------	---------

[Click here](#) to view Tax Roll Information.

Any information concerning tax payments should be directed to the Treasury office at 874-8490 or [e-mailed](#).

[Click here](#) to view comparable sales or below to view **by**:



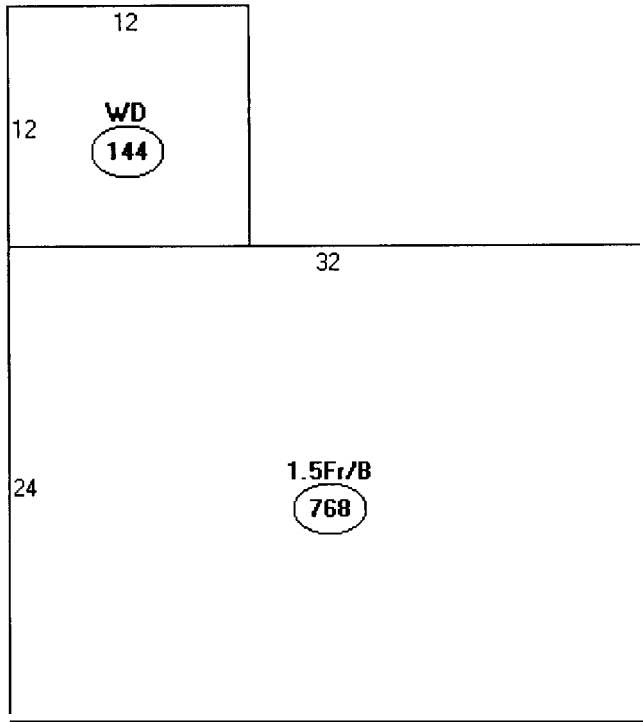

Descriptor/Area

A:1.5Fr/B  
768 sqft

E:WD  
144 ssft

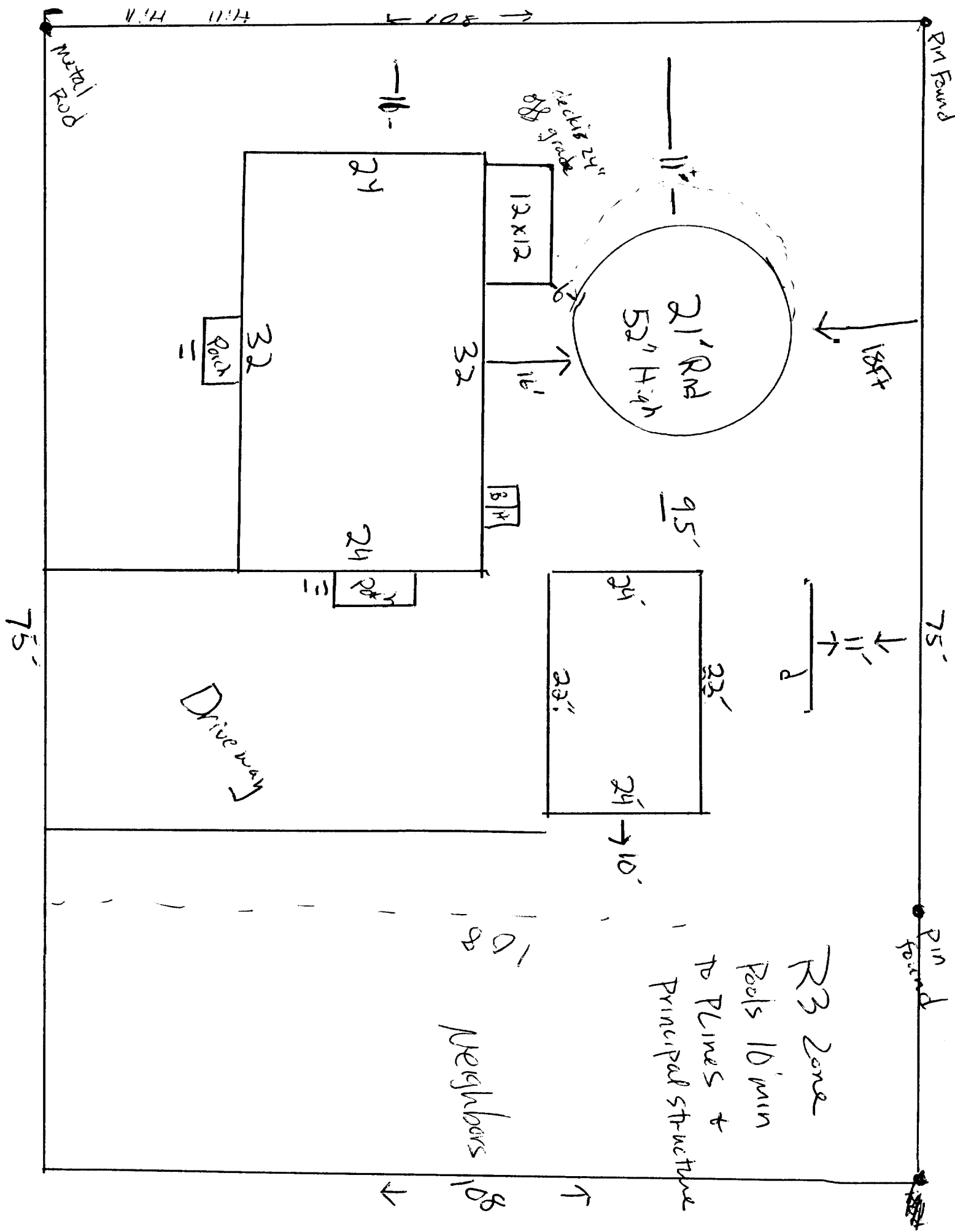

# BUILDING PERMIT INSPECTION PROCEDURES

Please call 874-8703 or 874-8693 to schedule your inspections as agreed upon

Permits expire in 6 months, if the project is **not** started or ceases for 6 months.

The Owner or their designee is required to notify the inspections office for the following inspections **and** provide adequate notice. Notice must be called in 48-72 hours in advance in order to schedule an inspection:

By **initializing** at each inspection time, you are agreeing that you understand the inspection procedure and additional fees from a "Stop Work Order" and "Stop Work Order Release" **will** be incurred if the procedure is not followed as stated below.

A Pre-construction Meeting will take place upon receipt of your building permit.

- 1 Footing/Building Location Inspection: Prior to pouring concrete
- NA Re-Bar Schedule Inspection: Prior to pouring concrete
- NA Foundation Inspection: Prior to placing ANY backfill
- 2 Framing/Rough Plumbing/Electrical: Trench Prior to any insulating or drywalling
- Final/Certificate of Occupancy: Prior to any occupancy of the structure or use. NOTE: ~~There is a \$75.00 fee per inspection at this point.~~

maybe  
2 INSPECTION  
Trench at Final

Certificate of Occupancy is not required for certain projects. Your inspector can advise you if your project requires a Certificate of Occupancy. All projects DO require a final inspection

**If any of the** inspections do not occur, the project cannot go on to the next phase, **REGARDLESS OF THE NOTICE OR CIRCUMSTANCES.**

**CERTIFICATE OF OCCUPANCIES MUST BE ISSUED AND PAID FOR, BEFORE THE SPACE MAY BE OCCUPIED**

A Paul M. Saurin  
Signature of Applicant/Designee

Date 5/12/05

Carole Bonka  
Signature of Inspections Official

Date

CBL: 310-E003

Building Permit #: # 05-0566



# DISPLAY THIS CARD ON PRINCIPAL FRONTAGE PERMIT ISSUES CITY OF PORTLAND

Please Read Application And Notes, If Any, Attached

**PERMIT**  
MAY 12 2005  
Permit Number: 050566  
CITY OF PORTLAND

This is to certify that Saucier Paul M &/National P & Spa  
has permission to Instal 21' x 52" above ground ol w/ren able la  
AT 110 Lane Ave 310 E003001

provided that the person or persons, firm or operation accepting this permit shall comply with all of the provisions of the Statutes of the City of Portland regulating the construction, maintenance and use of buildings and structures, and of the application on file in this department.

Apply to Public Works for street line and grade if nature of work requires such information.

Information and where this information is required, a notice is required.

A certificate of occupancy must be procured by owner before this building or part thereof is occupied.

### OTHER REQUIRED APPROVALS

Fire Dept. \_\_\_\_\_  
Health Dept. \_\_\_\_\_  
Appeal Board \_\_\_\_\_  
Other \_\_\_\_\_  
Department Name \_\_\_\_\_

*Paul Bouke Stiles*  
Director - Building & Inspection Services

PENALTY FOR REMOVING THIS CARD

Take A  
look...

1st / 2nd  
week  
June  
#

# NATIONAL POOL AND SPA "POOL QUOTE"

39 ROOSEVELT TRAIL  
WINDHAM, ME 04062  
207-893-0002  
STORE MANAGER- JULIE

## POOL PRICE CHOICES: INSTALLED / NOT INSTALLED

MODEL	<u>DISCOVERY</u>	SIZE	<u>21ft</u>	\$	<u>4295-</u>
MODEL	_____	SIZE	_____	\$	_____
MODEL	_____	SIZE	_____	\$	_____
MODEL	_____	SIZE	_____	\$	_____

### SELECTED OPTIONS:

_____	\$
_____	\$
_____	\$
_____	\$

### SALES TAX:

\$ \_\_\_\_\_

### TOTAL ESTIMATE PACKAGE:

\$ \_\_\_\_\_

THIS FORM IS AN ESTIMATE ONLY THIS IS USUALLY GIVEN SIGHT UNSEEN AND THEREFORE MAY REQUIRE MODIFICATION DEPENDING ONSITE CONDITIONS. WE WILL PROVIDE A WRITTEN CONTRACT TO BE SIGNED BY YOU AND THE AGENT OF NATIONAL POOL AND SPA BEFORE ANY WORK IS STARTED AND ANY MATERIALS ARE DELIVERED THIS IS DESIGNED TO BE A "BALL PARK" ESTIMATE AND IS NOT A PRICE GAURANTEE IF YOU WISH TO GAURANTEE A PRICE PLEASE ARRANGE AN ONSITE APPOINTMENT TO INITIATE A CONTRACT. THANK YOU FOR YOUR INTREST IN NATIONAL POOL AND SPA AND THE PRODUCTS WE CARRY.

DATE 5/7/05 LOCATION Windham SALESPERSON Julie  
----- (CUT)

NAME Paul Saucier

ADDRESS 110 Lane &e Portland, Me

PHONE \_\_\_\_\_ CELL 04103

HOW DID YOU HEAR ABOUT US? 1/4 The Road/Out CRUISIN'

DATE \_\_\_\_\_ LOCATION 1 SALESPERSON \_\_\_\_\_

POOL CHOICE \_\_\_\_\_ PRICE ESTIMATE \_\_\_\_\_

MISCNOTES Had a pool before

Patricia  
Kiaci

# NATIONAL POOL AND SPA

39 ROOSEVELT TRAIL

WINDHAM, ME 04062

207-893-0004

STORE MANAGER- JULIE

## ABOVE GROUND POOL OPTIONS

N&W WATER CLORINATOR SYSTEM	<del>\$89.95</del> ___
N&W WATER CARTRIDGES (3PAK)	\$79.95___
NATURE 2 CLARITEC UNIT	<del>\$139.95</del> ___
NATURE 2 CARTRIDGES (6 Months)	<del>\$99.95</del> ___
AQUA LUMINATOR POOL LIGHT	\$199.95___
WATER FOUNTAIN	\$69.95___
AQUA BUG CLEANER	\$185.95___
<del>██</del> VAC	\$199.95___
TUXEDO STEPS (TRADE)	\$299.95___
CONFER STAIRS WITH GATE (TRADE)	\$599.95___
POOL ALARM (Electric)	\$169.95___
110 TIMER	<del>\$79.95</del> ___
GAS HEATER 100,000 BTU (UP TO 24 FT)	\$995.95___
GAS HEATER 150,000 BTU (27 FT AND UP)	<del>\$1105.95</del> ___
SOLAR COVER	sizes vary
SOLAR FISH (3 pak)	\$25.00___
SOLAR REEL	sizes vary
WINTER COVER	sizes vary
CUSTOMER SIGNATURE <u>Julie Wallace</u>	DATE <u>5/7/05</u>

NATIONAL POOL AND SPA  
WINDHAM, GRAY AND KENNEBUNK

**POOL KIT FEATURES**

**POOL KIT INCLUDES:**

- \*CUSTOMERS CHOICE OF POOL
- \*V BEAD, 20 MIL, 15 YR WARRANTY
- \*THROUGH WALL (DELUXE SKIMMER KIT)
- \*FULL RATED SAND FILTER (DE OPTIONAL)
- \*SAFETY A FRAME- RESIN LADDER
- \*COMPLETE MAINTENCE KIT
- \*EZ VAC

\*HAYWARD Pump

**INSTALL INCLUDES:**

- \*PREP OF POOL SITE
- \*5" POOL BASE MATERIAL(FILL TO LEVEL NOT INCLUDED)
- \*PATIO BLOCKS FOR PERIMETER OF POOL
- \*ASSEMBLY OF POOL AND LINER
- \*INSTALL OF POOL AND LINER
- \*INSTALLATION OF PUMP, FILTER AND SKIMMER
- \*ON-SITE CUSTOMER TRAINING SESSION
- \*FREE POOL CLOSING WITH COVER PURCHASE(CHEMICALS NOT INCLUDED)

**NO INCLUDED WITH INSTALL:**

- \*ANY NECESSARY PERMIT
- \*ANY REQUIRED ELECTRICAL WORK
- \*WATER (1 LOAD REQUIRED)
- \*ADDITIONAL FILL OR REMOVAL OR ADDITIONAL EXCAVATING
- \*REMOVAL OF STUMPS, ROCKS, LEDGE, OR OTHER INSTALL BARRIERS

walls of 48" to 54", swivel pads adjust to any inclined surface. Additional safety on entry system, which can be used with a padlock

Individually packed  
1 per carton

**BEST BUY**  
**\$1 99.99**

48" to 54". Swivel pads adjust to any inclined surface

Individually packed  
1 per carton

**BEST BUY**  
**\$99.00**

## Performance AG Ladder

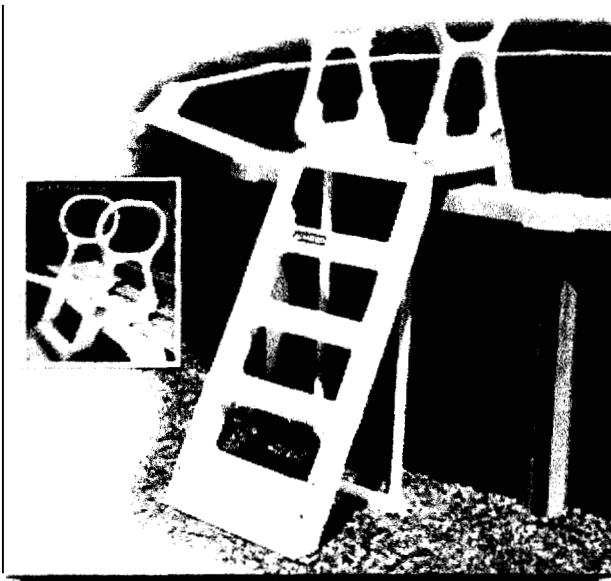

### USE THE STRONGEST MATERIAL:

The Integrity AG Ladder is molded of rugged, high-impact resistant thermoplastic. It resists pool chemicals, and contains UV inhibitors - for years of safe, carefree use.

### EASY-CLIMBING STEPS

The Integrity AG Ladder has five steps - rather than the typical four. We set the first tread low, and the others just over 10" apart. Result: easier climbing, safer for kids.

### ANTI-SLIP

No mold texture- rather than glue it on. The result: superior, permanent traction on both steps and deck.

### EASY TO ASSEMBLE

The "A-frame" design has 11 pieces, "Deck-To-Pool" just 5. With its stainless steel hardware, the ladder is virtually maintenance-free.

### BUILT-IN VERSATILITY

Adjustable to three pool heights: 48", 52" and 54". The A-frame ladder is convertible to deck-to-pool or stand-alone. And on the A-frame, there is a removable, portable outside ladder.

### NO COMPROMISE ON QUALITY OR SAFETY

The Integrity AG Ladder is designed and manufactured according to ANSI-NSPI standards, and under the ISO 9001:2000 Quality Standard the industry's highest.

<p><b>"A-Frame" Design</b></p> <p><b>\$229.99</b></p> <p>Select Color ▾</p> <p>1 ▾ Buy Now!</p>	<p><b>"Deck-To-Pool" Design</b></p> <p><b>\$139.99</b></p> <p>Select Color ▾</p> <p>1 ▾ Buy Now!</p>
---	--

## Above Ground Entry System

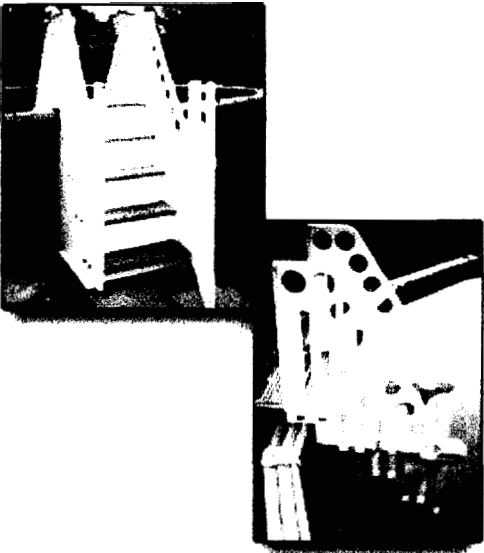

- Meets ANSI/NSPI standards.

**Garden**  
LEISURE

The pool with a 100% corrosion-free  
blow-molded resin structure

# DISCOVERY™ LX

ADVANTAGE ARCADE 52"

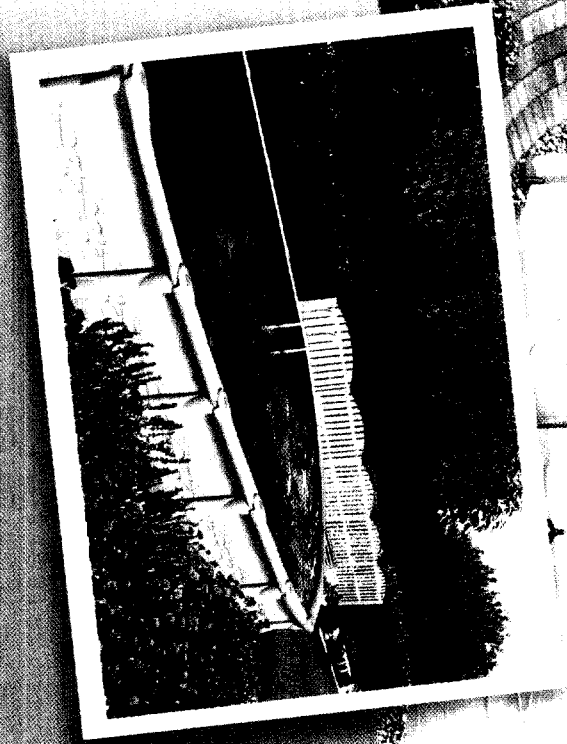

○ 12' 10" 18" 21" 24" 27"

○ 12' x 21' 15' x 30'