

DISPLAY THIS CARD ON PRINCIPAL FRONTAGE OF WORK CITY OF PORTLAND

Please Read Application And Notes, If Any, Attached

BUILDING DEPARTMENT

PERMIT

Permit Number: 030069

This is to certify that Legassie Edward J &/Maine Window & Glass

has permission to Enclose existing 12' x 16' deck with a sun room.

AT 60 Epping St 310 C003001

provided that the person or persons, firm or corporation accepting this permit shall comply with all of the provisions of the Statutes of Maine and of the ordinances of the City of Portland regulating the construction, maintenance and use of buildings and structures, and of the application on file in this department.

Apply to Public Works for street line and grade if nature of work requires such information.

Notification inspection must given and work on permit on procu before this building or part thereof leased or closed-in. HOUR NOTICE IS REQUIRED.

A certificate of occupancy must be procured by owner before this building or part thereof is occupied.

OTHER REQUIRED APPROVALS

Fire Dept. _____

Health Dept. _____

Appeal Board _____

Other _____

PERMIT ISSUED
FEB 7 2003
CITY OF PORTLAND

[Signature]
Director - Building & Inspection Services

LIABILITY FOR REMOVING THIS CARD

PERMIT ISSUED

City of Portland, Maine - Building or Use Permit Application

389 Congress Street, 04101 Tel: (207) 874-8703, Fax: (207) 874-8716

Permit No: 03-0069	Issue Date: FEB 7 2003	CBL: 310 C003001
-----------------------	----------------------------------	---------------------

Location of Construction: 60 Epping St	Owner Name: Legassie Edward J &	Owner Address: 60 Epping St	Phone: -578-2517
---	------------------------------------	--------------------------------	---------------------

Business Name: n/a	Contractor Name: Maine Window & Sunroom	Contractor Address: 71 Portland Rd. Kennebunk	Phone: 2079852300
-----------------------	--	--	----------------------

Lessee/Buyer's Name n/a	Phone: n/a	Permit Type: Alterations - Dwellings	Zone: R-3
----------------------------	---------------	---	---------------------

Past Use: Single Family	Proposed Use: Single Family / Enclose 12' x 16' existing deck with a sunroom.	Permit Fee: \$107.00	Cost of Work: \$11,500.00	CEO District: 1	1896 SF
----------------------------	--	-------------------------	------------------------------	--------------------	----------------

Proposed Project Description: Enclose existing 12' x 16' deck with a sunroom.	FIRE DEPT: <input type="checkbox"/> Approved <input type="checkbox"/> Denied <i>N/A</i>	INSPECTION: Use Group: R-3 Type: SB BOA 99
--	--	---

Signature: <i>[Signature]</i>	Signature: <i>[Signature]</i>
PEDESTRIAN ACTIVITIES DISTRICT (P.A.D.)	
Action: <input type="checkbox"/> Approved <input type="checkbox"/> Approved w/Conditions <input type="checkbox"/> Denied	
Signature:	Date:

Permit Taken By: gg	Date Applied For: 01/31/2003	Zoning Approval
------------------------	---------------------------------	------------------------

<ol style="list-style-type: none"> This permit application does not preclude the Applicant(s) from meeting applicable State and Federal Rules. Building permits do not include plumbing, septic or electrical work. Building permits are void if work is not started within six (6) months of the date of issuance. False information may invalidate a building permit and stop all work.. 	Special Zone or Reviews <input type="checkbox"/> Shoreland <input type="checkbox"/> Wetland <input type="checkbox"/> Flood Zone <input type="checkbox"/> Subdivision <input type="checkbox"/> Site Plan Maj <input type="checkbox"/> Minor <input type="checkbox"/> MM <input type="checkbox"/> Date: 2/7/03	Zoning Appeal <input type="checkbox"/> Variance <input type="checkbox"/> Miscellaneous <input type="checkbox"/> Conditional Use <input type="checkbox"/> Interpretation <input type="checkbox"/> Approved <input type="checkbox"/> Denied Date:	Historic Preservation <input checked="" type="checkbox"/> Not in District or Landmark <input type="checkbox"/> Does Not Require Review <input type="checkbox"/> Requires Review <input type="checkbox"/> Approved <input type="checkbox"/> Approved w/Conditions <input type="checkbox"/> Denied Date: 2/7/03
---	---	---	--

CERTIFICATION

I hereby certify that I am the owner of record of the named property, or that the proposed work is authorized by the owner of record and that I have been authorized by the owner to make this application as his authorized agent and I agree to conform to all applicable laws of this jurisdiction. In addition, if a permit for work described in the application is issued, I certify that the code official's authorized representative shall have the authority to enter all areas covered by such permit at any reasonable hour to enforce the provision of the code(s) applicable to such permit.

SIGNATURE OF APPLICANT ADDRESS DATE PHONE

RESPONSIBLE PERSON IN CHARGE OF WORK, TITLE DATE PHONE

All Purpose Building Permit Application

If you or the property owner owes real estate or personal property taxes or user charges on any property within the City, payment arrangements must be made before permits of any kind are accepted.

Location/Address of Construction: <u>60 Popping Street Portland, Me. 04103</u>		
Total Square Footage of Proposed Structure <u>192 Sq. Ft.</u>	Square Footage of Lot <u>10,634.4 square Ft.</u>	
Tax Assessor's Chart, Block & Lot Chart# <u>310</u> Block# <u>C</u> Lot# <u>003</u>	Owner: <u>Ed & Cynthia Legassie</u>	Telephone: <u>(207) 878-2517</u>
Lessee/Buyer's Name (If Applicable)	Applicant name, address & telephone: <u>MAINE WINDOW SUNROOM</u> <u>71 portland Rd. Kennebunk, Me. 04043</u> tele. # <u>985-2300</u>	Cost Of Work: \$ <u>11,500.00</u> Fee: \$ <u>107.00</u>
Current use: <u>Home. (2 story Dwelling)</u>		
If the location is currently vacant, what was prior use: _____		(Owes 107.00)
Approximately how long has it been vacant: _____		
Proposed use: <u>3 SEASON SUNROOM</u> Project description: <u>TO ENCLOSE A 12'X16' EXISTING DECK WITH A SUNROOM. (A-FRAME ROOM)</u>		
Contractor's name, address & telephone: Who should we contact when the permit is ready: <u>BRUCE MOORES MWS INC.</u> Mailing address: <u>71 portland Rd. Kennebunk, Me. 04043</u> Phone # <u>985-2300 X 132</u>		
We will contact you by phone when the permit is ready. You must come in and pick up the permit and review the requirements before starting any work, with a Plan Reviewer. A stop work order will be issued and a \$100.00 fee if any work starts before the permit is picked up. PHONE:		

IF THE REQUIRED INFORMATION IS NOT INCLUDED IN THE SUBMISSIONS THE PERMIT WILL BE AUTOMATICALLY DENIED AT THE DISCRETION OF THE BUILDING/PLANNING DEPARTMENT, WE MAY REQUIRE ADDITIONAL INFORMATION IN ORDER TO APPROVE THIS PERMIT.

I hereby certify that I am the Owner of record of the named property, or that the owner of record authorizes the proposed work and that I have been authorized by the owner to make this application as his/her authorized agent. I agree to conform to all applicable laws of this jurisdiction. In addition, if a permit for work described in this application is issued, I certify that the Code Official's authorized representative shall have the authority to enter all areas covered by this permit at any reasonable hour to enforce the provisions of the codes applicable to this permit.

Signature of applicant: <u>Bruce Moore MWS INC.</u>	Date: _____
---	-------------

This is NOT a permit, you may not commence ANY work until the permit is issued.
If you are in a Historic District you may be subject to additional permitting and fees with the Planning Department on the 4th floor of City Hall

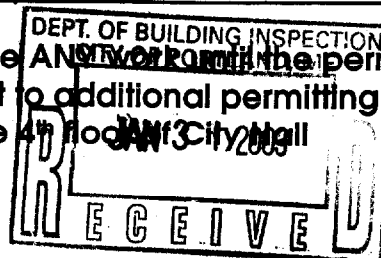

TABLE 1: LOAD/SPAN TABLE FOR HONEYCOMB CORE PANELS

PANEL SPAN (ft)	PANEL CONFIG.	ALLOWABLE LIVE ROOF LOADS FOR HONEYCOMB (HC) PANELS								
		20 psf	25 psf	30 psf	35 psf	40 psf	45 psf	50 psf	55 psf	60 psf
8	3" HC
8	3" HC + H
8	4.5" HC
8	4.5" HC + H
8	6" HC
8	6" HC + H
9	3" HC
9	3" HC + H
9	4.5" HC
9	4.5" HC + H
9	6" HC
9	6" HC + H
10	3" HC
10	3" HC + H + SKY
10	3" HC + H
10	4.5" HC
10	4.5" HC + H
10	6" HC
10	6" HC + H
11	3" HC
11	3" HC + H + SKY
11	3" HC + H
11	4.5" HC
11	4.5" HC + H
11	6" HC
11	6" HC + H
12	3" HC
12	3" HC + H + SKY
12	3" HC + H
12	4.5" HC
12	4.5" HC + H + SKY
12	4.5" HC + H
12	6" HC
12	6" HC + H
13	3" HC
13	3" HC + H + SKY
13	3" HC + H
13	4.5" HC
13	4.5" HC + H + SKY
13	4.5" HC + H
13	6" HC
13	6" HC + H

(Continued next page)



Edward Legassie
600 Epping St.
Portland, ME. 04103

"We Treat Your Home Like Our Own."

R-3
8' sides
25' front
+
Rear
OK

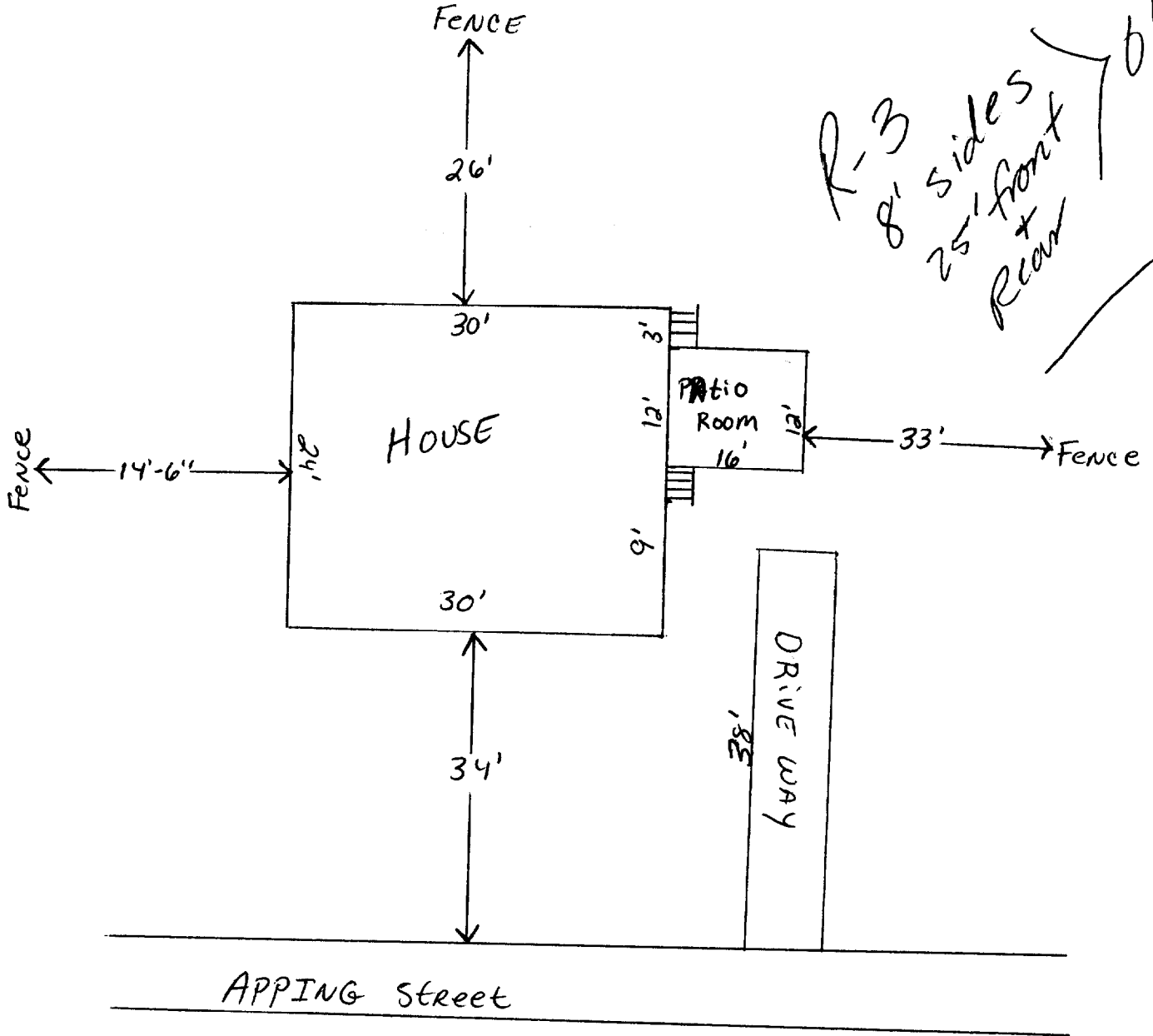

Established 1989