



02-0541

# All Purpose Building Permit Application

If you or the property owner owes real estate or personal property taxes or user charges on any property within the City, payment arrangements must be made before permits of any kind are accepted.

Location/Address of Construction: <u>4 Wyndham St. Portland 04103</u>		
Total Square Footage of Proposed Structure	Square Footage of Lot <u>8,000 ft.</u>	
Tax Assessor's Chart, Block & Lot Chart# <u>309</u> Block# <u>D</u> Lot# <u>35</u>	Owner: <u>Geraldine Miller</u>	Telephone: <u>797-2111</u>
Lessee/Buyer's Name (If Applicable)	Applicant name, address & telephone: <u>4 Wyndham St.</u> <u>797-2111</u>	Cost Of Work: \$ <u>3,500</u> Fee: \$ <u>51.00</u>
What size is the pool: <u>27' Round</u> Above or below ground: <u>Above</u>		
Dimensions of decking and/or platforms: <u>52" high pool</u>		
Contractor's name, address & telephone: <u>Nick's Pools E. Waterboro 247-5915</u>		
Who should we contact when the permit is ready: <u>Geri Miller</u>		
Mailing address: <u>4 Wyndham St.</u> <u>Portland 04103 797-2111</u>		
We will contact you by phone when the permit is ready. You must come in and pick up the permit and review the requirements before starting any work, with a Plan Reviewer. A stop work order will be issued and a \$100.00 fee if any work starts before the permit is picked up. <b>PHONE:</b>		

IF THE REQUIRED INFORMATION IS NOT INCLUDED IN THE SUBMISSIONS THE PERMIT WILL BE AUTOMATICALLY DENIED AT THE DISCRETION OF THE BUILDING/PLANNING DEPARTMENT, WE MAY REQUIRE ADDITIONAL INFORMATION IN ORDER TO APPROVE THIS PERMIT.

I hereby certify that I am the Owner of record of the named property, or that the owner of record authorizes the proposed work and that I have been authorized by the owner to make this application as his/her authorized agent. I agree to conform to all applicable laws of this jurisdiction. In addition, if a permit for work described in this application is issued, I certify that the Code Official's authorized representative shall have the authority to enter all areas covered by this permit at any reasonable hour to enforce the provisions of the codes applicable to this permit.

Signature of applicant: <u>Geraldine Miller</u>	Date: <u>5/17/02</u>
---	----------------------

This is NOT a permit; you may not commence ANY work until the permit is issued. If you are in a Historic District you may be subject to additional permitting and fees with the Planning Department on the 4<sup>th</sup> floor of City Hall

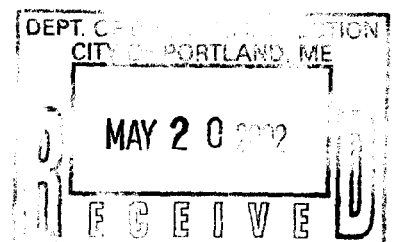

# ABOVE GROUND POOL CONSTRUCTION MATERIALS CHART

## SUGGESTED QUANTITIES NEEDED BY POOL SIZE

Pool Size	Tons Sand	Yard Sand	Support Post Blocks
15' round	2.0	1.25	10
18' round	2.5	1.75	12
21' round	3.5	2.25	14
24' round	4.5	3.00	16
27' round	5.5	3.75	18
30' round	7.0	4.75	20
12'x18'	2.0	1.25	18
12'x20'	2.5	1.75	18
15'x24'	3.5	2.25	26 Atlantic (HA)
15'x25'	3.5	2.25	18 Asahi (CP)
15'x30'	4.0	2.75	34 Atlantic (HA)
15'x30'	4.0	2.75	22 Asahi (CP)
18'x33'	5.5	3.50	36 Atlantic (HA)
18'x33'	5.5	3.50	24 Asahi (CP)

## ESTIMATED WATER CAPACITY BY POOL SIZE

	52" Pools	48" Pools
15' round	5,300 gallons	4,850 gallons
18' round	7,630 gallons	7,000 gallons
21' round	10,385 gallons	9,500 gallons
24' round	13,500 gallons	12,500 gallons
27' round	17,200 gallons	15,750 gallons
30' round	21,200 gallons	N/A
12'x18' oval	5,550 gallons	5,100 gallons
12'x20' oval	6,250 gallons	5,750 gallons
15'x24' oval	9,350 gallons	8,570 gallons
15'x25' oval	9,800 gallons	9,000 gallons
15'x30' oval	12,000 gallons	11,000 gallons
18'x33' oval	15,730 gallons	14,420 gallons

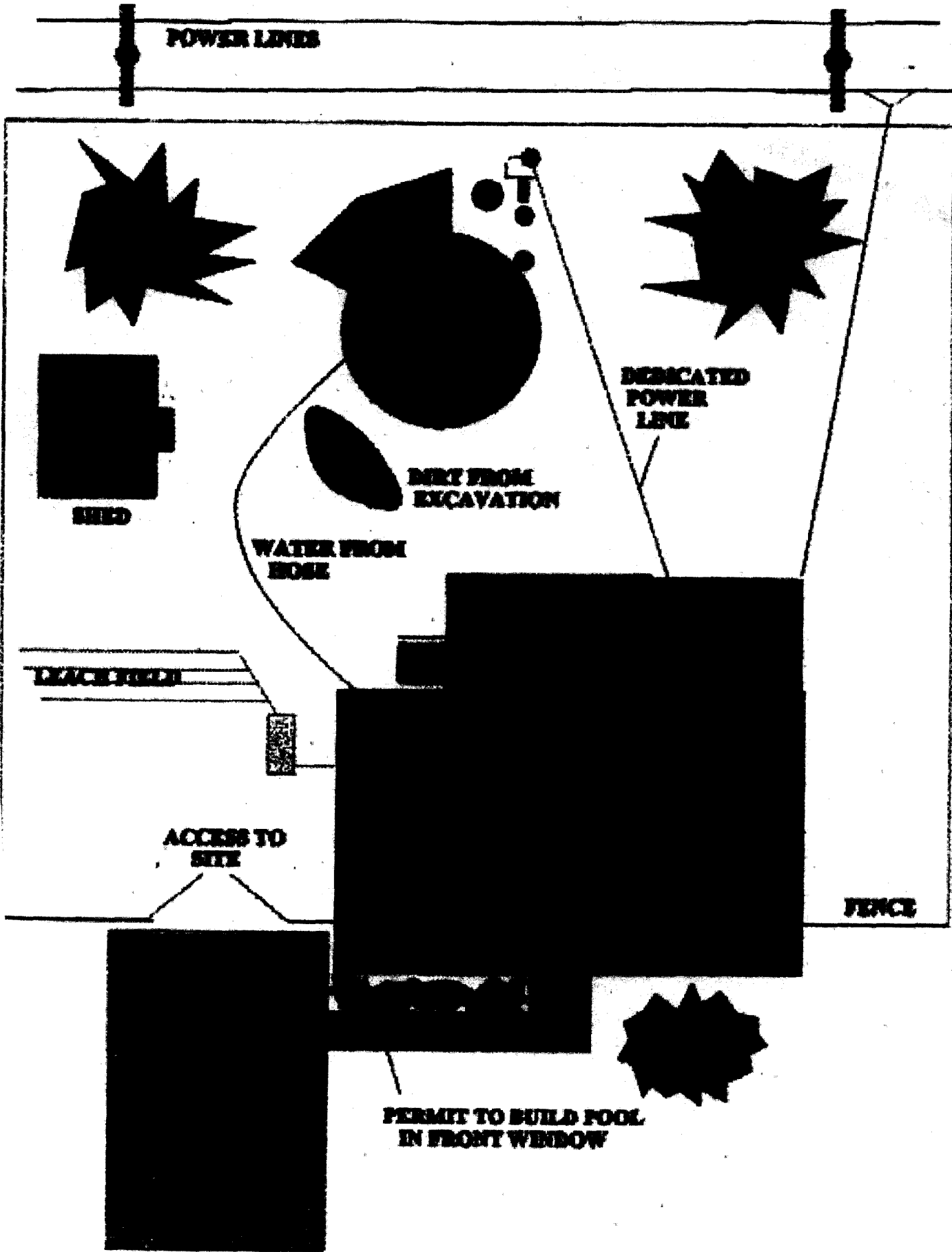

## **SITE PLANNING GUIDE**

This is intended to be a general site planning guideline and is not intended to replace the instructions provided by the manufacturer. Consult your local building department for the rules and regulations governing above ground pool installations for specific site planning requirements.

- Access for Crew and Machinery:** If insufficient, work will need to be done manually and at additional cost for the additional labor involved.
- Site Slope or Grade of Yard:** Could entail additional excavation and may affect safety codes and require the addition of fencing around the pool or yard.
- Tree and Shrub Root Systems:** Will need to be dealt with by the installer at the time of installation and may result in additional cost if severe enough.
- Convenience and Safety of Location:** After all, it is intended to be fun! Choose a spot where supervision is not compromised or sacrificed whenever possible.
- Deck Location and Equipment Location:** Position the deck to receive the optimum amount of sun, and the filter where it will be most aesthetic and functional.
- Electrical Supply Source for the Filter:** Position the filter where desired and then run the proper 110 Volt/20-30 Amp dedicated line from GFCI breaker underground and to code.
- Sod and Excess Dirt Dispersal on Site:** The earth that was there will still be there! Identify an area to fill in. All yards have at least one. Installer is typically not responsible for this.
- Awareness of Underground Septic/Leaching Systems:** In areas without sewage systems, you will need to position pool away from such underground systems.
- Overhead Power Lines:** Another item pools must be positioned away from. Consult your local building department for specifics, but generally, you must be at least ten (10) feet away.
- Rear and Side Property Lines:** In accord with zoning in your area, you must position the pool the proper distance away from side and end lot lines at a maximum as locally specified.
- Local Building Permits:** In most areas today, a permit is necessary prior to installing your pool. Along with a permit, and electrical inspection of the wiring to the filter may be required.
- Availability of Water to Fill the Pool:** Filling via a garden hose is preferred, but in some area this may not be possible or practical, thus, water will need to be trucked in at your expense.
- Site Finish Work and Around the Pool Beautification:** Completion of your perfect outdoor entertainment environment is yours to pursue limited only by your imagination. ENJOY!

w/ pool 775.<sup>00</sup>  
w/o pool

# CONFER PLASTICS' POOL ENTRY SYSTEM

*A new approach to the age-old problem.*

*The unique design of the pool entry system allows two units to be joined together to form a complete entry/exit system into the pool.*

- Meets current and proposed ANSI/NSPI Standards.
- Easy assembly; steps and risers snap into side panels and are held in place with plastic wedges. No metal parts.
- Bottom riser plate adjusts to fit 48" to 54" tall pools and decks
- Does not rest on or attach to pool.
- All-plastic construction will not affect water chemistry and will not corrode.
- Ventilation holes allow water to circulate through unit to prevent algae growth.
- Non-slip step surfaces.
- Optional gate available for attachment to outside unit to restrict access to the pool.
- Includes deck connector for easy attachment to deck.

#### **SPECIFICATIONS:**

Overall Projection into pool - 36"  
Overall Height - 81" (plus up to 6" adjustability)  
Overall Width - 31"  
Step - 10" x 27"  
Top Platform - 12" x 27"  
Hand rail height (from ground level) - 45"  
Riser Height - 11"

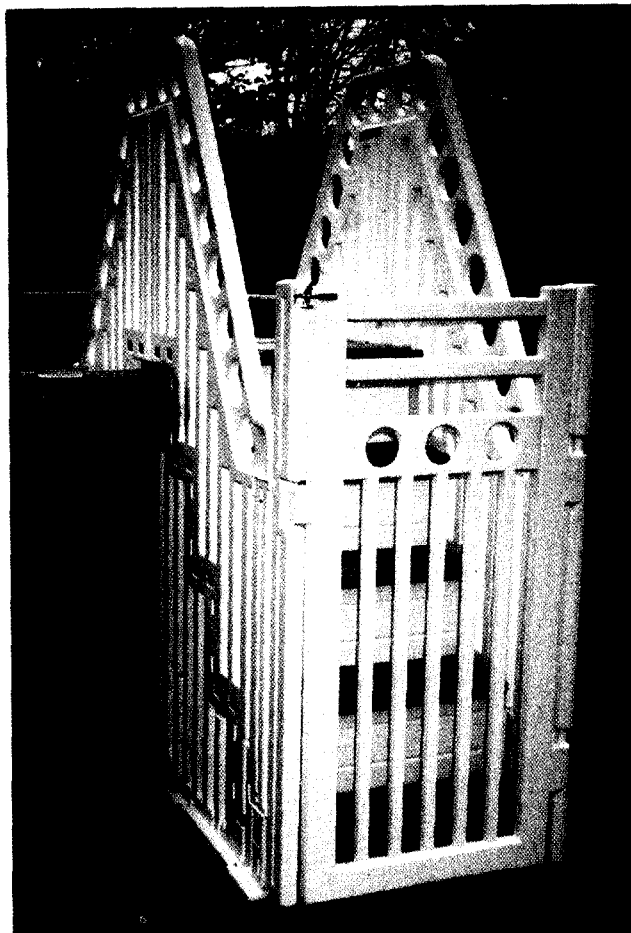

#### **Available at:**

**GLAMOUR POOLS**  
23 Bridgton Rd. • (Rt. 302)  
Westbrook, ME 04092  
(207) 878-9060



Witmer & River Rds., P.O. Box 217  
North Tonawanda, NY 14120  
Toll Free 1-800-635-3213 (716) 694-3100 Fax: (716) 694-3102

PRODUCT AND SPECIFICATIONS SUBJECT TO CHANGE WITHOUT NOTICE.  
PATENT #5,244,291  
PATENTS PENDING  
PRINTED IN U.S.A.

PES-1  
REV 7/97

Aldworth Street

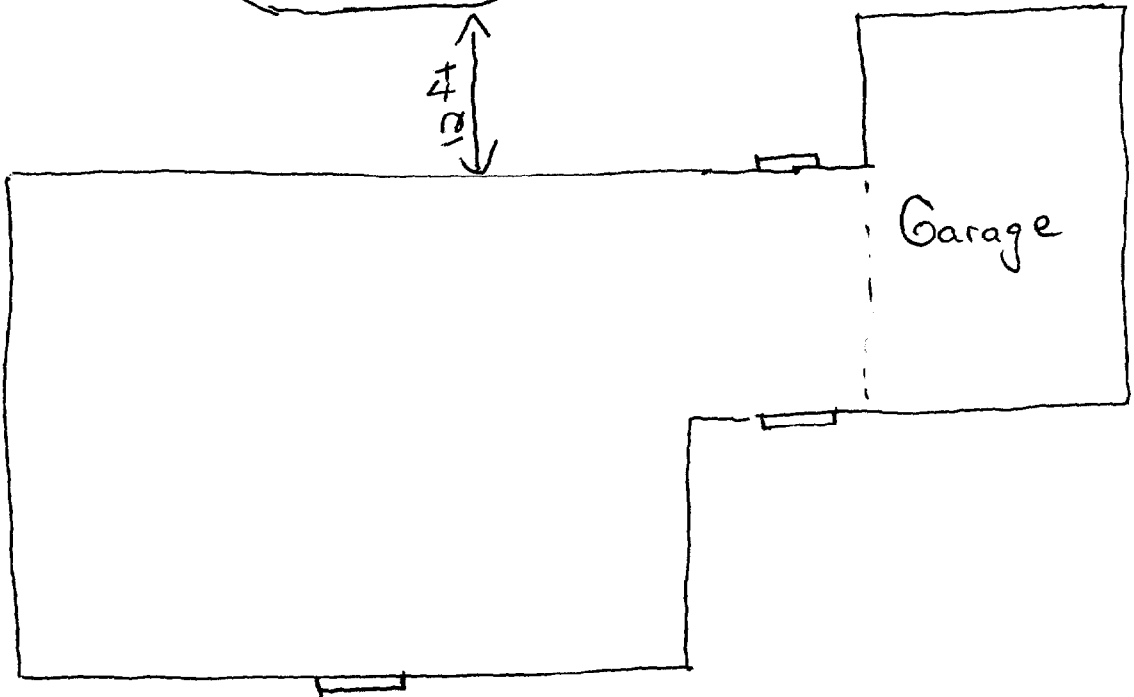
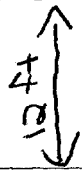
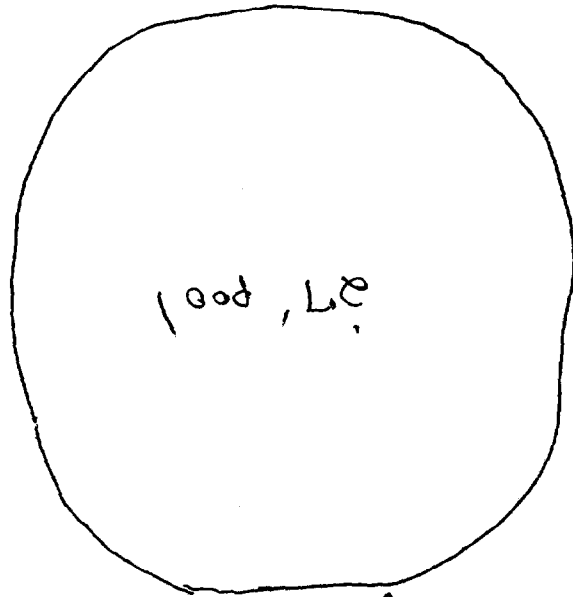

55 ft.

100 ft.

(#4)  
Wyndham Street

80 ft. →