

Inside Duct run Exhaust/make up air

1900 T110

16 ga galu steel grease solid welded Then wrap in 3m grease duct wrap  
from Hood up through Curb.

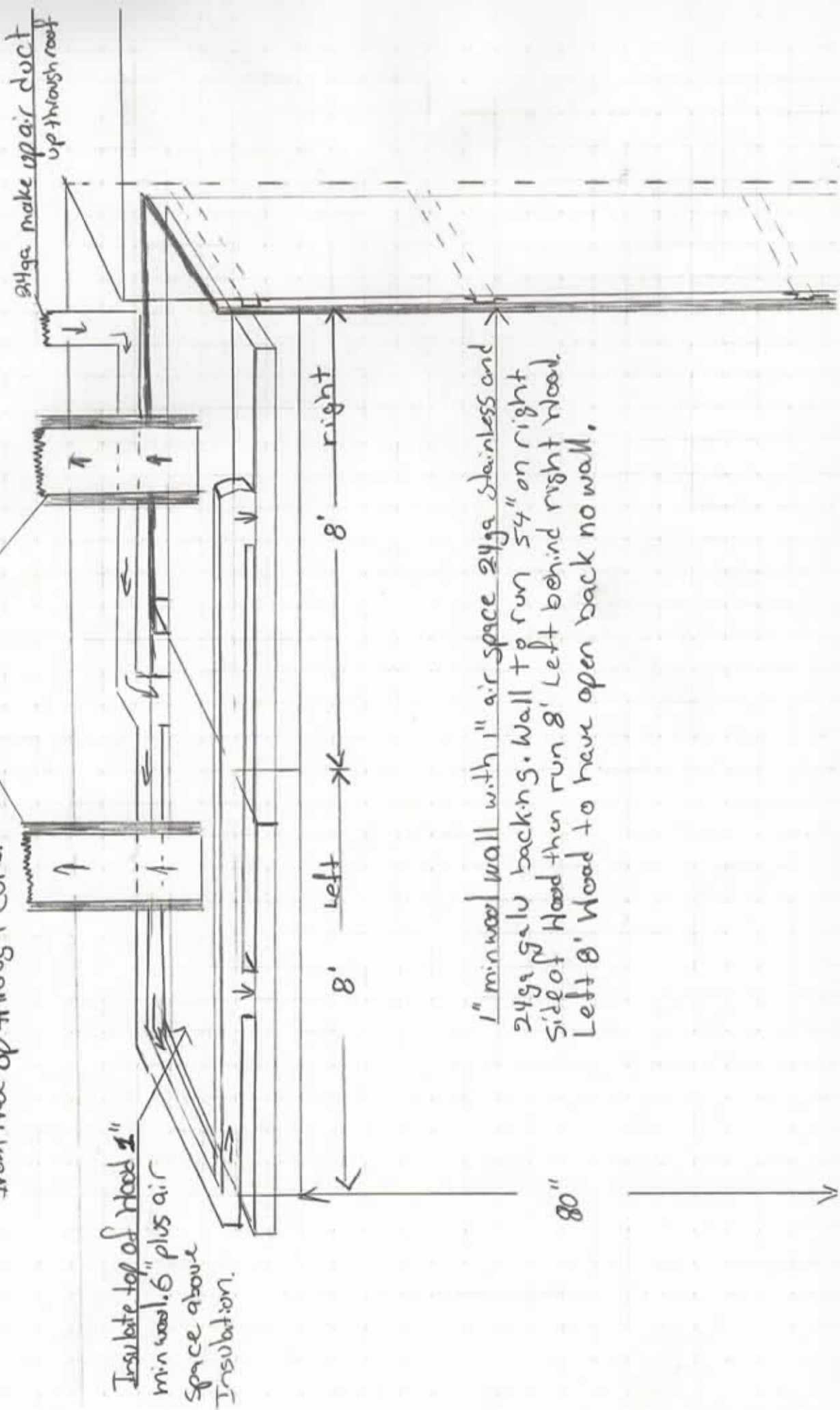

Insulate top of Hood 1"  
min wool. 6" plus air  
space above  
Insulation.

8' left

8' right

1" min wood wall with 1" air space 24ga stainless and  
24ga galu backing. Wall to run 54" on right  
side of Hood then run 8' Left behind right Hood.  
Left 8' Hood to have open back no wall.

80"