

DISPLAY THIS CARD ON PRINCIPAL FRONTAGE OF WORK



CITY OF PORTLAND BUILDING PERMIT



This is to certify that

BRIGHTON AVENUE PROPERTIES INC /Tim Davis
Plumbing & Heating

Located at

16 CASTINE AVE

PERMIT ID: 2013-00476 **ISSUE DATE:** 04/09/2013 **CBL:** 309 E010001

has permission to **HVAC; install Navien CH180**

provided that the person or persons, firm or corporation accepting this permit shall comply with all of the provisions of the Statues of Maine and of the Ordinances of the City of Portland regulating the construction, maintenance and use of the buildings and structures, and of the application on file in the department.

Notification of inspection and written permission procured before this building or part thereof is lathed or otherwise cloed-in. 48 HOUR NOTICE IS REQUIRED.

A final inspection must be completed by owner before this building or part thereof is occupied. If a certificate of occupancy is required, it must be procured prior to occupancy.

Fire Prevention Officer

Code Enforcement Officer / Plan Reviewer

**THIS CARD MUST BE POSTED ON THE STREET SIDE OF THE PROPERTY
THERE IS A PENALTY FOR REMOVING THIS CARD**

SCANNED

BUILDING PERMIT INSPECTION PROCEDURES
Please call 874-8703 (ONLY)
or email: buildinginspections@portlandmaine.gov

With the issuance of this permit, the owner, builder or their designee is required to provide adequate notice to the city of Portland Inspections Services for the following inspections. Appointments must be requested 48 to 72 hours in advance of the required inspection. The inspection date will need to be confirmed by this office.

- **Please read the conditions of approval that is attached to this permit!! Contact this office if you have any questions.**
- **Permits expire in 6 months. If the project is not started or ceases for 6 months.**
- **If the inspection requirements are not followed as stated below additional fees may be incurred due to the issuance of a "Stop Work Order" and subsequent release to continue.**

REQUIRED INSPECTIONS:

The project cannot move to the next phase prior to the required inspection and approval to continue, REGARDLESS OF THE NOTICE OF CIRCUMSTANCES.

IF THE PERMIT REQUIRES A CERTIFICATE OF OCCUPANCY, IT MUST BE PAID FOR AND ISSUED TO THE OWNER OR DESIGNEE BEFORE THE SPACE MAY BE OCCUPIED.

City of Portland, Maine - Building or Use Permit

389 Congress Street, 04101 Tel: (207) 874-8703, Fax: (207) 874-8716

Permit No: 2013-00476	Date Applied For: 03/12/2013	CBL: 309 E010001
---------------------------------	--	----------------------------

Location of Construction: 16 CASTINE AVE	Owner Name: BRIGHTON AVENUE PROPERTI	Owner Address: PO BOX 10127	Phone:
Business Name:	Contractor Name: Tim Davis Plumbing & Heating	Contractor Address: P.O. Box 255 Lyman	Phone (207) 324-5237
Lessee/Buyer's Name	Phone:	Permit Type: HVAC	

Proposed Use: New Single Family	Proposed Project Description: HVAC; install Navien CH180
---	--

Dept: Zoning	Status: Approved	Reviewer: Ann Machado	Approval Date: 03/12/2013
Note:			Ok to Issue: <input checked="" type="checkbox"/>
Dept: Building	Status: Approved w/Conditions	Reviewer: Tammy Munson	Approval Date: 04/03/2013
Note:			Ok to Issue: <input checked="" type="checkbox"/>

1) The installation must comply with the State of Maine Gas Regulations.

City of Portland, Maine - Building or Use Permit Application

389 Congress Street, 04101 Tel: (207) 874-8703, Fax: (207) 874-8716

Permit No: 2013-00476	Issue Date:	CBL: 309 E010001
---------------------------------	--------------------	----------------------------

Location of Construction: 16 CASTINE AVE	Owner Name: BRIGHTON AVENUE PROPERTIES INC	Owner Address: PO BOX 10127 PORTLAND , ME 04104		Phone:
Business Name:	Contractor Name: Tim Davis Plumbing & Heating	Contractor Address: P.O. Box 255 Lyman ME 04002		Phone (207) 324-5237
Lessee/Buyer's Name	Phone:	Permit Type: HVAC		Zone: R3
Past Use: New Single Family	Proposed Use: New Single Family	Permit Fee: \$60.00	Cost of Work: \$4,000.00	CEO District: 8
		FIRE DEPT: <input type="checkbox"/> Approved <input checked="" type="checkbox"/> Denied <input checked="" type="checkbox"/> N/A Signature: <i>[Signature]</i>		INSPECTION: Use Group: R-3 Type: SB <i>[Signature]</i>
Proposed Project Description: HVAC; install Navien CH180		PEDESTRIAN ACTIVITIES DISTRICT (P.A.D.) Action: <input type="checkbox"/> Approved <input type="checkbox"/> Approved w/Conditions <input type="checkbox"/> Denied Signature: _____ Date: _____		

Permit Taken By: bjs	Date Applied For: 03/12/2013	Zoning Approval	
--------------------------------	--	------------------------	--

1. This permit application does not preclude the Applicant(s) from meeting applicable State and Federal Rules. 2. Building permits do not include plumbing, septic or electrical work. 3. Building permits are void if work is not started within six (6) months of the date of issuance. False information may invalidate a building permit and stop all work..	Special Zone or Reviews <input type="checkbox"/> Shoreland <input type="checkbox"/> Wetland <input type="checkbox"/> Flood Zone <input type="checkbox"/> Subdivision <input type="checkbox"/> Site Plan Maj <input type="checkbox"/> Minor <input type="checkbox"/> MM <input type="checkbox"/> Date: <i>OK 3/12/13</i> <i>[Signature]</i>	Zoning Appeal <input type="checkbox"/> Variance <input type="checkbox"/> Miscellaneous <input type="checkbox"/> Conditional Use <input type="checkbox"/> Interpretation <input type="checkbox"/> Approved <input type="checkbox"/> Denied Date: _____	Historic Preservation <input checked="" type="checkbox"/> Not in District or Landmark <input type="checkbox"/> Does Not Require Review <input type="checkbox"/> Requires Review <input type="checkbox"/> Approved <input type="checkbox"/> Approved w/Conditions <input type="checkbox"/> Denied Date: <i>[Signature]</i>
--	--	---	---

CERTIFICATION

I hereby certify that I am the owner of record of the named property, or that the proposed work is authorized by the owner of record and that I have been authorized by the owner to make this application as his authorized agent and I agree to conform to all applicable laws of this jurisdiction. In addition, if a permit for work described in the application is issued, I certify that the code official's authorized representative shall have the authority to enter all areas covered by such permit at any reasonable hour to enforce the provision of the code(s) applicable to such permit.

SIGNATURE OF APPLICANT	ADDRESS	DATE	PHONE
RESPONSIBLE PERSON IN CHARGE OF WORK, TITLE		DATE	PHONE



FILL IN AND SIGN WITH INK

APPLICATION FOR PERMIT HEATING OR POWER EQUIPMENT

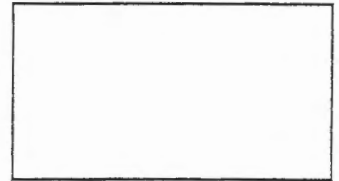

to the INSPECTOR OF BUILDINGS, PORTLAND, ME.

The undersigned hereby applies for a permit to install the following heating, cooking or power equipment in accordance with the Laws of Maine, the Building Code of the City of Portland, and the following specifications:

Location / CBL 16 Castine St Use of Building Residential Date 3/12/13
Name and address of owner of appliance Duvas Eric Properties

Installer's name and address Tim Davis Plumbing & Heating Inc. tdp@inc@yahoo.com
P.O. Box 255 Lyman, ME 04002 Telephone 207-324-5237

Location of appliance:

Basement Floor
 Attic Roof

Type of Fuel:

Gas Oil Solid

Appliance Name: NAVIERU CH180

U.L. Approved Yes No

Will appliance be installed in accordance with the manufacture's installation instructions? Yes No

IF NO Explain: _____

Type of Chimney:

Masonry Lined
Factory built _____

Metal
Factory Built U.L. Listing # _____

Direct Vent
Type PVC sch 40 UL# 5

Type of Fuel Tank

Oil
 Gas

Size of Tanks 100 GAL

Number of Tanks 2

Distance from Tank to Center of Flame outside feet.

Cost of Work: \$ 4,000.00

Permit Fee: \$ 60

RECEIVED
MAR 12 2013

Dept. of Building Inspection
City of Portland, Maine

Approved

Approved with Conditions

Fire: _____

See attached letter or requirement

Ele.: _____

Bldg.: _____

Inspector's Signature

Date Approved

Signature of Installer _____

White - Inspection

Yellow - File

Pink - Applicant's

Gold - Assessor's Copy

CASTINE ST

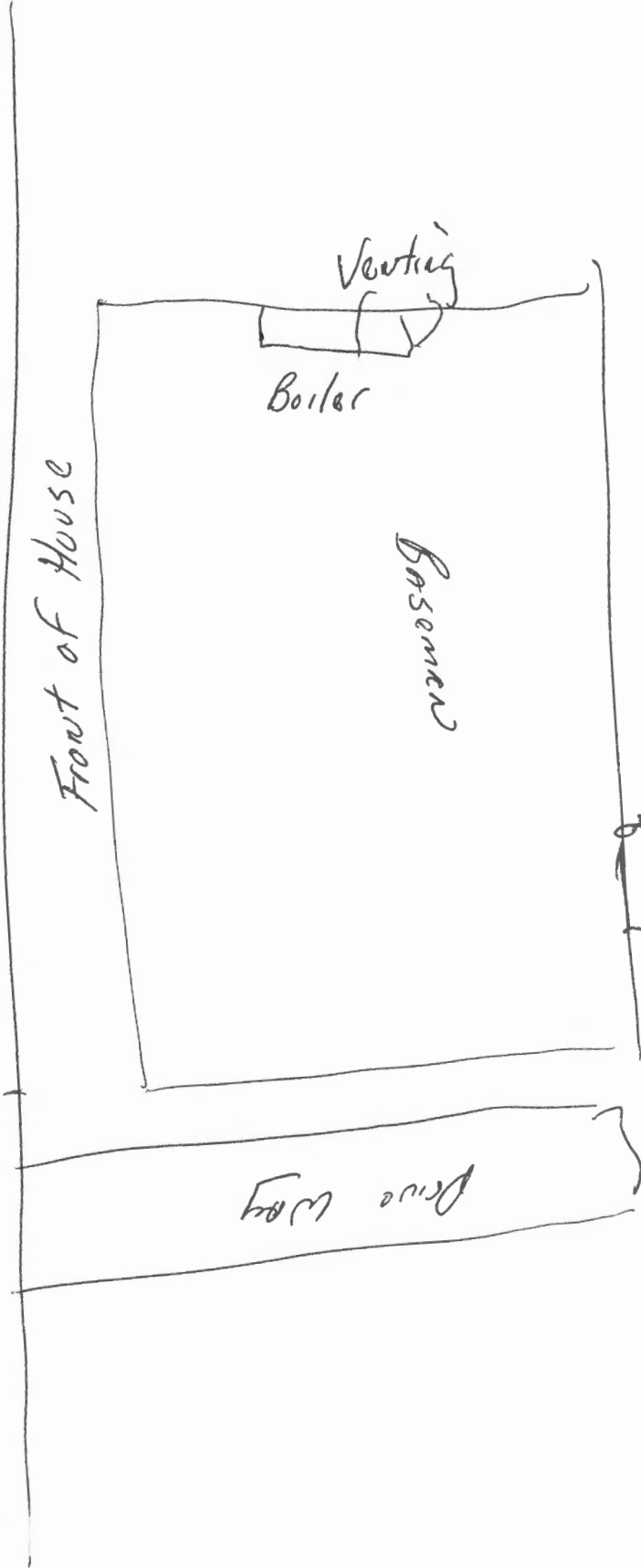

1/6 CASTINE
Bike Rack
Tanks

Condensing **NAVIENT**

Navigating Energy and Environment

Installation Manual

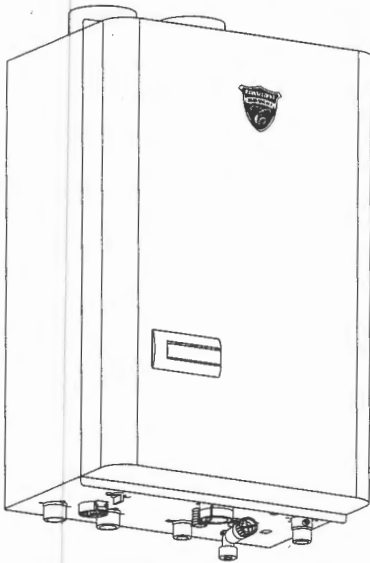

For potable water heating and space heating



CH-180 ASME MODEL
CH-210 ASME
CH-240 ASME

Keep this manual near the navien Combination Boiler for future reference whenever maintenance or service is required.

⚠ WARNING

If the information in this manual is not followed exactly, a fire or explosion may result causing property damage, personal injury or loss of life.

- Do not store or use gasoline or other flammable vapors and liquids in the vicinity of this or other appliance.
- **WHAT TO DO IF YOU SMELL GAS**
 - Do not try to light any appliance.
 - Do not touch any electrical switch; do not use any phone in your building.
 - Immediately call your gas supplier from a neighbor's phone. Follow the gas supplier's instructions.
 - If you cannot reach your gas supplier, call the fire department.
- Installation and service must be performed by a qualified installer, service agency or the gas supplier.

⚠ CAUTION

This product warranty is valid only used in the America and Canada but automatically be voided for other countries. (for America and Canada unit standard only)

Please return the "Installation Manual" to the customer after installing.

Navien Gas Combination Boiler
Installation Manual

CASTINE ST

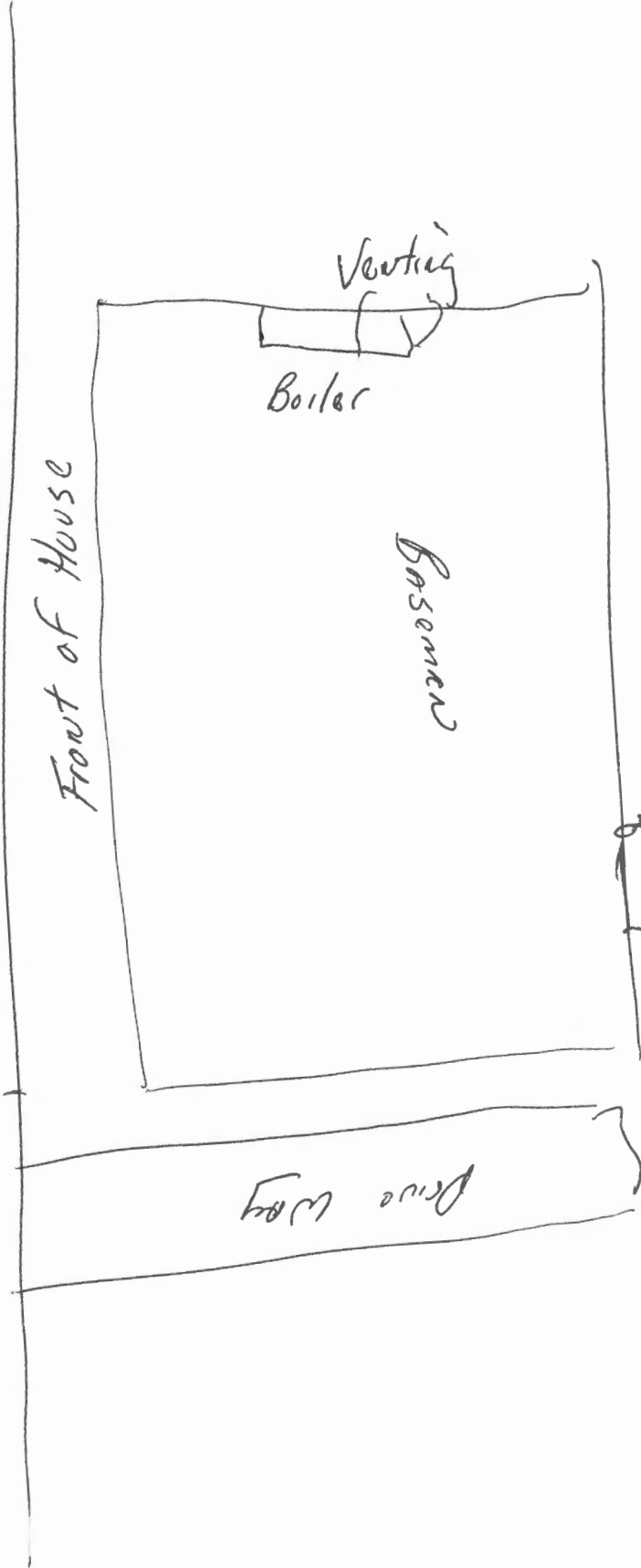

Bike Rack

1/6 CASTINE

Tanks