

SITE AND UTILITY PLAN
1"=20'

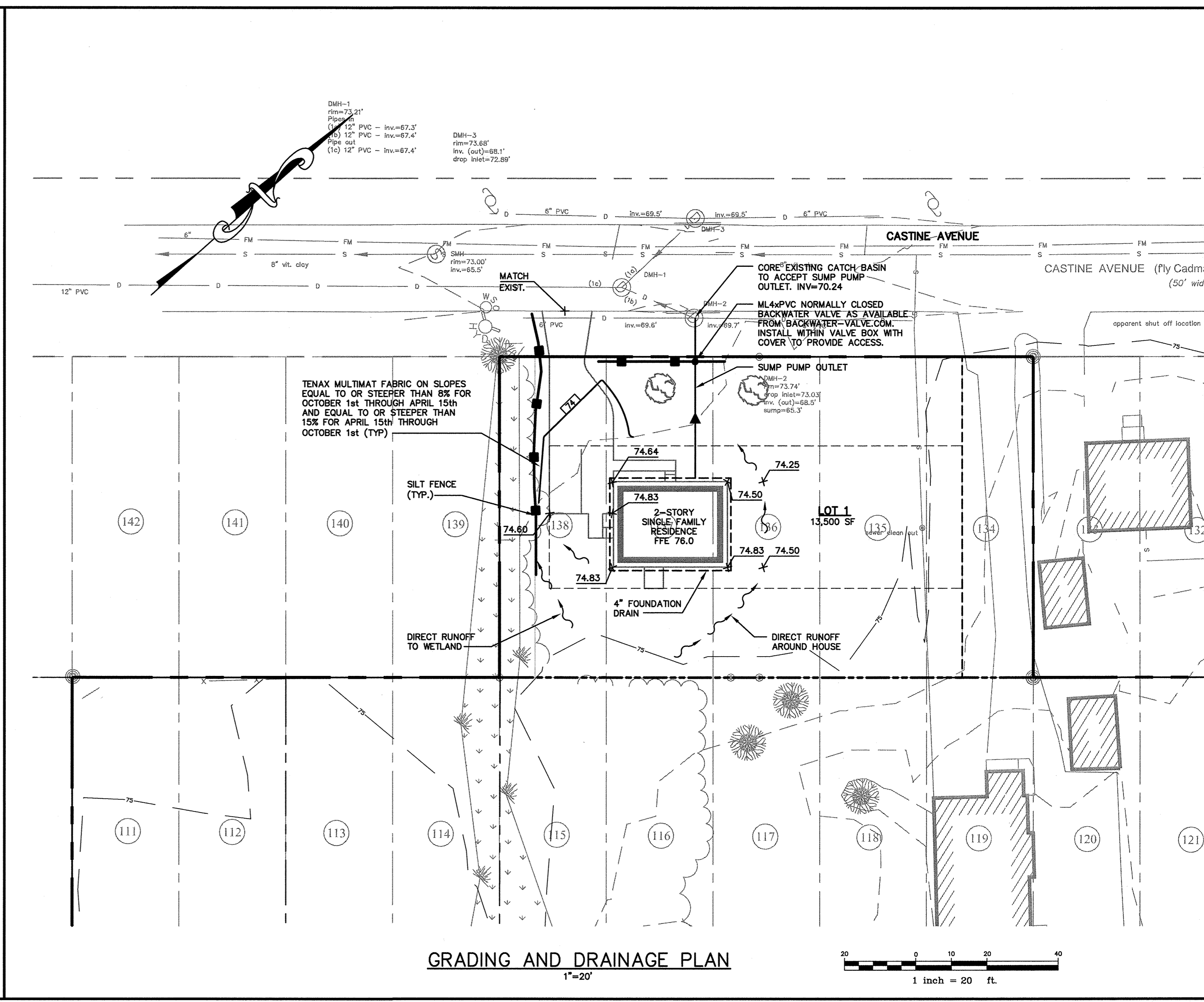

GRADING AND DRAINAGE PLAN
1"=20'

SPACE AND BULK REQUIREMENTS - R3 ZONE

MINIMUM LOT SIZE:	6,500 S.F.
MINIMUM FRONTAGE:	50 FT.
MINIMUM SETBACKS:	
FRONT YARD	25 FT.
REAR YARD	25 FT.
SIDE YARD*	
1 STORY	8 FT.
1 1/2 STORY	8 FT.
2 STORY	14 FT.
2 1/2 STORY	16 FT.
MINIMUM LOT WIDTH:	
OTHER USES:	65 FT.

* THE WIDTH OF ONE (1) SIDE YARD MAY BE REDUCED ONE (1) FOOT FOR EVERY FOOT THAT THE OTHER SIDE YARD IS CORRESPONDINGLY INCREASED, BUT NO SIDE YARD SHALL BE LESS THAN EIGHT (8) FEET IN WIDTH.

GRADING AND DRAINAGE NOTES:

1. ALL DISTURBED AREAS THAT ARE NOT PAVED SHALL RECEIVE 4" LOAM & SEED.
2. COMMON BORROW SHALL MEET MDOT SPECIFICATION 703.18.
3. FOUNDATION DRAIN SHALL BE DIRECTED TO SUMP LOCATED WITHIN BUILDING.
4. THE GRADING AND DRAINAGE SYSTEM ON THE PROPERTY SHALL BE CONSTRUCTED AND LOCATED AS DEPICTED ON THE APPROVED SITE PLAN AND SAID GRADING AND DRAINAGE SYSTEM SHALL NOT BE MODIFIED WITHOUT FURTHER APPROVAL FROM THE PLANNING AUTHORITY.

GENERAL NOTES

1. TOPOGRAPHIC DATA AND EXISTING CONDITIONS ARE BASED UPON A GROUND SURVEY CONDUCTED BY TITCOMB ASSOCIATES IN FEBRUARY 2007.
2. THE CONTRACTOR IS SPECIFICALLY CAUTIONED THAT THE LOCATION AND/OR THE ELEVATION OF THE EXISTING UTILITIES AS SHOWN ON THESE PLANS IS BASED ON RECORDS OF THE VARIOUS UTILITY COMPANIES AND WHERE POSSIBLE MEASUREMENTS TAKEN IN THE FIELD. THIS INFORMATION IS NOT TO BE RELIED ON AS BEING EXACT OR COMPLETE. THE CONTRACTOR MUST CALL THE APPROPRIATE UTILITY COMPANY AND DIG SAFE AT LEAST 72 HOURS PRIOR TO ANY EXCAVATION TO REQUEST EXACT FIELD LOCATION OF UTILITIES. IT SHALL BE THE RESPONSIBILITY OF THE CONTRACTOR TO RELOCATE ALL EXISTING UTILITIES WHICH CONFLICT WITH THE PROPOSED IMPROVEMENTS SHOWN ON THE PLANS.
3. MAINTENANCE OF EROSION CONTROL MEASURES IS OF PARAMOUNT IMPORTANCE TO THE OWNER AND THE CONTRACTOR IS RESPONSIBLE FOR COMPLYING WITH ALL EROSION CONTROL MEASURES SHOWN ON THE PLANS. ADDITIONAL EROSION CONTROL MEASURES SHALL BE INSTALLED IF DETERMINED NECESSARY BY ON-SITE INSPECTIONS OF THE OWNER OR THEIR REPRESENTATIVES AT NO ADDITIONAL COST TO THE OWNER.
4. ALL WATER UTILITY MATERIALS AND INSTALLATION METHODS SHALL CONFORM TO PORTLAND WATER DISTRICT STANDARDS. DISINFECTION OF WATER LINES SHALL CONFORM TO AWWA STANDARD C651, LATEST REVISION.
5. ALL SEWER MATERIALS SHALL CONFORM TO THE REQUIREMENTS OF THE CITY OF PORTLAND TECHNICAL AND DESIGN STANDARDS AND GUIDELINES.
6. ALL MATERIALS AND CONSTRUCTION METHODS SHALL CONFORM TO MAINE DEPARTMENT OF TRANSPORTATION SPECIFICATIONS, AND CITY OF PORTLAND TECHNICAL AND DESIGN STANDARDS AND GUIDELINES.
7. LOT OWNER IS RESPONSIBLE FOR LAYOUT AND EXTENSION OF ELECTRIC SERVICE, COORDINATE WITH CMP.
8. THE LOT SHALL BE PROVIDED WITH AT LEAST TWO (2) TREES MEETING THE CITY'S ARBORICULTURE SPECIFICATIONS AND WHICH ARE CLEARLY VISIBLE FROM THE STREET LINE AND ARE LOCATED SO AS TO VISUALLY WIDEN THE NARROW DIMENSION OR PROPORTION OF THE UNIT.
9. SEWER AND WATER SERVICES SHALL BE INSTALLED BY THE DEVELOPER 5' INTO THE PROPERTY. CONNECTION TO THE HOUSE WILL BE THE RESPONSIBILITY OF THE LOT OWNER.
10. EQUIVALENT STREET TREE SHALL INCLUDE RETENTION OF EXISTING TREES OF SAME OR GREATER CALIPER.
11. ALL WORK SHALL BE DONE IN CONFORMANCE WITH THE CITY OF PORTLAND TECHNICAL STANDARDS, SECTION VII EROSION AND SEDIMENTATION CONTROL STANDARDS FOR SINGLE AND TWO FAMILY HOMES.
12. ANY CURBING REMOVED WITHIN THE RIGHT-OF-WAY IS THE PROPERTY OF THE CITY OF PORTLAND AND SHALL BE DELIVERED TO THE PUBLIC WORKS FACILITY ON OUTER CONGRESS STREET.

NOTE: THIS PLAN SET IS ISSUED FOR PERMITTING PURPOSES AND SHALL NOT BE USED FOR CONSTRUCTION.

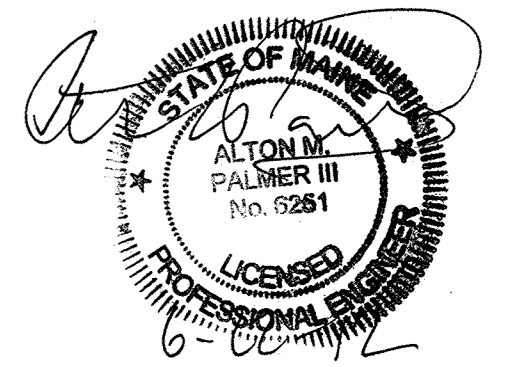

S:\Land Projects\1721\dwg\1721-pbase.dwg 6/22/2012 10:31 AM

Rev.	Date	Revision

CITY REVIEW	Date	AMP
	06-22-12	AMP

Design: JWA	Draft: CG	Date: JUNE 2012
Checked: AMP	Scale: 1"=20'	Job No.: 1721
File Name: 1721-pbase.dwg		
This plan shall not be modified without written permission from Gorrill-Palmer Consulting Engineers, Inc.(GPCEI). Any alterations, authorized or otherwise, shall be at the user's sole risk and without liability to GPCEI.		

GP Gorrill-Palmer Consulting Engineers, Inc.
Engineering Excellence Since 1998

PO Box 1237 15 Shaker Road Gray, ME 04039

207-657-6910
 207-657-6912
 E-Mail: mailbox@gorrillpalmer.com

Drawing Name:	Site, Utility, Grading and Drainage Plans
Project:	Castine Avenue Lot Castine Avenue, Portland, Maine
Client:	Brighton Avenue Properties, Inc. P.O. Box 10127, Portland, Maine 04204

Drawing No.	1
-------------	----------