

1761-1763 FOREST AVENUE

SHAW-WALKER
C203-3R

(COPY)

MAINE PRINTING CO., PORTLAND

CITY OF PORTLAND, MAINE
Department of Building Inspection



Certificate of Occupancy

LOCATION 1761-1763 Forest Ave.

Date of Issue April 17, 1957

Issued to Carl W. Hayden

This is to certify that the building, premises, or part thereof, at the above location, built—~~erected~~
~~erected~~ under Building Permit No. 56/1631, has had final inspection, has been found to conform
substantially to requirements of Zoning Ordinance and Building Code of the City, and is hereby approved for
occupancy or use, limited or otherwise, as indicated below.

PORTION OF BUILDING OR PREMISES

Entire

APPROVED OCCUPANCY

One-family Dwelling House

Limiting Conditions:

This certificate supersedes
certificate issued

1957 Carl Smith
(Date) Inspector

Warren D. Smith
Inspector of Buildings

Notice: This certificate identifies lawful use of building or premises, and ought to be transferred from
owner to owner when property changes hands. Copy will be furnished to owner or lessee for one dollar.



APPLICATION FOR AMENDMENT TO PERMIT

Amendment No. 1
Portland, Maine, J.A. 4, 1957

PERMIT ISSUED

JAN 7 1957

PORTLAND

To the INSPECTOR OF BUILDINGS, PORTLAND, MAINE

The undersigned hereby applies for amendment to Permit No. 56/1631 pertaining to the building or structure comprised in the original application in accordance with the Laws of the State of Maine, the Building Code and Zoning Ordinance of the City of Portland, plans and specifications, if any, submitted herewith, and the following specifications:

Location .. 1761-1763 Forest Ave. Within Fire Line no. Dist. No.
 Owner's name and address ... Carl W. Hayden, 119 Brentwood St. Telephone . 2-7826 .
 Lessee's name and address Telephone
 Contractor's name and address ... OWNER Telephone
 Architect Plan filed no. No. of sheets
 Proposed use of building dwelling house. No. families 1
 Last use No. families
 Increased cost of work 1,000. Additional fee 1.00

Description of Proposed Work

To finish off one room and bathroom on second floor. 2x4 studs, 16" on centers, covered with plaster. Plastered ceiling

Details of New Work

Is any plumbing involved in this work? Is any electrical work involved in this work?
 Height average grade to top of plate Height average grade to highest point of roof
 Size, front depth No. stories solid or filled land? earth or rock?
 Material of foundation Thickness, top bottom cellar
 Material of underpinning Height Thickness
 Kind of roof Rise per foot Roof covering
 No. of chimneys Material of chimneys of lining
 Framing lumber—Kind Dressed or full size?
 Corner posts Sills Girt or ledger board? Size
 Girders Size Columns under girders Size Max. on centers
 Studs (outside walls and carrying partitions) 2x4-16" O. C. Bridging in every floor and flat roof span over 8 feet.
 Joists and rafters: 1st floor , 2nd , 3rd , roof
 On centers: 1st floor. , 2nd , 3rd , roof
 Maximum span: 1st floor , 2nd , 3rd , roof

Approved: O.R. 1/7/57 - [Signature]

Signature of Owner Carl Hayden

Approved: 1/7/57 [Signature] Inspector of Buildings

INSPECTION COPY

C-10-154-SC-Marks

$$\text{AREA} = \frac{19.5}{2} \times 70.5 = 682.125 \text{ sq. ft.}$$

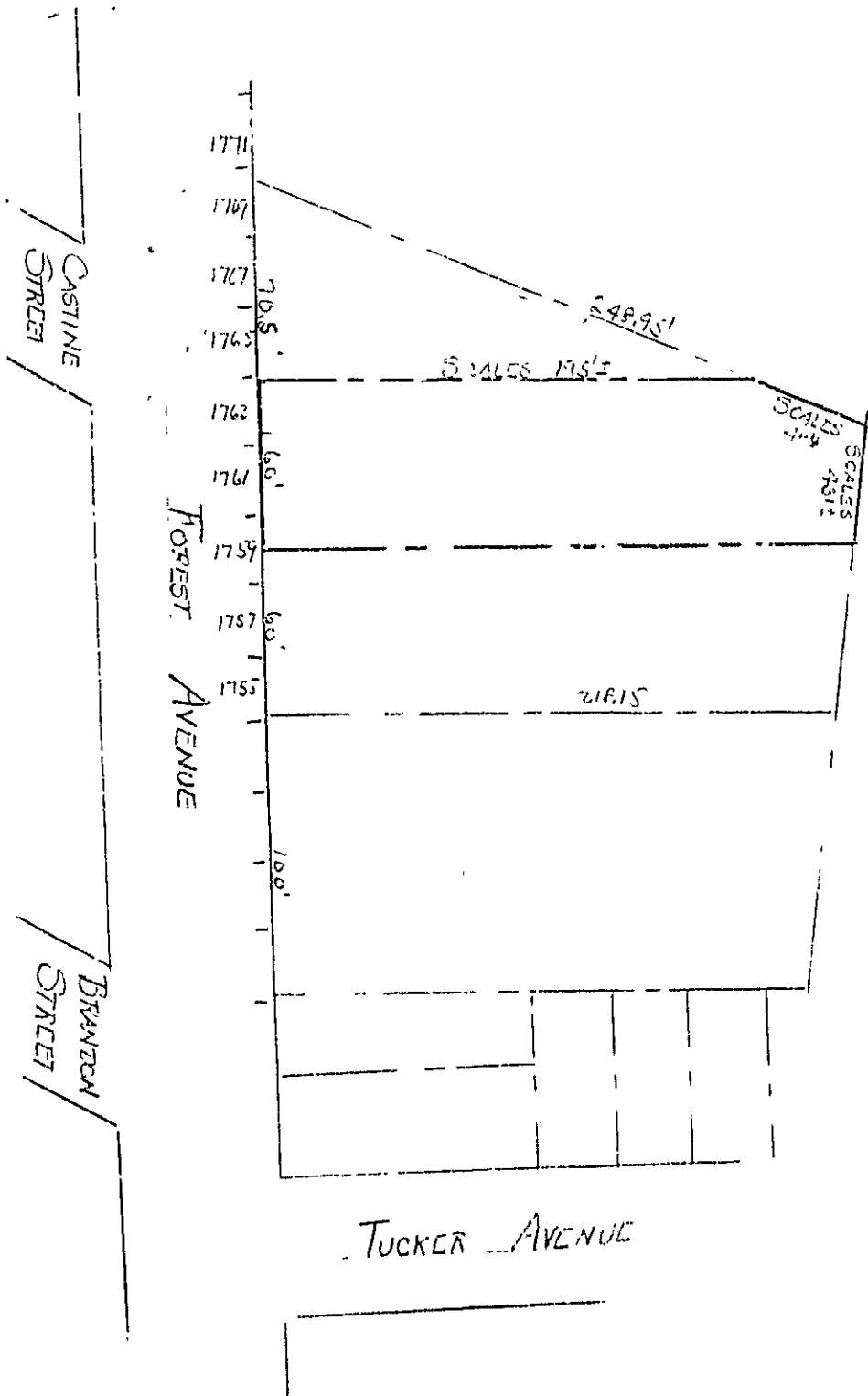

CITY OF PORTLAND, MAINE
Department of Building Inspection

SEPTIC TANKS
Request for approval of

Date May 17, 1956

Location - Next to 1753 Forest Ave.
Owner - Carl Hayden
Contractor Carl Hayden
Type Bldg - Dwelling

To The Health Director:

Application for building permit identified as above has been filed in this office; indicating that a septic tank installation is proposed, as a means of sewage disposal. Applicant represents that connection to a public sewer is not feasible. Copy to owner and contractor is attached.

Your approval as to the method of sewage disposal is requested before a building permit is issued, therefore will you complete and return the appended report as expeditiously as possible.

Inspector of Buildings

Attachment:
Copy of this notice
Copy of letter to owner

Proposed sewage disposal method is ~~approved~~ approved.

Remarks: Percolation test made May 16, 1956 was satisfactory.
65 foot absorption trench recommended.

Edward W. Kelly 445
Health Director

May 17 1956
APM

RECEIVED
MAY 17 1956
DEPT. OF BLDG INSP.
CITY OF PORTLAND



RESIDENTIAL ZONE - A

APPLICATION FOR PERMIT

11831

Class of Building or Type of Structure Third Class
Portland, Maine, September 27, 1956

To the INSPECTOR OF BUILDINGS, PORTLAND, MAINE

The undersigned hereby applies for a permit to erect alter repair demolish install the following building structure equipment in accordance with the Laws of the State of Maine, the Building Code and Zoning Ordinance of the City of Portland, plans and specifications, if any, submitted herewith and the following specifications:

Location 1563 Forest Ave. (1761-1763) Within Fire Limits? _____ Dist. No. _____
 Owner's name and address Carl W. Hayden, 119 Brentwood St. Telephone 2-7826
 Lessee's name and address _____ Telephone _____
 Contractor's name and address owner Telephone _____
 Architect _____ Specifications _____ Plans yes No. of sheets 5
 Proposed use of building Dwelling No. families 1
 Last use _____ No. families _____
 Material _____ No. stories _____ Heat _____ Style of roof _____ Roofing _____
 Other buildings on same lot _____
 Estimated cost \$ 7,500. Fee \$ 8.00

General Description of New Work

To construct 1 story frame dwelling 26'x34'

Kind and thickness of outside sheathing of exterior walls? 1" boards

It is understood that this permit does not include installation of heating apparatus which shall be taken out separately by and in the name of the heating contractor. PERMIT TO BE ISSUED TO owner

Details of New Work

Is any plumbing involved in this work? yes Is any electrical work involved in this work? yes
 Is connection to be made to public sewer? no If not, what is proposed for sewage? septic tank
 Has septic tank notice been sent? yes Form notice sent? yes
 Height average grade to top of plate 10' Height average grade to highest point of roof 17'
 Size, front 34' depth 26' No. stories 1 1/2 solid or filled land? solid earth or rock? earth
 Material of foundation concrete at least 4' below grade Thickness, top 10" bottom 10" cellar yes
 Material of underpinning " to sill Height _____ Thickness _____
 Kind of roof pitch-gable Rise per foot 7" Roof covering asphalt roofing Class C Und. Labx
 No. of chimneys 1 Material of chimneys brick of lining tile Kind of heat h.w. fuel oil
 Framing lumber—Kind hemlock Dressed or full size? dressed
 Corner posts 4x6 Sills 2x8 box Girt or ledger board? _____ Size _____
 Girders yes Size 6x8 full size Columns under girders lally Size 3 1/2" Max. on centers 7' 6"
 Studs (outside walls and carrying partitions) 2x4-16" O. C. Bridging in every floor and flat roof span over 8 feet.
 Joists and rafters: 1st floor 2x8 2nd 2x8 stairway 3rd _____ roof 2x6
 On centers: 1st floor 16" 2nd 16" 3rd _____ roof 24"
 Maximum span: 1st floor 12' 2nd 12' 3rd _____ roof _____
 If one story building with masonry walls, thickness of walls? _____ height? _____

If a Garage

No. cars now accommodated on same lot _____, to be accommodated _____ number commercial cars to be accommodated _____
 Will automobile repairing be done other than minor repairs to cars habitually stored in the proposed building? _____

Miscellaneous

Will work require disturbing of any tree on a public street? no
 Will there be in charge of the above work a person competent to see that the State and City requirements pertaining thereto are observed? yes

APPROVED:

O.K. - 9/28/56 - CWS

INSPECTION COPY

Signature of owner

Carl W. Hayden

NOTES

10/12/56 - Form insp. made
SSS

10/31/56 - Part of foundation
wall was pushed in by
bull-dozers. Carl took
that part of wall out and
has replaced it. C. S. S.

1/12/57 - Left Carl to clear
in E. S. S.

3/26/57 - Final insp.
made - Front and rear
parches not finished - As
soon as finished - Carl
will be wired. SSS

4/17/57 - Carl to be
wired. SSS

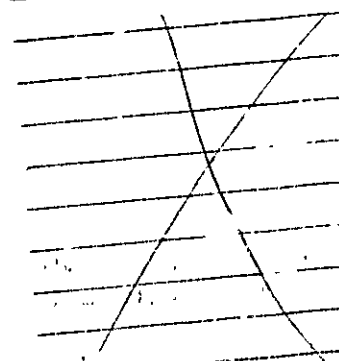

Permit No. 5611631

Location 1761-1763 Grand Ave.

Owner Carl S. Sander

Date of permit 9/28/56

Notif. closing-in 1/14/57

Inspn. closing-in 1/15/57

Final Inspn. 3/26/57

Cert. of Occupancy issued 4/17/57

Staking Out Notice 1/21/57

Form Check Notice 1/21/57

Handwritten notes and signatures at the top right of the page.

Official form fields for permit details, including permit number, location, owner, dates, and inspection status.

STATEMENT ACCOMPANYING APPLICATION FOR BUILDING PERMIT

for 1 car garage
at 1563 Forest Ave. Date 9/27/56

1. In whose name is the title of the property now recorded? Carl Hayden
2. Are the boundaries of the property in the vicinity of the proposed work shown clearly on the ground, and how? stakes
3. Is the outline of the proposed work now staked out upon the ground? no will call
If not, will you notify the Inspection Office when the work is staked out and before any of the work is commenced? _____
4. What is to be maximum projection or overhang of eaves or drip? _____
5. Do you assume full responsibility for the correctness of the location plan or statement of location filed with this application, and does it show the complete outline of the proposed work on the ground, including bay windows, porches and other projections? yes
6. Do you assume full responsibility for the correctness of all statements in the application concerning the size, design and use of the proposed building? yes
7. Do you understand that in case changes are proposed in the location of the work or in any of the details specified in the application that a revised plan and application must be submitted to this office before the changes are made? yes

Carl W. Hayden



(R-1) RESIDENCE ZONE - A

APPLICATION FOR PERMIT

Class of Building or Type of Structure Third Class

Portland, Maine, September 27, 1956

To the INSPECTOR OF BUILDINGS, PORTLAND, ME.

The undersigned hereby applies for a permit to erect alter repair demolish install the following building structure equipment in accordance with the Laws of the State of Maine, the Building Code and Zoning Ordinance of the City of Portland, plans and specifications, if any, submitted herewith and the following specifications:

Location 156 Forest Avenue (1761-1763) Within Fire Limits? _____ Dist. No. _____
 Owner's name and address Carl Hayden, 119 Brentwood St. Telephone _____
 Lessee's name and address _____ Telephone _____
 Contractor's name and address owner Telephone _____
 Architect _____ Specifications _____ Plans yes No. of sheets 1
 Proposed use of building 1 car garage No. families _____
 Last use _____ No. families _____
 Material _____ No. stories _____ Heat _____ Style of roof _____ Re _____
 Other buildings on same lot dwelling Re _____
 Estimated cost \$ 1500. _____

General Description of New Work

To construct 1-car frame garage 12'x24'

It is understood that this permit does not include installation of heating apparatus which is to be taken out separately by and in the name of the heating contractor.

Details of New Work owner

Is any plumbing work involved in this work? _____ Is any electrical work involved in this work? _____
 Height average grade to top of plate 8' Height average grade to highest point of roof 12'
 Size, front 12' depth 24' No. stories 1 solid or filled land? solid earth or rock? earth
 Material of foundation concrete slab Thickness, top _____ bottom _____ cellar _____
 Material of underpinning _____ Height _____ Thickness _____
 Kind of roof pitch-gable Rise per foot 7" Roof covering asphalt roofing Class C Und. Lab.
 No. of chimneys _____ Material of chimneys _____ of lining _____ Kind of heat _____ fuel _____
 Framing lumber--Kind hemlock Dressed or full size? dressed
 Corner posts 4x4 Sills 2x4 bolted Girt or ledger board? _____ Size _____
 Girders _____ Size _____ Columns under girders _____ Size _____ Max. on centers _____
 Studs (outside walls and carrying partitions) 2x4-16" O. C. Bridging in every floor and flat roof span over 8 feet.
 Joists and rafters: 1st floor concrete, 2nd _____, 3rd _____, roof 2x6
 On centers: 1st floor _____, 2nd _____, 3rd _____, roof 24"
 Maximum span: 1st floor _____, 2nd _____, 3rd _____, roof 6'

If one story building with masonry walls, thickness of walls? _____ height? _____

If a Garage

No. cars now accommodated on same lot _____, to be accommodated 1 number commercial cars to be accommodated 0
 Will automobile repairing be done other than minor repairs to cars habitually stored in the proposed building? no

Miscellaneous

Will work require disturbing of any tree on a public street? no
 Will there be in charge of the above work a person competent to see that the State and City requirements pertaining thereto are observed? yes

APPROVED:

ON-4/18/57-agj

Signature of owner

Carl W Hayden

INSPECTION COPY

Permit No. 56/484
Location: 1761-1763 Forest Ave.
Owner Carl Hayden
Date of permit 4/18/56
Notif. closing-in _____
Inspn. closing-in _____
Final Notif. _____
Final Inspn. 6/13/57
Crt. of Occupancy issued _____

NOTES

4/17/57 - Inspection
OK 888
6/13/57 - work done
888

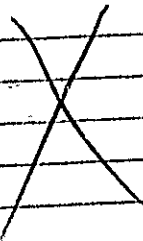



CITY OF PORTLAND
DEPARTMENT OF BUILDING INSPECTION

GAS FITTING CERTIFICATE

Permit No. _____

The entire system of new gas piping, fittings and equipment in the building
at 1765 Forest Ave
has been installed in accordance with the Building Code of the City of Portland,
was properly air tested on Jan 9, 1957 and found to satisfy
said test. The service supply pipe from street main is 1 1/2
inches in diameter and all shut-offs required by law have been provided.

Chas. H. ...
Signature in ink of person in charge of fitting.
Portland Gas Light Co.
Gas Fitting Contractor

After signing, this tag to be attached to "METER FIT" in building and not removed,
except by City Inspector.



FILL IN AND SIGN WITH INK

APPLICATION FOR PERMIT FOR HEATING, COOKING OR POWER EQUIPMENT

Portland, Maine, January 7, 1957

RECEIVED
00053
JAN 8 1957
N-ESS

To the INSPECTOR OF BUILDINGS, PORTLAND, ME.

The undersigned hereby applies for a permit to install the following heating, cooking or power equipment in accordance with the Laws of Maine, the Building Code of the City of Portland, and the following specifications:

Location 1765 Forest Ave. Use of Building Dwelling No Stories New Building Exchange
Name and address of owner of appliance Carl Hayden, 1765 Forest Ave.
Installer's name and address Portland Gas Light Co., 5 Temple St. Telephone 2-8321

General Description of Work

To install gas-fueled K-16-W National hot water heater

IF HEATER, OR POWER BOILER

Location of appliance basement Any burnable material in floor surface or beneath? no
If so, how protected? Kind of fuel? gas
Minimum distance to burnable material, from top of appliance or casing top of furnace 21
From top of smoke pipe 15 From front of appliance 4 From sides or back of appliance Over 3
Size of chimney flue 12 Other connections to same flue none
If gas fired, how vented? chimney Rated maximum demand per hour
Will sufficient fresh air be supplied to the appliance to insure proper and safe combustion? yes

IF OIL BURNER

Name and type of burner Labeled by underwriters' laboratories?
Will operator be always in attendance? Does oil supply line feed from top or bottom of tank?
Type of floor beneath burner Size of vent pipe
Location of oil storage Number and capacity of tanks
Low water shut off Make No.
Will all tanks be more than five feet from any flame? How many tanks enclosed?
Total capacity of any existing storage tanks for furnace burners

IF COOKING APPLIANCE

Location of appliance Any burnable material in floor surface or beneath?
If so, how protected? Height of Legs, if any
Skirting at bottom of appliance? Distance to combustible material from top of appliance?
From front of appliance From sides and back From top of smokepipe
Size of chimney flue Other connections to same flue
Is hood to be provided? If so, how vented? Forced or gravity?
If gas fired, how vented? Rated maximum demand per hour

MISCELLANEOUS EQUIPMENT OR SPECIAL INFORMATION

Appliance is equipped with device which will automatically shut off all gas supply in case pilot flame is extinguished.

Amount of fee enclosed? 2.00 (\$2.00 for one heater, etc., 50 cents additional for each additional heater, etc., in same building at same time.)

OVED:
OK P.S.S. 1/7/57

Will there be in charge of the above work a person competent to see that the State and City requirements pertaining thereto are observed? YES
Portland Gas Light Co.

INSPECTION COPY
Signature of Installer By: [Signature]
PH

Permit No. 57/15

Location ~~765~~ Forest Ave

Owner Carl Stephens

Date of permit 1/8/57

Approved 3/26/57

NOTES

4.17.57 - Revised up gas tag.

