

DISPLAY THIS CARD ON PRINCIPAL FRONTAGE OF WORK



CITY OF PORTLAND

BUILDING PERMIT

This is to certify that DANIEL M. LEGAGE

Located At 194 LANE AVE

Job ID: 2011-05-1214-ALTR

CBL: 308 - - B - 050 - 001 - - - -

has permission to permit an existing 10' x 10' shed provided that the person or persons, firm or corporation accepting this permit shall comply with all of the provisions of the Statues of Maine and of the Ordinances of the City of Portland regulating the construction, maintenance and use of the buildings and structures, and of the application on file in the department.

Notification of inspection and written permission procured before this building or part thereof is lathed or otherwise closed-in. 48 HOUR NOTICE IS REQUIRED.

A final inspection must be completed by owner before this building or part thereof is occupied. If a certificate of occupancy is required, it must be

N/A

A. Bell 6/3/11

Fire Prevention Officer

Code Enforcement Officer / Plan Reviewer

**THIS CARD MUST BE POSTED ON THE STREET SIDE OF THE PROPERTY
PENALTY FOR REMOVING THIS CARD**

BUILDING PERMIT INSPECTION PROCEDURES

Please call 874-8703 or 874-8693 (ONLY)

or email: buildinginspections@portlandmaine.gov

With the issuance of this permit, the owner, builder or their designee is required to provide adequate notice to the city of Portland Inspections Services for the following inspections. Appointments must be requested 48 to 72 hours in advance of the required inspection. The inspection date will need to be confirmed by this office.

- **Please read the conditions of approval that is attached to this permit!! Contact this office if you have any questions.**
- **Permits expire in 6 months. If the project is not started or ceases for 6 months.**
- **If the inspection requirements are not followed as stated below additional fees may be incurred due to the issuance of a "Stop Work Order" and subsequent release to continue.**

1. Call for final inspection.

The project cannot move to the next phase prior to the required inspection and approval to continue, REGARDLESS OF THE NOTICE OF CIRCUMSTANCES.

IF THE PERMIT REQUIRES A CERTIFICATE OF OCCUPANCY, IT MUST BE PAID FOR AND ISSUED TO THE OWNER OR DESIGNEE BEFORE THE SPACE MAY BE OCCUPIED.



PORTLAND MAINE

Strengthening a Remarkable City, Building a Community for Life • www.portlandmaine.gov

Director of Planning and Urban Development
Penny St. Louis

Job ID: 2011-05-1214-ALTR

Located At: 194 LANE AVE

CBL: 308 - - B - 050 - 001 - - - -

Conditions of Approval:

Zoning

This permit has been reviewed for the location of the shed only. The existing principal structure footprint has not been reviewed for zoning.

Building

1. Because the proposed shed is less than 200 square feet in size, the current Building Code exempts this type of structure from review. This shed has not been reviewed for building codes.

R-3

5/31/11 66 2011 05-1214



General Building Permit Application

If you or the property owner owes real estate or personal property taxes or user charges on any property within the City, payment arrangements must be made before permits of any kind are accepted.

Location/Address of Construction: <u>194 LANE AVENUE PORTLAND ME 04103</u>		
Total Square Footage of Proposed Structure/Area <u>100</u>		Square Footage of Lot
Tax Assessor's Chart, Block & Lot Chart# <u>308</u> Block# <u>B</u> Lot# <u>50</u>	Applicant * <u>must be owner, Lessee or Buyer</u> * Name <u>STEPHANIE, SCOTT LOVE</u> Address <u>194 LANE AVE.</u> City, State & Zip <u>PORTLAND, ME. 04103</u>	Telephone:
Lessee/DBA (If Applicable)	Owner (if different from Applicant) Name <u>DAN & TRISH LeGage</u> Address <u>194 LANE AVE</u> City, State & Zip <u>PORTLAND, ME. 04103</u>	Cost Of Work: \$ <u>30.00</u> C of O Fee: \$ <u>4</u> Total Fee: \$ <u>30.00</u>
Current legal use (i.e. <u>single family</u>) <u>SINGLE FAMILY</u> If vacant, what was the previous use? Proposed Specific use: <u>SHED</u> Is property part of a subdivision? <u>NO</u> If yes, please name _____ Project description: <u>after the fact 10' x 10' shed</u>		
RECEIVED MAY 27 2011 Dept. of Building Inspections City of Portland Maine		
Contractor's name: _____		
Address: _____		
City, State & Zip _____		Telephone: _____
Who should we contact when the permit is ready: _____		Telephone: _____
Mailing address: _____		

Please submit all of the information outlined on the applicable Checklist. Failure to do so will result in the automatic denial of your permit.

In order to be sure the City fully understands the full scope of the project, the Planning and Development Department may request additional information prior to the issuance of a permit. For further information or to download copies of this form and other applications visit the Inspections Division on-line at www.portlandmaine.gov, or stop by the Inspections Division office, room 315 City Hall or call 874-8703.

I hereby certify that I am the Owner of record of the named property, or that the owner of record authorizes the proposed work and that I have been authorized by the owner to make this application as his/her authorized agent. I agree to conform to all applicable laws of this jurisdiction. In addition, if a permit for work described in this application is issued, I certify that the Code Official's authorized representative shall have the authority to enter all areas covered by this permit at any reasonable hour to enforce the provisions of the codes applicable to this permit.

Signature: [Signature] Date: 5-27-11

This is not a permit; you may not commence ANY work until the permit is issue

PLEASE MAIL to: Stephanie & SCOTT LOVE
194 LANE AVE PORTLAND 04103



CITY OF PORTLAND, MAINE

Department of Building Inspections

Original Receipt

May 27 2011

Received from Daniel Dodge

Location of Work 194 Lane Ave

Cost of Construction \$ _____ Building Fee: _____

Permit Fee \$ _____ Site Fee: _____

Certificate of Occupancy Fee: _____

Total: 30.00

Building (IL) _____ Plumbing (I5) _____ Electrical (I2) _____ Site Plan (U2) _____

Other _____

CBL: 308 B 050

Check #: 1009 Total Collected \$ 30.00

**No work is to be started until permit issued.
Please keep original receipt for your records.**

Taken by: Dodge

WHITE - Applicant's Copy

YELLOW - Office Copy

PINK - Permit Copy

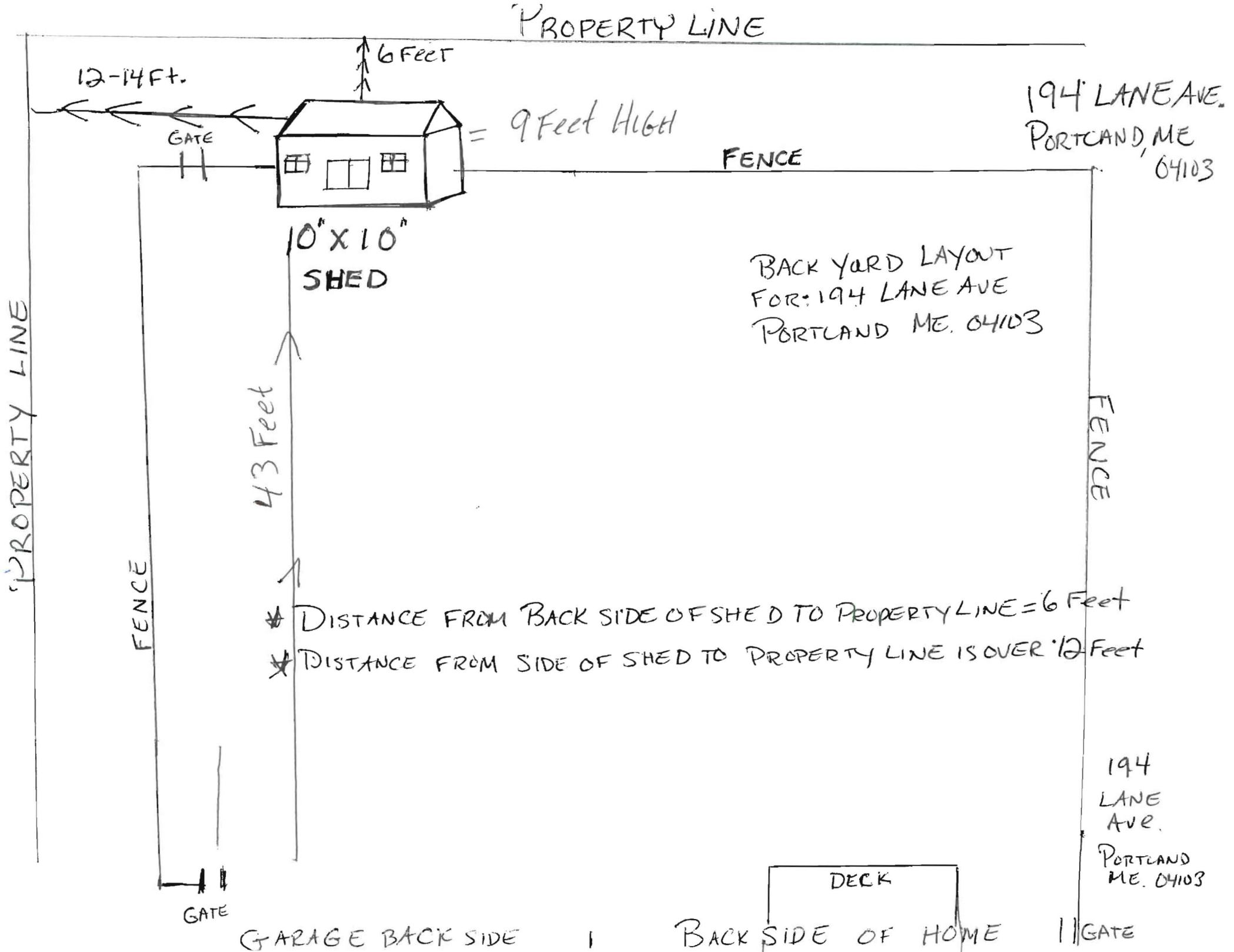

R-3
 lot size 8100 sq ft
 front N/A
 rear - 5' ± 14 ft - 6' 5 in (ob)
 side - " - 12' ± 9 in (ob)
 lot coverage - 35% = 2835

existing 1534
 100
 1634 (ob)

LANE AVE