

DISPLAY THIS CARD ON PRINCIPAL FRONTAGE OF WORK



# CITY OF PORTLAND

# BUILDING PERMIT

This is to certify that PATRICIAA DIPAOLO/ DODGE OIL CO.

Located At 27 WILKIE ST

Job ID: 2011-03-511-UI

CBL: 307 - - F - 015 - 001 - - - -

has permission to Set two (2) Propane tanks

provided that the person or persons, firm or corporation accepting this permit shall comply with all of the provisions of the Statues of Maine and of the Ordinances of the City of Portland regulating the construction, maintenance and use of the buildings and structures, and of the application on file in the department.

Notification of inspection and written permission procured before this building or part thereof is lathed or otherwise closed-in. 48 HOUR NOTICE IS REQUIRED.

A final inspection must be completed by owner before this building or part thereof is occupied. If a certificate of occupancy is required, it must be

06/09/2011

Fire Prevention Officer

Code Enforcement Officer / Plan Reviewer

**THIS CARD MUST BE POSTED ON THE STREET SIDE OF THE PROPERTY  
PENALTY FOR REMOVING THIS CARD**

# City of Portland, Maine - Building or Use Permit Application

389 Congress Street, 04101 Tel: (207) 874-8703, FAX: (207) 8716

Job No: 2011-03-511-UI 2011-3955HVAC	Date Applied: 6/1/2011	CBL: 307 - - F - 015 - 001 - - - - -	
Location of Construction: 27 WILKIE ST	Owner Name: Zareh Derhagopian	Owner Address: 23 Stormy Brook Rd Falmouth, ME 04105	Phone:
Business Name:	Contractor Name: Dodge Oil Co. - James McLaughlin, Jr.	Contractor Address: West Newfield, ME 04095	Phone:
Lessee/Buyer's Name:	Phone:	Permit Type: HVAC	Zone: <b>R-3</b>
Past Use: Single family	Proposed Use: Single Family - install two Propane tanks	Cost of Work:	CEO District:
		Fire Dept: <input type="checkbox"/> Approved <input type="checkbox"/> Denied <input checked="" type="checkbox"/> N/A	Inspection: Use Group: Type: <b>NEPA 58</b>
		Signature:	Signature: 
Proposed Project Description: 27 Wilkie St - install two propane tanks		Pedestrian Activities District (P.A.D.)	

Permit Taken By:	<b>Zoning Approval</b>		
<p>1. This permit application does not preclude the Applicant(s) from meeting applicable State and Federal Rules.</p> <p>2. Building Permits do not include plumbing, septic or electrical work.</p> <p>3. Building permits are void if work is not started within six (6) months of the date of issuance. False informatin may invalidate a building permit and stop all work.</p>	<b>Special Zone or Reviews</b> <input type="checkbox"/> Shoreland <input type="checkbox"/> Wetlands <input type="checkbox"/> Flood Zone <input type="checkbox"/> Subdivision <input type="checkbox"/> Site Plan <input type="checkbox"/> Maj <input type="checkbox"/> Min <input type="checkbox"/> MM Date: <b>OK w/condition</b> <b>6/1/11 ASH</b>	<b>Zoning Appeal</b> <input type="checkbox"/> Variance <input type="checkbox"/> Miscellaneous <input type="checkbox"/> Conditional Use <input type="checkbox"/> Interpretation <input type="checkbox"/> Approved <input type="checkbox"/> Denied Date:	<b>Historic Preservation</b> <input checked="" type="checkbox"/> Not in Dist or Landmark <input type="checkbox"/> Does not Require Review <input type="checkbox"/> Requires Review <input type="checkbox"/> Approved <input type="checkbox"/> Approved w/Conditions <input type="checkbox"/> Denied Date: <b>ASH</b>

**CERTIFICATION**

I hereby certify that I am the owner of record of the named property, or that the proposed work is authorized by the owner of record and that I have been authorized by the owner to make this application as his authorized agent and I agree to conform to all applicable laws of this jurisdiction. In addition, if a permit for work described in the application is issued, I certify that the code official's authorized representative shall have the authority to enter all areas covered by such permit at any reasonable hour to enforce the provision of the code(s) applicable to such permit.

SIGNATURE OF APPLICANT	ADDRESS	DATE	PHONE
RESPONSIBLE PERSON IN CHARGE OF WORK, TITLE		DATE	PHON

## BUILDING PERMIT INSPECTION PROCEDURES

Please call 874-8703 or 874-8693 (ONLY)

or email: [buildinginspections@portlandmaine.gov](mailto:buildinginspections@portlandmaine.gov)

With the issuance of this permit, the owner, builder or their designee is required to provide adequate notice to the city of Portland Inspections Services for the following inspections. Appointments must be requested 48 to 72 hours in advance of the required inspection. The inspection date will need to be confirmed by this office.

- **Please read the conditions of approval that is attached to this permit!! Contact this office if you have any questions.**
- **Permits expire in 6 months. If the project is not started or ceases for 6 months.**
- **If the inspection requirements are not followed as stated below additional fees may be incurred due to the issuance of a "Stop Work Order" and subsequent release to continue.**

The project cannot move to the next phase prior to the required inspection and approval to continue, REGARDLESS OF THE NOTICE OF CIRCUMSTANCES.

IF THE PERMIT REQUIRES A CERTIFICATE OF OCCUPANCY, IT MUST BE PAID FOR AND ISSUED TO THE OWNER OR DESIGNEE BEFORE THE SPACE MAY BE OCCUPIED.



# PORTLAND MAINE

*Strengthening a Remarkable City, Building a Community for Life* • [www.portlandmaine.gov](http://www.portlandmaine.gov)

Director of Planning and Urban Development  
Penny St. Louis

Job ID: 2011-03-511-UI

Located At: 27 WILKIE

CBL: 307 - - F - 015 - 001 - - - -

## **Conditions of Approval:**

### **Zoning**

1. This property shall remain a single family dwelling. Any change of use shall require a separate permit application for review and approval.

### **Building**

1. Tanks shall be installed per NFPA 58.
2. Separate permits are required for any electrical, plumbing, sprinkler, fire alarm, HVAC systems, heating appliances, commercial hood exhaust systems and fuel tanks. Separate plans may need to be submitted for approval as a part of this process.



FILL IN AND SIGN WITH INK

# APPLICATION FOR PERMIT HEATING OR POWER EQUIPMENT



To the INSPECTOR OF BUILDINGS, PORTLAND, ME.

The undersigned hereby applies for a permit to install the following heating, cooking or power equipment in accordance with the Laws of Maine, the Building Code of the City of Portland, and the following specifications:

Location / CBL 27 Wilkie Use of Building SFD Date 5-1-11  
 Name and address of owner of appliance Zarech Derhasopian  
27 Wilkie St. Portland Me. 04103  
 Installer's name and address Dodge Oil Co. James McLaughlin Jr.  
1650 Newfield Me. 04095 Telephone \_\_\_\_\_

### Location of appliance:

- Basement
- Attic
- Floor
- Roof

### Type of Fuel:

- Gas
- Oil
- Solid

### Appliance Name:

U.L. Approved  Yes  No

Will appliance be installed in accordance with the manufacture's installation instructions?  Yes  No

IF NO Explain: only setting Tanks no  
equipment

### The Type of License of Installer:

- Master Plumber # \_\_\_\_\_
- Solid Fuel # \_\_\_\_\_
- Oil # \_\_\_\_\_
- Gas # PNT3348
- Other \_\_\_\_\_

### Type of Chimney:

- Masonry Lined  
Factory built N/A
- Metal  
Factory Built U.L. Listing # \_\_\_\_\_
- Direct Vent  
Type \_\_\_\_\_ UL# \_\_\_\_\_

### Type of Fuel Tank

- Oil
- Gas Propane

Size of Tank 100 Gal

Number of Tanks 2

Distance from Tank to Center of Flame \_\_\_\_\_ feet.

Cost of Work: \$ \_\_\_\_\_

Permit Fee: \$ \_\_\_\_\_

### Approved

### Approved with Conditions

Fire: \_\_\_\_\_

See attached letter or requirement

Ele.: \_\_\_\_\_

Bldg.: \_\_\_\_\_

Inspector's Signature

Date Approved

Signature of Installer

White - Inspection    Yellow - File    Pink - Applicant's    Gold - Assessor's Copy

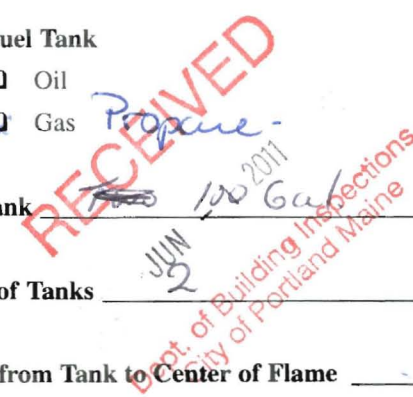



FILL IN AND SIGN WITH INK

# APPLICATION FOR PERMIT HEATING OR POWER EQUIPMENT

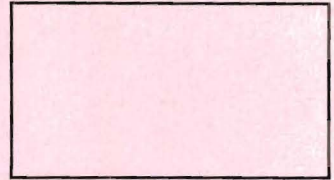

To the INSPECTOR OF BUILDINGS, PORTLAND, ME.

The undersigned hereby applies for a permit to install the following heating, cooking or power equipment in accordance with the Laws of Maine, the Building Code of the City of Portland, and the following specifications:

Location / CBL 27 Wilkie Use of Building SFD Date 5-1-11  
 Name and address of owner of appliance Zareh Derhasopian  
27 Wilkie St Portland Me. 04103  
 Installer's name and address Dodge Oil Co James McLaughlin Jr  
435 Newfield Me. 04105 Telephone \_\_\_\_\_

**Location of appliance:**  
 Basement  Floor  
 Attic  Roof

**Type of Fuel:**  
 Gas  Oil  Solid

**Appliance Name:** \_\_\_\_\_  
 U.L. Approved  Yes  No

Will appliance be installed in accordance with the manufacture's installation instructions?  Yes  No

IF NO Explain: only setting Tanks - no  
equipment

**The Type of License of Installer:**  
 Master Plumber # \_\_\_\_\_  
 Solid Fuel # \_\_\_\_\_  
 Oil # \_\_\_\_\_  
 Gas # PNT33415  
 Other \_\_\_\_\_

**Type of Chimney:**  
 Masonry Lined  
 Factory built N/A  
 Metal  
 Factory Built U.L. Listing # \_\_\_\_\_  
 Direct Vent  
 Type \_\_\_\_\_ UL# \_\_\_\_\_

**Type of Fuel Tank**  
 Oil  
 Gas Propane

Size of Tank Two 110 Gal.

Number of Tanks 2

Distance from Tank to Center of Flame \_\_\_\_\_ feet.

Cost of Work: \$ \_\_\_\_\_

Permit Fee: \$ \_\_\_\_\_

**Approved**

**Approved with Conditions**

Fire: \_\_\_\_\_  
 Ele.: \_\_\_\_\_  
 Bldg.: \_\_\_\_\_

See attached letter or requirement

Inspector's Signature

Date Approved

Signature of Installer \_\_\_\_\_

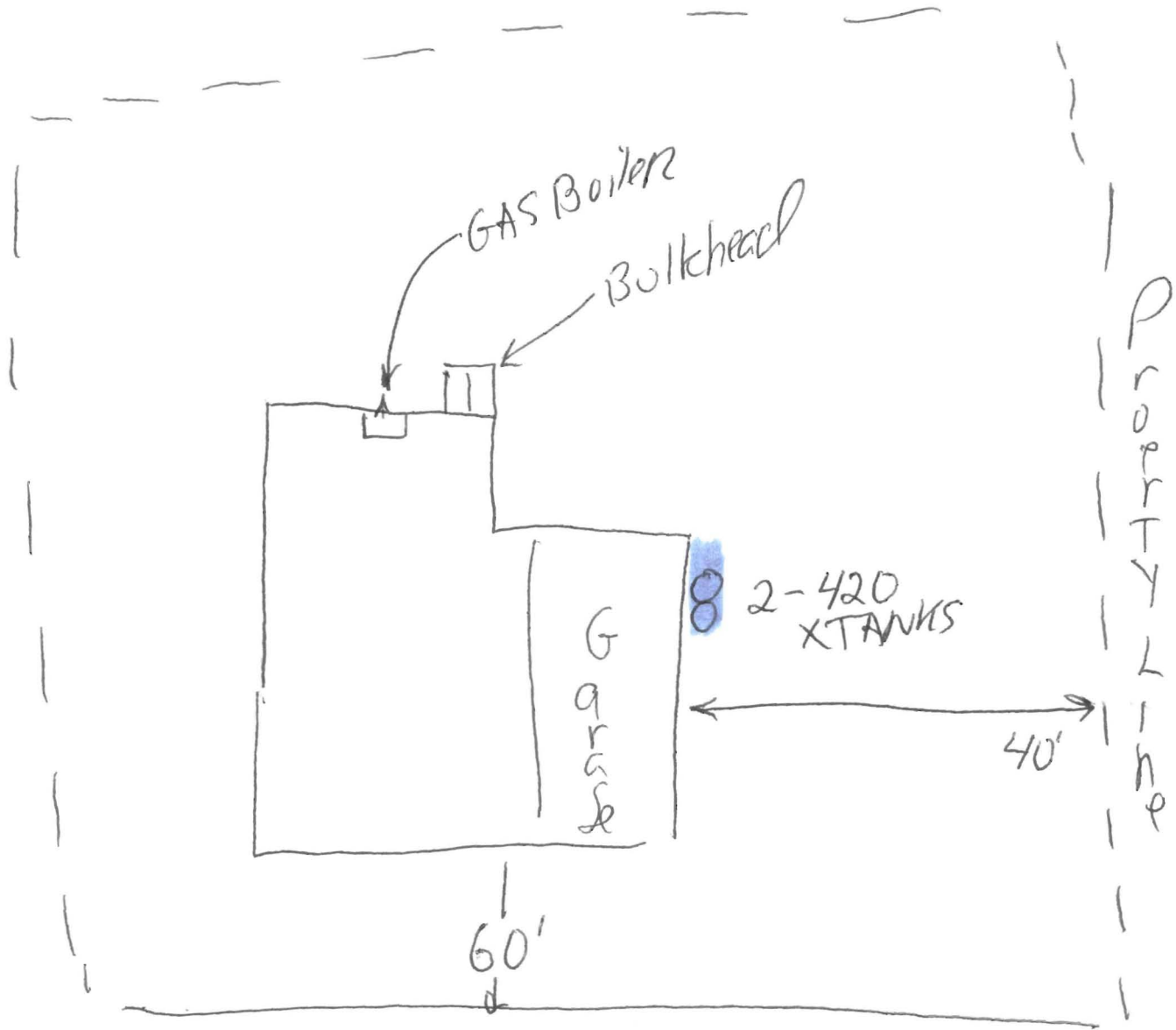

Wilke Street

Permit TO TWO TANKS



# CITY OF PORTLAND, MAINE

Department of Building Inspections

## Original Receipt

6-1 20 11

Received from Dodge Oil

Location of Work 27 Wilkie

Cost of Construction \$ \_\_\_\_\_ Building Fee: \_\_\_\_\_

Permit Fee \$ \_\_\_\_\_ Site Fee: \_\_\_\_\_

Certificate of Occupancy Fee: \_\_\_\_\_

Total: 30

Building (IL) \_\_\_\_\_ Plumbing (I5) \_\_\_\_\_ Electrical (I2) \_\_\_\_\_ Site Plan (U2) \_\_\_\_\_

Other tank

CBL: 307-F-15

Check #: \_\_\_\_\_ Total Collected \$ 30

**No work is to be started until permit issued.  
Please keep original receipt for your records.**

Taken by: [Signature]

WHITE - Applicant's Copy  
YELLOW - Office Copy  
PINK - Permit Copy