

DISPLAY THIS CARD ON PRINCIPAL FRONTAGE OF WORK



CITY OF PORTLAND

BUILDING PERMIT

This is to certify that MATTHEW M KING

Located At 60 LABEL AVE

Job ID: 2012-04-3886-POOL

CBL: 307- A-018-001

has permission to install an aboveground pool with the pool height as the barrier (Single Family Residence), provided that the person or persons, firm or corporation accepting this permit shall comply with all of the provisions of the Statues of Maine and of the Ordinances of the City of Portland regulating the construction, maintenance and use of the buildings and structures, and of the application on file in the department.

Notification of inspection and written permission procured before this building or part thereof is lathed or otherwise closed-in. 48 HOUR NOTICE IS REQUIRED.

A final inspection must be completed by owner before this building or part thereof is occupied. If a certificate of occupancy is required, it must be

Fire Prevention Officer



Code Enforcement Officer / Plan Reviewer

05/24/2012

THIS CARD MUST BE POSTED ON THE STREET SIDE OF THE PROPERTY
PENALTY FOR REMOVING THIS CARD

BUILDING PERMIT INSPECTION PROCEDURES

Please call 874-8703 or 874-8693 (ONLY)

or email: buildinginspections@portlandmaine.gov

With the issuance of this permit, the owner, builder or their designee is required to provide adequate notice to the city of Portland Inspections Services for the following inspections. Appointments must be requested 48 to 72 hours in advance of the required inspection. The inspection date will need to be confirmed by this office.

- **Please read the conditions of approval that is attached to this permit!! Contact this office if you have any questions.**
 - **Permits expire in 6 months. If the project is not started or ceases for 6 months.**
 - **If the inspection requirements are not followed as stated below additional fees may be incurred due to the issuance of a "Stop Work Order" and subsequent release to continue.**
1. Pool Location
 2. Electrical and Plumbing Rough-In.
 3. Final Inspection

The project cannot move to the next phase prior to the required inspection and approval to continue, REGARDLESS OF THE NOTICE OF CIRCUMSTANCES.

IF THE PERMIT REQUIRES A CERTIFICATE OF OCCUPANCY, IT MUST BE PAID FOR AND ISSUED TO THE OWNER OR DESIGNEE BEFORE THE SPACE MAY BE OCCUPIED.



PORTLAND MAINE

Strengthening a Remarkable City, Building a Community for Life • www.portlandmaine.gov

Acting Director of Planning and Urban Development
Gregory Mitchell

Job ID: 2012-04-3886-POOL

Located At: 60 LABEL AVE

CBL: 307- A-018-001

Conditions of Approval:

Building

1. Separate permits are required for any electrical: plumbing, sprinkler, fire alarm, HVAC systems, commercial hood exhaust systems and fuel tanks. Separate plans may need to be submitted for approval as a part of this process.
2. Where an aboveground pool structure is used as a barrier or where the barrier is mounted on top of the pool structure, and the means of access is a ladder or steps, then:
 - a. The ladder or steps shall be capable of being secured, locked or removed to prevent access, or
 - b. The ladder or steps shall be surrounded by a barrier which meets the requirements set forth above. When the ladder or steps are secured, locked or removed, any opening created shall not allow the passage of a 4- inch-diameter (102 mm) sphere.
2. Barriers shall be located so as to prohibit permanent structures, equipment or similar objects from being used to climb the barriers.
3. The top of the barrier shall be at least 48 inches above grade measured on the side of the barrier which faces away from the swimming pool. The maximum vertical clearance between grade and the bottom of the barrier shall be 2 inches measured on the side of the barrier which faces away from the swimming pool. Where the top of the pool structure is above grade, such as an aboveground pool, the barrier may be at ground level, such as the pool structure, or mounted on top of the pool structure. Where the barrier is mounted on top of the pool structure, the maximum vertical clearance between the top of the pool structure and the bottom of the barrier shall be 4 inches.
4. Openings in the barrier shall not allow passage of a 4-inch-diameter sphere.
5. **Note: Reference Section 6-24 of the City Code of Ordinances, see attachment.**

material.

(f) Demolition debris includes, but is not limited to, materials which are created by site preparation, clearing land, or erection of a structure. It also includes, but is not limited to, brush, tree limbs, stumpage, building materials, and the waste products of building activity, such as: clay, brick, masonry, concrete, plaster, glass, wood and wood products, asphalt, rubber, metal; and plumbing, electrical and heating fixtures, appurtenances thereto and parts thereof.

(g) No demolition debris shall either be disposed of or stored on any of the islands.

(Ord. No. 76-10/11, 11-15-10)

Sec. 6-24. Swimming Pools, spas and hot tubs.

(a) Definitions.

1. *Barrier* shall mean a fence, wall, building wall or combination thereof which completely surrounds the swimming pool and obstructs access to the swimming pool.
2. *Swimming Pool* shall mean any structure intended for swimming or recreational bathing that contains water over 24 inches (610 mm) deep. This includes in-ground, aboveground and on-ground swimming pools, hot tubs and spas.

(b) An outdoor swimming pool, including an in-ground, aboveground or on-ground pool, hot tub or spa shall be provided with a barrier which shall comply with the following:

1. The top of the barrier shall be at least 48 inches (1219 mm) above grade measured on the side of the barrier which faces away from the swimming pool. The maximum vertical clearance between grade and the bottom of the barrier shall be 2 inches (51 mm) measured on the side of the barrier which faces away from the swimming pool. Where the top of the pool structure is above grade, such as an aboveground pool, the barrier may be at ground level, such as the pool structure, or mounted on

top of the pool structure. Where the barrier is mounted on top of the pool structure, the maximum vertical clearance between the top of the pool structure and the bottom of the barrier shall be 4 inches (102 mm).

2. Openings in the barrier shall not allow passage of a 4-inch-diameter (102 mm) sphere.
3. Solid barriers which do not have openings, such as masonry or stone wall, shall not contain indentations or protrusions except for normal construction tolerances and tooled masonry joints.
4. Where the barrier is composed of horizontal and vertical members and the distance between the tops of the horizontal members is less than 45 inches (1143 mm), the horizontal members shall be located on the swimming pool side of the fence. Spacing between vertical members shall not exceed 1.75 inches (44 mm) in width. Where there are decorative cutouts within vertical members, spacing within the cutouts shall not exceed 1.75 inches (44 mm) in width.
5. Where the barrier is composed of horizontal and vertical members and the distance between the tops of the horizontal members is 45 inches (1143 mm) or more, spacing between vertical members shall not exceed 4 inches (102 mm). Where there are decorative cutouts within vertical members, spacing within the cutouts shall not exceed 1.75 inches (44 mm) in width.
6. Maximum mesh size for chain link fences shall be a 2.25-inch (57 mm) square unless the fence is provided with slats fastened at the top or the bottom which reduce the openings to not more than 1.75 inches (44 mm).
7. Where the barrier is composed of diagonal members, such as a lattice fence, the maximum opening formed by the diagonal members shall not be more than 1.75 inches (44 mm).
8. Access gates shall comply with the above standards and shall be equipped to accommodate a locking device. Pedestrian access gates shall open outward

away from the pool and shall be self-closing and have a self-latching device. Gates other than pedestrian access gates shall have a self-latching device. Where the release mechanism of the self-latching device is located less than 54 inches (1372 mm) from the bottom of the gate, the release mechanism and openings shall comply with the following:

- 8.1. The release mechanism shall be located on the pool side of the gate at least 3 inches (76 mm) below the top of the gate, and
 - 8.2. The gate and barrier shall have no opening greater than 0.5 inch (12.7 mm) within 18 inches (457 mm) of the release mechanism.
9. Where a wall of a dwelling serves as part of the barrier one of the following conditions shall be met:
- 9.1. The pool shall be equipped with a powered safety cover in compliance with accepted industry safety standards; or
 - 9.2. All doors with direct access to the pool through that wall shall be equipped with an alarm which produces an audible warning when the door and its screen, if present, are opened. The alarm shall sound continuously for a minimum of 30 seconds immediately after the door is opened and be capable of being heard throughout the house during normal house-hold activities. The alarm shall automatically reset under all conditions. The alarm system shall be equipped with a manual means, such as touchpad or switch, to temporarily deactivate the alarm for a single opening. Such deactivation shall last for not more than 15 seconds. The deactivation switch(es) shall be located at least 54 inches (1372 mm) above the threshold of the door; or
 - 9.3. Other means of protection, such as self-closing doors with self-latching devices, which are approved by the building authority,

shall be acceptable so long as the degree of protection afforded is not less than the protection afforded by section 9.1 or 9.2 above.

10. Where an aboveground pool structure is used as a barrier or where the barrier is mounted on top of the pool structure, and the means of access is a ladder or steps, then:

10.1 The ladder or steps shall be capable of being secured, locked or removed to prevent access, or

10.2 The ladder or steps shall be surrounded by a barrier which meets the requirements set forth above. When the ladder or steps are secured, locked or removed, any opening created shall not allow the passage of a 4-inch-diameter (102 mm) sphere.

11. Barriers shall be located so as to prohibit permanent structures, equipment or similar objects from being used to climb the barriers.

(c) Spas or hot tubs with a safety cover which complies with accepted industry safety standards shall be exempt from the provisions of this section.

(Ord. No. 76-10/11, 11-15-10)

Sec. 6-25. Municipal plumbing inspection and permit fees.

In addition to all other fees hereunder or under any state law, the city shall charge a ten-dollar (\$10.00) base fee for plumbing inspections and the following fees for plumbing permits:

(a) *Internal plumbing code fees:*

Fixture fee:

| | |
|------------------|---------|
| 1-3 Fixtures: | \$24.00 |
| Each additional: | \$6.00 |

Reinspection fee: Twenty dollars (\$20.00). A reinspection fee shall be charged when a reinspection is required as a result of improper or incomplete work.

City of Portland, Maine - Building or Use Permit Application

389 Congress Street, 04101 Tel: (207) 874-8703, FAX: (207) 8716

| | | | |
|---|---|--|---|
| Job No: 2012-04-3886-POOL | Date Applied: 4/30/2012 | CBL: 307- A-018-001 | |
| Location of Construction: 60 LABEL AVE | Owner Name: MATTHEW M KING | Owner Address: 60 LABEL AVE PORTLAND, ME 04103 | Phone: 207-797-4613 |
| Business Name: | Contractor Name: Dave's Pool | Contractor Address: 110 Roosevelt Trail, Windham, ME 04062 | Phone: (207) 893-2500 |
| Lessee/Buyer's Name: | Phone: | Permit Type: BLDG - Building | Zone: R-3 |
| Past Use: Single family | Proposed Use: Same – single family – install oval, above ground pool, 15'x 30' | Cost of Work: 8000.00 | CEO District: |
| | | Fire Dept: <input type="checkbox"/> Approved <input type="checkbox"/> Denied <input type="checkbox"/> N/A Signature: | Inspection: Use Group: Type: Pool 6-24 Signature:  |
| Proposed Project Description: 15' x 30' oval above ground pool | | Pedestrian Activities District (P.A.D.) | |
| Permit Taken By: | Zoning Approval | | |

| | | | |
|--|--|---|---|
| 1. This permit application does not preclude the Applicant(s) from meeting applicable State and Federal Rules. 2. Building Permits do not include plumbing, septic or electrical work. 3. Building permits are void if work is not started within six (6) months of the date of issuance. False informatin may invalidate a building permit and stop all work. | Special Zone or Reviews <input type="checkbox"/> Shoreland <input type="checkbox"/> Wetlands <input type="checkbox"/> Flood Zone <input type="checkbox"/> Subdivision <input type="checkbox"/> Site Plan <input type="checkbox"/> Maj <input type="checkbox"/> Min <input type="checkbox"/> MM Date: 04/30/12  | Zoning Appeal <input type="checkbox"/> Variance <input type="checkbox"/> Miscellaneous <input type="checkbox"/> Conditional Use <input type="checkbox"/> Interpretation <input type="checkbox"/> Approved <input type="checkbox"/> Denied Date: | Historic Preservation <input type="checkbox"/> Not in Dist or Landmark <input type="checkbox"/> Does not Require Review <input type="checkbox"/> Requires Review <input type="checkbox"/> Approved <input type="checkbox"/> Approved w/Conditions <input type="checkbox"/> Denied Date: |
| | CERTIFICATION | | |

I hereby certify that I am the owner of record of the named property, or that the proposed work is authorized by the owner of record and that I have been authorized by the owner to make this application as his authorized agent and I agree to conform to all applicable laws of this jurisdiction. In addition, if a permit for work described in the appication is issued, I certify that the code official's authorized representative shall have the authority to enter all areas covered by such permit at any reasonable hour to enforce the provision of the code(s) applicable to such permit.

SIGNATURE OF APPLICANT ADDRESS DATE PHONE

RESPONSIBLE PERSON IN CHARGE OF WORK, TITLE DATE PHONE



P-3
Furnish by 01

2012-04 - 3FPL

Pool Installation/Construction Permit Application

If you or the property owner owes real estate or personal property taxes or user charges on any property within the City, payment arrangements must be made before permits of any kind are accepted.

| | | |
|---|---|--|
| Location/Address of Construction: <u>60 Label Ave</u> | | |
| Total Square Footage of Proposed Structure <u>480 - Pool</u> | Square Footage of Lot <u>12,520</u> | |
| Tax Assessor's Chart, Block & Lot Chart# Block# Lot# <u>307 A018001</u> | Owner: <u>Matthew & Holly King</u> | Telephone: <u>797 4613</u> |
| Lessee/Buyer's Name (If Applicable) RECEIVED <u>APR 30 2012</u> | Applicant name, address & telephone: <u>Matthew King</u> <u>60 Label Ave</u> <u>797 4613</u> | Cost Of Work: \$ <u>7,625</u> Fee: \$ <u>100.00</u> |
| Dept. of Building Inspections City of Portland Maine | | |
| Dimensions of pool: <u>15 x 30</u> above or below ground: <u>above</u> | | |
| Dimensions of decking and/or any platforms, sheds, or other structures: <u>11 x 23 deck</u> <u>8 x 12 deck</u> <u>8 x 12 deck</u> <u>15 x 30 oval above ground pool</u> <u>on closed lot</u> <u>SF</u> | | |
| Contractor's name, address & telephone: <u>Dave's Pool 110 Roosevelt Trail Windham ME 04062</u> <u>893-2500</u> | | |
| Who should we contact when the permit is ready: <u>Matthew King</u> | | |
| Mailing address: <u>60 Label Ave 04103</u> Phone: <u>797 4613</u> | | |

Please submit all of the information outlined in the pool application checklist. Failure to do so could result in the automatic denial of your permit.

In order to be sure the City fully understands the full scope of the project, the Planning and Development Department may request additional information prior to the issuance of a permit. For further information visit us on-line at www.portlandmaine.gov, stop by the Building Inspections office, room 315 City Hall or call 874-8703.

I hereby certify that I am the Owner of record of the named property, or that the owner of record authorizes the proposed work and that I have been authorized by the owner to make this application as his/her authorized agent. I agree to conform to all applicable laws of this jurisdiction. In addition, if a permit for work described in this application is issued, I certify that the Code Official's authorized representative shall have the authority to enter all areas covered by this permit at any reasonable hour to enforce the provisions of the codes applicable to this permit.

| | |
|---|----------------------|
| Signature of applicant: <u>Matthew King</u> | Date: <u>2/27/12</u> |
|---|----------------------|

This is not a permit; you may not commence ANY work until the permit is issued.

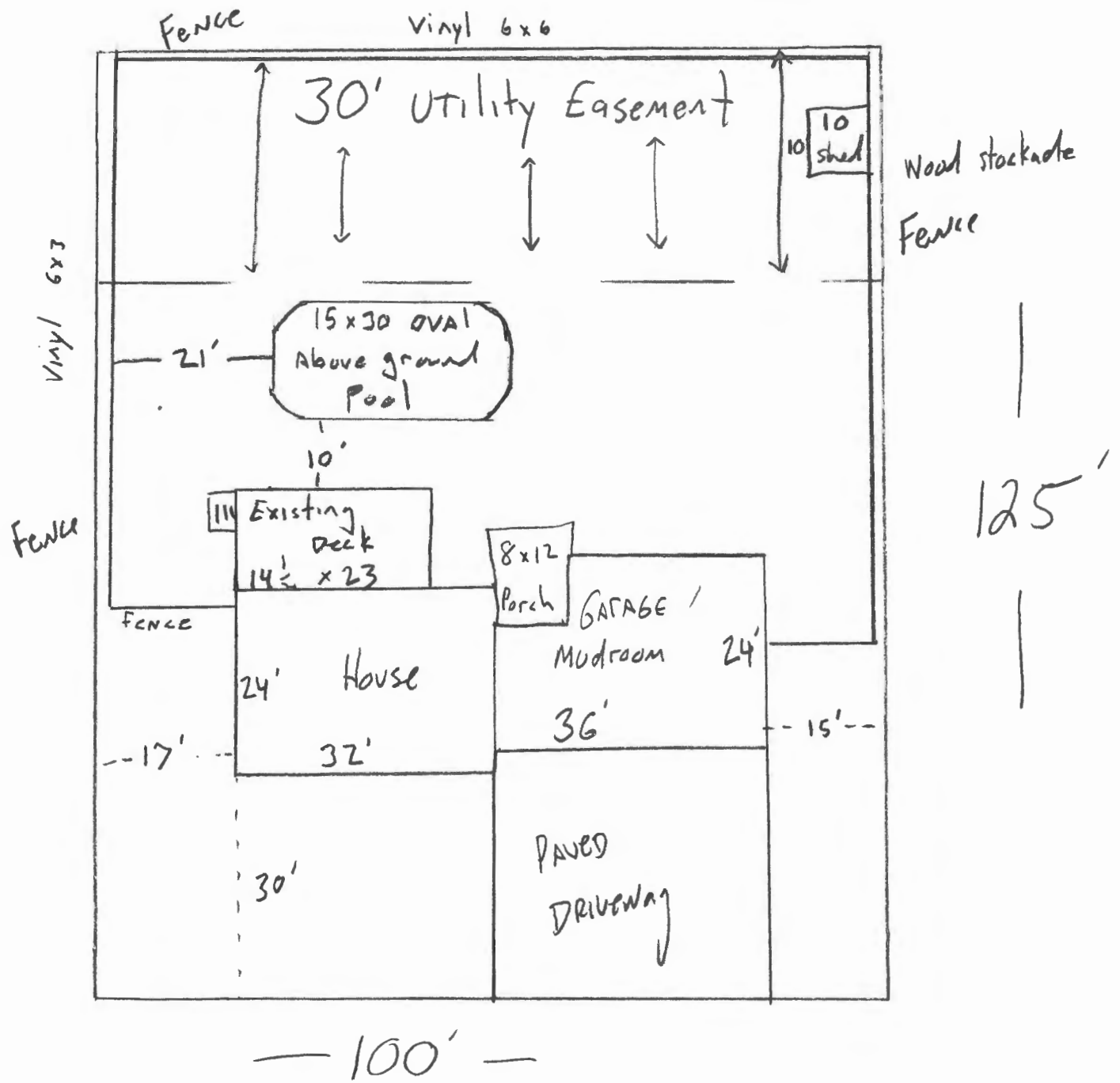

front yard - N/A
rear yard - 10' min - 30' 5 min ok
side " - 10' min - 21' 5 min ok
10' from principal structure 10' off deck

DAVE'S POOL

SALES & SERVICE, INC.

Water Ground Pool Specialists

110 Roosevelt Trail
Windham, Maine 04062

T: 207-893-2500
F: 207-893-2502

| | | |
|--|----------------------------|--|
| Proposal Submitted To: Matt King | Home Phone: | Date: 10/8/2011 |
| Street Address: 60 Label Avenue | Work Phone: | Note: 2011 Season Pricing |
| City, State, Zip Code: Portland, Maine 04103 | Cell Phone: (207) 756-3490 | www.davespool.com |

Estimated time of installation: Spring 2012

We hereby submit specifications and estimates for:

| | |
|---|----------|
| Pool Size and Style: 15' x 30' x 52" Distinction LX | 5,500.00 |
|---|----------|

| | |
|---|--|
| Liner: 25 Gauge "V" Bead Liner with a Palazzo Tile/Glimmerglass Wall Design | |
|---|--|

| | |
|---|--|
| Filter: Hayward 21" Pro Series Top-Mount Sand Filter (Model S210T) with 1.5 HP Pump and Motor | |
|---|--|

| | |
|--|--|
| Ladder: Integrity A-Frame Safety Conversion Ladder | |
|--|--|

| | |
|---|--|
| Vacuum Kit: Weighted Triangular Vacuum Head with a 30' Swivel Cuff Vacuum Hose and 8'-16' Telescopic Pole | |
|---|--|

| | |
|---|--|
| Skimmer: Hayward Wide Mouth Skimmer (Model SP1091) with Hoses and Accessories | |
|---|--|

| | |
|--------------------------------------|--|
| Filter Media: 100 lbs. Zeobrite Sand | |
|--------------------------------------|--|

| | |
|---|--|
| Chemicals: 1 Gallon Shock Treatment, 32 oz. Polypower 60, 4 lbs. Water Conditioner, 10 lbs. Total Alkalinity, 25 lbs. Calcium | |
|---|--|

| | |
|---|--|
| Increaser, 4 lbs. pH Minus, 5 lbs. pH Increaser, 5 lbs. 3" Chlorine Tabs, and Pool Water Test Kit | |
|---|--|

| | |
|-------------------------------------|----------|
| Installation, Labor, and Materials: | 1,850.00 |
|-------------------------------------|----------|

| | |
|------------|--------|
| State Tax: | 275.00 |
|------------|--------|

| | |
|--------|----------|
| Total: | 7,625.00 |
|--------|----------|

We Propose hereby to furnish material and labor-complete in accordance with the above specifications, for the sum of:

Seven Thousand Six Hundred Twenty Five Dollars and 00/100

| | |
|--------------------------------|--|
| Payment to be made as follows: | \$1,000.00 Down Payment; Balance Due Upon Completion |
|--------------------------------|--|

All material is guaranteed to be as specified. All work to be completed in a workmanship like manner according to standard practices. Any alterations or deviations from the above specifications involving extra costs will be executed only upon written orders and will become an extra charge over and above the estimate. All agreements contingent upon strikes, accidents or delays beyond our control. Owner to carry fire, wind damage and other necessary insurance. Our workers are fully covered by Workman's Compensation Insurance.

Authorized Signature _____

Date _____

Note: This proposal may be withdrawn by us if not accepted within _____ days.

Acceptance of Proposal - The above prices, specifications and conditions are satisfactory and are hereby accepted. You are authorized to do the work as specified. Payment will be made as outlined above.

Signature *Matt King*

Date of Acceptance 10/10/11

Signature _____

Distinction LX™

Wall and structure now coordinated for style

Nuance™ wall – 52" (1.32 m)



Structure

- 8-inch multi-ribbed top ledge
- 6-inch fully supportive uprights
- Synpro™ resin decorator ledge cover:
 - Won't chip, peel or splinter
 - Tie-in support to the upright for greater rigidity
 - Flush design eliminates exposed screws

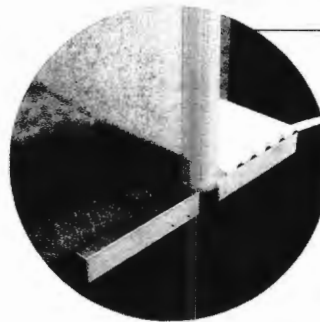

Yard Extender System

Our oval pools come with the Yard Extender System, a series of practically invisible lateral supports that you place in the ground

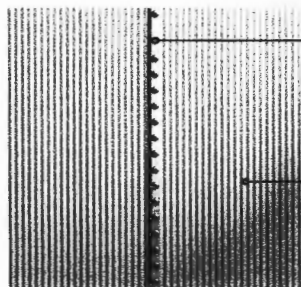

Wall Joint

- Computer-designed wall joint ensures better resistance to water pressure
- Oversized bolts augment stability

Corrugation

- A rippled finish lets the wall resist both water pressure and external shocks

Pool-fit System

- Parts are pre-grooved for fast and easy installation of screws
- Unique design locks screws solidly in place for long-lasting structural integrity



Protective Finishes

Zincguard™ 275

hot-dipped galvanized

Zinc coating on both sides of the steel for maximum protection against corrosion

Tru-Kote™

Undercoating process applied to the inner face for extra protection

Polyenamel™ Kote

Excellent tried-and-true finish for a long-lasting pool

Resin-Shield™

Textured resin coating applied to the outer face

Synpro™

Non-corrosive resin that contains UV stabilizers that protect against discoloration and chemicals

Duoguard™

An epoxy and alkyd resin compound that protects against condensation between the wall and the liner

Tuf Base Z™

Applied to bottom wall channels for superior corrosion protection

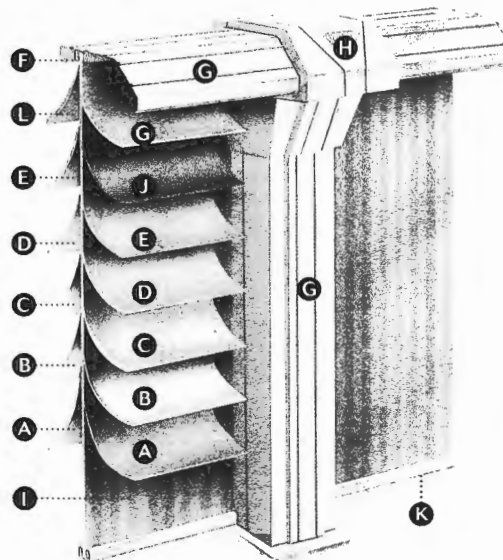

- A Galvanization
- B Zincguard™ 275, 99.5% pure
- C Alkaline cleaned
- D Bonderized
- E Chromic rinse
- F Tru-Kote™
- G Resin-Shield™
- H Synpro™
- I Pre-finished quality steel core
- J Polyenamel™ Kote
- K Tuf Base Z™
- L Duoguard™

Pre-finished pool components

All metal parts are coated and finished before assembly for longer-lasting effects

50-year Warranty

3 years at 100% (47 years prorated)

Water Safety

The purchase of an aboveground pool provides years of pleasure and fun, but it also involves water safety. Although we cannot supply a full-time lifeguard, we strongly recommend that you implement the following safety rules. These will help provide a pleasant atmosphere for you and your family.

- NEVER jump or dive in an aboveground pool.
- Maintain constant adult supervision when children are in or near any body of water.
- Read all of the safety, installation, and maintenance information contained in the instruction manual and Water Safety brochure before you start installing your pool.
- Ask your city about any specific rules and regulations that apply to aboveground pools.

- Follow the instruction manual and maintenance instructions.
- Never remove applied or posted safety stickers or signs from your pool or pool area.
- Barriers to prevent unsupervised access, especially by young children, should be built, installed and checked on a regular basis to ensure they are in good working order.
- Inspect your pool, barriers, alarms, and other related equipment on a regular basis in order to ensure they are in good working order and that they are safe.

The installation, maintenance and safety manual contains detailed tips and recommendations. They must be read, followed and applied on a regular basis, as they will prevent unnecessary accidents and will ensure many summers of pleasant, safe family fun.

SWIM SAFELY AND STAY SAFE

The dimensions, weights, illustrations and other specifications are approximate. The company reserves the right to modify and/or discontinue without notification any feature in any pool model.

© Copyright 2009



8300-187A 11/09