

**DISPLAY THIS CARD ON PRINCIPAL FRONTAGE OF WORK
CITY OF PORTLAND**

Please Read
Application And
Notes, If Any,
Attached

BUILDING INSPECTION

PERMIT

Permit Number: 021002

This is to certify that Kelton Real Estate Holdings
has permission to Erect 2- 4' x 8' permanent sign
AT 68 Waldron Way Portland, OR 97201 306 B018001

provided that the person or persons, firm or corporation accepting this permit shall comply with all of the provisions of the Statutes of Maine and of the Ordinances of the City of Portland regulating the construction, maintenance and use of buildings and structures, and of the application on file in this department.

Apply to Public Works for street line and grade if nature of work requires such information.

Notification of inspection must be given and when permission is procured before this building or part thereof is occupied or closed-in. **48 HOURS NOTICE IS REQUIRED.**

A certificate of occupancy must be procured by owner before this building or part thereof is occupied.

OTHER REQUIRED APPROVALS

Fire Dept. _____
Health Dept. _____
Appeal Board _____
Other _____
Department Name

[Handwritten Signature]
Director - Building Inspection Services

PENALTY FOR REMOVING THIS CARD

PERMIT ISSUED

City of Portland, Maine - Building or Use Permit Application

388 Congress Street, 04101 Tel: (207) 874-8703, Fax: (207) 874-8716

Permit No: 02-1002 SEP 17 2002	Issue Date: 17 2002	CBL: 306 B018001
--------------------------------------	------------------------	---------------------

Location of Construction: 68 Waldron Way	Owner Name: Kelton Real Estate Holdings Llc	Owner Address: 470 Riverside St PORTLAND	Phone: 207-797-0024
Business Name:	Contractor Name:	Contractor Address:	Phone:
Lease/Buyer's Name:	Phone:	Permit Type: Signs - Permanent	Zone: I-M

Past Use: Macine Shop	Proposed Use: Machine Shop w/2-4' x 8' permanent signs.	Permit Fee: \$94.00	Cost of Work: \$0.00	CEO District: 1
Proposed Project Description: Erect 2- 4' x 8' permanent signs 32A		FIRE DEPT: <input type="checkbox"/> Approved <input type="checkbox"/> Denied	INSPECTION: Use Group: NA Type: NA Signature: [Signature]	

PEDESTRIAN ACTIVITIES DISTRICT (P.A.D.)	
Action: <input type="checkbox"/> Approved <input type="checkbox"/> Approved w/Conditions <input type="checkbox"/> Denied	Signature: _____ Date: _____

Permit Taken By: jmy	Date Applied For: 09/04/2002	Zoning Approval	
-------------------------	---------------------------------	------------------------	--

1. This permit application does not preclude the Applicant(s) from meeting applicable State and Federal Rules. 2. Building permits do not include plumbing, septic or electrical work. 3. Building permits are void if work is not started within six (6) months of the date of issuance. False information may invalidate a building permit and stop all work..	Special Zone or Reviews <input type="checkbox"/> Shoreland <input type="checkbox"/> Wetland <input type="checkbox"/> Flood Zone <input type="checkbox"/> Subdivision <input type="checkbox"/> Site Plan Maj <input type="checkbox"/> Minor <input type="checkbox"/> MM <input type="checkbox"/> Date: 9/12/02	Zoning Appeal <input type="checkbox"/> Variance <input type="checkbox"/> Miscellaneous <input type="checkbox"/> Conditional Use <input type="checkbox"/> Interpretation <input type="checkbox"/> Approved <input type="checkbox"/> Denied Date:	Historic Preservation <input checked="" type="checkbox"/> Not in District or Landmark <input type="checkbox"/> Does Not Require Review <input type="checkbox"/> Requires Review <input type="checkbox"/> Approved <input type="checkbox"/> Approved w/Conditions <input type="checkbox"/> Denied Date:
--	---	---	--

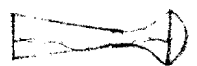

CERTIFICATION

I hereby certify that I am the owner of record of the named property, or that the proposed work is authorized by the owner of record and that I have been authorized by the owner to make this application as his authorized agent and I agree to conform to all applicable laws of this jurisdiction. In addition, if a permit for work described in the application is issued, I certify that the code official's authorized representative shall have the authority to enter all areas covered by such permit at any reasonable hour to enforce the provision of the code(s) applicable to such permit.

SIGNATURE OF APPLICANT ADDRESS DATE PHONE

RESPONSIBLE PERSON IN CHARGE OF WORK, TITLE DATE PHONE

02-1002

THIS IS NOT A PERMIT/CONSTRUCTION MAY NOT COMMENCE UNTIL THE PERMIT IS ISSUED

Signage Application

If you or the property owner owes real estate or personal property taxes or user charges on any property within the City, payment arrangements must be made before permits of any kind are accepted.

Location/Address of Construction: <u>68 Waldron Way Portland</u>		
Total Square Footage of Proposed Structure <u>14,780 sq²</u>	Square Footage of Lot <u>107,726 sq²</u>	
Tax Assessor's Chart, Block & Lot Chart# <u>X(306 or B 018)</u>	Owner: <u>Kelton Real Estate Holdings, LLC</u> <u>Bill & Debbie Kelton</u>	Telephone: <u>*876-6926</u> <u>797-0024</u>
Lessee/Buyer's Name (if Applicable) <u>Maine Parts & Machine, Inc.</u>	Applicant name, address & telephone: <u>Bill Kelton</u> <u>Maine Parts & Machine</u> <u>68 Waldron Way</u> <u>Portland, ME 04103</u> 797-0024	Total s.f. of signage <u>64</u> x 1.00 per s.f. \$ <u>64</u> , plus \$30.00 base fee <u>30</u> . Fee: \$ <u>94.00</u>
Current use: <u>Machine Shop</u>		
If the location is currently vacant, what was prior use: <u>none</u>		
Approximately how long has it been vacant: _____		
Proposed use: <u>Machine Shop</u>		
Project description: <u>Two 4' x 8' signs</u>		
Contractor's name, address & telephone:		
Who should we contact when the permit is ready: <u>Bill Kelton to call</u>		
Mailing address: <u>MPM</u> <u>P.O. Box 407</u> <u>Westbrook, ME 04098</u>		
We will contact you by phone when the permit is ready. You must come in and pick up the permit and review the requirements before starting any work, with a Plan Reviewer. A stop work order will be issued and a \$50.00 fee if any work starts before the permit is picked up. Phone: <u>797-0024</u>		

IF THE REQUIRED INFORMATION IS NOT INCLUDED IN THE SUBMISSIONS THE PERMIT WILL BE AUTOMATICALLY DENIED AT THE DISCRETION OF THE BUILDING/PLANNING DEPARTMENT, WE MAY REQUIRE ADDITIONAL INFORMATION IN ORDER TO APPROVE THIS PERMIT.

I hereby certify that I am the Owner of record of the named property, or that the owner of record authorizes the proposed work and that I have been authorized by the owner to make this application as his/her authorized agent. I agree to conform to all applicable laws of this jurisdiction. In addition, if a permit for work described in this application is issued, I certify that the Code Official's authorized representative shall have the authority to enter all areas covered by this permit at any reasonable hour to enforce the provisions of the codes applicable to this permit.

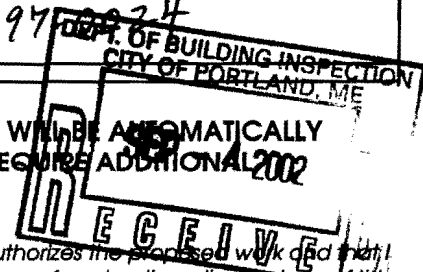

Signature of applicant: <u>William M. Galt</u>	Date: <u>8/28/02</u>
--	----------------------

This is NOT a permit, you may not commence ANY work until the permit is issued. If you are in a Historic District you may be subject to additional permitting and fees with the Planning Department on the 4th floor of City Hall

SIGNAGE PRE-APPLICATION

PLEASE ANSWER ALL QUESTIONS

ADDRESS: 68 Waldron Way ZONE: I-M

OWNER: Kelton Real Estate Holdings, LLC

APPLICANT: Maine Parts & Machine, Inc.

ASSESSOR NO. 33782 306-B-18, 311-A-14

PLEASE CIRCLE APPROPRIATE ANSWER

SINGLE TENANT LOT? YES NO MULTI-TENANT LOT? YES NO
 FREESTANDING SIGN? (ex. Pole Sign) YES NO DIMENSIONS None HEIGHT None
 MORE THAN ONE SIGN? YES NO DIMENSIONS _____ HEIGHT _____
 SIGN ATTACHED TO BLDG.? YES NO DIMENSIONS _____
 MORE THAN ONE SIGN? YES NO DIMENSIONS 8' x 4' (2) 32" x 2 = 64"
 AWNING: YES NO IS AWNING BACKLIT? YES NO HEIGHT OFF SIDEWALK _____
 IS THERE ANY MESSAGE, TRADEMARK OR SYMBOL ON IT? _____

LIST ALL EXISTING SIGNAGE AND THEIR DIMENSIONS:

Bl.

*** TENANT BLDG. FRONTAGE (IN FEET): _____

*** REQUIRED INFORMATION

AREA FOR COMPUTATION

6% Allowed
 $40 \times 17^h = 680 \times 6\% = 40.8 \text{ ft}$ Allowed in one place - 32" show
 $124 \times 17^h = 2108 \times 6\% = 126.48 \text{ ft}$ MAX Allowed Along front - 32" show
 ok ok

YOU SHALL PROVIDE:

A SITE SKETCH AND BUILDING SKETCH SHOWING EXACTLY WHERE EXISTING AND NEW SIGNAGE IS LOCATED MUST BE PROVIDED. SKETCHES AND/OR PICTURES OF PROPOSED ARE ALSO REQUIRED.

SIGNATURE OF APPLICANT: William W. Kato DATE: 8/28/02

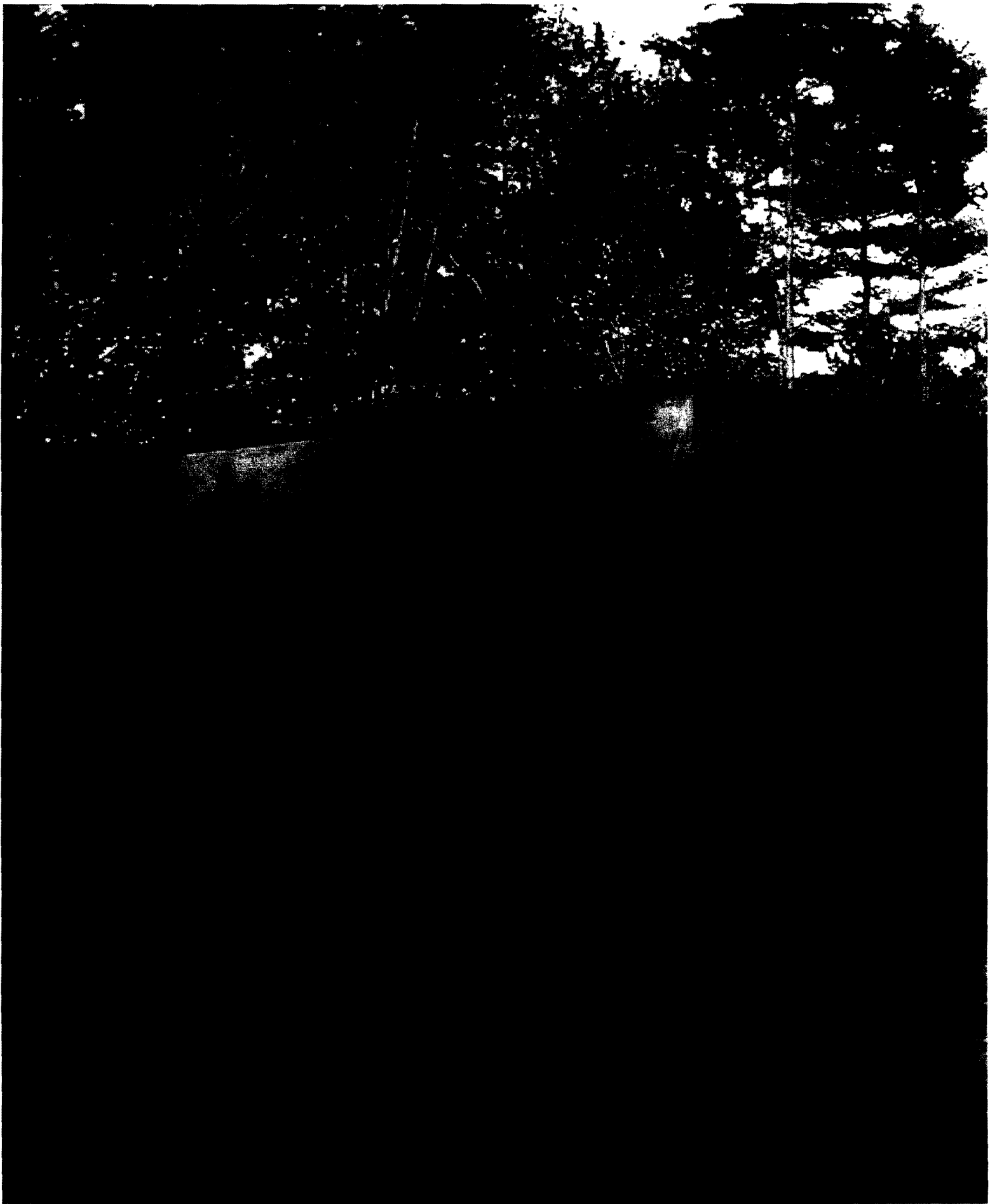

~~172~~ approx location of 4' x 8' sign

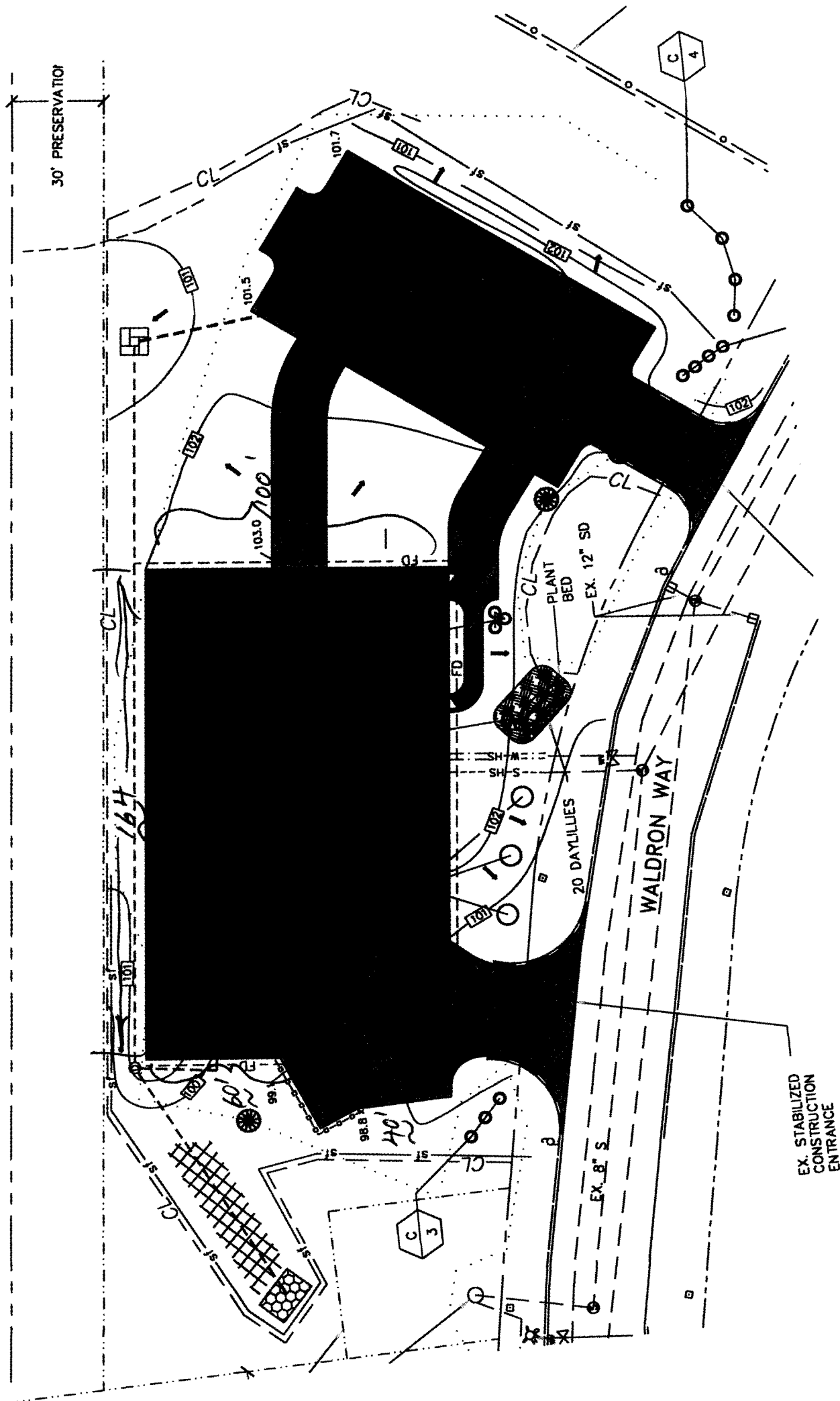

This is one of the two signs on
the old building. Both signs look exactly
the same. I am going to take these
signs off of the old building and put them
on to my new building at 68 Waldron Way
Thank you,
Bill Kelson

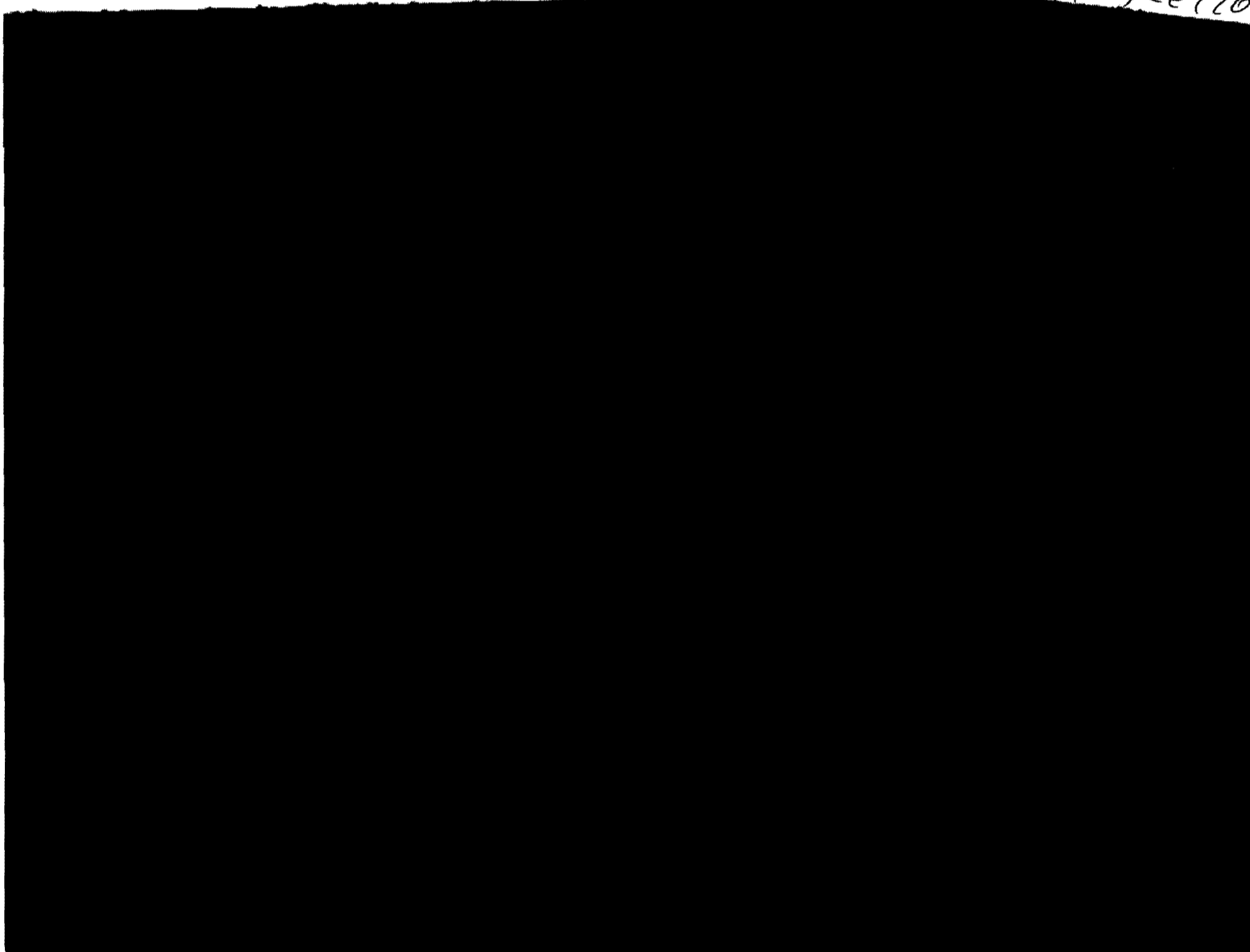

REAL ESTATE PROPERTY TAX STATEMENT, CITY OF PORTLAND

Fiscal Year 2003
July 1, 2002 - June 30, 2003

DUE SEPT. 6, 2002 \$1,740.60	DUE MARCH 7, 2003 \$1,740.60	AMOUNT PAID \$0.00	INTEREST DUE \$0.00	PAY THIS AMOUNT \$1,740.60
---------------------------------	---------------------------------	-----------------------	------------------------	-------------------------------

FIRST BILLING
306 - B-018-001

ACCOUNT NUMBER 33782

AUG 7 2002

306 - B-018-001

Assessed Property Description
306-B-18 311-A-14
WALDRON WAY
107266 SF

RE 33782
KREH
MAINE PARTS & MACHINE
PO BOX 407
WESTBROOK ME 04098

BRING COMPLETE TAX BILL WHEN
PAYING IN PERSON.

Please Make Your Check Payable to:
City of Portland

PARTIAL PAYMENTS MAY BE MADE
AT ANY TIME.

Change of Address

Name:

RETURN THIS TOP PORTION WITH PAYMENT

Credit cards are not accepted for property tax payments.

KEEP THIS PORTION

REAL ESTATE PROPERTY TAX STATEMENT
City of Portland

AUG 11 7 2002

2003
Fiscal Year
July 1, 2002 - June 30, 2003
Owner of Record as of April 1, 2002

KELTON REAL ESTATE HOLDINGS LL
470 RIVERSIDE ST
PORTLAND ME 04103



ACCOUNT NUMBER
33782

CBL
306 - B-018-001

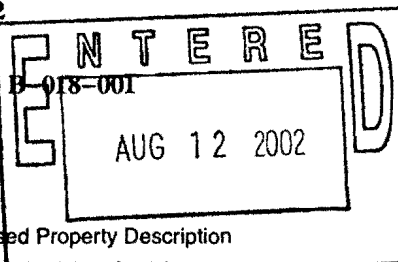

Assessed Property Description
306-B-18 311-A-14
WALDRON WAY
107266 SF

CURRENT BILLING DISTRIBUTION		CURRENT BILLING INFORMATION	
School	\$1,817.20	Land Value	\$135,350.00
Public Works	\$177.54	Building Value	\$0.00
Parks & Recreation	\$97.47	Total Value	\$135,350.00
Fire	\$275.01	Exemptions	\$0.00
Police	\$278.50	Homestead	\$0.00
Debt Repayments	\$327.23	Taxable Value	\$135,350.00
General Government	\$153.17	Tax Rate	25.72
County	\$119.36	TOTAL TAX	\$3,481.20
Health & Human Services	\$20.89	AMOUNT PAID	\$0.00
Library	\$107.92		
Metro Transit District	\$69.62		
Enterprise Funds	-\$17.41		
Regional Waste Systems	\$55.70		

Remittance Instructions

To avoid standing in line, it is recommended that taxes be paid by mail. Please make check or money order payable to: **CITY OF PORTLAND**. Credit cards are not accepted for property tax payments.

Use enclosed envelope to mail in your payment.

Use top right margin for change of address.

RGB CONSTRUCTION INC.

P.O. BOX 3672
PORTLAND, MAINE 04101

306-B-018

TRANSMITTAL LETTER

TO: CITY OF PORTLAND

CONTRACT 68 WARDEN WAY

BUILDING INSPECTIONS

DATE 10.23.02

REPLY TO: RICHARD BUTTERFIELD

GENTLEMEN:

WE ARE SENDING YOU: HEREWITH UNDER SEPARATE COVER
SHOP DRAWINGS COLOR SAMPLES SPECIFICATIONS PLANS

NO. OF COPIES	DRWG. NOS.	DATE	DESCRIPTION
1			Full Set of Drawings 11x17

SENT TO YOU FOR THE FOLLOWING: APPROVAL FILE OR DISTRIBUTION
 APPROVED FINAL APPROVAL INFORMATION
 APPROVED AS NOTED REVISE RESUBMIT ___ COPIES

NOTES: _____

SENT BY C.C. TO
 MESSENGER _____
 MAIL _____
 _____ _____

Very truly yours,
RGB CONSTRUCTION INC.
Per: *[Signature]*

DEPT. OF PUBLIC WORKS
CITY OF PORTLAND
RECEIVED
OCT 23 2002



CITY OF PORTLAND, MAINE

Department of Building Inspections

September 4 2002

Received from Bill Kerton

Location of Work 68 Waldron Way

Cost of Construction \$ _____

Permit Fee \$ 94.00

Building (I) Plumbing (I5) _____ Electrical (I2) _____ Site Plan (U2) _____

Other 2 maps

CBL: 206 B 015 or 311 A 014

Check #: Cash Total Collected \$ 94.00

THIS IS NOT A PERMIT

No work is to be started until PERMIT CARD is actually posted upon the premises. Acceptance of fee is no guarantee that permit will be granted. PRESERVE THIS RECEIPT. In case permit cannot be granted the amount of the fee will be refunded upon return of the receipt less \$10.00 or 10% whichever is greater.

WHITE - Applicant's Copy
YELLOW - Office Copy
PINK - Permit Copy

[Handwritten signature]