

N:\Projects\2013\13001 - Portland Public Schools - Central Kitchen\CD Drawing Files\13001P.dwg Mar 19, 2013 - 3:55pm

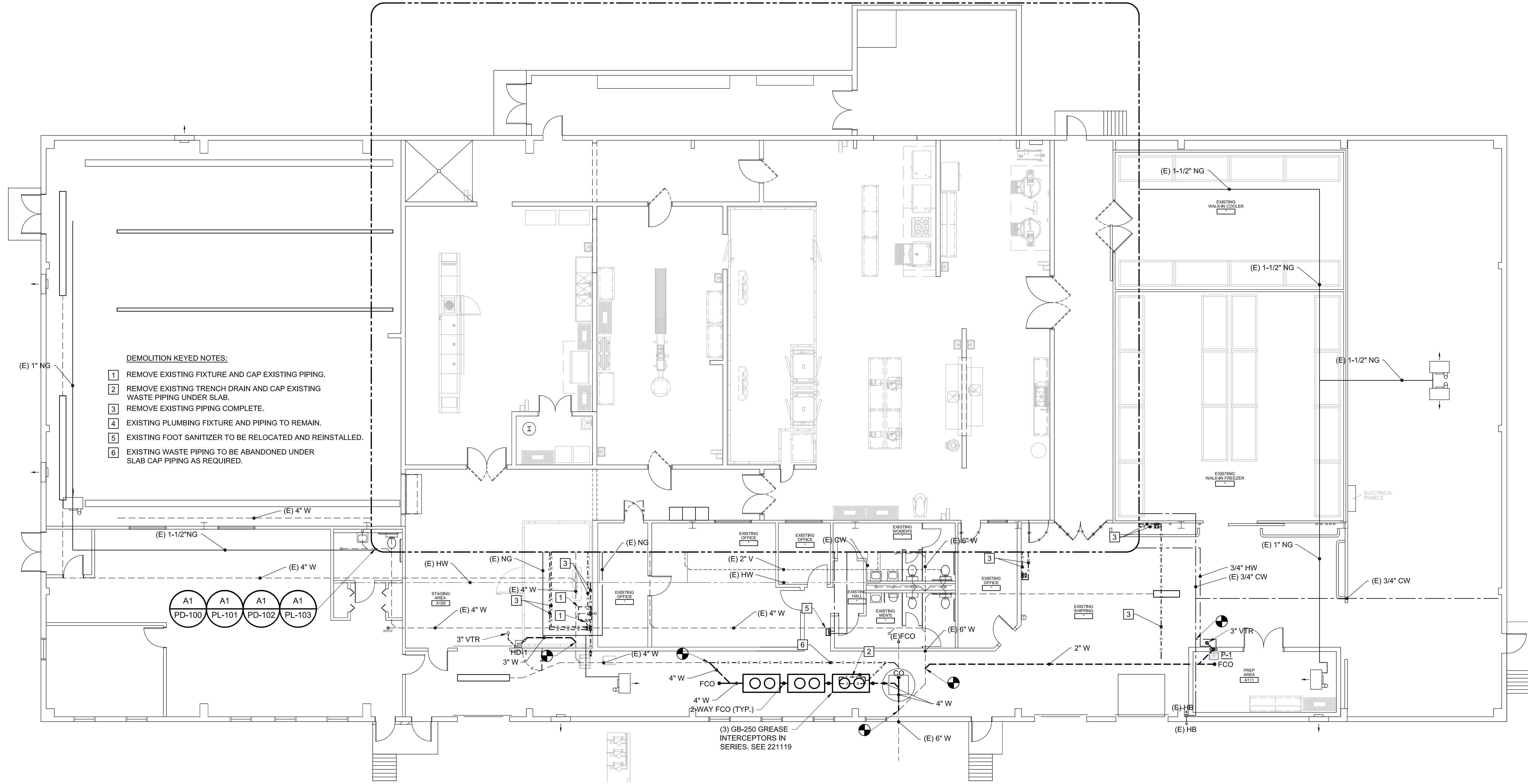

- DEMOLITION KEYED NOTES:**
- 1 REMOVE EXISTING FIXTURE AND CAP EXISTING PIPING.
 - 2 REMOVE EXISTING TRENCH DRAIN AND CAP EXISTING WASTE PIPING UNDER SLAB.
 - 3 REMOVE EXISTING PIPING COMPLETE.
 - 4 EXISTING PLUMBING FIXTURE AND PIPING TO REMAIN.
 - 5 EXISTING FOOT SANITIZER TO BE RELOCATED AND REINSTALLED.
 - 6 EXISTING WASTE PIPING TO BE ABANDONED UNDER SLAB CAP PIPING AS REQUIRED.

160 Veranda Street
 Portland, Maine 04103
 T: 207.221.2260
 F: 207.221.2266
 Web: www.allied-eng.com

Allied Engineering
 Structural Mechanical Electrical Commissioning

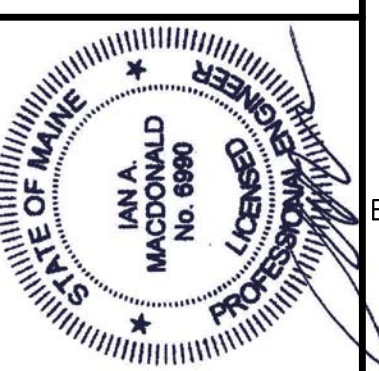

REVISIONS			
NUMBER	DATE	BY	DESCRIPTION

PLUMBING ~ OVER ALL PLAN

CITY OF PORTLAND
 PORTLAND PUBLIC SCHOOLS - CENTRAL KITCHEN
 92 WALDRON WAY, PORTLAND, MAINE

PL-100

A1 PLUMBING ~ OVER ALL PLAN
 1/8" = 1'-0"