

- LEGEND:**
- EXISTING WALL SHALL REMAIN
 - PROPOSED WALL
 - PARTITION TYPE - SEE DWG A-300
 - EXISTING WINDOW SHALL REMAIN
 - EXISTING DOOR SHALL REMAIN
 - EXISTING DOOR RELOCATED
 - PROPOSED DOOR - SEE SCHEDULE

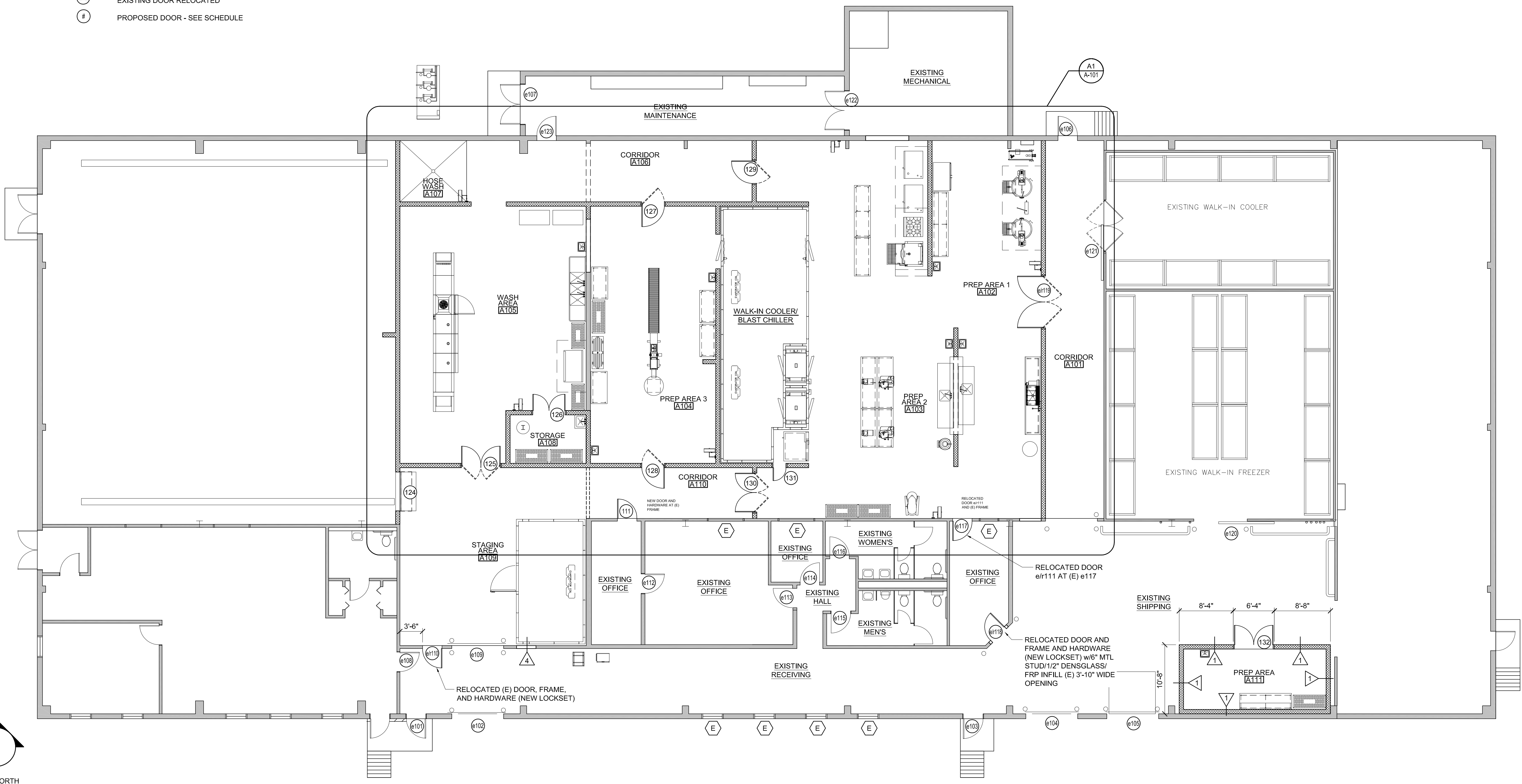

REVISIONS			
NUMBER	DATE	BY	DESCRIPTION

Date: 03/20/2013
 Drawn By: PED
 Checked By: MFM
 Project Mgr: IAM
 Project No: 13001
 Cad File: 13001A.dwg
 Graphic Scale: 0 1'

ARCHITECTURAL ~
FLOOR PLAN
CITY OF PORTLAND
PORTLAND PUBLIC SCHOOLS - CENTRAL KITCHEN
92 WALDRON WAY, PORTLAND, MAINE
© COPYRIGHT 2013 ALLIED ENGINEERING, INC.

N:\Projects\2013\13001 - Portland Public Schools - Central Kitchen\03 Drawing Files\13001A.dwg Mar 19, 2013 - 2:05pm

A1 ARCHITECTURAL ~ PROPOSED FLOOR PLAN
1/8" = 1'-0"