

FIRE ALARM LEGEND

Symbol	Description
	Smoke Detector
	Smoke Detector - local
	Combination Smoke/CO Detector
	Combination Smoke/CO Detector - local
	Heat Detector - rate of rise
	Heat Detector - fixed
	CO Detector
	Pull Station - dual action
	Pull Station - weather proof
	Horn/Strobe Unit
	Horn/Strobe Unit - weather proof
	Low Frequency Sounder
	Strobe Only Unit
	Exterior Beacon
	Monitor Module
	Flow Switch
	Tamper Switch
	Pressure Switch
	Power Supply
	Fire Alarm Control Panel
	Annunciator
	Fire Alarm Sprinkler Bell
	Remote Test Station
	Remote Alarm Indicator
	Key Box
	Control Module
	Master Box

FIRE ALARM GENERAL NOTES

1. FIRE ALARM INSTALLATION SHALL COMPLY WITH ALL LOCAL CODES AND REGULATIONS AND BE INSTALLED ACCORDING TO MANUFACTURERS INSTRUCTIONS.
2. ALL FIRE ALARM RACEWAY SIZES AND CIRCUITRY REQUIREMENTS SHALL BE IN ACCORDANCE WITH APPLICABLE CODES AND MANUFACTURERS RECOMMENDATIONS
3. PROVIDE 120V 20A DEDICATED CIRCUIT TO CONTROL PANELS, POWER SUPPLIES, ETC AS NEEDED. CIRCUIT BREAKERS SHALL BE EQUIPPED WITH LOCKS TO PREVENT ACCIDENTAL SHUT OFF AND BE CLEARLY MARKED "FIRE ALARM CIRCUIT"
4. WIRING SHALL BE COLOR CODED ACCORDING TO ALL APPLICABLE CODES AND SHALL BE MAINTAINED THROUGHOUT THE ENTIRE SYSTEM
5. ALL WIRING SHALL BE CHECKED AND TESTED TO ENSURE THERE ARE NO OPEN OR GROUND CONDITION PRIOR TO ENERGIZING SYSTEM
6. ALL STROBES SHALL BE SYNCHRONIZED AT THE END OF CONSTRUCTION
7. SMOKE DETECTORS HEADS SHALL NOT BE INSTALLED UNTIL AFTER THE CONSTRUCTION CLEANUP OF ALL TRADES IS COMPLETE AND FINAL IN ACCORDANCE WITH NFPA 72

PREPARED AND APPROVED BY
GARY J. EMOND
NICET LEVEL IV
SET #74053

DEAN & ALLYN, INC.
116 Lewiston Road
Gray, ME

NO.	REVISION/ISSUE	DATE
-	-	-
-	-	-

PROJECT NAME
BJ'S WHOLESALE
PORTLAND, ME

FILE
BJ WHOLESALE.DWG

DRAWN BY
B. G.

DATE
NOVEMBER 19, 2014

CHECKED BY
G. E.

DATE
NOVEMBER 19, 2014

SCALE
N/A

SHEET

FA-0

PAGE 1 OF 3

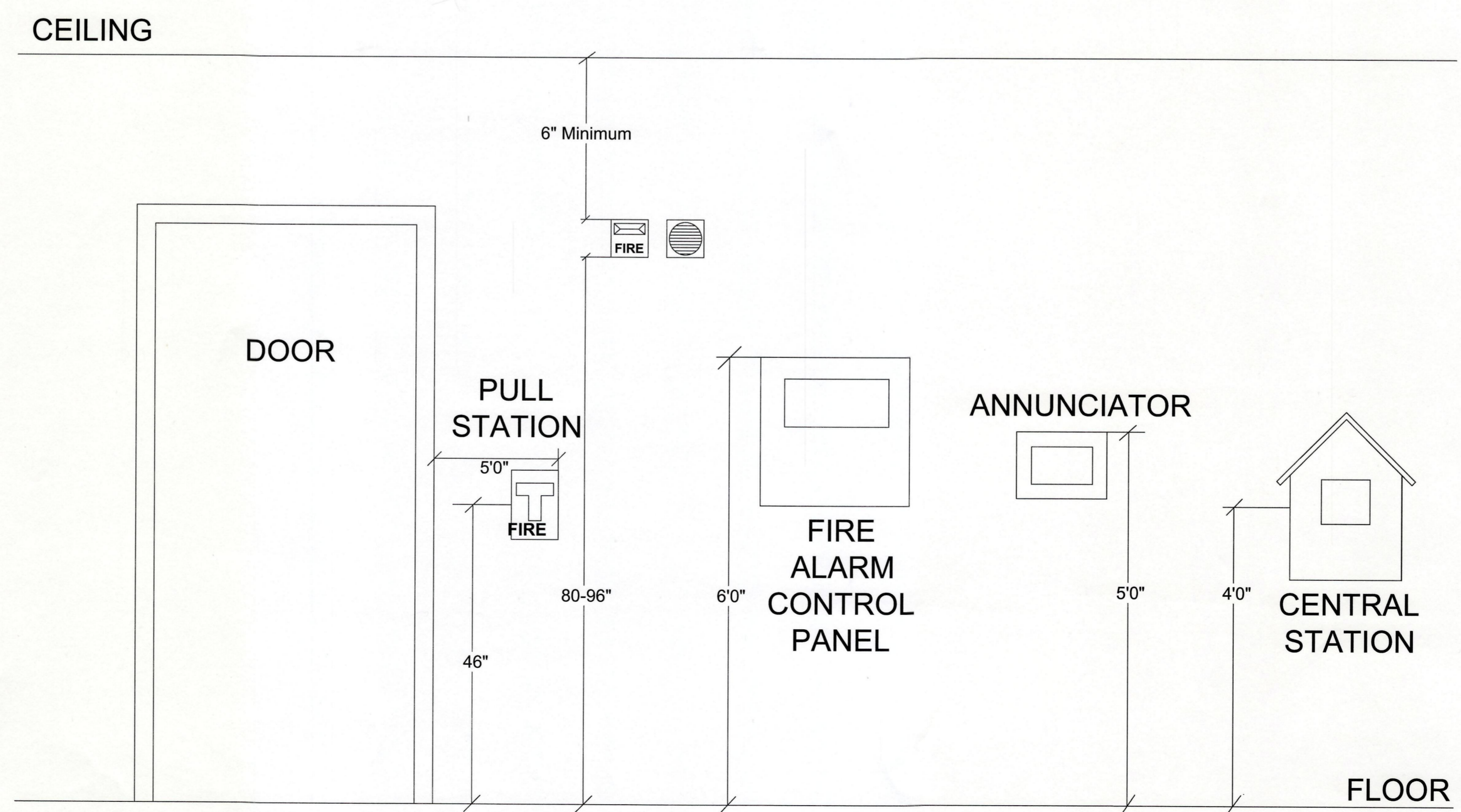

EXAMPLE OF FIRE ALARM DEVICE MOUNTING HEIGHTS



DEAN & ALLYN, INC.

116 Lewiston Road
Gray, ME

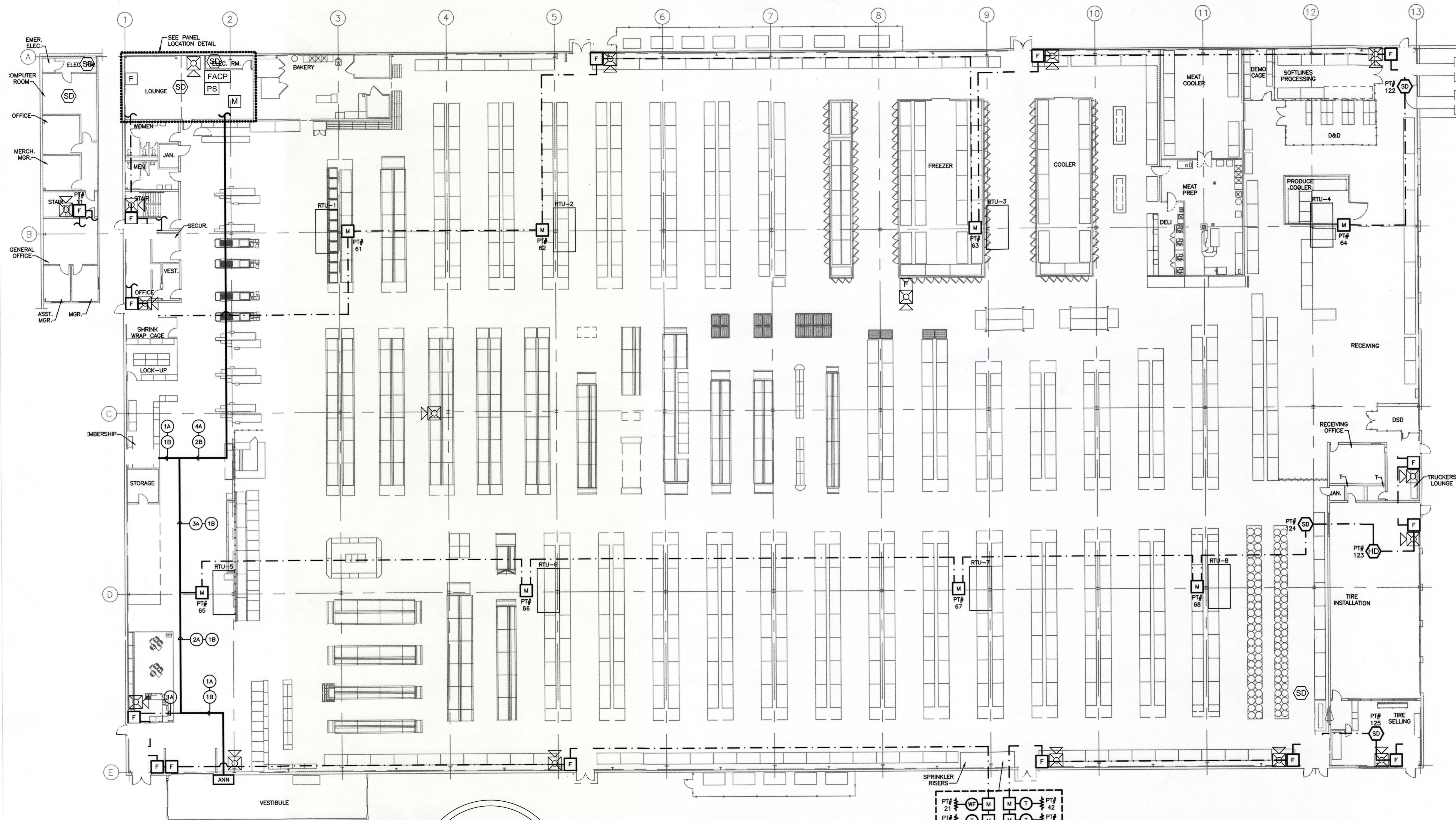

PREPARED AND
APPROVED BY
GARY J. EMOND
NICET LEVEL IV
SET #74053

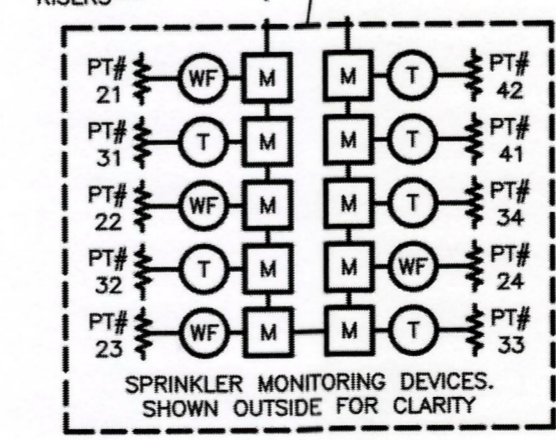

NO.	REVISION/ISSUE	DATE

PROJECT NAME
BJ'S WHOLESALE
PORTLAND, ME

FILE
BJ WHOLESALE.DWG

DRAWN BY
B. G.

DATE
NOVEMBER 19, 2014

CHECKED BY
G. E.

DATE
NOVEMBER 19, 2014

SCALE
N/A

SHEET

FA-1



Reviewed for Code Compliance
 Inspection Division
 Approved with Conditions
 Date: 01/05/15

PREPARED AND
 APPROVED BY
 GARY J. EMOND
 NICET LEVEL IV
 SET #74053

DEAN & ALLYN, INC.
 116 Lewiston Road
 Gray, ME

SYSTEM INPUTS	SYSTEM OUTPUTS																							
	Control Unit Annunciation				Notification				Outputs				Required Fire Safety Control				Supplementary							
	A	B	C	D	E	F	G	H	I	J	K	L	M	N	P	Q	R	S	T	U	V	W	X	Y
1 Manual Alarm Boxes	X	X			X	X	X	X	X	X														
2 Smoke Detectors	X	X			X	X	X	X	X	X														
3 In Duct Smoke Detectors			X	X									X											
4 Heat Detectors	X	X			X	X	X	X	X	X														
5 Waterflow Switches	X	X			X	X	X	X	X	X														
6 Sprinkler Tamper Switches			X	X								X												
7 Sprinkler Pressure Switches			X	X								X												
8 FACP Ground Fault					X	X	X						X											
9 FACP AC Power Failure					X	X	X						X											
10 FACP Battery Failure					X	X	X						X											
11 SLC Short Circuit					X	X	X						X											
12 SLC Open Circuit					X	X	X						X											
13 SLC Ground Fault					X	X	X						X											
15 NAC Short Circuit					X	X	X						X											
16 NAC Open					X	X	X						X											
17 NAC Ground Fault					X	X	X						X											
18 Annunciator Communications Failure					X	X	X						X											
19 Power Supply Trouble					X	X	X						X											

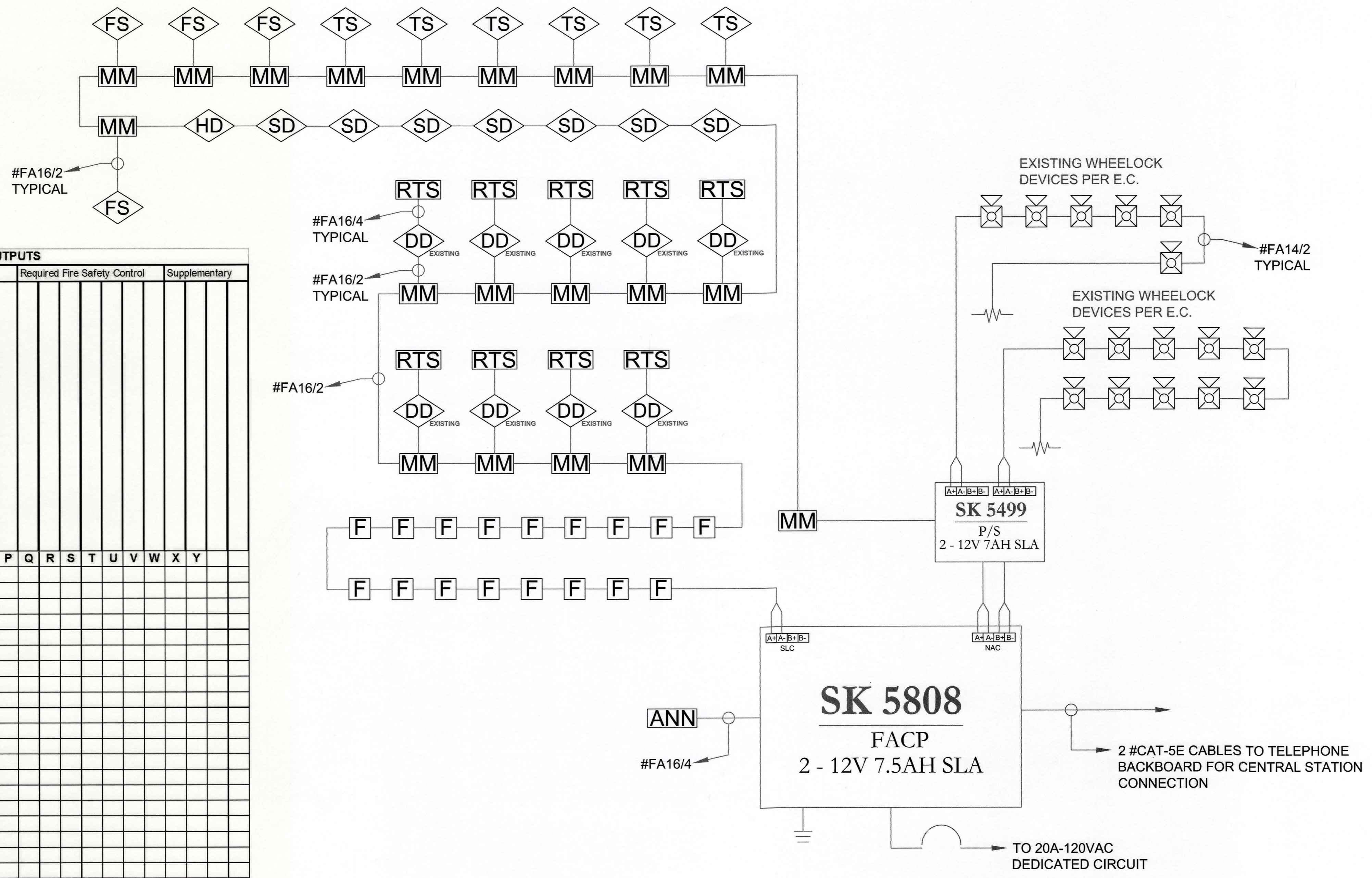

RISER DIAGRAM & MATRIX
 SHOWING DEVICES AND WIRING

NO.	REVISION/ISSUE	DATE

PROJECT NAME
 BJ'S WHOLESALE
 PORTLAND, ME

FILE
 BJ WHOLESALE.DWG

DRAWN BY
 B. G.

DATE
 NOVEMBER 19, 2014

CHECKED BY
 G. E.

DATE
 NOVEMBER 19, 2014

SCALE
 N/A

SHEET

FA-2

PAGE 3 OF 3



Reviewed for Code Compliance
Inspections Division
Approved with Conditions



Strengthening a Remarkable City, Building a Community for Life

Date: 01/05/15

Jeff Levine, AICP, Director
Director of Planning and Urban Development

Tammy Munson
Director, Inspections Division

Electronic Signature and Fee Payment Confirmation

Notice: Your electronic signature is considered a legal signature per state law.

By digitally signing the attached document(s), you are signifying your understanding this is a legal document and your electronic signature is considered a **legal signature** per Maine state law. You are also signifying your intent on paying your fees by the opportunities below.

I, the undersigned, intend and acknowledge that no permit application can be reviewed until payment of appropriate permit fees are **paid in full** to the Inspections Office, City of Portland Maine by method noted below:

- Within 24-48 hours, once my complete permit application and corresponding paperwork has been electronically delivered, I intend to **call the Inspections Office** at 207-874-8703 and speak to an administrative representative and provide a credit/debit card over the phone.
- Within 24-48 hours, once my permit application and corresponding paperwork has been electronically delivered, I intend to **hand deliver** a payment method to the Inspections Office, Room 315, Portland City Hall.
- I intend to deliver a payment method through the U.S. Postal Service mail once my permit paperwork has been electronically delivered.

Applicant Signature: Eric Elkanich

Date: 11/23/14

I have provided digital copies and sent them on:

Date: 11/23/14

NOTE: All electronic paperwork must be delivered to buildinginspections@portlandmaine.gov or by physical means ie; a thumb drive or CD to the office.



Fire Alarm Permit Application

If you or the property owner owes real estate or personal property taxes or user charges within the City, payment arrangements must be made before permits of any kind

Reviewed for Code Compliance
Inspections Division
Approved with Conditions

Date: 01/05/15

Address/Location of Construction: <u>B.I.'s • 513 WARREN AVE, PORTLAND 04103</u>		
Total Square Footage of Proposed Structure: <u>EXISTING</u>		
Tax Assessor's Chart, Block & Lot Chart# Block# Lot#	Applicant Name: <u>ERIC EIKANICH</u> Address: <u>DEAN & ALLYN, INC</u> <u>110 LEWISTON RD</u> City, State & Zip: <u>GRAY ME 04033</u>	Telephone: <u>657-5646</u> Email: <u>EIKANICH@DEANANDALYN.COM</u>
Lessee/Owner Name: <u>B.I.'s WHOLESALE CLUB</u> (if different than applicant) Address: <u>25 RESEARCH DR</u> City, State & Zip: <u>WESTBOROUGH, MA 01581</u> Telephone & E-mail:	Contractor Name: <u>SAME</u> (if different from Applicant) Address: <u>SAME</u> City, State & Zip: Telephone & E-mail:	Cost Of Work: <u>\$28,199.00</u> Fees: first \$1000 = \$25 fee + \$11 for every other \$1,000 of Cost of work Total Fees : \$ <u>322</u>
Current use (i.e. single family) <u>SHOPPING</u> If vacant, what was the previous use? <u>N/A</u> Proposed Specific use: <u>SAME</u> Is property part of a subdivision? <u>NO</u> If yes, please name _____ Project description:		
Who should we contact when the permit is ready: <u>ERIC EIKANICH</u>		
Address: <u>110 LEWISTON RD</u>		
City, State & Zip: <u>GRAY, ME 04033</u>		
E-mail Address: <u>EIKANICH@DEANANDALYN.COM</u>		
Telephone: <u>657-5646</u>		

Please submit all of the information outlined on the applicable checklist. Failure to do so causes an automatic permit denial.

In order to be sure the City fully understands the full scope of the project, the Planning and Development Department may request additional information prior to the issuance of a permit. For further information or to download copies of this form and other applications visit the Inspections Division on-line at www.portlandmaine.gov, or stop by the Inspections Division office, room 315 City Hall or call 874-8703.

I hereby certify that I am the Owner of record of the named property, or that the owner of record authorizes the proposed work and that I have been authorized by the owner to make this application as his/her authorized agent. I agree to conform to all applicable laws of this jurisdiction. In addition, if a permit for work described in this application is issued, I certify that the Code Official's authorized representative shall have the authority to enter all areas covered by this permit at any reasonable hour to enforce the provisions of the codes applicable to this permit.

Signature: [Signature] Date: 11-23-14

This is not a permit; you may not commence ANY work until the permit is issued.



Reviewed for Code Compliance
 Inspections Division
 Approved with Conditions

Fire Alarm Permit Application Checklist

Date: 01/05/15

All of the following information is required and must be submitted. Checking off each item as you prepare your application package will ensure your package is complete and will help to expedite the permitting process.

Complete and submit the following

- Design complies with City Code Ch. 10 and Fire Department Regulations Ch 5: _____
- Life Safety Code Occupancy Classification: Shopping
- A formal code analysis may be required depending on the complexity of the property: _____
- Is the top occupiable floor of the building greater than 75 ft. above the lowest level of fire department access (high-rise)? NO
- Is this new work or a renovation to an existing system? REPLACE OLD ALARM PANELS
- Name of company providing programming and certification of system DEAN & ALLYN, INC.
 (see <http://www.portlandmaine.gov/fireprevention/firealarmcompanies.asp> for approved companies):
- Vectored pdf plans and documents included
- Accurate scalable floor plan(s) _____
- Reflected ceiling or electrical plans are not acceptable. The plans shall be represent only the fire alarm system
- Each plan shall have a graphic scale
- Each plan shall have a 3 in. x 3 in. space reserved in the top right hand corner for city approval stamp
- Each plan shall have FA and a sheet number and a descriptive title on it
- Each sheet shall be saved as a separate file and named the sheet number and title (ex. FA-01 First Floor, FA-04 Wiring Diagram, etc.)
- In order to review revisions to previously submitted plans, each revision shall have the same file name as the previous version
- Each document shall be a separate file with a descriptive file name
- An example of one document and file is a four page data sheet for one smoke detector
- Designer qualifications (copy of NICET IV certificate or stamped plans and documents)
- Scope of work
- Wiring diagram(s)
- Annunciator details
- Operations matrix



Reviewed for Code Compliance
Inspections Division
Approved with Conditions

Date: 01/05/15

- Battery and voltage calculations
- Equipment data sheets
- A city electrical permit has been pulled

Master Box Approval (complete all items for approval)

- Is this check list applicable?
- Will a master box be installed? NO - MONITORED 24-7 BY PROTECTION ONE
- AES approved installing contractor? _____
- Documentation of AES approval: _____
- Property Owner? _____
- Property Owner Billing Address? _____
- Property common name: _____
- E-911 Address for protected premises: _____
- Life Safety Code Occupancy Classification: _____
- Emergency contact name: _____
- Emergency contact phone: (____) _____ - _____
- Additional emergency contact phone: (____) _____ - _____
- Number of stories protected? 1
- Number of square feet of structure protected? _____
- Is the building protected by a supervised, automatic sprinkler system? YES

* See Applicant Submittal Requirements for Electronic Plan Review.

Separate permits are required for internal and external plumbing, & electrical installations. For questions on Fire Department requirements call the Fire Prevention Officer at (207) 874-8405. Please submit all of the information outlined in this application checklist. If the application is incomplete, the application may be refused.

In order to be sure the City fully understands the full scope of the project, the Planning and Development Department may request additional information prior to the issuance of a permit. For further information or to download copies of this form and other applications visit the Inspections Division on-line at www.portlandmaine.gov, or stop by the Inspections Division office, room 315 City Hall or call 874-8703.

This is not a Permit; you may not commence any work until the Permit is issued.



November 23, 2014

Fire Alarm Scope of Work

**BJ's Wholesale Club #29
513 Warren Ave
Portland, ME 04103**

Existing System:

8 zone conventional Kidde fire alarm control panel that is monitored by Protection One. Building is fully sprinklered with water flow and tamper switches monitored thru the alarm panel. All egress man doors have manual pull stations and horn strobe devices are installed throughout the building. Additionally there are smoke detectors installed: Over tire storage, Over trash compactor, Within electrical closet and 2nd floor data rooms.

Reason for Fire Alarm Upgrade:

Customer has installed new HVAC roof top units with built in duct smoke detection. Since the existing panel is out of production and not expandable, a new addressable fire alarm control panel will be needed to monitor the new duct smoke detectors and other existing equipment.

New Fire Alarm System:

We propose installing a new Silent Knight addressable fire alarm control panel with additional NAC power supply to power the existing horn / strobe devices. The existing wiring, manual pull stations, horn / strobes, duct smoke detectors, water flow and tamper switches will remain however new monitor modules will be installed to convert these devices to addressable. Additionally the smoke detectors will be replaced with new addressable detectors. The existing annunciator will be replaced with an LCD unit compatible with the new panel. New remote duct smoke test switches will be installed to test and reset the HVAC duct smoke detectors. This upgraded fire alarm system will be setup to be monitored by the customer's existing central station (Protection One).

Eric Elkanich
Inspection / Alarm / Suppression Divs. Manager
116 Lewiston Road
Gray, Maine 04039
Tel: 207/657-5646 Fax: 207/657-5647
Mobile: 207/233-9104
www.deanandallyn.com