

**1** DEMOLITION FLOOR PLAN (BAKERY)  
 SCALE: 1/8" = 1'-0"

**1** DEMOLITION FLOOR PLAN (PRODUCE / MEAT / CHICKEN / DELI)  
 SCALE: 1/8" = 1'-0"

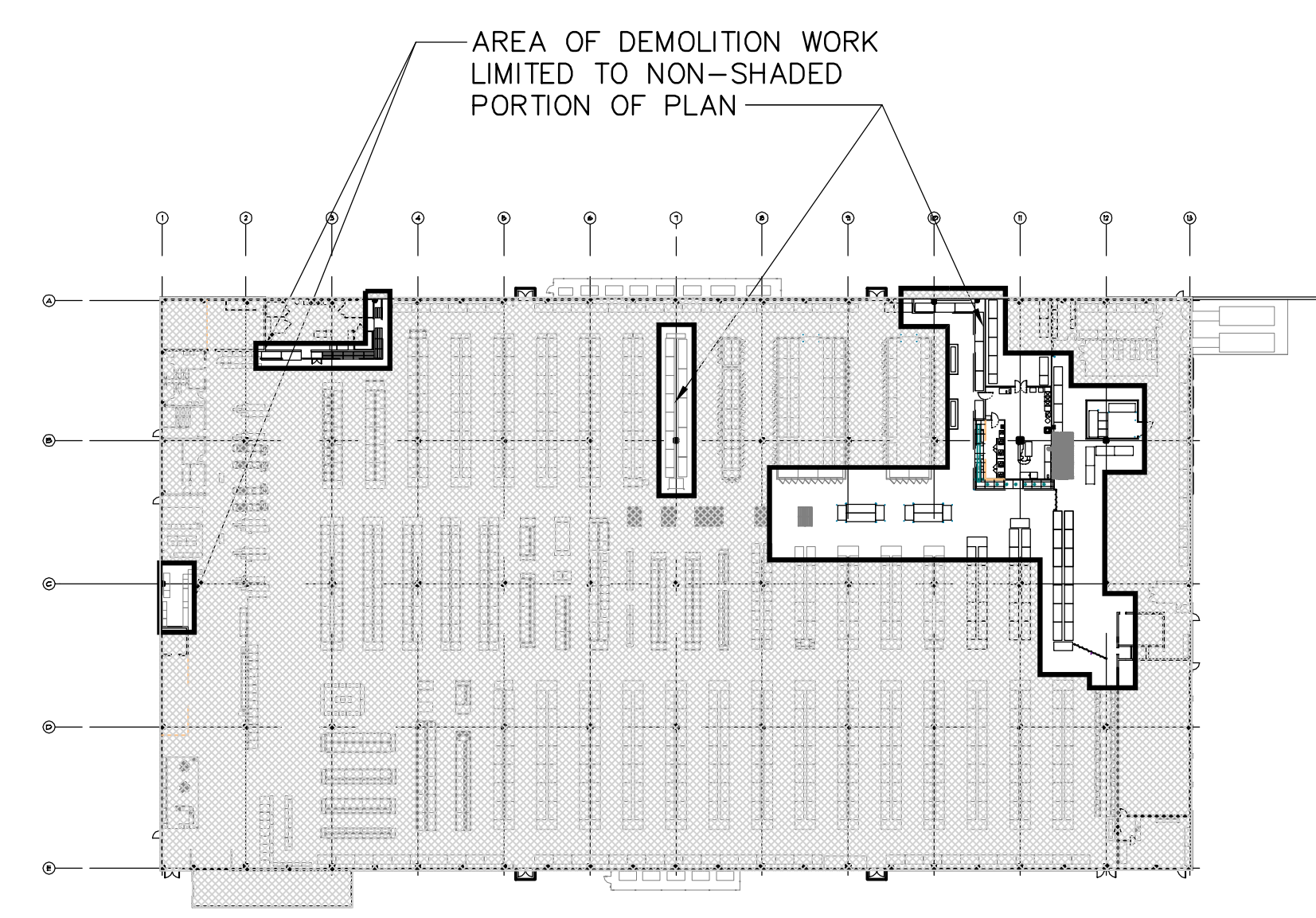

**KEY PLAN**  
 SCALE: NTS

**LEGEND**

	EXISTING WALL/DOOR TO BE REMOVED.
	EXISTING WALL/DOOR TO REMAIN.
	EXISTING FIXTURES TO BE REMOVED.

**KEYED DEMOLITION NOTES**

- 1 REMOVE FIXTURES/EQUIPMENT. SEE MEP DRAWINGS FOR FURTHER DIRECTION ON SELECTIVE DEMO FOR SPECIFIC TECHNICAL TRADES. REFER TO NOTE 16.
- 2 NOT USED.
- 3 REMOVE EXISTING HANGING RAIL, CURTAIN AND ATTACHMENT HARDWARE.
- 4 REMOVE EXISTING CART BUMPER AND POSTS IN THEIR ENTIRETY - PATCH HOLES IN EXISTING SLAB FLUSH w/ EXISTING.
- 5 REMOVE EXISTING WALL PANEL, FULL HEIGHT - INCL ALSO DOORS, HARDWARE, GLAZING & FRAMES WHERE INDICATED. COOLER PANEL DEMO BY BUS CONTR.
- 6 GC TO REMOVE ALL SHEETROCK OR COOLER PANEL SOFFITS, LIGHTING AND PAINT BEHIND THEM WHERE ANYTHING WILL BE EXPOSED TO STORE CUSTOMERS VIEW AFTER NEW SIGN PANEL INSTALLATION.
- 7 SAWCUT AND REMOVE EXISTING SLAB. PROTECT EXISTING COLUMNS AND FOOTINGS DURING SAW CUTTING AND EXCAVATION OF THE REFERENCED AREA. ACTUAL AREAS OF CONCRETE REMOVAL SHALL BE COORDINATED WITH PLUMBING DRAWINGS TO ENSURE EXACT DIMENSIONS. EDGES AND CORNERS OF SAW CUTS SHALL BE SMOOTH (NO RAILROADING), CLEAN AND STRAIGHT TO AVOID SPALLING OF EXISTING SLAB. IF SPALLING OCCURS DURING SLAB REMOVAL, RECUT EDGE PRIOR TO NEW CONCRETE PLACEMENT. ALL REMOVED CONCRETE SLABS SHALL BE REPLACED WITH 4000 PSI CONCRETE AND FINISHED WITH CONCRETE TO MATCH ADJACENT FLOOR FINISH.
- 8 REMOVE EXISTING LIGHT FIXTURES, HARDWARE, ELECTRICAL SUPPLY - COORDINATE w/ ELECTRICAL DRAWINGS.
- 9 DEMO ALL EXISTING PENDANT SPRINKLERS AND DROP PIPING IN EXISTING (TO BE REMOVED BY OTHERS) SOFFIT. PLUG OUTLETS AT OVERHEAD SUPPLY. NO NEW SPRINKLERS REQUIRED AT NEW SIGN PANEL WALL. AREA PROTECTION PROVIDED FROM OVERHEAD SYSTEM.
- 10 GC TO REMOVE RED CANOPIES, OLD SIGNAGE, LIGHTS AND PAINT THE WALLS, STEEL OR DECK WHERE ANYTHING WILL BE EXPOSED TO STORE CUSTOMERS VIEW AFTER NEW SIGN PANEL INSTALLATION.
- 11 SHADED AREA DENOTES EXISTING 4" NEW SLAB TO BE PREPARED (SCAFFERED) TO RECEIVE NEW FLOOR STAIN - PREPARE PER MANUFACTURERS SPECIFICATIONS.

**GENERAL DEMOLITION NOTES**

1. CLEAN FLOOR OF ALL DEBRIS, GREASE, DIRT, ETC. TO THE CONCRETE SUBSTRATE AT ALL REMOVALS. PATCH FLOOR TO MATCH EXISTING. ALL YELLOW PAINT REMOVED BY DEMO IN AFFECTED AREAS SHALL ALSO BE REPAINTED.
2. GENERAL CONTRACTOR SHALL REMOVE ALL PIPES AND VENTS THRU ROOF AT EQUIPMENT FIXTURE REMOVAL LOCATIONS AND REMOVE ELECTRICAL BACK TO SOURCE. COORDINATE WITH MEP DRAWINGS.
3. ALL DEMOLITION SHALL BE PERFORMED TO ACCOMMODATE NEW CONSTRUCTION. GENERAL CONTRACTOR SHALL REFER TO NEW CONSTRUCTION CONTRACT DOCUMENTS PRIOR TO PROCEEDING WITH DEMOLITION TO COORDINATE AND ENSURE EXTENT OF STRUCTURE & FINISHES TO BE REMOVED IS ADEQUATE TO ACCOMMODATE NEW CONSTRUCTION.
4. SEE PLUMBING, ELECTRICAL, HVAC & FIRE PROTECTION SYSTEMS DRAWINGS FOR EXTENT OF SELECTIVE DEMOLITION FOR THESE TRADES. THE GENERAL CONTRACTOR SHALL COORDINATE ALL DEMOLITION TO ANY OF THE ABOVE MENTIONED SYSTEMS AND MAINTAIN FULL OPERATION AND FUNCTIONAL CAPACITY OF SYSTEMS WHICH ARE TO REMAIN. REFER TO SPECIFICATION SECTION SELECTIVE DEMOLITION FOR ADDITIONAL INFORMATION.
5. ALL DEMOLITION MATERIAL SHALL BE DISPOSED OF LEGALLY OFF SITE BY GENERAL CONTRACTOR EXCEPT FOR MATERIAL TO BE REUSED AS DIRECTED.
6. SAW CUT AND REMOVE EXISTING SLAB TO ACCOMMODATE THE INSTALLATION OF NEW SANITARY. PROTECT EXISTING COLUMNS AND FOOTINGS DURING SAW CUTTING AND EXCAVATION OF THE REFERENCED AREA. ACTUAL AREAS OF CONCRETE REMOVAL SHALL BE COORDINATED WITH PLUMBING DRAWINGS TO ENSURE EXACT DIMENSIONS. EDGES AND CORNERS OF SAW CUTS SHALL BE SMOOTH (NO RAILROADING), CLEAN AND STRAIGHT TO AVOID SPALLING OF EXISTING SLAB. IF SPALLING OCCURS DURING SLAB REMOVAL, RECUT EDGE PRIOR TO NEW CONCRETE PLACEMENT. ALL REMOVED CONCRETE SLABS SHALL BE REPLACED WITH 4000 PSI CONCRETE AND SHALL BE MATCHED TO ADJACENT FLOOR FINISH. SEE ENLARGED PLAN THIS SHEET. ALL FLOOR REPAIRS TO BE w/ METZGER / McGUIRE PRODUCTS ONLY.
7. GENERAL CONTRACTOR SHALL COORDINATE ALL PHASES OF DEMOLITION FOR PROJECT AND NOTIFY THE DESIGN TEAM OF ANY DISCREPANCIES OR CONFLICTING CONDITIONS WHICH WOULD INTERFERE WITH THE SATISFACTORY COMPLETION OF THE WORK, PRIOR TO THE START OF DEMOLITION.
8. WHERE EXISTING MATERIALS AND FINISHES ARE DISTURBED OR LEFT INCOMPLETE BY THE REMOVALS OR CHANGES SHOWN ON ALL DRAWINGS, THE GENERAL CONTRACTOR SHALL CUT, PATCH AND FINISH THESE FLOORS, WALLS, CEILING, AND FINISHES ETC TO MATCH ADJACENT FINISHES.
9. PROTECT EXISTING ITEMS TO REMAIN AS REQUIRED, REPLACE ANY ITEMS DAMAGED BY CONTRACTOR TO ORIGINAL CONDITION.
10. ALL WORK SHALL COMPLY WITH APPLICABLE LOCAL AND CITY BUILDING CODES AS WELL AS ANY REGULATORY AGENCIES I.E. OSHA. IT SHALL BE THE RESPONSIBILITY OF THE GENERAL CONTRACTOR TO MAKE THEMSELVES FAMILIAR WITH LOCAL REGULATIONS REGARDING HOURS IN WHICH DEBRIS MAY BE REMOVED FROM THE SITE. GC IS RESPONSIBLE FOR TRANSPORTING DEBRIS TO A LEGAL PERMITTED LANDFILL OR TRANSFER STATION.
11. NO SAW CUTTING WITHOUT AN ELECTRICIAN ON SITE THROUGHOUT THE PROCESS.
12. NO SAW CUTTING WHEN THE CLUB IS OPEN.
13. REFER TO THE SPECIFICATION SECTION 'SPRINKLER SYSTEMS RENOVATIONS' FOR DEMOLITION SCOPE OF WORK.
14. SCHEDULE OF DEMOLITION SHALL COORDINATE WITH PHASING PLAN AND CPM.
15. ALL AREAS SCHEDULED TO RECEIVE SAW CUTS AND CONCRETE SLAB REMOVAL SHALL BE X-RAYED TO DETERMINE EXISTING SUB-SURFACE CONDITIONS.
16. BOLLARDS/GUARD RAILS/STEEL RACKING THAT ARE BOLTED TO THE FLOOR SHALL BE REMOVED AND SHALL HAVE BOLTS GROUND TO A MIN. OF 3/4" BELOW THE FLOOR SO THAT EPOXY MAY BE FLOATED LEVEL WITH THE ADJACENT FINISH FLOOR LEVEL. IF THE BOLLARD IS A CORE DRILL INSTALLATION, THE BOLLARD SHALL BE CORE DRILLED AND THE CORE SHALL BE A MIN. OF 4" DIAMETER GREATER THAN THE BOLLARD SO THAT THE SLAB MAY BE FLOATED AND FINISHED WITH CONCRETE TO MATCH THE ADJACENT FLOOR LEVEL.
17. BUS WHOLESALE SHALL PROVIDE ALL DUMPSTERS NEEDED FOR DEMO AND CONSTRUCTION. GC TO COORDINATE. GC TO ALSO PROVIDE STORAGE CONTAINERS FOR USE IN STORING/RECEIVING EQUIPMENT/MATERIALS.

**Revisions**

#	Date	Title
03/14/2016		for REVIEW
03/18/2016		for PERMIT / BID

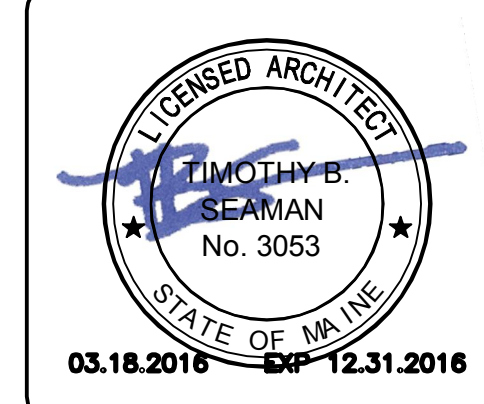

Client:  
**BJS WHOLESALE CLUB**

**BUS WHOLESALE CLUB #029 PORTLAND ME**

DATE: 03.18.2016 PROJECT NO: 160113

SHEET TITLE  
**DEMOLITION PLANS**

SHEET NUMBER  
**D101**