



REMODEL FOR BJ'S WHOLESALE CLUB CLUB #029 PORTLAND 513 WARREN AVENUE PORTLAND, ME 04103



PROJECT DIRECTORY CODE SUMMARY ABBREVIATIONS INDEX OF DRAWINGS

ARCHITECT : ARCHITECTURAL GROUP INTERNATIONAL, INC.
CONTACT: SCOTT KYLE
15W 7TH STREET
COVINGTON, KY 41011
T: (859)-261-5400
E: skyle@agi-us.com

MEP PROJECT MANAGER: KLH ENGINEERS
CONTACT: BRETT BOSSE
1538 ALEXANDRIA PIKE, STE. 11
FT. THOMAS, KY 41075
T: (859)-442-8050
F: (859)-442-8058
E: bbosse@klhengrs.com

REFRIGERATION ENGINEER: KLH ENGINEERS
CONTACT: WILL BARDO
1538 ALEXANDRIA PIKE, STE. 11
FT. THOMAS, KY 41075
T: (859)-442-8050
F: (859)-442-8058
E: wbardo@klhengrs.com

ELECTRICAL ENGINEER : KLH ENGINEERS
CONTACT: MIKE ETEN
1538 ALEXANDRIA PIKE, STE. 11
FT. THOMAS, KY 41075
T: (859)-442-8050
F: (859)-442-8058
E: meten@klhengrs.com

MECHANICAL ENGINEER : KLH ENGINEERS
CONTACT: STEFON TOWLER
1538 ALEXANDRIA PIKE, STE. 11
FT. THOMAS, KY 41075
T: (859)-442-8050
F: (859)-442-8058
E: stowler@klhengrs.com

PLUMBING: KLH ENGINEERS
CONTACT: JARED GIBSON
1538 ALEXANDRIA PIKE, STE. 11
FT. THOMAS, KY 41075
T: (859)-442-8050
F: (859)-442-8058
E: jgibson@klhengrs.com

FIRE PROTECTION: TELGIAN CORPORATION
CONTACT: GRACE LARGE
10230 SOUTH 50th PLACE
PHOENIX, AZ 85044
T: (480)-292-8091
E: glarge@telgian.com

PROJECT : BJ'S WHOLESALE CLUB #029
LOCATION : 513 WARREN AVENUE
PORTLAND, ME 04103

OWNER CONTACT: JOHN CHISOLM
BJ'S WHOLESALE CLUB, INC
25 RESEARCH DRIVE
WESTBOROUGH, MA 01581
781-864-3164

APPLICABLE CODES: MAINE UNIFORM BUILDING CODE (MUBEC)
BUILDING CODE: 2009 IBC-2009 IEBC
PLUMBING CODE: 2009 IPC
MECHANICAL CODE: 2009 IMC
ELECTRICAL CODE: 2008 NEC (NFPA 70)
ACCESSIBILITY CODE: 2009 IBC ACCESSIBILITY
ENERGY CODE: 2009 IECC
FIRE CODE: NFPA 1 (CURRENT EDITION)

CONSTRUCTION TYPE: EXISTING

AREA: 104,695 SF EXISTING

USE CLASSIFICATION: MERCANTILE, M

AFFECTED AREA: 5,245 SF

FIRE PROTECTION: FULLY SPRINKLED (EXISTING)

EXIT TRAVEL: 250' ALLOWED

A.C.T.	ACOUSTICAL CEILING	FD	FLOOR DRAIN FOUNDATION	N.T.S.	NOT TO SCALE
A.F.F.	ABOVE FINISH FLOOR	FDN.	FOUNDATION	O.D.	OUTSIDE DIAMETER
ALT.	ALTERNATE	F.L.	FLOW LINE	O.R.D.	OVERHEAD ROOF DRAIN
APPROX.	APPROXIMATE	FLR.	FLOOR	OH.	OVERHEAD
ALUM.	ALUMINUM	FURR.	FURRING	OPP.	OPPOSITE
A.B.	ANCHOR BOLT	FTC.	FOOTING	O.C.	ON CENTER
A.C.	ACOUSTICAL	FIN.	FINISH(ED)	OPN'G	OPENING
ACOUST.	ACOUSTICAL	F.R.T.	FIRE RESISTANT TREATED	PLAS. LAM.	PLASTIC LAMINATE
ASPH.	ASPHALT	GA.	GAUGE	PL.	PLATE
BLK'G	BLOCKING BOARD	GALV.	GALVANIZED	PLYWD.	PLYWOOD
BD.	BUILDING BOARD	GD.	GUTTER DRAIN	PR	PAIR
BLDG.	BUILDING	GL.	GLASS	RAD.	RADIUS
BM.	BEAM	GYP.	GYP'SUM	REQ'D	REQUIRED
BOT.	BOTTOM	GRD.	GRADE	REINF.	REINFORCED
CONTR.	CONTRACTOR	G.W.B.	GYP'SUM WALL BOARD	RESIL.	RESILIENT
CLG.	CONCRETE	HDWD	HARDWOOD	RM.	ROOM
CONC.	CONTINUOUS	H.	HEIGHT	R.O.	ROUGH OPENING
CONT.	CONTROL JOINT	HT.	HOLLOW CORE	SFRM.	SPRAY APPLIED FIRE RESISTIVE MATL.
C.J.	COLUMN	HC.	HORIZONTAL	STL.	STEEL
COL.	CONSTRUCTION MANAGER	HORIZ.	HOLLOW METAL	SUSP. CLG.	SUSPENDED CEILING
C.M.	CONCRETE MASONRY	H.M.	HIGH POINT	SIM.	SIMILAR
C.M.U.	CONCRETE MASONRY UNITS	H.P.	HIGH POINT	SPEC'S.	SPECIFICATIONS
CLR.	CLEAR	I.D.C.	INSIDE DIMENSION CLEAR	SO.	SQUARE
CTR.	CENTER	I.D.	INSIDE DIAMETER	STD.	STANDARD
D.	DEEP	INSUL.	INSULATION	STRUCT.	STRUCTURAL
DN.	DOWN	INT.	INTERIOR	T.O.M.	TOP OF MASONRY
DIA.	DIAMETER	JOINT	JOINT	T.O.S.	TOP OF STEEL
DWG.	DRAWING	JT.	JANITOR	T.O.W.	TOP OF WALL
DS.	DOWNSPOUT	JAN.	JANITOR	TYP.	TYPICAL
DR.	DOOR	L.	LONG	U.O.N.	UNLESS OTHERWISE NOTED
DTL./DET.	DETAIL	LAM.	LAMINATE	V.C.T.	VINYL COMPOSITION TILE
E.W.C.	ELECTRIC WATER COOLER	LAV.	LAVATORY	W.	WIDE
EXIST.	EXISTING	L.P.	LOW POINT	W/W.	WITH
EXP.	EXPANSION	MAX.	MAXIMUM	WD.	WOOD
ELEC.	ELECTRICAL	MTL.	METAL		
EQUIP.	ELECTRICAL EQUIPMENT	MIN.	MINIMUM		
EA.	EACH	MECH.	MECHANICAL		
ELEV.	ELEVATION	MISC.	MISCELLANEOUS		
EQ.	EQUAL	MTD.	MOUNTED		
		M.O.	MASONRY OPENING		
		N.I.C.	NOT IN CONTRACT		
		NO.	NUMBER		

#	Date	Title	REVIEW 03/14/16	PERMIT / BID 03/18/16
ARCHITECTURAL PLANS				
CS001		COVER SHEET	•	•
D101		DEMOLITION PLAN	•	•
A101		FLOOR PLAN	•	•
A200		PARTITION, DOOR SCHEDULE & DETAILS	•	•
A501		ENLARGED PLANS	•	•
A600		WALL SECTIONS (INTERIOR SIGN PANELS)	•	•
MECHANICAL PLANS				
M101		HVAC FLOOR PLAN	•	•
M201		HVAC DETAILS & SCHEDULES	•	•
PLUMBING PLANS				
P001		PLUMBING SCHEDULES, NOTES AND LEGEND	•	•
P100		DEMO PLUMBING PLAN	•	•
P300		PLUMBING PLANS	•	•
ELECTRICAL PLANS				
E001		ELECTRICAL LEGEND	•	•
E030		SINGLE LINE DIAGRAM	•	•
E100		DEMO LIGHTING PLAN	•	•
E101		LIGHTING PLAN	•	•
E201		POWER PLAN	•	•
E800		ELECTRICAL DETAILS	•	•
E900		ENERGY COMPLIANCE FORMS	•	•

LOCATION MAP

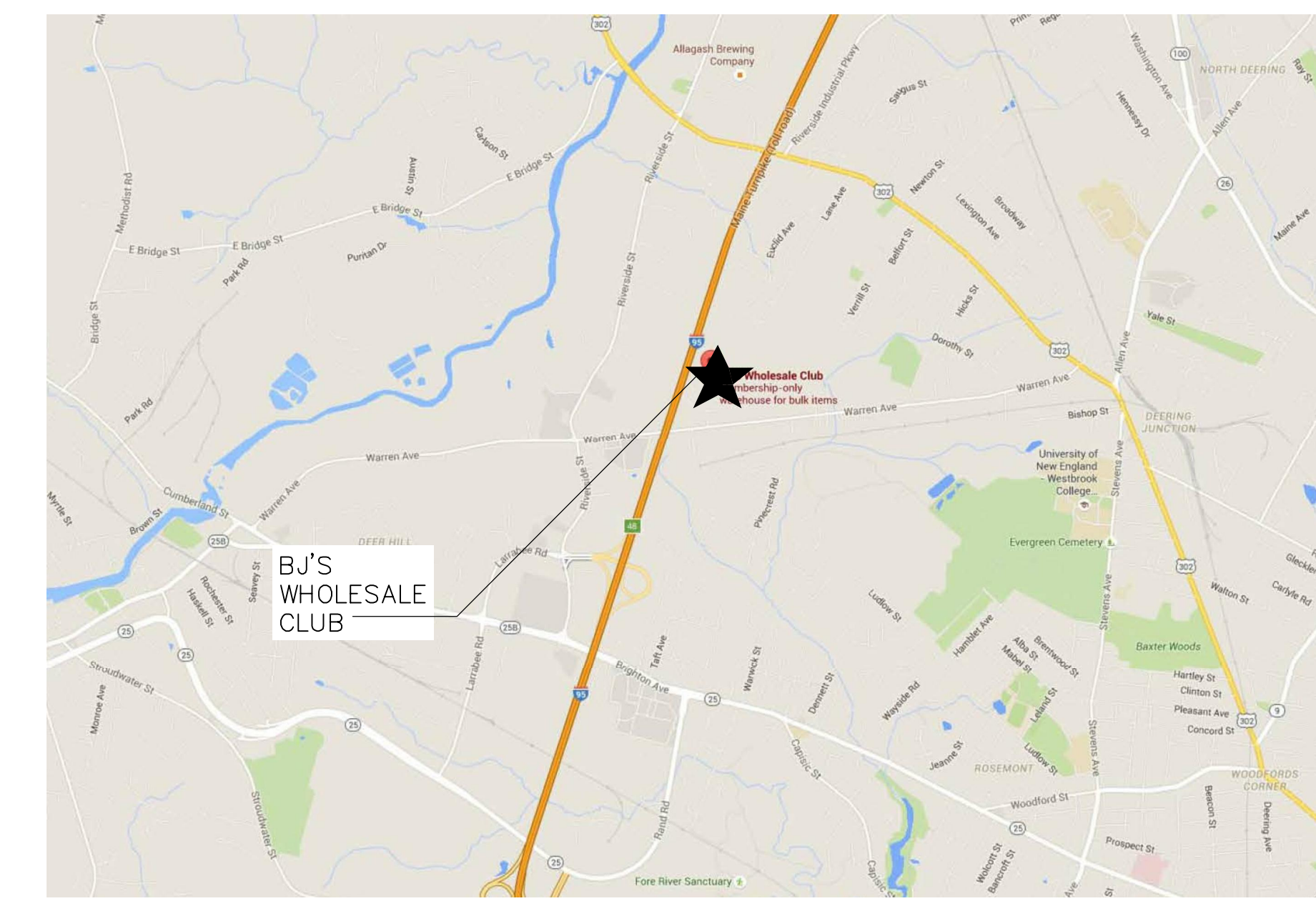

SYMBOL LEGEND

	ELEVATION MARKER INDICATING THE ELEVATION AND SHEET WHERE IT IS LOCATED		DETAIL MARKER INDICATING THE DETAIL AND SHEET WHERE IT IS LOCATED
	WALL SECTION MARKER INDICATING THE WALL SECTION AND SHEET WHERE IT IS LOCATED		ROOM NUMBER IDENTIFICATION
	INTERIOR ELEVATION MARKER INDICATING THE INTERIOR ELEVATION AND SHEET WHERE IT IS LOCATED		DOOR NUMBER IDENTIFICATION
	REFERENCE ELEVATION INDICATOR		WINDOW NUMBER IDENTIFICATION
	CEILING HEIGHT MARKER		KEYED NOTE
	INTERIOR PARTITION TYPE		REVISION MARK

AREA OF WORK

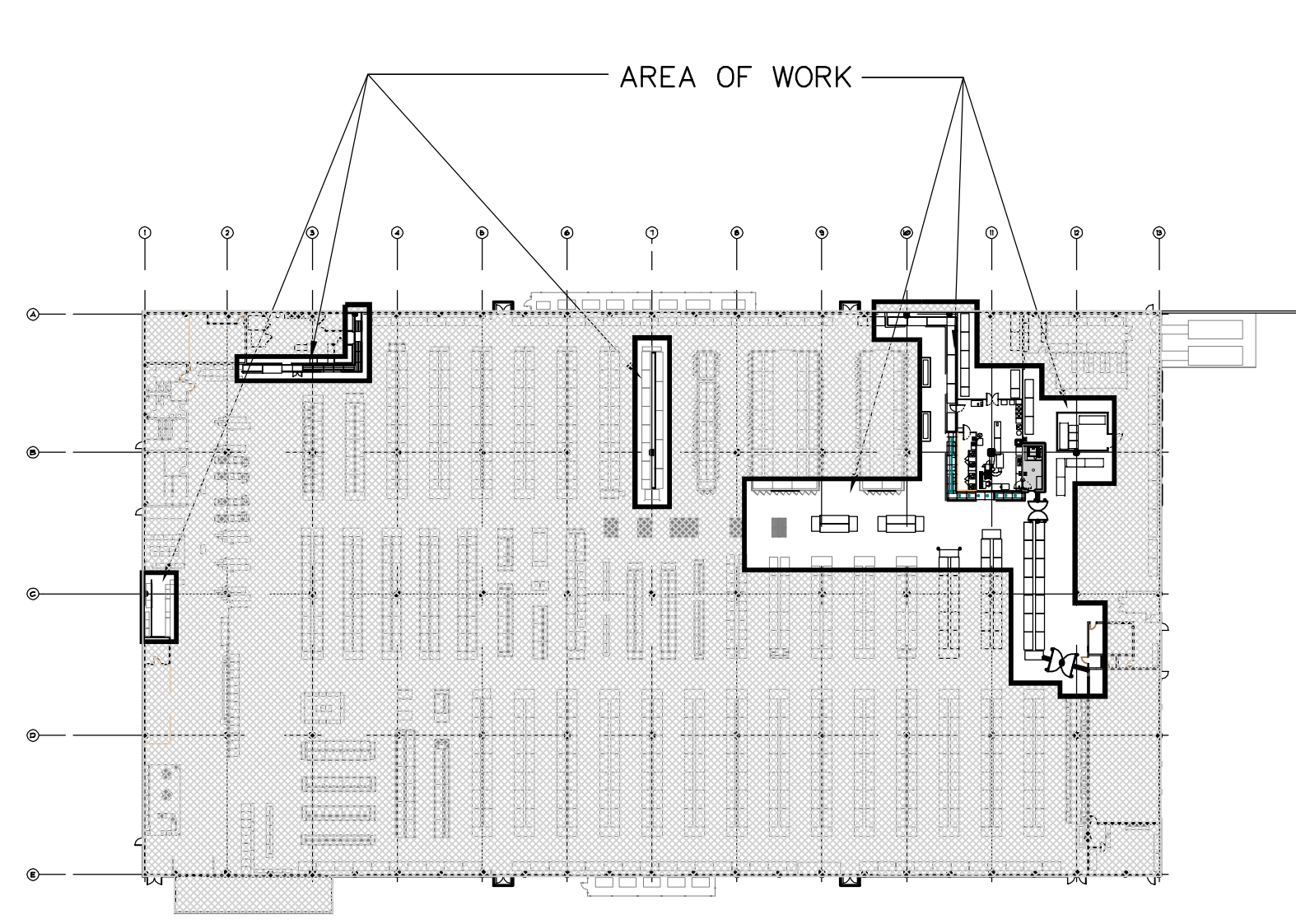

#	Date	Title
03/14/16		for REVIEW
03/18/16		for PERMIT / BID

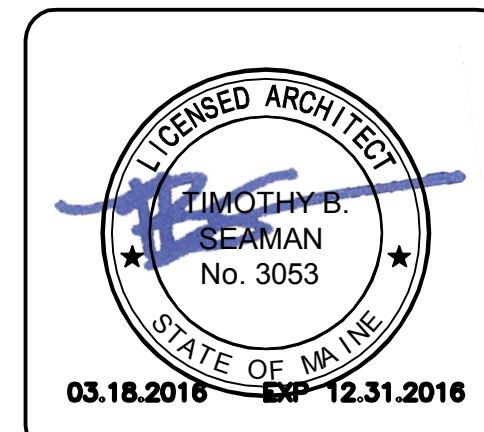

BJ'S WHOLESALE CLUB #029 PORTLAND ME

DATE: 03/18/16 PROJECT NO.: 16-013

COVER SHEET

SHEET NUMBER: **CS001**