

City of Portland, Maine - Building or Use Permit Application

389 Congress Street, 04101 Tel: (207) 874-8703, Fax: (207) 874-8716

Permit No: 08-0973	Issue Date:	CBL: 304 B033002
-----------------------	-------------	---------------------

Location of Construction: 429 WARREN AVE REAR	Owner Name: BJ/PORTLAND LIMITED PARTN	Owner Address: 1 MERCER RD	Phone: 207-774-2300
Business Name:	Contractor Name: Air Temp	Contractor Address: 11 Wallace Ave South Portland	Phone 2077742300
Lessee/Buyer's Name	Phone:	Permit Type: HVAC	Zone:

Past Use: Retail / BJ'S Wholesale Club	Proposed Use: Retail / BJ'S Wholesale Club - Alterations to existing refrigeration system	Permit Fee: \$110.00	Cost of Work: \$8,688.00	CEO District: 5
		FIRE DEPT: <input type="checkbox"/> Approved <input checked="" type="checkbox"/> Denied <i>N/A</i>	INSPECTION: Use Group: <i>U</i> Type:	

Proposed Project Description: Alterations to existing refrigeration system	Signature: <i>[Signature]</i>	Signature: <i>[Signature]</i>
PEDESTRIAN ACTIVITIES DISTRICT (P.A.D.)		
Action: <input type="checkbox"/> Approved <input type="checkbox"/> Approved w/Conditions <input checked="" type="checkbox"/> Denied		
Signature:		Date:

Permit Taken By: lmd	Date Applied For: 08/07/2008	Zoning Approval
-------------------------	---------------------------------	------------------------

- This permit application does not preclude the Applicant(s) from meeting applicable State and Federal Rules.
- Building permits do not include plumbing, septic or electrical work.
- Building permits are void if work is not started within six (6) months of the date of issuance. False information may invalidate a building permit and stop all work..

Special Zone or Reviews <input type="checkbox"/> Shoreland <input type="checkbox"/> Wetland <input type="checkbox"/> Flood Zone <input type="checkbox"/> Subdivision <input type="checkbox"/> Site Plan Maj <input type="checkbox"/> Minor <input type="checkbox"/> MM <input type="checkbox"/> Date: <i>8/12/08</i>	Zoning Appeal <input type="checkbox"/> Variance <input type="checkbox"/> Miscellaneous <input type="checkbox"/> Conditional Use <input type="checkbox"/> Interpretation <input type="checkbox"/> Approved <input type="checkbox"/> Denied Date:	Historic Preservation <input checked="" type="checkbox"/> Not in District or Landmark <input type="checkbox"/> Does Not Require Review <input type="checkbox"/> Requires Review <input type="checkbox"/> Approved <input type="checkbox"/> Approved w/Conditions <input type="checkbox"/> Denied Date: <i>8/12/08</i>
--	---	---

CERTIFICATION

I hereby certify that I am the owner of record of the named property, or that the proposed work is authorized by the owner of record and that I have been authorized by the owner to make this application as his authorized agent and I agree to conform to all applicable laws of this jurisdiction. In addition, if a permit for work described in the application is issued, I certify that the code official's authorized representative shall have the authority to enter all areas covered by such permit at any reasonable hour to enforce the provision of the code(s) applicable to such permit.

SIGNATURE OF APPLICANT	ADDRESS	DATE	PHONE
RESPONSIBLE PERSON IN CHARGE OF WORK, TITLE		DATE	PHONE



FILL IN AND SIGN WITH INK

APPLICATION FOR PERMIT HEATING OR POWER EQUIPMENT

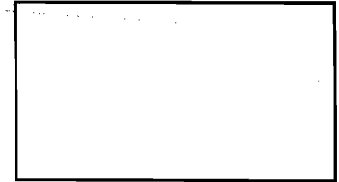

304-B-033002

To the INSPECTOR OF BUILDINGS, PORTLAND, ME.

The undersigned hereby applies for a permit to install the following heating, cooking or power equipment in accordance with the Laws of Maine, the Building Code of the City of Portland, and the following specifications:

Location / CBL 513 Warren Ave Use of Building Retail Date 8/5/08
Name and address of owner of appliance BJ's Wholesale Club

Installer's name and address William Packard / Airtemp Mechanical 11 Wallace Ave. South Portland Telephone (207) 774-2300

Location of appliance:

- Basement
- Attic
- Floor
- Roof

Type of Fuel:

- Gas
- Oil
- Solid

Appliance Name: _____

U.L. Approved Yes No

Will appliance be installed in accordance with the manufacture's installation instructions? Yes No

IF NO Explain: _____

The Type of License of Installer:

- Master Plumber # _____
- Solid Fuel # _____
- Oil # _____
- Gas # _____
- Other Universal Refrigerant

Type of Chimney:

- Masonry Lined
Factory built _____
- Metal
Factory Built U.L. Listing # _____
- Direct Vent
Type _____ UL# _____

Type of Fuel Tank

- Oil
- Gas

AUG 7 2008

Size of Tank _____

Number of Tanks _____

Distance from Tank to Center of Flame _____ feet.

Cost of Work: \$ 8,688

Permit Fee: \$ 106

Approved

Approved with Conditions

Fire: _____
Ele.: _____
Bldg.: _____

See attached letter or requirement

Inspector's Signature _____

Date Approved _____

Signature of Installer William J. [Signature]

White - Inspection Yellow - File Pink - Applicant's Gold - Assessor's Copy

City of Portland, Maine - Building or Use Permit

389 Congress Street, 04101 Tel: (207) 874-8703, Fax: (207) 874-8716

Permit No: 08-0973	Date Applied For: 08/07/2008	CBL: 304 B033002
------------------------------	--	----------------------------

Location of Construction: 429 WARREN AVE REAR	Owner Name: BJ/PORTLAND LIMITED PARTN	Owner Address: 1 MERCER RD	Phone: 207-774-2300
Business Name:	Contractor Name: Air Temp	Contractor Address: 11 Wallace Ave South Portland	Phone: (207) 774-2300
Lessee/Buyer's Name	Phone:	Permit Type: HVAC	

Proposed Use: Retail / BJ'S Wholesale Club - Alterations to existing refrigeration system	Proposed Project Description: Alterations to existing refrigeration system
---	--

Dept: Zoning **Status:** Approved **Reviewer:** Tammy Munson **Approval Date:** 08/12/2008

Note: **Ok to Issue:**

- 1) This permit is being approved on the basis of plans submitted. Any deviations shall require a separate approval before starting that work.

Dept: Building **Status:** Approved with Conditions **Reviewer:** Tammy Munson **Approval Date:** 08/12/2008

Note: **Ok to Issue:**

- 1) Separate permits are required for any electrical, plumbing, or HVAC systems.
Separate plans may need to be submitted for approval as a part of this process.

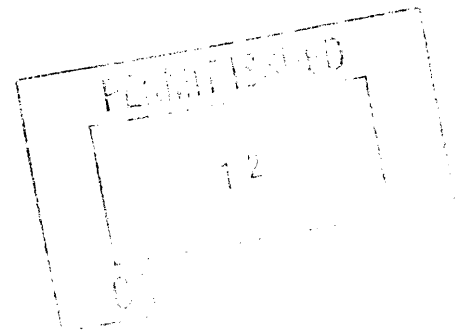

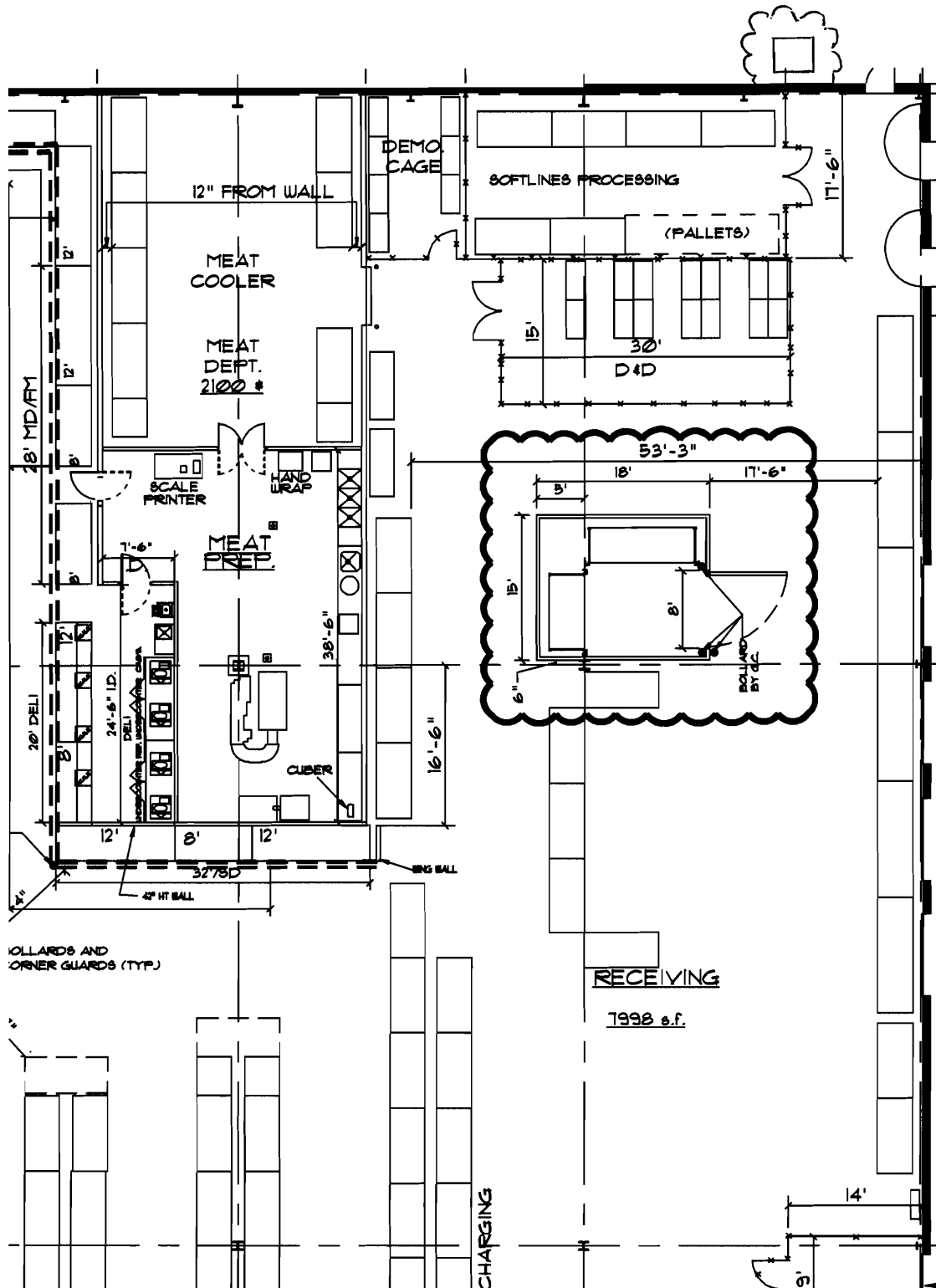

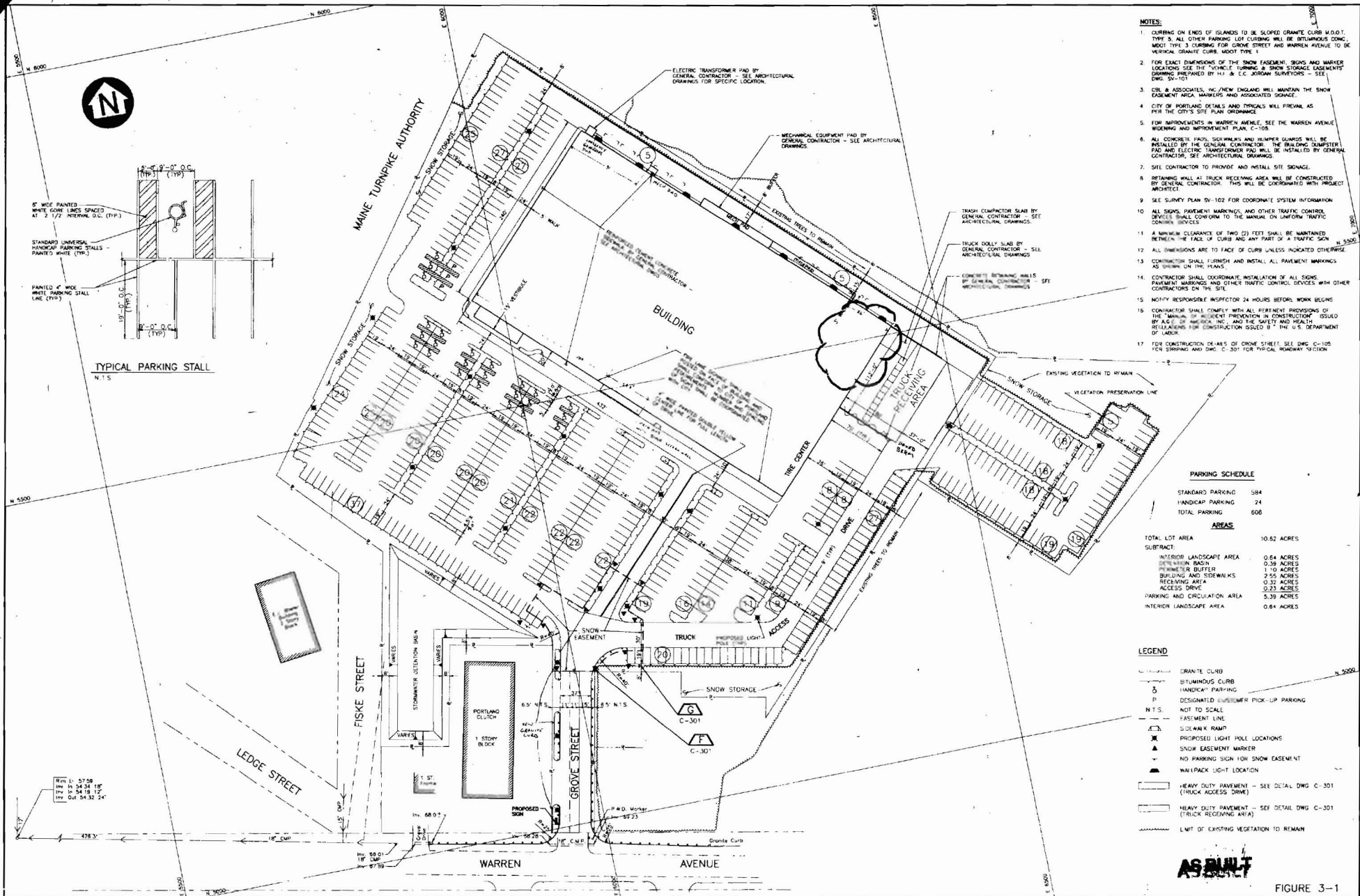

- NOTES:**
- CURBING ON ENDS OF ISLANDS TO BE SLOPED GRANITE CURB W.O.O.T. TYPE 5. ALL OTHER FARMING LED CURBING WILL BE BULBIOUS CONC. MOOT TYPE 3 CURBING FOR GROVE STREET AND WARREN AVENUE TO BE VERTICAL GRANITE CURB. MOOT TYPE 1
 - FOR EXACT DIMENSIONS OF THE SNOW EASEMENT, SIGNS AND MARKER LOCATIONS SEE THE "TYPICAL TURNING & SNOW STORAGE EASEMENTS" DRAWING PREPARED BY H.J. & E.C. JORDAN SURVEYORS - SEE DWG. SW-10
 - CBL & ASSOCIATES, INC./NEW ENGLAND WILL MAINTAIN THE SNOW EASEMENT AREA, MARKERS AND ASSOCIATED SIGNAGE.
 - CITY OF PORTLAND DETAILS AND PERMITS WILL PREVAIL AS PER THE CITY'S SITE PLAN ORDINANCE.
 - FOR IMPROVEMENTS IN WARREN AVENUE, SEE THE WARREN AVENUE WIDENING AND IMPROVEMENT PLAN, C-105.
 - ALL CONCRETE FLOORS, SIDEWALKS AND RAMPED DRIVEWAYS WILL BE INSTALLED BY THE GENERAL CONTRACTOR. THE BUILDING DRAINSTER PAD AND ELECTRICAL LAMP ROOMS WILL BE INSTALLED BY GENERAL CONTRACTOR. SEE ARCHITECTURAL DRAWINGS.
 - SITE CONTRACTOR TO PROVIDE AND INSTALL SITE SIGNAGE.
 - RETAINING WALL AT TRUCK RECEIVING AREA WILL BE CONSTRUCTED BY GENERAL CONTRACTOR. THIS WILL BE COORDINATED WITH PROJECT ARCHITECT.
 - SEE SURVEY PLAN SW-102 FOR COORDINATE SYSTEM INFORMATION.
 - ALL SIGNS, PAVEMENT MARKINGS, AND OTHER TRAFFIC CONTROL DEVICES SHALL CONFORM TO THE MANUAL ON UNIFORM TRAFFIC CONTROL DEVICES.
 - A MINIMUM CLEARANCE OF TWO (2) FEET SHALL BE MAINTAINED BETWEEN THE FACE OF CURB AND ANY PART OF A TRAFFIC SIGN.
 - ALL INTERSECTIONS ARE TO FACE OF CURB UNLESS INDICATED OTHERWISE.
 - CONTRACTOR SHALL FURNISH AND INSTALL ALL PAVEMENT MARKINGS AS SHOWN ON THE PLANS.
 - CONTRACTOR SHALL COORDINATE INSTALLATION OF ALL SIGNS, PAVEMENT MARKINGS AND OTHER TRAFFIC CONTROL DEVICES WITH OTHER CONTRACTORS ON THE SITE.
 - NOTIFY RESPONSIBLE INSPECTOR 24 HOURS BEFORE WORK BEGINS.
 - CONTRACTOR SHALL COMPLY WITH ALL PERTINENT PROVISIONS OF THE "MANUAL ON SIGN PRESENTATION IN CONSTRUCTION" ISSUED BY A.S.E. OF MASSACHUSETTS, INC. AND THE SAFETY AND HEALTH REGULATIONS FOR CONSTRUCTION ISSUED BY THE U.S. DEPARTMENT OF LABOR.
 - FOR CONSTRUCTION DETAILS OF GROVE STREET, SEE DWG. C-105 FOR STRIPPING AND DWG. C-301 FOR PHYSICAL ROADWAY SECTION.

PARKING SCHEDULE

STANDARD PARKING	584
HANDICAP PARKING	24
TOTAL PARKING	608

AREAS

TOTAL LOT AREA	10.82 ACRES
SUBTRACT:	
INTERIOR LANDSCAPE AREA	0.64 ACRES
DETENTION BASIN	0.36 ACRES
PURVIEWER BUFFER	1.10 ACRES
BUILDING AND SIDEWALKS	2.54 ACRES
RECEIVING AREA	0.33 ACRES
ACCESS DRIVE	0.23 ACRES
PARKING AND CIRCULATION AREA	5.39 ACRES
INTERIOR LANDSCAPE AREA	0.64 ACRES

- LEGEND**
- GRANITE CURB
 - BULBIOUS CURB
 - HANDICAP PARKING
 - P DESIGNATED BUS/EMERGENCY PICK-UP PARKING
 - N.T.S. NOT TO SCALE
 - FASMENT LINE
 - SIDEWALK RAMP
 - PROPOSED LIGHT POLE LOCATIONS
 - SNOW EASEMENT MARKER
 - NO PARKING SIGN FOR SNOW EASEMENT
 - WALKPARK LIGHT LOCATION
 - HEAVY DUTY PAVEMENT - SEE DETAIL DWG. C-301 (TRUCK ACCESS DRIVE)
 - HEAVY DUTY PAVEMENT - SEE DETAIL DWG. C-301 (TRUCK RECEIVING AREA)
 - LIMIT OF EXISTING VEGETATION TO REMAIN

AS BUILT FIGURE 3-1

REFERENCE DRAWINGS REV. DATE STATUS DESIGNED BY: [] CHECKED BY: [] DATE: []		AS BUILT 699 BOYLSTON STREET BOSTON, MASSACHUSETTS	C-E ENVIRONMENTAL, INC. 699 BOYLSTON STREET BOSTON, MASSACHUSETTS	DESIGN BY: [] 12/2/89 DRAWN BY: [] 2/2/90 CHECKED BY: [] 12/2/89 DATE: [] 12/2/89 PROJECT NO: [] SHEET NO: [] OF []	PROJECT NO: [] SHEET NO: [] OF [] DATE: []	BJ'S WHOLESALE CLUB PORTLAND, MAINE SITE PLAN 5967-501 SHEET 3 OF 13
--	--	---	---	---	--	--



About Climate Control

Products

News & Information

Literature

Access2Answers

Interlink Parts

Condensing Units

CS 1/2-5 HP Semi-Hermetic

Indoor/Outdoor

CH 1/2-5 HP

Hermetic

Indoor/Outdoor

CZ 2-6 HP Scroll

Indoor/Outdoor

CDT/CDN/CDS 3-22

HP Discus

Indoor/Outdoor

CDH 15-40 HP Discus

Outdoor

CDD 24-80 HP Dual

Compressor

Outdoor

HWN, ZWN 1/2-6 HP

Hermetic Remote

Water Cooled

ZWN 1/2-6 HP Scroll

Remote Water

Cooled

SWN 3/4-20 HP

Indoor Water

Cooled

SRN 3/4-20 HP

Remote Indoor

< Back to List

CS 1/2-5 HP Semi-Hermetic Indoor/Outdoor

The CS series of condensing units is ideal for convenience store, restaurant and other commercial applications. The units feature a semi-hermetic refrigeration compressor which is spring mounted with vibration eliminators. Also, these condensing units have an oversized aluminum fin/copper tube condenser that works in high ambients, encapsulated auto-reset high pressure controls to eliminate leaks, prepainted G90 galvanized steel cabinet for superior strength and corrosion protection, and suction and discharge service valves. PSC motors come standard to help you save energy. UL listed for the United States and Canada.

Climate Control 1/2-6 HP Indoor & Outdoor Air Cooled Condensing Units Bulletin, April 2008

CS* Indoor or Outdoor Installation, Semi-Hermetic Compressors (1/2 - 5 HP)

CS* Model No.	Compressor	Refrigerant	Section Temp.	BTU/H @ 95° Ambient	Connections (In.)		Minimum Circuit Ampacity				Dimensions (In.)			Approx. Net Wt. (Lbs.)
					Liquid LBS	Suction SCS	208V/1	208V/3	460V/3	230V/1	L	H	D	
CS*005H2	HAG-0050	Medium Temp HCFC-22	25°F	4,430	3/8	1/2	15	15	—	—	23 3/4	17 1/4	28 1/4	170
CS*008H2	KAR-0075			6,920	3/8	5/8	15	15	—	—	23 3/4	17 1/4	28 1/4	181
CS*008M2	KAR-0075			7,910	3/8	5/8	15	15	—	—	23 3/4	17 1/4	28 1/4	188
CS*010H2	KAR-0100	Medium & High Temp HCFC-22	25°F	9,260	3/8	5/8	15	15	—	—	23 3/4	17 1/4	28 1/4	191
CS*010M2	KAR-0100			10,680	3/8	5/8	15	15	—	—	23 3/4	17 1/4	28 1/4	191
CS*015H2	KAR-0150			12,230	3/8	7/8	15	15	—	—	23 3/4	17 1/4	28 1/4	220
CS*020H2	ERA-0200	High Temp HCFC-22	25°F	16,210	3/8	7/8	—	15	15	15	37 3/4	17 1/4	28 1/4	286
CS*020M2	KAK-0200			16,530	3/8	7/8	15	15	—	—	37 3/4	17 1/4	28 1/4	224
CS*020L2	ERC-021E			17,640	3/8	7/8	—	15	15	15	37 3/4	17 1/4	28 1/4	286
CS*024M2	ERF-031E	Medium Temp HCFC-22	25°F	24,720	1/2	7/8	—	15	15	21	37 3/4	19 3/4	28 1/4	318
CS*030M2	3RA-0310			28,900	1/2	7/8	—	20	15	23	42 1/2	29 3/4	30 1/4	377
CS*040M2	MRA-0400			38,960	1/2	1 1/8	—	28	15	—	42 1/2	29 3/4	30 1/4	431
CS*050H2	MRA-0500	Medium Temp HCFC-22	25°F	44,690	1/2	1 1/8	—	28	15	—	42 1/2	29 3/4	30 1/4	431
CS*050M2	MRA-0500			51,590	1/2	1 1/8	—	31	15	—	42 1/2	29 3/4	30 1/4	431
CS*005M6	HAI-005E			Low Temp HCFC-22	-10°F	5,210	3/8	1/2	15	15	—	—	23 3/4	17 1/4
CS*010M6	KAR-010E	9,750	3/8			5/8	15	15	—	—	23 3/4	17 1/4	28 1/4	190
CS*020M6	KAK-020E	16,240	3/8			7/8	15	15	—	—	37 3/4	17 1/4	28 1/4	224
CS*021M6	ERC-021E	Low Temp HCFC-22	-10°F	20,060	3/8	7/8	—	15	15	—	37 3/4	17 1/4	28 1/4	293
CS*030M6	ERF-031E			29,690	1/2	7/8	—	20	15	23	42 1/2	29 3/4	30 1/4	370
CS*040M6	MRA-040E			39,240	1/2	1 1/8	—	28	15	—	42 1/2	29 3/4	30 1/4	442
CS*005L2	KAR-0050	Low Temp HCFC-22	-10°F	3,860	3/8	1/2	15	15	—	—	23 3/4	17 1/4	28 1/4	181
CS*008L2	KAR-0075			4,540	3/8	5/8	15	15	—	—	23 3/4	17 1/4	28 1/4	189
CS*014L2	KAJ-0100			5,630	3/8	5/8	15	15	—	—	23 3/4	17 1/4	28 1/4	181
CS*020L2	EAD-0200	Low Temp HCFC-22	-10°F	9,590	3/8	7/8	—	15	15	15	37 3/4	17 1/4	28 1/4	281
CS*021L2	EAV-0210			11,010	3/8	7/8	—	15	15	15	37 3/4	17 1/4	28 1/4	286
CS*030L2	LAH-0310			15,630	1/2	7/8	—	15	15	20	37 3/4	19 3/4	28 1/4	345
CS*005L6	KAR-005E	Low Temp HCFC-404A	-10°F	2,580	3/8	1/2	15	15	—	—	23 3/4	17 1/4	28 1/4	186
CS*008L6	KAR-007E			4,320	3/8	5/8	15	15	—	—	23 3/4	17 1/4	28 1/4	185
CS*014L6	KAJ-010E			5,790	3/8	5/8	15	15	—	—	23 3/4	17 1/4	28 1/4	192
CS*015L6	KAL-015E	Low Temp HCFC-404A	-10°F	8,920	3/8	7/8	15	15	15	—	37 3/4	17 1/4	28 1/4	218
CS*020L6	EAD-020E			9,870	3/8	7/8	—	15	15	15	37 3/4	17 1/4	28 1/4	286
CS*021L6	EAV-021E			11,280	3/8	7/8	20	15	15	—	37 3/4	17 1/4	28 1/4	284
CS*027L6	SAB-031E	Low Temp HCFC-404A	-10°F	13,210	1/2	7/8	—	15	15	20	37 3/4	19 3/4	28 1/4	331
CS*030L6	LAH-032E			16,930	1/2	7/8	—	15	20	20	37 3/4	19 3/4	28 1/4	336
CS*030L6	LAC-032E			16,930	1/2	7/8	—	15	15	20	37 3/4	19 3/4	28 1/4	336
CS*040L6	MRA-040E	Low Temp HCFC-404A	-10°F	22,530	1/2	1 1/8	—	22	15	35	42 1/2	29 3/4	30 1/4	458
CS*040L6	MRA-042E			22,530	1/2	1 1/8	—	22	15	35	42 1/2	29 3/4	30 1/4	458

* Minimum Circuit Amps - Air Defrost Type Unit.
 * - T for outdoor, A for indoor, S for Section II.
 ^ MRA-040E compressor is single phase and uses HCFC-404A only.
 ^^ Uses HCFC-404A and S07 in three phase model.

DIMENSIONAL DATA

Diagram 1. Dimensions for all CW Series Units.

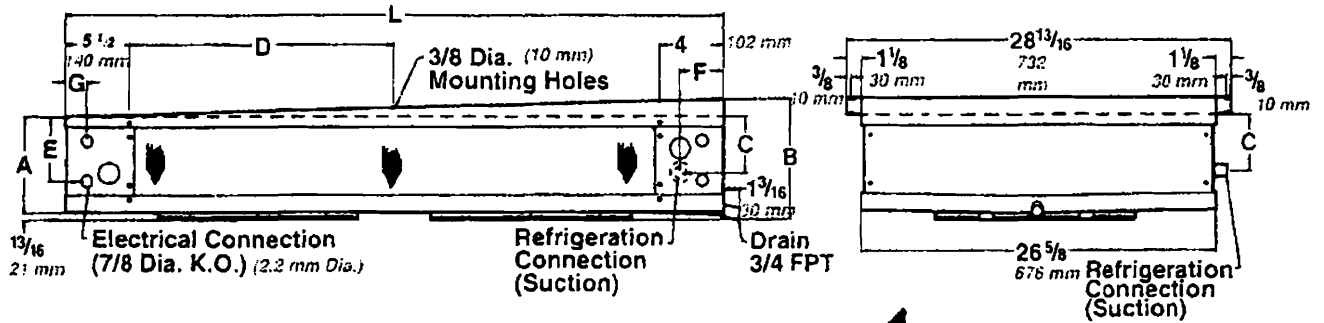

Table 1. Dimensional Data for all CW Series Units.

Model Numbers by Defrost Types			Dimensions (Inches/mm)								Connections (In.)	
Air	Electric	Hot Gas	A	B	C	D	E	F	G	L	Liquid OD	Suction OD
CWA 050	CWE 050	---	6 7/8	8 7/8	4 1/16	---	4 5/8	3 1/4	1 5/8	53 1/2	1/2	7/8
CWA 075	CWE 075	---	6 7/8 175	8 7/8 225	4 1/16 103	---	4 5/8 118	3 1/4 83	1 5/8 41	75 1/2 1918	1/2	7/8
CWA 100	CWE 100	CWG 100	9 3/8 238	11 3/8 288	6 9/16 167	---	7 1/8 181	3 1/4 83	1 5/8 41	75 1/2 1918	1/2	7/8
CWA 130	CWE 130	CWG 130	13 1/8 333	15 1/8 384	10 1/8 257	---	8 1/2 216	2 11/16 68	1 1/8 32	75 1/2 1918	1 1/8	1 1/8
CWA 155	CWE 155	CWG 155	13 1/8 333	15 1/8 384	10 1/8 257	---	8 1/2 216	2 11/16 68	1 1/8 32	75 1/2 1918	1 1/8	1 1/8
CWA 180	CWE 180	CWG 180	13 1/8 333	15 1/8 384	10 1/8 257	---	8 1/2 216	2 11/16 68	1 1/8 32	75 1/2 1918	1 1/8	1 1/8
CWA 210	CWE 210	CWG 210	13 1/8 333	15 1/8 384	10 1/8 257	44 1118	8 1/2 216	2 11/16 68	1 1/8 32	97 1/2 2477	1 1/8	1 1/8
CWA 270	CWE 270	CWG 270	13 1/8 333	15 1/8 384	10 1/8 257	44 1118	8 1/2 216	2 11/16 68	1 1/8 32	97 1/2 2477	1 3/8	1 3/8
CWA 340	CWE 340	CWG 340	13 1/8 333	15 1/8 384	10 1/8 257	55 1397	8 1/2 216	2 11/16 68	1 1/8 32	119 1/2 3035	1 3/8	1 3/8

Dimensional Drawings

OUTDOOR

INDOOR

LEFT VIEW

FRONT VIEW

FRONT VIEW

1/2, 3/4 and 1 HP

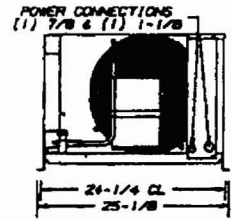
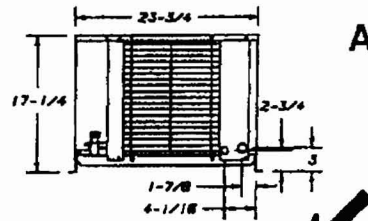
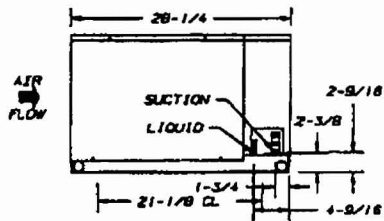

1-1/2 and 2 HP

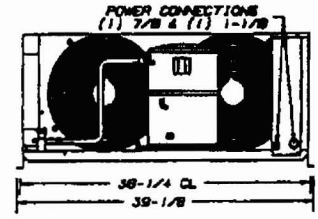
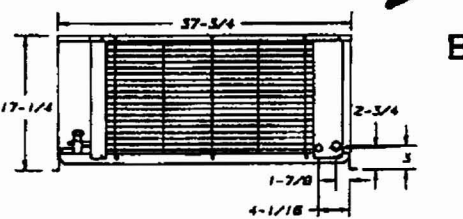
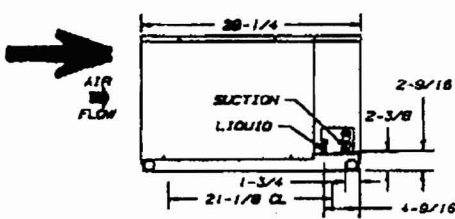

3 HP - ALTERNATE CABINET

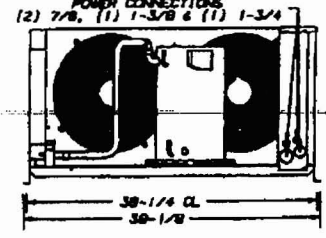
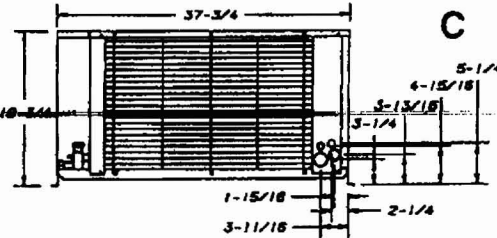
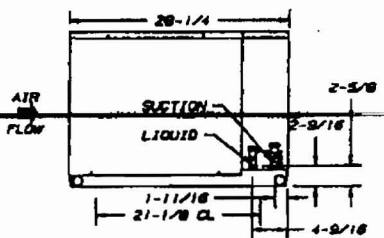

3, 4, 5 and 6 HP

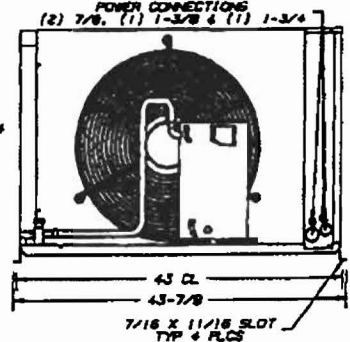
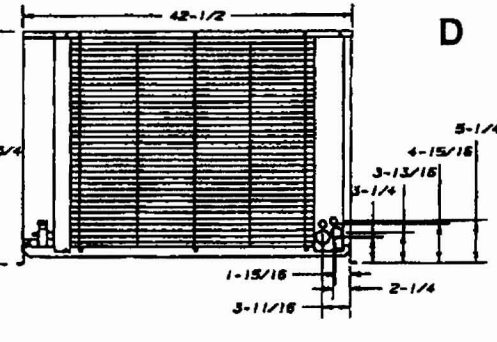
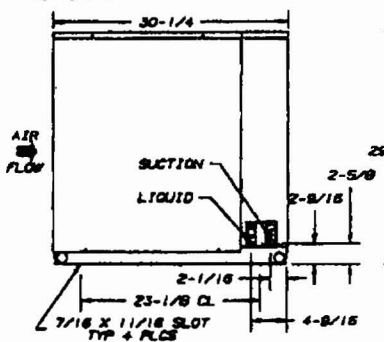

10' units
TYPE 3

Cooler top

3/8" Rod
From unit
to unit
Start
TYPE 6

Each unit weighs 100lbs

Cond
drain
to
Floor drain

Hanging Detail
N.T.S.

