

DOOR SCHEDULE ABBREVIATIONS

DOOR SCHEDULE

| NO. | TYPE | SIZE | THK | FIR | MAT. | GLASS | TYPE | MAT. | FRAMES | | THRESHOLD | | REMARKS |
|-----|------|---------------|--------|-----|------|-------|------|------|--------|------|-----------|--------|-------------------------------------|
| | | | | | | | | | HEAD | JAMB | MAT. | DETAIL | |
| 100 | | 3'-0" x 6'-0" | 1 1/4" | | MTL | | | | | | | | EXISTING DOOR |
| 101 | | 3'-0" x 6'-0" | 1 1/4" | | WOOD | | | | | | | | |
| 102 | | 3'-0" x 6'-0" | 1 1/4" | | WOOD | | | | | | | | |
| 103 | | 3'-0" x 6'-0" | 1 1/4" | | WOOD | | | | | | | | CLOSER RUBBER SLEEP ALUM. THRESHOLD |
| 104 | | 3'-0" x 6'-0" | 1 1/4" | | WOOD | | | | | | | | |
| 105 | | 3'-0" x 6'-0" | 1 1/4" | | WOOD | | | | | | | | |
| 106 | | 3'-0" x 6'-0" | 1 1/4" | | WOOD | | | | | | | | |
| 107 | | 3'-0" x 6'-0" | 1 1/4" | | WOOD | | | | | | | | |
| 108 | | 3'-0" x 6'-0" | 1 1/4" | | WOOD | | | | | | | | |
| 109 | | 3'-0" x 6'-0" | 1 1/4" | | WOOD | | | | | | | | |
| 110 | | 3'-0" x 6'-0" | 1 1/4" | | WOOD | | | | | | | | |
| 111 | | 3'-0" x 6'-0" | 1 1/4" | | WOOD | | | | | | | | |
| 112 | | 3'-0" x 6'-0" | 1 1/4" | | WOOD | | | | | | | | |
| 113 | | 3'-0" x 6'-0" | 1 1/4" | | WOOD | | | | | | | | |
| 114 | | 3'-0" x 6'-0" | 1 1/4" | | WOOD | | | | | | | | |
| 115 | | 3'-0" x 6'-0" | 1 1/4" | | WOOD | | | | | | | | |
| 116 | | 3'-0" x 6'-0" | 1 1/4" | | WOOD | | | | | | | | |
| 117 | | 3'-0" x 6'-0" | 1 1/4" | | WOOD | | | | | | | | |
| 118 | | 3'-0" x 6'-0" | 1 1/4" | | WOOD | | | | | | | | |
| 119 | | 3'-0" x 6'-0" | 1 1/4" | | WOOD | | | | | | | | |
| 120 | | 3'-0" x 6'-0" | 1 1/4" | | WOOD | | | | | | | | |

NOTE: DOORS LOCATED IN THE STORE PARTITION WALL (BETWEEN OFFICE AND SHOP) AS INDICATED IN THE DOOR SCHEDULE SHALL BE DESIGNED TO RESIST THE PASSAGE OF SMOKE & SHALL COMPLY W/ NFPA 88.
ALL HARDWARE SHALL BE LEVER HANDLE COMPLYING W/ ADA 101.

WINDOW SCHEDULE

| NO. | TYPE | MANUFACTURER | CATALOG NO. | DETAILS | REMARKS |
|-----|--------|--------------|-------------|-----------------|-----------------|
| A | GLIDER | | | HEAD JAMBS SILL | EXISTING WINDOW |
| B | FIXED | | | | SEE WINDOW TYPE |

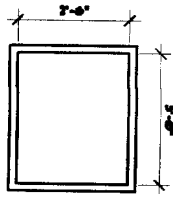

INTERIOR FIBER GLASS WINDOW

WALL TYPES

SCALE: 1/4" = 1'-0"

1 METAL STUD WALL (NON-RATED) STORE PARTITION
01 LAYER 1/2" STRIP PANEL EACH SIDE
2" METAL STUD WALL WITH ROLL INSULATION
2" INSULATION
2" METAL STUD WALL ABOVE 10'-0" AFF.

2 EXISTING METAL STUD WALL (IF RATED)

3 EXISTING CHILL WALL

4 METAL STUD WALL (NON-RATED)

5 EXISTING 3 BAY PIER WALL (NON-RATED)

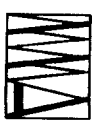
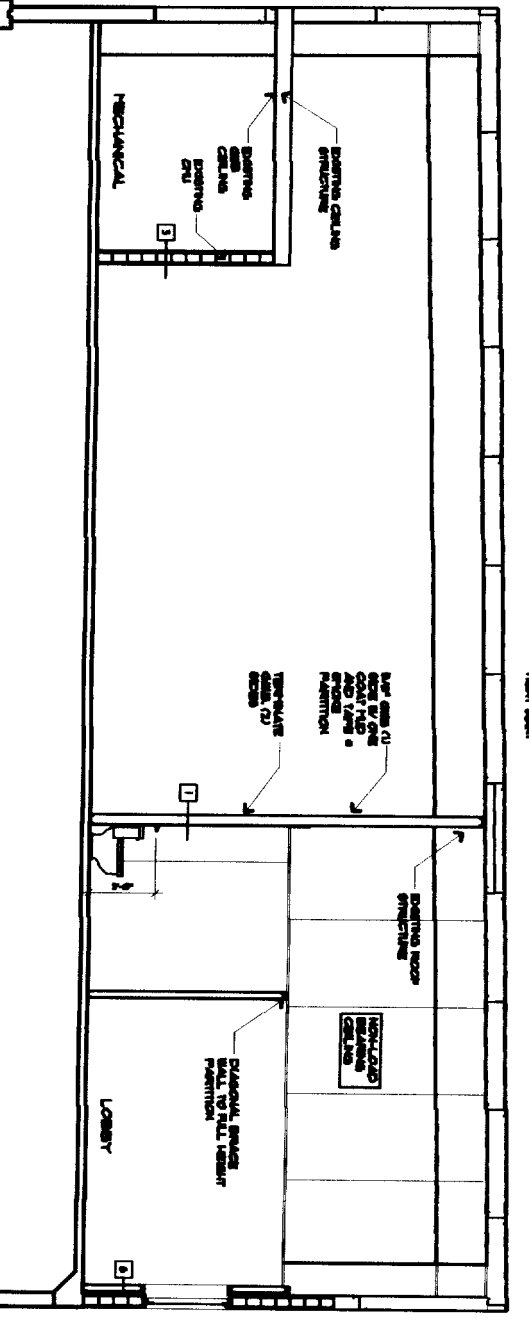
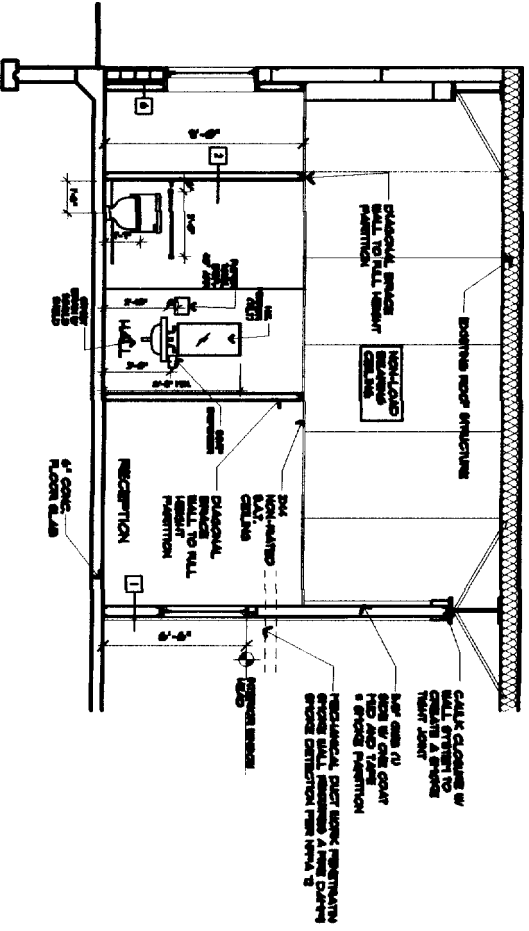

M A R K MUELLER ARCHITECTS
A.I.A.

100 Commercial Street
Suite 405
Portland, Maine 04101
Phone / Fax: 603.774.9307
Email: MARK@markm.com

DATE: 01/11/2011

JAMES SPINELLI
AAMCO TRANSMISSIONS
429 WARREN AVE. UNIT 12
PORTLAND, MAINE

SCHEDULE & SECTIONS

| NO. | REVISION |
|-----|------------------|
| 1 | ISSUE FOR PERMIT |

