

DISPLAY THIS CARD ON PRINCIPAL FRONTAGE OF WORK

CITY OF PORTLAND

BUILDING DEPARTMENT

PERMIT

PERMIT ISSUED

Permit Number: 050733 5 2005
JUL 5 2005

CITY OF PORTLAND

Please Read Application And Notes, If Any, Attached

This is to certify that Girard Arthur/William Gilbert
has permission to install: 1) 40sf wall sign, 2 top banner and 1 vertical insert for freestanding sign.
AT 380 Warren Ave 303 E001001

provided that the person or persons, firm or corporation accepting this permit shall comply with all of the provisions of the Statutes of Maine and of the ordinances of the City of Portland regulating the construction, maintenance and use of buildings and structures, and of the application on file in this department.

Apply to Public Works for street line and grade if nature of work requires such information.

Notification of inspection must be given and written permission procured before this building or part thereof is altered or closed-in.
24 HOUR NOTICE IS REQUIRED.

A certificate of occupancy must be procured by owner before this building or part thereof is occupied.

OTHER REQUIRED APPROVALS

Fire Dept. _____
Health Dept. _____
Appeal Board _____
Other _____
Department Name

Jeannie Bouke 6/30/05
Director - Building & Inspection Services

PENALTY FOR REMOVING THIS CARD

City of Portland, Maine - Building or Use Permit Application

389 Congress Street, 04101 Tel: (207) 874-8703, Fax: (207) 874-8716

Permit No: 05-0733	Result: PERMIT ISSUED	BL: 303 E001001
-----------------------	---------------------------------	--------------------

Location of Construction: 380 Warren Ave	Owner Name: Girard Arthur	Owner Address: 120 Exchange St #106	Phone:
Business Name:	Contractor Name: William Gilbert	Contractor Address: 22 Black Point Rd Scarborough	Phone: 8850548
Lessee/Buyer's Name	Phone:	Permit Type: Signs - Permanent	Zone: B4

Past Use: Commercial	Proposed Use: Commercial install: 1) 40sf wall sign, 2 temp banners and 1 vinyl insert for freestanding sign.	Permit Fee: \$158.00	Cost of Work: \$158.00	CEO District: 5
Proposed Project Description: install: 1) 40sf wall sign, 2 temp banners and 1 vinyl insert for freestanding sign.		FIRE DEPT: <input type="checkbox"/> Approved <input type="checkbox"/> Denied	INSPECTION: Use Group: B Type: Signs	

Signature: _____
Signature: *JMB 6/30/05*

PEDESTRIAN ACTIVITIES DISTRICT (P.A.D.)

Action: Approved Approved w/Conditions Denied

Signature: _____ Date: _____

Permit Taken By: dmartin	Date Applied For: 06/07/2005	Zoning Approval	
------------------------------------	--	------------------------	--

<ol style="list-style-type: none"> This permit application does not preclude the Applicant(s) from meeting applicable State and Federal Rules. Building permits do not include plumbing, septic or electrical work. Building permits are void if work is not started within six (6) months of the date of issuance. False information may invalidate a building permit and stop all work.. 	Special Zone or Reviews <input type="checkbox"/> Shoreland <input type="checkbox"/> Wetland <input type="checkbox"/> Flood Zone <input type="checkbox"/> Subdivision <input type="checkbox"/> Site Plan Maj <input type="checkbox"/> Minor <input type="checkbox"/> MM <input type="checkbox"/> Date: <i>6/30/05</i>	Zoning Appeal <input type="checkbox"/> Variance <input type="checkbox"/> Miscellaneous <input type="checkbox"/> Conditional Use <input type="checkbox"/> Interpretation <input type="checkbox"/> Approved <input type="checkbox"/> Denied Date: _____	Historic Preservation <input checked="" type="checkbox"/> Not in District or Landmark <input type="checkbox"/> Does Not Require Review <input type="checkbox"/> Requires Review <input type="checkbox"/> Approved <input type="checkbox"/> Approved w/Conditions <input type="checkbox"/> Denied Date: _____
---	--	---	--

CERTIFICATION

I hereby certify that I am the owner of record of the named property, or that the proposed work is authorized by the owner of record and that I have been authorized by the owner to make this application as his authorized agent and I agree to conform to all applicable laws of this jurisdiction. In addition, if a permit for work described in the application is issued, I certify that the code official's authorized representative shall have the authority to enter all areas covered by such permit at any reasonable hour to enforce the provision of the code(s) applicable to such permit.

SIGNATURE OF APPLICANT	ADDRESS	DATE	PHONE
RESPONSIBLE PERSON IN CHARGE OF WORK, TITLE		DATE	PHONE

City of Portland, Maine - Building or Use Permit

389 Congress Street, 04101 Tel: (207) 874-8703, Fax: (207) 874-8716

Permit No: 05-0733	Date Applied For: 0610712005	CBL: 303 E001001
------------------------------	--	----------------------------

Location of Construction: 380 Warren Ave	Owner Name: Girard Arthur	Owner Address: 120 Exchange St #106	Phone:
Business Name:	Contractor Name: William Gilbert	Contractor Address: 22 Black Point Rd Scarborough	Phone (207) 885-0548
Lessee/Buyer's Name	Phone:	Permit Type: Signs - Permanent	

Proposed Use: Commercial install: 1) 40sf wall sign, 1 temp banner 2'x3' and 1 vinyl insert for freestanding sign.	Proposed Project Description: install: 1) 40sf wall sign, 1 temp banner 2'x3' and 1 vinyl insert for freestanding sign.
--	---

Dept: Zoning **Status:** Approved with Conditions **Reviewer:** Marge Schmuckal **Approval Date:** 06/30/2005**Note:** 6/29/05 talked to Barbara Dalquist - needs more info on the length of tenant space and where the banner is going -
6130105 Barbara dropped off more info **Ok to Issue:**

- 1) It is understood that there will only be one temporary sign 2'x3', set five (5) feet from the front property line. This permit only approves this temporary sign for thirty (30) days from the date of permit issuance, after which time the temporary sign shall be removed. Please note that no more than two (2) portable or temporary sign permits shall be issued to each business on the same lot in any calendar year. In no event shall any lot have a portable or temporary sign for more than sixty (60) days in one calendar year.

Dept: Building **Status:** Approved **Reviewer:** Jeanine Bourke **Approval Date:** 06/30/2005**Note:** **Ok to Issue:**

- 1) Signage Installation to comply with Chapter 31 of the IBC 2003 building code.

Signage/Awning Permit Application

If you or the property owner owes real estate or personal property taxes or user charges on any property within the City, payment arrangements must be made before permits of any kind are accepted.

Location/Address of Construction: <u>380 WARREN AVE, Portland, ME 04103</u>		
Total Square Footage of Proposed Structure	Square Footage of Lot	
Tax Assessor's Chart, Block & Lot Chart# <u>303</u> Block# <u>E</u> Lot# <u>001</u>	Owner: <u>Art Girard</u>	Telephone: <u>Bus. 828-4650</u>
DEPT. OF BUILDING INSPECTION CITY OF PORTLAND, ME JUN 7 2005 RECEIVED	Applicant name, address & telephone: <u>27 BLACK POINT RD SCARBOROUGH</u>	Total s.f. of signage x \$2.00 per s.f. plus \$30.00/\$65.00 for H.D. signage = Total Fee: \$ <u>405⁰⁰</u> Awning Fee = Cost Of <u>17</u> SF Work: \$ <u>158⁰⁰</u> Total Fee: \$ <u>563⁰⁰</u>
	Lessee/Buyer's Name (If Applicable)	

Current use: Vacant Commercial

If the location is currently vacant, what was prior use: Assembly / Garage Doors

Approximately how long has it been vacant: 5/31/05

Proposed use: Puncture proof tires & safety engineered auto accessories.

Project description: Retail & installation

Contractor's name, address & telephone:

Whom should we contact when the permit is ready: Barbara Dahlquist / William Gilbert

Mailing address: 27 Black Point Rd 1E
Scarborough, ME 04074

We will contact you by phone when the permit is ready. You must come in and pick up the permit and review the requirements before starting any work, with a Plan Reviewer. A STOP WORK ORDER will be issued and a \$100.00 fee if any work starts before the permit is picked up. PHONE: 207-885-0248

IF THE REQUIRED INFORMATION IS NOT INCLUDED IN THE SUBMISSIONS THE PERMIT WILL BE AUTOMATICALLY DENIED AT THE DISCRETION OF THE BUILDING/PLANNING DEPARTMENT. WE MAY REQUIRE ADDITIONAL INFORMATION IN ORDER TO APPROVE THIS PERMIT.

I hereby certify that I am the Owner of record of the named property, or that the owner of record authorizes the proposed work and that I have been authorized by the owner to make this application as his/her authorized agent. I agree to conform to all applicable laws of this jurisdiction. In addition, if a permit for work described in this application is issued, I certify that the Code Official's authorized representative shall have the authority to enter all areas covered by this permit at any reasonable hour to enforce the provisions of the codes applicable to this permit.

Signature of applicant: Barbara Dahlquist | Date: 6/8/05

This is NOT a permit, you may not commence ANY work until the permit is issued.

SIGNAGE/AWNING PRE-APPLICATION QUESTIONNAIRE

PLEASE COMPLETE ALL INFORMATION

ADDRESS: 380 Warren Ave. Portland, Me 04103 ZONE: 34

CBL: _____

SINGLE TENANT LOT? YES _____ NO MULTITENANT LOT? YES NO _____

MORE THAN ONE SIGN TOTAL WITH PROPOSED SIGN? YES NO _____

TENANT/ALLOCATED BUILDING SPACE FRONTAGE (FEET):

Length: ~~787 sq ft~~ 42' x 11.5' = 639' Height: 19'

INFORMATION ON PROPOSED SIGN(S):

FREESTANDING (e.g., pole) SIGN? YES NO _____ DIMENSIONS PROPOSED: 12 sq ft (2) 2' x 3' Benjamins

BLDG. WALL SIGN? (attached to bldg) YES NO _____ DIMENSIONS PROPOSED: 40 sq ft

INFORMATION ON ALREADY EXISTING AND PERMITTED SIGN(S):

FREESTANDING (e.g., pole) SIGN? YES _____ NO _____ DIMENSIONS: _____

BLDG. WALL SIGN(attached to bldg)? YES _____ NO _____ DIMENSIONS: _____

AWNING? YES _____ NO _____ DIMENSIONS: _____

LOT FRONTAGE (FEET): _____

AWNING YES _____ NO IS AWNING BACKLIT? YES _____ NO _____

HEIGHT OF AWNING: _____ LENGTH OF AWNING: _____ DEPTH: _____

IS THERE ANY COMMUNICATION, MESSAGE, TRADEMARK OR SYMBOL ON IT? YES _____ NO _____

IF YES, TOTAL S.F. OF PANELS WITH COMMUNICATIONS/MESSAGE/TRADEMARK/SYMBOL? _____ s.f.

A SITE SKETCH AND BUILDING SKETCH SHOWING EXACTLY WHERE EXISTING AND NEW SIGNAGE IS LOCATED MUST BE PROVIDED. SKETCHES AND/OR PICTURES OF PROPOSED SIGNAGE ARE ALSO REQUIRED.

SIGNATURE OF APPLICANT: _____ DATE: _____

***** FOR OFFICE USE ONLY *****

42 feet Frontage

380 Warren Ave.
Portland, Me 04103

885-0548
OR
730-1399

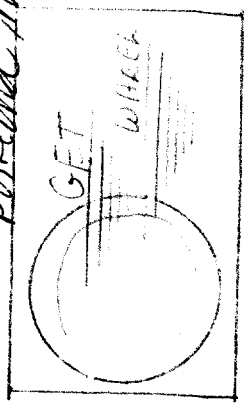
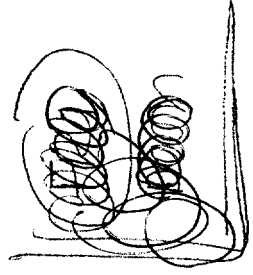

Ron Bldg
40#

SAFETY ENGINEERED AUTO ACCESSORIES

DON'T LET YOUR TIRES SHIP

Steer you in the wrong direction...

TRUCKS - SUVs - EXOTIC & HUNTERY CHS

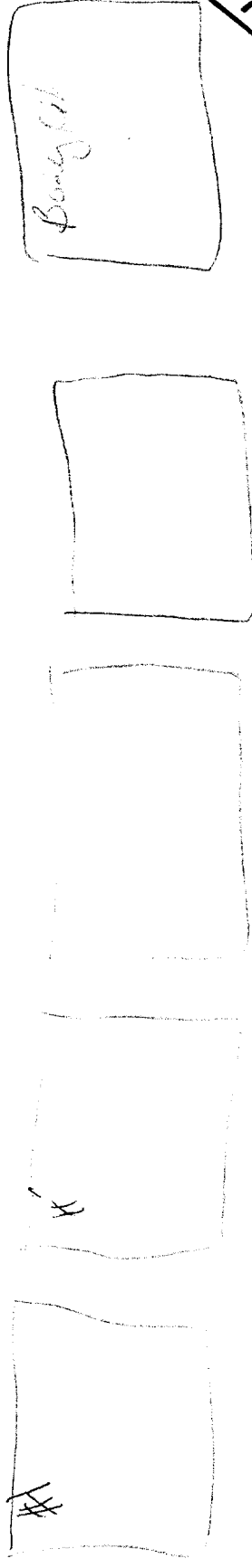

Custom made for Formula One - NASCAR - Auto Enthusiasts and you.

COME KNOW WHAT DRIVES YOU

temporary banner says: 2'x3'

"Get Wheel 4 wheels - 4 tires \$27.95 installed"

only one temp sign for 30 days on the bottom

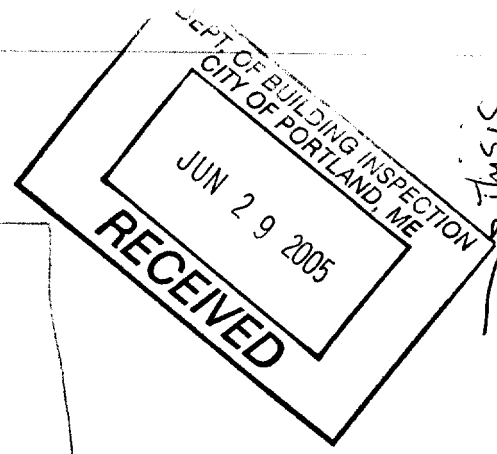

This is



COLDPLAY
TWISTED LOGIC TOUR

X&Y
In Stores June 7

VIEW FULL TOUR SCHEDULE
+ BUY TICKETS
[CLICK HERE](#)

Mail | Addresses | Calendar | Notepad | [What's New](#) - [Mail Upgrades](#) - [Mail Options](#)

Check Mail | Compose | Search Mail | Search the Web

for bad credit

[Add - Edit]

- Inbox (19)
- Draft
- Sent
- Bulk (212) [Empty]
- Trash [Empty]

What's your Credit Score? See it FREE!

Refinance Now
Bad Credit OK

\$ \$160,000 Loan
only \$617/mo.

Wow! Mortgage
Rates under 4%



File name:
GE
type: application/msword

Delta Realty
120 Exchange Street
Portland, ME 04101
207-828-4650

Handwritten note:
303 E 001
↓
min for 303A
paid.

June 6, 2005

To: Code Enforcement
Signage Division
City of Portland

From: Art Girard
Delta Realty

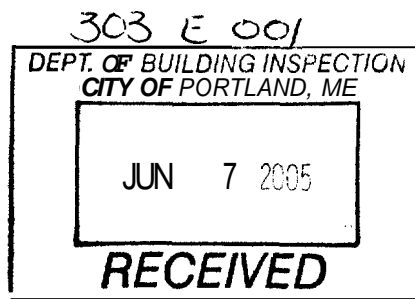

This is to inform you that Delta Realty is giving permission to GET WHEEL, one of Delta's tenants located at 380 Warren Avenue, Portland, ME to erect signage on Delta's building, as per allowed by code.

Art Girard
President

Check Mail

Compose

Search Mail

Search the Web

Copyright© 1994-2005 Yahoo! Inc. All rights reserved. Terms of Service - Copyright/IP Policy - Guidelines - Ad Feedback
NOTICE: We collect personal information on this site.
To learn more about how we use your information, see our Privacy Policy

303 E 001
DEPT. OF BUILDING INSPECTION
CITY OF PORTLAND, ME
JUN 7 2005
RECEIVED

ACORD™ CERTIFICATE OF LIABILITY INSURANCE

DATE(MM/DD/YYYY)

6/7/2005

PRODUCER

O'Hearn Insurance Agency
1087 Forest Ave
Portland, Me. 04103
207-797-9400

THIS CERTIFICATE IS ISSUED AS A MATTER OF INFORMATION ONLY AND CONFERS NO RIGHTS UPON THE CERTIFICATE HOLDER. THIS CERTIFICATE DOES NOT AMEND, EXTEND OR ALTER THE COVERAGE AFFORDED BY THE POLICIES BELOW.

INSURERS AFFORDING COVERAGE

NAIC#

INSURED

Get Wheel LLC

380 Warren Avenue
Portland, ME 04103

INSURER A: **Nationwide Insurance**

INSURER B:

INSURER C:

INSURER D:

INSURER E:

COVERAGES

THE POLICIES OF INSURANCE LISTED BELOW HAVE BEEN ISSUED TO THE INSURED NAMED ABOVE FOR THE POLICY PERIOD INDICATED. NOTWITHSTANDING ANY REQUIREMENT, TERM OR CONDITION OF ANY CONTRACT OR OTHER DOCUMENT WITH RESPECT TO WHICH THIS CERTIFICATE MAY BE ISSUED OR MAY PERTAIN, THE INSURANCE AFFORDED BY THE POLICIES DESCRIBED HEREIN IS SUBJECT TO ALL THE TERMS, EXCLUSIONS AND CONDITIONS OF SUCH POLICIES. AGGREGATE LIMITS SHOWN MAY HAVE BEEN REDUCED BY PAID CLAIMS.

VSR TR	ADD'L INSRD	TYPE OF INSURANCE	POLICY NUMBER	POLICY EFFECTIVE DATE(MM/DD/YY)	POLICY EXPIRATION DATE(MM/DD/YY)	LIMITS
		GENERAL LIABILITY <input type="checkbox"/> COMMERCIAL GENERAL LIABILITY <input type="checkbox"/> CLAIMS MADE <input type="checkbox"/> OCCUR GENL AGGREGATE LIMIT APPLIES PER: <input type="checkbox"/> PRO-JECT <input type="checkbox"/> LOC				EACH OCCURRENCE \$ DAMAGE TO RENTED PREMISES (Ea occurrence) \$ MED EXP (Any one person) \$ PERSONAL & ADV INJURY \$ GENERAL AGGREGATE \$ PRODUCTS - COMP/OP AGG \$
		AUTOMOBILE LIABILITY <input type="checkbox"/> ANY AUTO <input type="checkbox"/> ALL OWNED AUTOS <input type="checkbox"/> SCHEDULED AUTOS <input type="checkbox"/> HIRED AUTOS <input type="checkbox"/> NON-OWNED AUTOS				COMBINED SINGLE LIMIT (Ea accident) \$ BODILY INJURY (Per person) \$ BODILY INJURY (Per accident) \$ PROPERTY DAMAGE (Per accident) \$
A		GARAGE LIABILITY <input checked="" type="checkbox"/> ANY AUTO	TBD	06/07/05	06/07/06	AUTO ONLY - EA ACCIDENT \$ 15,000 OTHER THAN EA ACC \$ 500,000 AUTO ONLY: AGG \$ 1,500,000
		EXCESS/UMBRELLA LIABILITY <input type="checkbox"/> OCCUR <input type="checkbox"/> CLAIMS MADE DEDUCTIBLE RETENTION \$				EACH OCCURRENCE \$ AGGREGATE \$ \$ \$ \$
		WORKERS COMPENSATION AND EMPLOYERS' LIABILITY ANY PROPRIETOR/PARTNER/EXECUTIVE OFFICER/MEMBER EXCLUDED? If yes, describe under SPECIAL PROVISIONS below				WC STATUTORY LIMITS: OTH-ER: E.L. EACH ACCIDENT \$ E.L. DISEASE - EA EMPLOYEE \$ E.L. DISEASE - POLICY LIMIT \$
		OTHER				

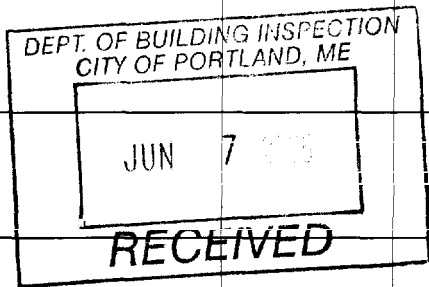

YES !PTION OF OPERATIONS/ LOCATIONS/ VEHICLES / EXCLUSIONS ADDED BY ENDORSEMENT / SPECIAL PROVISIONS

CERTIFICATE HOLDER

City Of Portland
Congress St
Portland, ME 04103

CANCELLATION

SHOULD ANY OF THE ABOVE DESCRIBED POLICIES BE CANCELLED BEFORE THE EXPIRATION DATE THEREOF, THE ISSUING INSURER WILL ENDEAVOR TO MAIL **30** DAYS WRITTEN NOTICE TO THE CERTIFICATE HOLDER NAMED TO THE LEFT, BUT FAILURE TO DO SO SHALL IMPOSE NO OBLIGATION OR LIABILITY OF ANY KIND UPON THE INSURER, ITS AGENTS OR REPRESENTATIVES.

AUTHORIZED REPRESENTATIVE

[Signature]

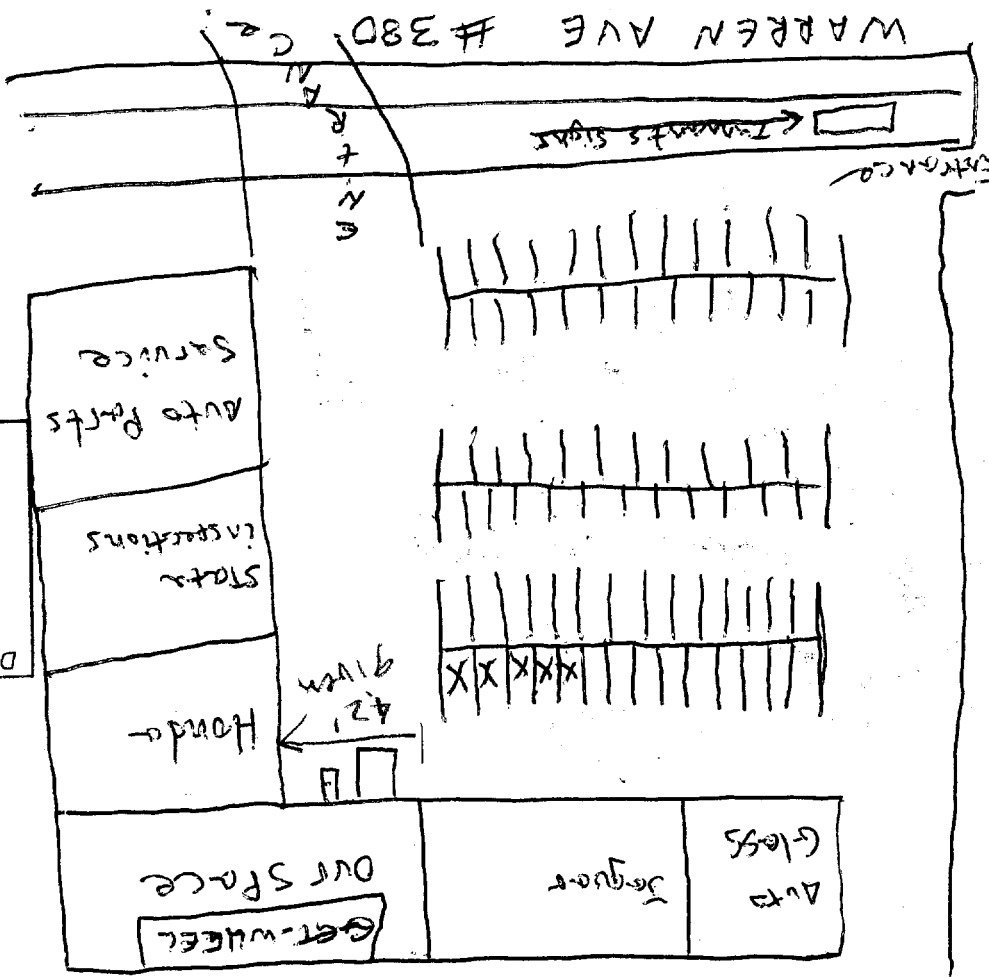

Wall sign
 Attached w/ 1/4"
 lag bolt. (6 bolts)

RECEIVED
 JUN 7 2005
 DEPT. OF BUILDING INSPECTION
 CITY OF PORTLAND, ME
 303 E 001

(800) 340-6025 • www.womentowomen.com/personal

