





PRE-DEVELOPMENT SUMMARY			
SUBCATCHMENT ID	AREA (ACRES)	TC (MIN)	RCN
1	2.47	50.80	79
2	.40	6	81
3A	0.500	6	93
3B	.10	6	98
3C	0.37	6	98
4	.79	6	87

NOTE
ONLY AREA IMPACTS POI 1 & POI 2 WERE
USED FOR WATERSHED ANALYSIS.

WATERSHED LEGEND

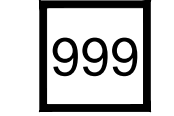
-  WATERSHED BOUNDARY
-  WATERSHED FLOW PATH
-  SUBCATCHMENT
-  REACH
- SF SHEET FLOW
- SCF SHALLOW CONCENTRATED FLOW
- CF CHANNEL FLOW
- CC CIRCULAR CHANNEL
- POI POINT OF INTEREST
-  POND

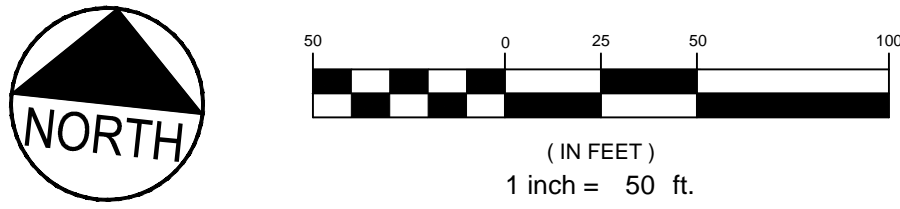
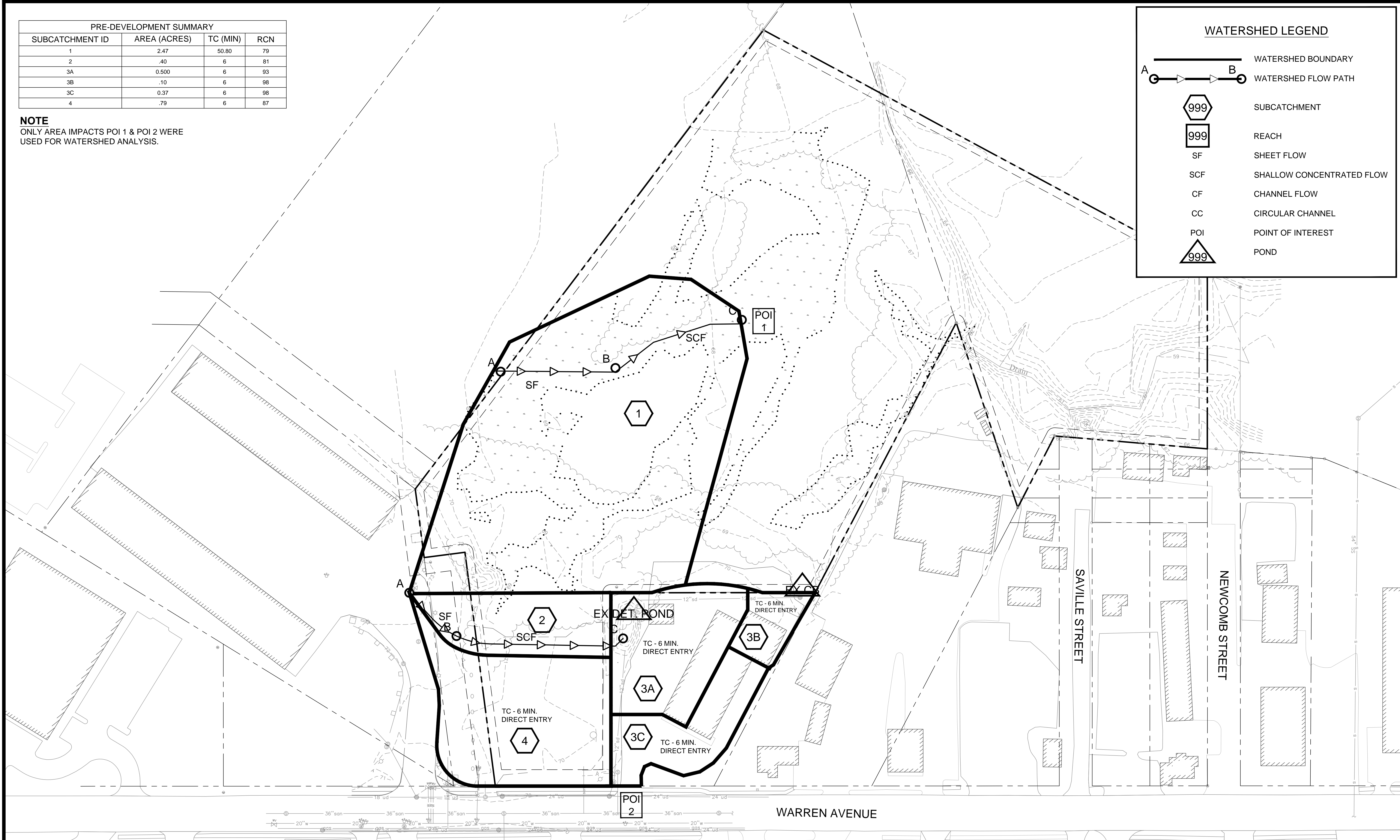

PRELIMINARY - NOT FOR CONSTRUCTION

REV	DATE	DESCRIPTION
2	04.17.14	FINAL PLAN SUBMISSION TO CITY
1	02.10.14	SUBMITTED TO CITY OF PORTLAND

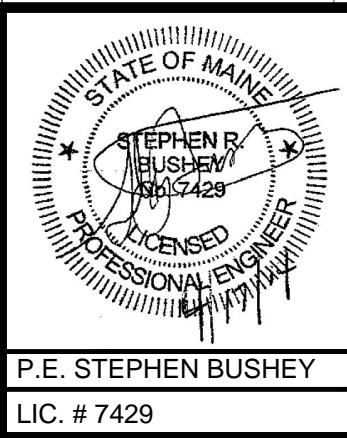

PROJECT PH WARREN AVENUE, LLC
COMMERCIAL SITE
421 WARREN AVENUE

SHEET TITLE
**PREDEVELOPMENT
WATERSHED MAP**

CLIENT PH WARREN AVENUE, LLC
C/O PETER HOLMES
12 WILDWOOD LANE
SCARBOROUGH, ME 04074

FST **FAY, SPOFFORD & THORNDIKE, INC.**
ENGINEERS - PLANNERS - SCIENTISTS
778 MAIN ST., SUITE 8, SOUTH PORTLAND, ME 04106

DRAWN: CMW DATE: NOVEMBER 2013
DESIGNED: SRB SCALE: 1" = 50'
CHECKED: SRB JOB NO. SP-M104
FILE NAME: SP-M104-WSHD
SHEET **C-7.0**