

POST-DEVELOPMENT SUMMARY				
SUBCATCHMENT ID	AREA (ACRES)	TC (MIN)	RCN	TREATMENT APPROACH
1	1.51	50.8	81	NONE
2	0.48	6	89	GRAVEL WETLAND 1
3	0.66	6	97	DRIP STRIP
4	1.00	6	90	GRAVEL WETLAND 2
3A	.50	6	98	NONE
3B	.10	6	92	NONE
3C	.37	6	98	NONE

NOTE
ONLY AREA IMPACTS POI 1 & POI 2 WERE USED FOR WATERSHED ANALYSIS.

WATERSHED LEGEND

- WATERSHED BOUNDARY
- WATERSHED FLOW PATH
- SUBCATCHMENT
- REACH
- SF SHEET FLOW
- SCF SHALLOW CONCENTRATED FLOW
- CF CHANNEL FLOW
- CC CIRCULAR CHANNEL
- POI POINT OF INTEREST
- POND

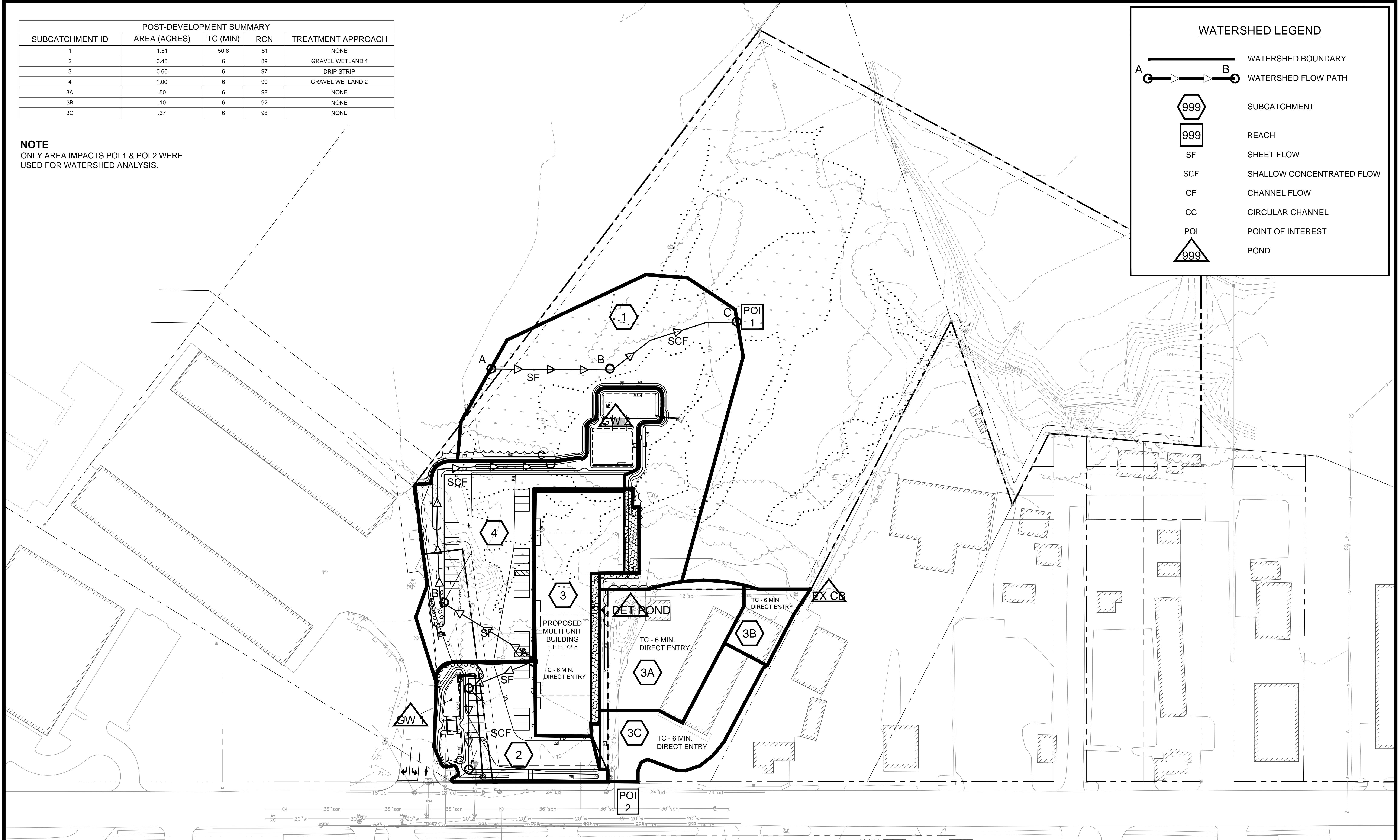

NORTH

(IN FEET)
1 inch = 50 ft.

REV	DATE	DESCRIPTION
4	08.11.14	RELEASED TO CITY - FINAL PLANS
3	07.03.14	FINAL PLAN SUBMISSION TO CITY PER CONDITIONS OF APPROVAL
2	04.17.14	FINAL PLAN SUBMISSION TO CITY
1	02.10.14	SUBMITTED TO CITY OF PORTLAND

STEPHEN R. BUSHEY
LICENSED PROFESSIONAL ENGINEER
LIC. # 7429

PROJECT PH WARREN AVENUE, LLC
COMMERCIAL SITE
421 WARREN AVENUE

SHEET TITLE
POST-DEVELOPMENT WATERSHED MAP

CLIENT PH WARREN AVENUE, LLC
C/O PETER HOLMES
12 WILDWOOD LANE
SCARBOROUGH, ME 04074

FAY, SPOFFORD & THORNDIKE, INC.
ENGINEERS - PLANNERS - SCIENTISTS
778 MAIN ST., SUITE 8, SOUTH PORTLAND, ME 04106

DRAWN: CMW	DATE: NOVEMBER 2013
DESIGNED: SRB	SCALE: 1" = 50'
CHECKED: SRB	JOB NO. SP-M104
FILE NAME: SP-M104-WSHD	
SHEET	C-7.1