

Belfort Street

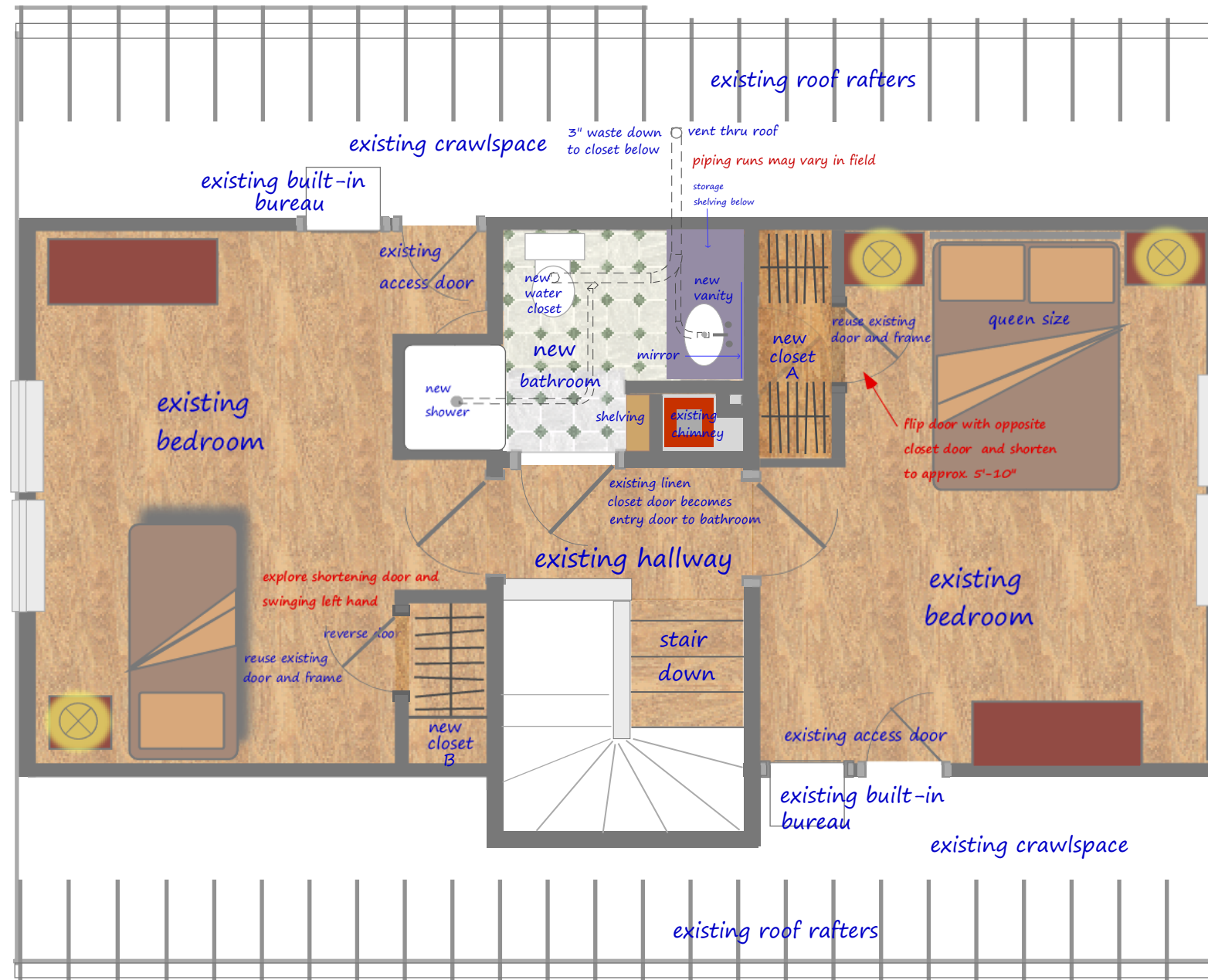

important notes:

- 1) new bathroom size is approximately 41 GSF
limitations of existing space requires
new bathroom size to be smaller than minimum MUBEC minimum requirements for habitable rooms (70 SF with minimum dimension of 7')
- 2) A minimum of 7'-0" is obtained in front of all fixtures as required by MUBEC
- 3) closet doors will be shortened to approx. 5'-10" in height to clear sloped ceiling
- 4) new moisture resistant GWB shall be applied to all walls of bathroom
- 5) bathroom shall have a ceiling fan exhausted to the exterior

second floor plan

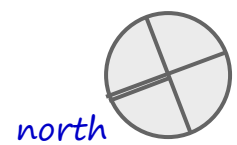

scale: 1/4"=1'-0"
when printed on 11"x17" paper