

DISPLAY THIS CARD ON PRINCIPAL FRONTAGE OF WORK CITY OF PORTLAND

DEPT. BUILDING INSPECTION
CITY OF PORTLAND, ME

APR 14 2006

Permit Number: 060389

RECEIVED

Please Read
Application And
Notes, If Any,
Attached

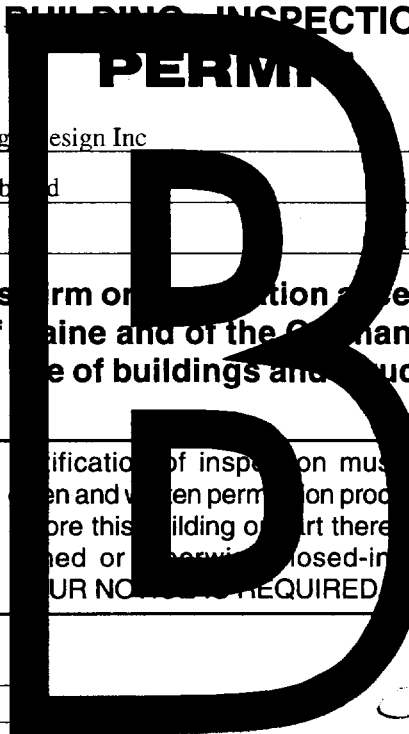

This is to certify that CITY OF PORTLAND / Sign Design Inc
 has permission to install a community reader board
 AT 1592 FOREST AVE L 299 D046001

provided that the person or persons who accept this permit shall comply with all of the provisions of the Statutes of Maine and of the Ordinances of the City of Portland regulating the construction, maintenance and use of buildings and structures, and of the application on file in this department.

Apply to Public Works for street line and grade if nature of work requires such information.

Notification of inspection must be given and when permission is procured before this building or part thereof is used or service is closed-in. 4
 YOUR NOTICE REQUIRED

A certificate of occupancy must be procured by owner before this building or part thereof is occupied.

OTHER REQUIRED APPROVALS

Fire Dept. _____
 Health Dept. _____
 Appeal Board _____
 Other _____
 Department Name

[Signature] 4/12/06
 Director - Building & Inspection Services

PENALTY FOR REMOVING THIS CARD

City of Portland, Maine - Building or Use Permit Application

389 Congress Street, 04101 Tel: (207) 874-8703, Fax: (207) 874-8716

DEPT. OF BUILDING INSPECTION
CITY OF PORTLAND, ME

Permit No: 06-0389	Issue Date: APR 17 2006	CBL: 299 D046001
-----------------------	----------------------------	---------------------

Location of Construction: 1592 FOREST AVE	Owner Name: CITY OF PORTLAND	Owner Address: 389 CONGRESS ST	Phone: 2078562600
Business Name:	Contractor Name: Sign Design Inc	Contractor Address: PO Box 207 Westbrook	Phone: 2078562600
Lessee/Buyer's Name	Phone:	Permit Type: Signs - Permanent	Zone: R3/B1

Past Use: City School Riverton School	Proposed Use: City School Riverton School/ install a community reader board	Permit Fee: \$158.00	Cost of Work: \$15800	CEO District: 5
Proposed Project Description: install a community reader board		FIRE DE : Approved <input checked="" type="checkbox"/> Denied <input type="checkbox"/>	INSPECTION: Use Group: <i>V</i> Type: <i>Sign</i> <i>IBC 2003</i> Signature: <i>[Signature]</i>	
		RICT (P.A.D.): Action: <input type="checkbox"/> Approved <input type="checkbox"/> Approved w/Conditions <input type="checkbox"/> Denied Signature: _____ Date: _____		

Permit Taken By: Idobson	Date Applied For: 03/24/2006
------------------------------------	--

<ol style="list-style-type: none"> This permit application does not preclude the Applicant(s) from meeting applicable State and Federal Rules. Building permits do not include plumbing, septic or electrical work. Building permits are void if work is not started within six (6) months of the date of issuance. False information may invalidate a building permit and stop all work.. 	Special Zone or Reviews Shoreland <input type="checkbox"/> Wetland <i>permit to Deb Andrews.</i> <input type="checkbox"/> Flood Zone <i>per 14-526(a)(22)</i> <input type="checkbox"/> Subdivision <i>(not meet regulations)</i> <input type="checkbox"/> Site Plan Maj <input type="checkbox"/> Minor <input type="checkbox"/> MM <input type="checkbox"/> Date: <i>3/28/06 ABM</i>	Zoning Appeal Variance <input type="checkbox"/> Miscellaneous <input type="checkbox"/> Conditional Use <input type="checkbox"/> Interpretation <input type="checkbox"/> Approved <input type="checkbox"/> Denied Date: _____	Historic Preservation <input checked="" type="checkbox"/> Not in District or Landmark <input type="checkbox"/> Does Not Require Review <input type="checkbox"/> Requires Review <input type="checkbox"/> Approved <input type="checkbox"/> Approved w/Conditions <input type="checkbox"/> Denied Date: _____
---	--	--	--

X CM approved 040406

CERTIFICATION

I hereby certify that I am the owner of record of the named property, or that the proposed work is authorized by the owner of record and that I have been authorized by the owner to make this application as his authorized agent and I agree to conform to all applicable laws of this jurisdiction. In addition, if a permit for work described in the application is issued, I certify that the code official's authorized representative shall have the authority to enter all areas covered by such permit at any reasonable hour to enforce the provision of the code(s) applicable to such permit.

SIGNATURE OF APPLICANT ADDRESS DATE PHONE

RESPONSIBLE PERSON IN CHARGE OF WORK, TITLE DATE PHONE

City of Portland, Maine - Building or Use Permit

389 Congress Street, 04101 Tel: (207) 874-8703, Fax: (207) 874-8716

Permit No: 06-0389	Date Applied For: 03/24/2006	CBL: 299 D046001
------------------------------	--	----------------------------

Location of Construction: 1592 FOREST AVE	Owner Name: CITY OF PORTLAND	Owner Address: 389 CONGRESS ST	Phone:
Business Name:	Contractor Name: Sign Design Inc	Contractor Address: PO Box 207 Westbrook	Phone (207) 856-2600
Lessee/Buyer's Name	Phone:	Permit Type: Signs - Permanent	

Proposed Use: City School Riverton School / install a community reader board	Proposed Project Description: install a community reader board
--	--

Dept: Historical **Status:** Approved **Reviewer:** Carrie Marsh **Approval Date:** 04/04/2006
Note: Reviewed by Carie Marsh under section 14-526(a) (22) since sign didn't meet regulations in 14-369.5. **Ok to Issue:**

Dept: Zoning **Status:** Not Applicable **Reviewer:** Ann Machado **Approval Date:**
Note: 3/28/06. Sent to Deb Andrews because it does not meet the size permitted under the ordinance per Section 14-526(a)(22). **Ok to Issue:**

1) This permit is being issued with the understanding that the sign will be a minimum of 5' from the property line.

Dept: Building **Status:** Approved with Conditions **Reviewer:** Tammy Munson **Approval Date:** 0411212006
Note: **Ok to Issue:**

1) Signage Installation to comply with Chapter 31 of the IBC 2003 building code.



Signage/Awning Permit Application

If you or the property owner owes real estate or personal property taxes or user charges on any property within the City, payment arrangements must be made before permits of any kind are accepted.

Location/Address of Construction: 1600 Forest Avenue		
Tax Assessor's Chart, Block & Lot Chart# Block# Lot# 299 D 46	Owner: City of Portland Portland Public Schools	Telephone: Doug Sherwood 842-5342
Lessee/Buyer's Name (If Applicable) Riverton School PTO Contact: KATH 31 Blackwood incide	Contractor name, address & telephone: Sign Design Inc 306 Warren Ave	Total s.f. of signage x \$2.00 Per s.f. plus \$30.00/\$65.00 For H.D. signage= Total Fee: \$ _____

_____ designation _____		
_____ same as above _____		
_____		8

No <input checked="" type="checkbox"/> bldg) Yes _____		

A site sketch and building sketch showing exactly where existing and new signage is located must be provided. Sketches and/or pictures of proposed signage and existing building are also required.

Please submit all of the information outlined in the Sign/Awning Application Checklist. Failure to do so may result in the automatic denial of your permit.

In order to be sure the City fully understands the full scope of the project, the Planning and Development Department may request additional information prior to the issuance of a permit. For further information visit us on-line at www.portlandmaine.gov, stop by the Building Inspections office, room 315 City Hall or call 874-8703.

I hereby certify that I am the Owner of record of the named property, or that the owner of record authorizes the proposed work and that I have been authorized by the owner to make this application as his/her authorized agent. I agree to conform to all applicable laws of this jurisdiction. In addition, if a permit for work described in this application is issued, I certify that the Code Official's authorized representative shall have the authority to enter all areas covered by this permit at any reasonable hour to enforce the provisions of the codes applicable to this permit.

Signature of applicant: Kathryn Burston	Date: 3/20/06
--	----------------------

This is not a permit; you may not commence ANY work until the permit is issued.

area 25 ft
height 8'
setback 5'

not meet sq. footage
upto Planning 14-526(a)(22)

96" x 96"
435 ft
8'

This Design Is The Property Of:

Sign Design Inc.

306 Warren Ave. Portland, ME
Phone: 207-856-2600 Fax: 207-856-7600

30x10'

48" x 84" =

92" x 18" =

6" x 96" =

4032

1652

576

6264"

43.5 \$ Signage.

Double Sided, Non Illuminated Cabinet
Aluminum Sign Faces W/ Vinyl Graphics



Customer approval is a signed confirmation that dimensions, colors, graphics and all other job specifics are correct

Customer: Riverton Elementary rev.2
Job Name: riverton comp. 2
Date: 2-27-06

Approval:



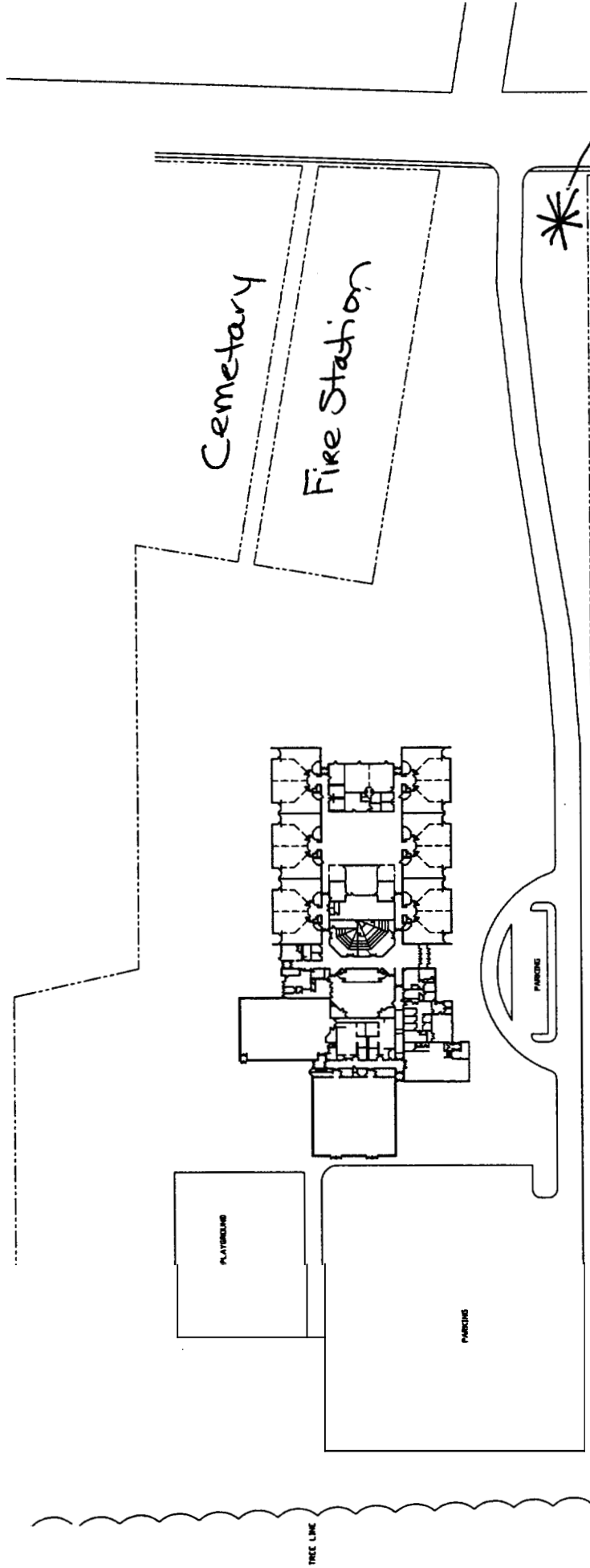

Will be
at least 5'
from property
line per
conversation w/
Kathy Buxton
3/28/06

new sign
existing
sign

RIVERTON
SITE PLAN

Morrison's



Signage/Awning Permit Application Checklist

All of the following information is required and must be submitted. Checking of each item as you prepare your application package will ensure your package is complete and will help to expedite the permitting process.

- N/A* Certificate of Liability listing the City as additional insured if any portion of the sign abuts or encroaches on any public right of way, or can fall into any public right of way.
- Letter of permission from the owner indicating the permissions granted and the tenant/space building frontage. *Doug Sherwood, Portland Public Schools*
- A sketch plan of lot indicating location of buildings, driveways and any abutting streets or rights of way, lengths of building frontages, street frontages and all existing setbacks. Please indicate on the plan all existing and proposed signs with their dimensions and specific locations. Be sure to include distance from the ground and building façade dimensions for any signage attached to the building.
- A sketch or photo of any proposed sign(s) indicating content, dimensions, materials, source of illumination, construction method as well as specifics of installation/attachment.
- N/A* Certificate of flammability required for awning or canopy.
- N/A* A UL# is required for lighted signs at the time of final inspection.
- Pre-application questionnaire completed and attached.
- Photos of existing signage
- Details for sign fastening, attachment or mounting in the ground.

Permit fee for signage or awning-with-signage: **\$30.00** plus **\$2.00** per square foot of sign.

Permit fee for awning-without-signage is based on cost of work:
\$30.00 for the first **\$1,000.00**, **\$9.00** per additional **\$1,000.00** of cost.

Base application fee for any Historic District signage is **\$65.00**.

Kathy Buxton

From: Douglas Sherwood[sherwd@portlandschools.org]
Sent: Sunday, March 19, 2006 11:49 AM
To: Kathy Buxton
Subject: Re: Riverton School project

Ms. Buxton
Kathy,

Good morning!

The pleasure was certainly all mine. You definitely know what needs to get done and how to do it.

I've sent Mr. Nugent an email regarding our (PPS) intention to accept your (PTO's) most gracious gift and advised all interested and necessary parties in the process. Please don't forget about licensing and insurance requirements as well as contacting Dig Safe and Moran's.

We are most fortunate that someone of Mike's experience, credentials and connection to the Portland Public Schools would be interested in this half time Clerk of the Works position. We have not advertised the Clerk of the Works position yet, but will make sure our architect and/or the City of Portland adds Clover Leaf Management to the list of firms and individuals to contact.

Most respectfully and sincerely,
Douglas Ritter Sherwood
Facilities Director
Portland School Department
842-5342

>>> "Kathy Buxton" <kbuxton@LucasTree.com> 03/17/06 5:36 PM >>>
Hi Doug,

Thank you for taking the time to meet with us today concerning the new sign, we are very excited about our project. I will prepare the application and take it to City Hall next week. If I get there and they haven't heard from your office I will give you a call.

Clerk of the Works

After we talked a bit about the renovation project I got to thinking that I know of someone that does this work. I called him and he would be interested in submitting a bid for the "clerk of the works" position as an "Owners Rep for the Portland School Department" and would be able to do it on a part-time basis if needed. He recently completed a similar project for Univ Maine Farmington, Fall 2005 and does this type of work for Gorham Savings Bank and TD Banknorth as a subcontractor.

How would he go about getting a bid packet or submitting his name? The name of the company is: Clover Leaf Management, LLC and the owner is Mike Doherty. Phone: 207-934-0048 or cell: 207-838-0074.

I know the bid packages are going out if not out already but I am not sure if this position was included.

Mike was actually a member of the first graduating class of PRVTC back in 1977 and graduated from the "Building construction" program. He also worked for Ledgewood Construction and was called in as the Superintendent to get the Lincoln Middle School project completed when the original contractor was fired. He welcomes the opportunity to speak with you and/or the Riverton Building Committee on the Riverton project.

Again, thank you for your help.
Kathy