

THE PARTY NAMED ON THESE PLANS CANNOT COPY IT, CONSTRUCT IT, OR GIVE IT TO A THIRD PARTY, WITHOUT PERMISSION OF STIFFLER AND CLOSE BUILDERS.

STRUCTURAL

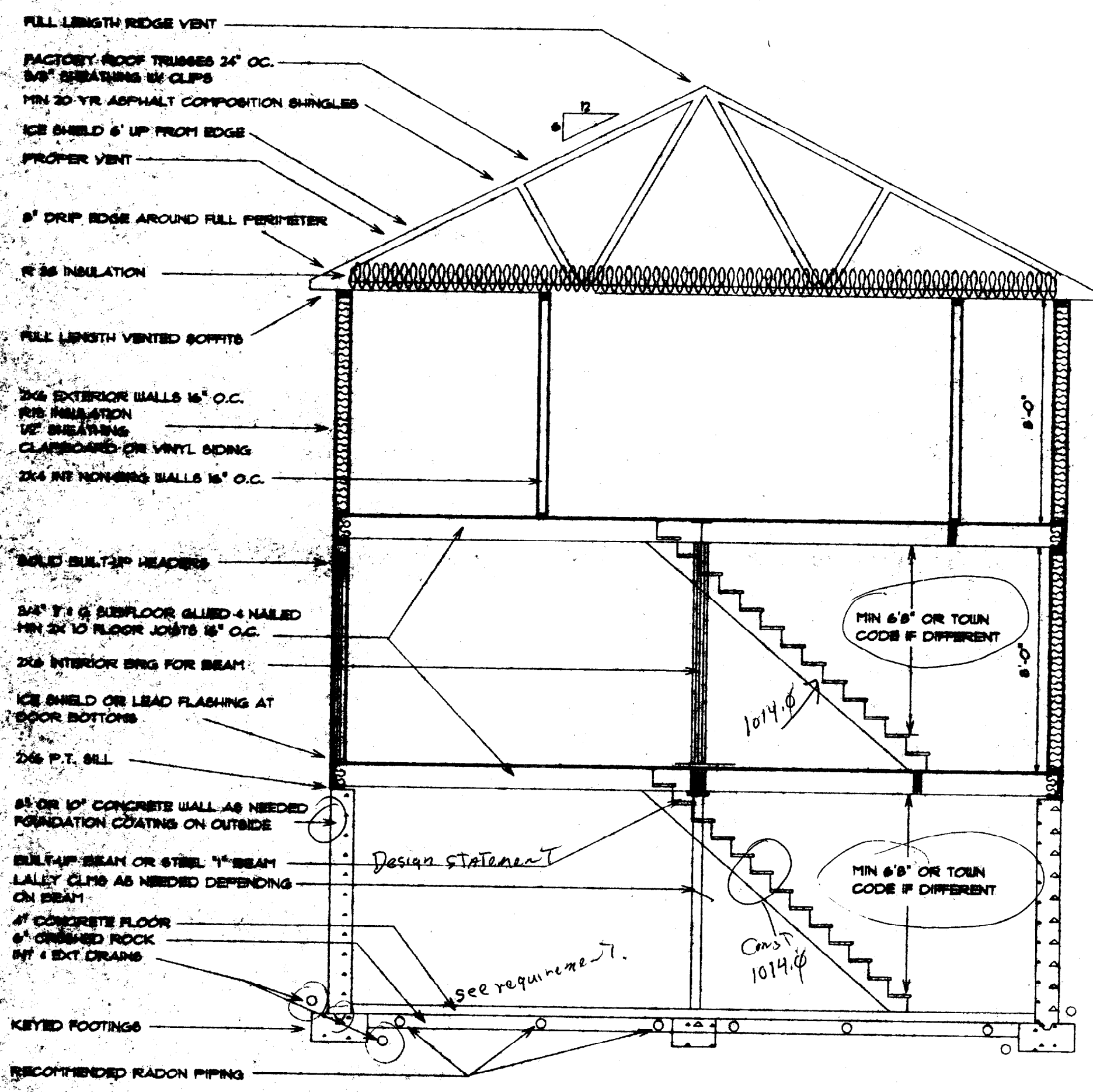

- FULL LENGTH RIDGE VENT
- FACTORY ROOF TRUSSES 24" O.C.
- 5/8" SHEATHING W/ CLIPS
- MIN 20-YR ASPHALT COMPOSITION SHINGLES
- ICE SHIELD 6' UP FROM EDGE
- PROPER VENT
- 6" DRIP EDGE AROUND FULL PERIMETER
- R-28 INSULATION
- FULL LENGTH VENTED SOFFITS
- 2x6 EXTERIOR WALLS 16" O.C.
- R-19 INSULATION
- 1/2" SHEATHING
- CLAPBOARD OR VINYL SIDING
- 2x4 INT NON-BEARING WALLS 16" O.C.
- SOLID BUILT-UP HEADERS
- 3/4" x 1/2" SUBFLOOR GLUED & NAILED
- MIN 2x10 FLOOR JOISTS 16" O.C.
- 2x6 INTERIOR BRG FOR BEAM
- ICE SHIELD OR LEAD FLASHING AT DOOR BOTTOMS
- 2x6 P.T. SILL
- 8" OR 10" CONCRETE WALL AS NEEDED
- FOUNDATION COATING ON OUTSIDE
- BUILT-UP BEAM OR STEEL 1" BEAM
- LALLEY CLIPS AS NEEDED DEPENDING ON BEAM
- 4" CONCRETE FLOOR
- 6" CRUSHED ROCK
- INT & EXT DRAINS
- KEYED FOOTINGS
- RECOMMENDED RADON PIPING

Design Statement

see requirements

MIN 6'8" OR TOWN CODE IF DIFFERENT

MIN 6'8" OR TOWN CODE IF DIFFERENT

Const 1014.0

- = \$