

1. Plot - to Scale

85 Avalon Rd Property

FOR MORTGAGE LENDER USE ONLY

GENERAL NOTES: (1) DISTANCES SHOWN ARE TAKEN FROM PROVIDED TITLE REFERENCES SHOWN BELOW. (2) THE PURPOSE OF THIS INSPECTION IS TO RENDER AN OPINION AS FOLLOWS: A) DWELLING AND ACCESSORY STRUCTURE'S COMPLIANCE WITH RESPECT TO MUNICIPAL ZONING SETBACKS, AND B) FLOOD ZONE DETERMINATION BY HORIZONTAL SCALING ON BELOW REFERENCED FEMA MAP. (3) THIS INSPECTION EXCEPTS OUT ALL TECHNICAL STANDARDS CURRENTLY SET FORTH BY STATE OF MAINE BOARD OF LICENSURE FOR PROFESSIONAL LAND SURVEYORS. (4) THIS INSPECTION IS TO BE USED ONLY BY THE BELOW LISTED LENDER AND IS NOT TO BE USED BY ANOTHER PARTY FOR BOUNDARY LINE LOCATIONS OR LAND TITLE OPINIONS. (5) TITLE OR OWNERSHIP NOT DETERMINED. (6) A BOUNDARY SURVEY SHOULD BE PERFORMED TO RENDER A PROFESSIONAL OPINION PERTAINING TO BOUNDARY LINE LOCATIONS, BASEMENTS, RIGHTS OF WAY, ENCUMBRANCES, ENCROACHMENTS, AND/OR CONFLICTS WITH ADJUTER'S DEEDS. (7) LOCATION/EXISTENCE OF WETLANDS NOT DETERMINED UNLESS SHOWN ON A RECORDED SUBDIVISION PLAN. (8) THIS OFFICE DOES NOT GRANT AUTHORIZATION TO ANY THIRD PARTY FOR USE OF THIS INSPECTION IN ANY BOUNDARY LINE EVALUATION FOR PERMITTING/PLANNING/APPROVALS. (9) THIS OFFICE ACCEPTS NO LIABILITY AND/OR RESPONSIBILITY FOR THE IMPROPER USE OF THIS MORTGAGE LOAN INSPECTION.

REV. 08/01/2013

THIS SKETCH IS NOT TO BE USED FOR CONSTRUCTION PURPOSES. IMPROVEMENTS SHOWN ARE APPROXIMATE.

ADDRESS: 85 Avalon Road
Portland, Maine

INSP. DATE: 04/13/2015
SCALE: 1" = 30'

Recommend Boundary Survey for accurate location.

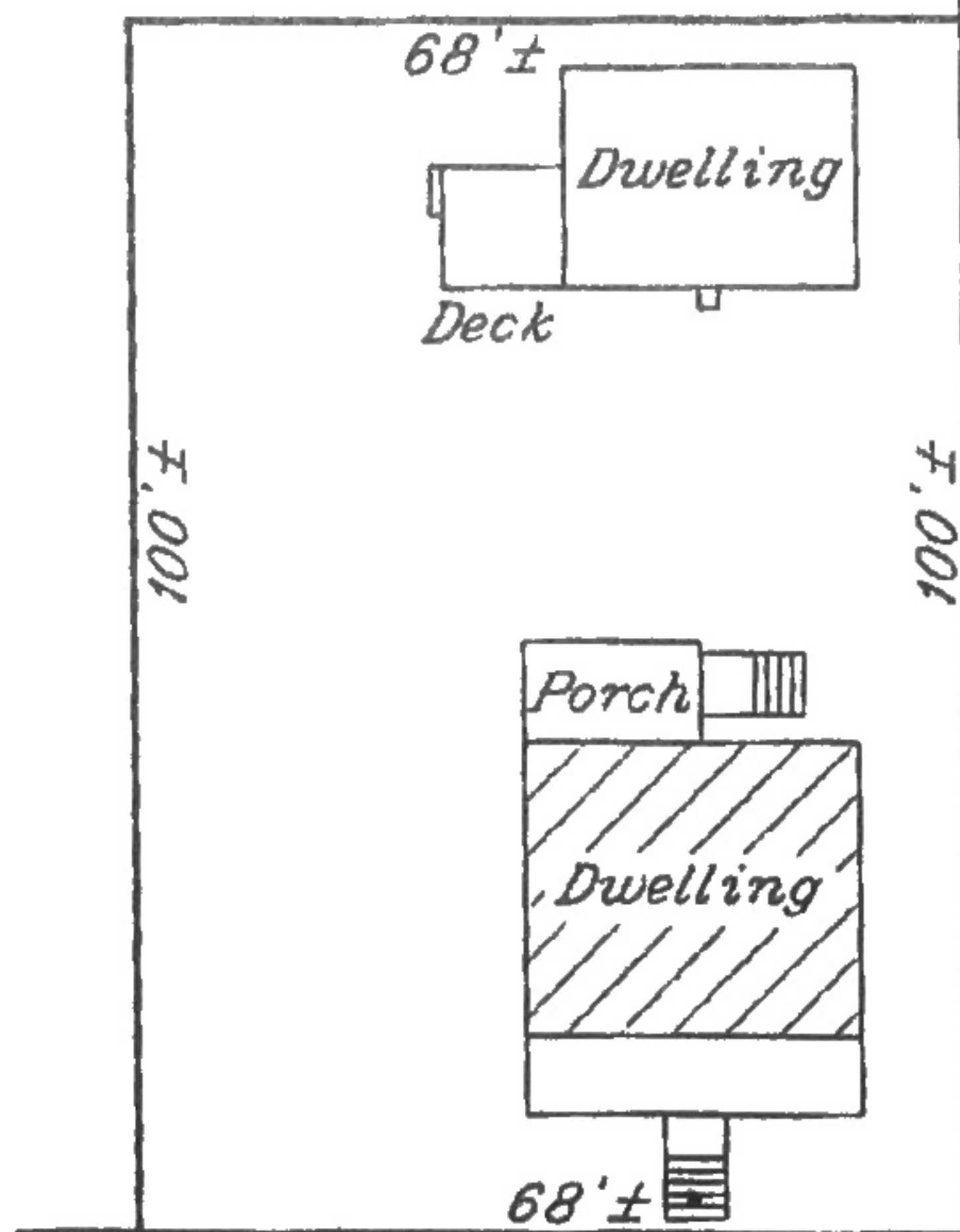

Dorothy Street

Avalon Road

Driveways in Right of Way

JDN

SEE PROVIDED TITLE REFERENCES FOR APPURTENANCES, IF ANY.

APPLICANT: Wilbur FILE#: 21528151
OWNER: Estate of Dongo & Campbell CLIENT#: _____
LENDER: TD Bank, NA
REQ. PARTY: Gateway Title of Maine, Inc.

TITLE REFERENCES: COUNTY: Cumberland
DEED BOOK: 9554 PAGE: 141
PLAN BOOK: 12 PAGE: 11 LOT: 71, p/o 70

MUNICIPAL REFERENCE:
MAP: 297 BLOCK: E LOT: 19

THE DWELLING DOES NOT FALL WITHIN A SPECIAL FLOOD HAZARD AREA PER FEMA COMMUNITY MAP No. 230051 PANEL: 0007C ZONE: X DATE: 12/08/1998

THE DWELLING WAS IN COMPLIANCE WITH MUNICIPAL ZONING SETBACK REQUIREMENTS AT THE TIME OF CONSTRUCTION.

Nadeau Land Surveys

Professional Land Surveyors
Certified Floodplain Managers

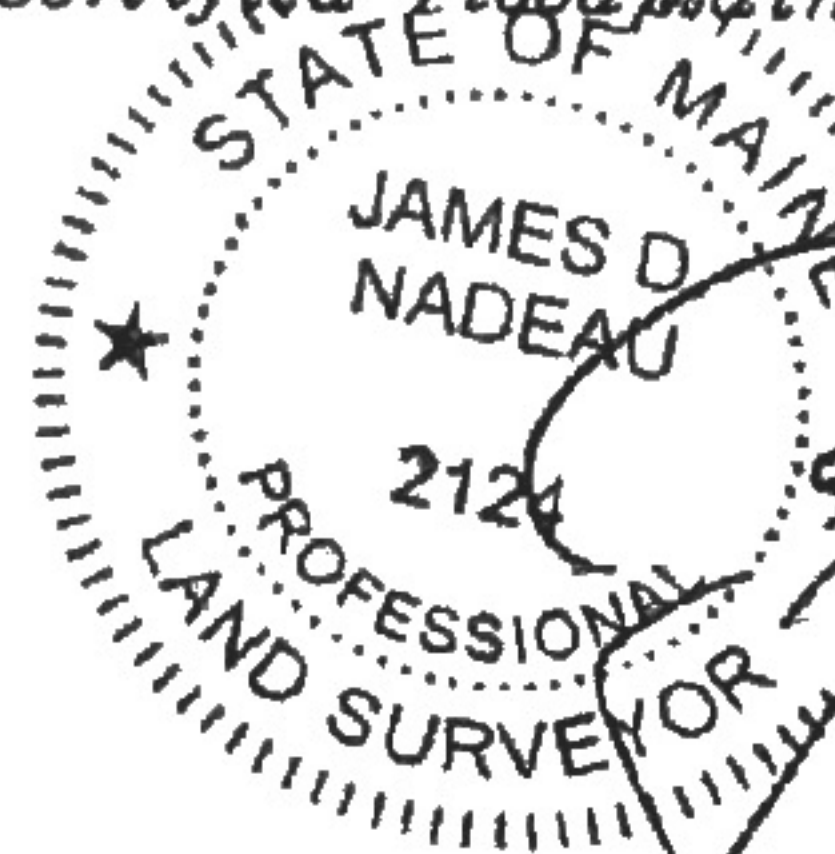

918 BRIGHTON AVE. PH. (207) 878-7870
PORTLAND, ME. 04102 F. (207) 878-7871
THIS INSPECTION IS VALID ONLY WITH A SURVEYOR'S SEAL AND IS NULL & VOID 90 DAYS AFTER INSPECTION DATE.

THIS IS NOT A BOUNDARY SURVEY - NOT FOR RECORDING