

DISPLAY THIS CARD ON PRINCIPAL FRONTAGE OF WORK

CITY OF PORTLAND

BUILDING DEPARTMENT

PERMIT

Permit Number: 100862

PERMIT ISSUED

Please Read Application And Notes, If Any, Attached

This is to certify that COLLINS STEVEN D /Waterhouse Builders
has permission to removing large existing deck, replacing w/ roller deck. Repair roof eav sills
AT 90 DOROTHY ST CB# 297 C014001 AUG 20 2010

provided that the person or persons, firm or corporation accepting this permit, shall comply with all of the provisions of the Statutes of Maine and of the Ordinances of the City of Portland regulating the construction, maintenance and use of buildings and structures, and of the application on file in this department.

Apply to Public Works for street line and grade if nature of work requires such information.

Notification of inspection must be given and written permission procured before this building or part thereof is lathed or otherwise finished-in. 24 HOUR NOTICE IS REQUIRED.

A certificate of occupancy must be procured by owner before this building or part thereof is occupied.

OTHER REQUIRED APPROVALS

Fire Dept. _____
Health Dept. _____
Appeal Board _____
Other _____
Department Name

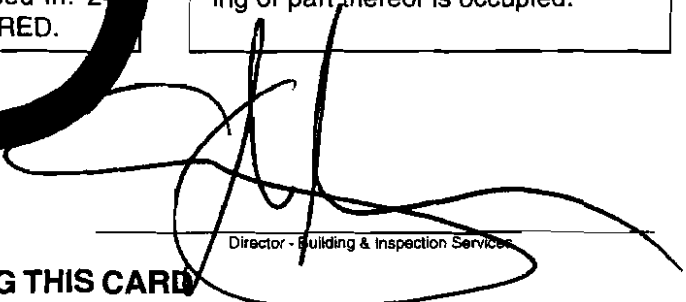

Director - Building & Inspection Services

PENALTY FOR REMOVING THIS CARD

City of Portland, Maine - Building or Use Permit Application

389 Congress Street, 04101 Tel: (207) 874-8703, Fax: (207) 874-8716

Permit No: 10-0862	Issue Date:	CBL: 297 C014001
-----------------------	-------------	---------------------

Location of Construction: 90 DOROTHY ST	Owner Name: COLLINS STEVEN D	Owner Address: 7465 BINGHAM RD	Phone:
Business Name:	Contractor Name: Waterhouse Builders	Contractor Address: 19 Waterhouse Road Cape Elizabeth	Phone 2076154971
Lessee/Buyer's Name	Phone:	Permit Type: Alterations - Dwellings	Zone: R-3

Past Use: Single Family Home	Proposed Use: Single Family Home - removing large existing deck, replacing w/ smaller deck Repair rotted sills	Permit Fee: \$80.00	Cost of Work: \$6,000.00	CEO District: 5	14,600
		FIRE DEPT: <input type="checkbox"/> Approved <input checked="" type="checkbox"/> Denied N/A	INSPECTION: Use Group: R-3 Type: SB IRC 2003		

Proposed Project Description: removing large existing deck, replacing w/ smaller deck Repair rotted sills	Signature: <i>[Signature]</i>	Signature: <i>[Signature]</i>
PEDESTRIAN ACTIVITIES DISTRICT (P.A.D.)		
Action: <input type="checkbox"/> Approved <input type="checkbox"/> Approved w/Conditions <input checked="" type="checkbox"/> Denied		
Signature:	Date:	

Permit Taken By: Idobson	Date Applied For: 07/20/2010	Zoning Approval
-----------------------------	---------------------------------	------------------------

<ol style="list-style-type: none"> This permit application does not preclude the Applicant(s) from meeting applicable State and Federal Rules. Building permits do not include plumbing, septic or electrical work. Building permits are void if work is not started within six (6) months of the date of issuance. False information may invalidate a building permit and stop all work.. 	Special Zone or Reviews <input type="checkbox"/> Shoreland <input type="checkbox"/> Wetland <input type="checkbox"/> Flood Zone <input type="checkbox"/> Subdivision <input type="checkbox"/> Site Plan Maj <input type="checkbox"/> Minor <input type="checkbox"/> MM <input type="checkbox"/> <input checked="" type="checkbox"/> Denied Date: <i>7/22/10</i>	Zoning Appeal <input type="checkbox"/> Variance <input type="checkbox"/> Miscellaneous <input type="checkbox"/> Conditional Use <input type="checkbox"/> Interpretation <input type="checkbox"/> Approved <input checked="" type="checkbox"/> Denied Date:	Historic Preservation <input checked="" type="checkbox"/> Not in District or Landmark <input type="checkbox"/> Does Not Require Review <input type="checkbox"/> Requires Review <input type="checkbox"/> Approved <input type="checkbox"/> Approved w/Conditions <input type="checkbox"/> Denied Date:
	<p style="font-size: 2em; font-weight: bold; text-align: center;">PERMIT ISSUED</p> <p style="font-size: 1.5em; text-align: center;">AUG 20 2010</p> <p style="text-align: center;">City of Portland</p>		

CERTIFICATION

I hereby certify that I am the owner of record of the named property, or that the proposed work is authorized by the owner of record and that I have been authorized by the owner to make this application as his authorized agent and I agree to conform to all applicable laws of this jurisdiction. In addition, if a permit for work described in the application is issued, I certify that the code official's authorized representative shall have the authority to enter all areas covered by such permit at any reasonable hour to enforce the provision of the code(s) applicable to such permit.

SIGNATURE OF APPLICANT ADDRESS DATE PHONE

RESPONSIBLE PERSON IN CHARGE OF WORK, TITLE DATE PHONE



CITY OF PORTLAND, MAINE

Department of Building Inspections

Original Receipt

7.20 20 10

Received from

Walton Builders

Location of Work

90 Dorothy St

Cost of Construction

\$ _____

Building Fee: _____

Permit Fee

\$ _____

Site Fee: _____

Certificate of Occupancy Fee: _____

Total:

80

Building (1L) _____

Plumbing (1S) _____

Electrical (1Z) _____

Site Plan (1Z) _____

Other _____

CBL:

297 C-14

Check #:

1191

Total Collected \$

80

**No work is to be started until permit issued.
Please keep original receipt for your records.**

Taken by:

[Signature]

WHITE - Applicant's Copy

YELLOW - Office Copy

PINK - Permit Copy



General Building Permit Application

If you or the property owner owes real estate or personal property taxes or user charges on any property within the City, payment arrangements must be made before permits of any kind are accepted.

Location/Address of Construction: <u>90 Dorothy St Portland Me</u>		
Total Square Footage of Proposed Structure/Area	Square Footage of Lot	Number of Stories <u>1</u>
Tax Assessor's Chart, Block & Lot Chart# <u>297</u> Block# <u>C</u> Lot# <u>14</u>	Applicant * <u>must</u> be owner, Lessee or Buyer* Name Address City, State & Zip	Telephone:
Lessee/DBA (If Applicable) Waterhouse Builders Mike Backman 19 Waterhouse RD Cape Elizabeth Me 04107	Owner (if different from Applicant) Name <u>Steve Collins</u> Address <u>7465 Bingham RD</u> City, State & Zip <u>Bloomfield Hills MN 48301</u>	Cost Of Work: \$ <u>6000.00</u> C of O Fee: \$ _____ Total Fee: \$ <u>80.00</u>
Current legal use (i.e. single family) <u>Single family</u> Number of Residential Units <u>1</u> If vacant, what was the previous use? _____ Proposed Specific use: _____ Is property part of a subdivision? _____ If yes, please name _____ Project description: <u>Remove large existing deck, replacing with smaller deck Repair to rot sills</u>		
Contractor's name: <u>Waterhouse Builders / Mike Backman</u> Address: <u>19 Waterhouse RD Cape Elizabeth ME</u> City, State & Zip _____ Telephone: _____ Who should we contact when the permit is ready: <u>Mike Backman</u> Telephone: <u>207-615-4971</u> Mailing address: <u>19 Waterhouse RD Cape Elizabeth</u>		

Please submit all of the information outlined on the applicable Checklist. Failure to do so will result in the automatic denial of your permit.

In order to be sure the City fully understands the full scope of the project, the Planning and Development Department may request additional information prior to the issuance of a permit. For further information or to download copies of this form and other applications visit the Inspections Division on-line at www.portlandmaine.gov, or stop by the Inspections Division office, room 315 City Hall or call 874-8703.

I hereby certify that I am the Owner of record of the named property, or that the owner of record authorizes the proposed work and that I have been authorized by the owner to make this application as his/her authorized agent. I agree to conform to all applicable laws of this jurisdiction. In addition, if a permit for work described in this application is issued, I certify that the Code Official's authorized representative shall have the authority to enter all areas covered by this permit at any reasonable hour to enforce the provisions of the codes applicable to this permit.

RECEIVED

JUL 20 2010

Signature: [Signature] Date: _____

This is not a permit; you may not commence ANY work until the permit is issued. Dept. of Building Inspections City of Portland and Maine

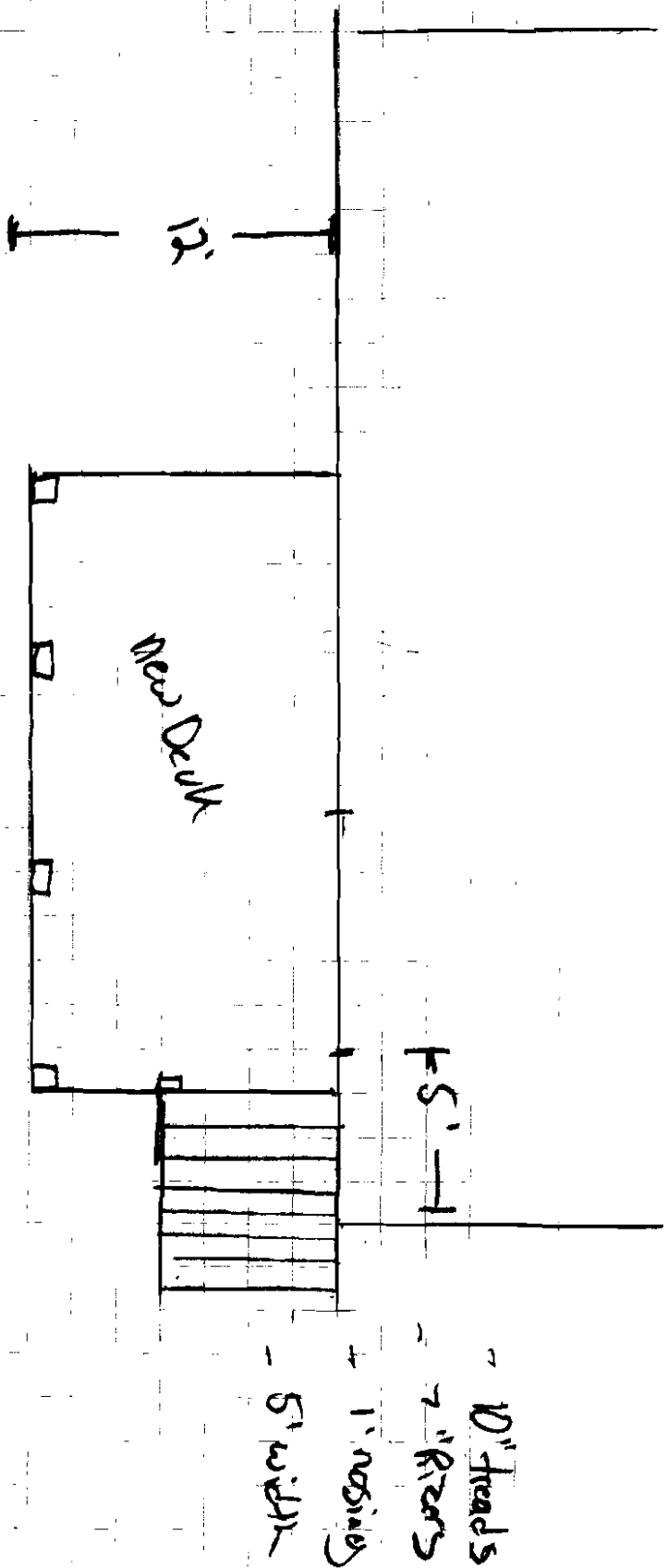

- 2x6 ledger - 6" Lags 14" centers
- 2x8 Joist 16" on centers 12' span
- 4x4 Post on 48" Piers 10"
- 5' on center, Simpson bracket

5' span on

City of Portland, Maine - Building or Use Permit

389 Congress Street, 04101 Tel: (207) 874-8703, Fax: (207) 874-8716

Permit No: 10-0862	Date Applied For: 07/20/2010	CBL: 297 C014001
------------------------------	--	----------------------------

Location of Construction: 90 DOROTHY ST	Owner Name: COLLINS STEVEN D	Owner Address: 7465 BINGHAM RD	Phone:
Business Name:	Contractor Name: Waterhouse Builders	Contractor Address: 19 Waterhouse Road Cape Elizabeth	Phone (207) 615-4971
Lessee/Buyer's Name	Phone:	Permit Type: Alterations - Dwellings	

Proposed Use: Single Family Home - removing large existing deck, replacing w/ smaller deck Repair rotted sills	Proposed Project Description: removing large existing dck, replacing w/ smaller deck Repair rotted sills
--	--

Dept: Zoning **Status:** Approved with Conditions **Reviewer:** Marge Schmuckal **Approval Date:** 07/22/2010

Note: **Ok to Issue:** ✓

- 1) Separate permits shall be required for future decks, sheds, pools, and/or garages.
- 2) This is NOT an approval for an additional dwelling unit. You SHALL NOT add any additional kitchen equipment including, but not limited to items such as stoves, microwaves, refrigerators, or kitchen sinks, etc. Without special approvals.
- 3) This property shall remain a single family dwelling. Any change of use shall require a separate permit application for review and approval.
- 4) This permit is being approved on the basis of plans submitted. Any deviations shall require a separate approval before starting that work.

Dept: Building **Status:** Approved with Conditions **Reviewer:** Tammy Munson **Approval Date:** 08/05/2010

Note: **Ok to Issue:** ✓

- 1) Application approval based upon information provided by applicant. Any deviation from approved plans requires separate review and approval prior to work.

BUILDING PERMIT INSPECTION PROCEDURES

Please call 874-8703 or 874-8693 (ONLY)

or email: buildinginspections@portlandmaine.gov

With the issuance of this permit, the owner, builder or their designee is required to provide adequate notice to the City of Portland Inspection Services for the following inspections. Appointments must be requested 48 to 72 hours in advance of the required inspection. The inspection date will need to be confirmed by this office.

- Please read the conditions of approval that is attached to this permit!! Contact this office if you have any questions.
- Permits expire in 6 months, if the project is not started or ceases for 6 months.
- If the inspection requirements are not followed as stated below additional fees may be incurred due to the issuance of a "Stop Work Order" and subsequent release to continue with construction.

 X Footing/Building Location Inspection: Prior to pouring concrete or setting precast piers

 X Framing inspection required. This can be done upon completion if the framing is visible.

 X Final inspection required at completion of work.

The project cannot move to the next phase prior to the required inspection and approval to continue, REGARDLESS OF THE NOTICE OR CIRCUMSTANCES.

IF THE PERMIT REQUIRES A CERTIFICATE OF OCCUPANCY, IT MUST BE PAID FOR AND ISSUED TO THE OWNER OR DESIGNEE BEFORE THE SPACE MAY BE OCCUPIED.

PERMIT ISSUED

AUG 20 2010

City of Portland

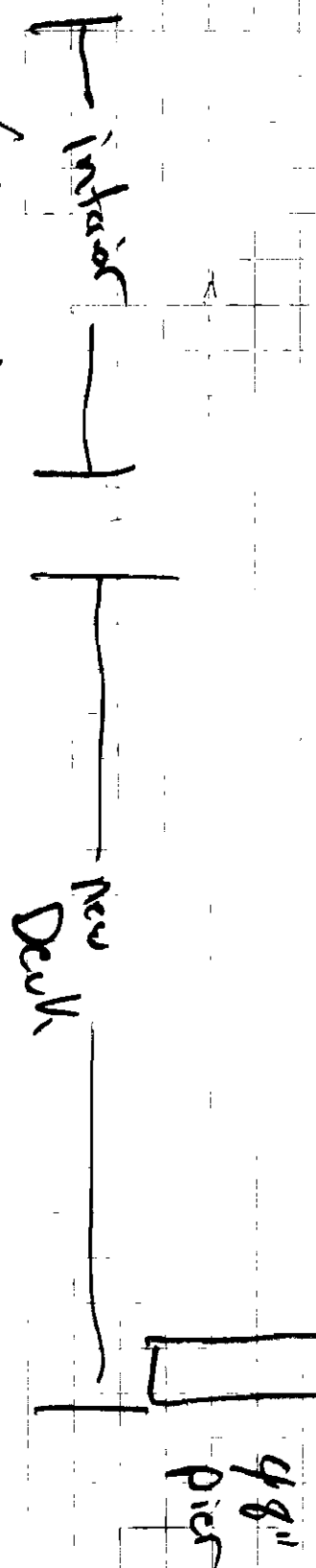
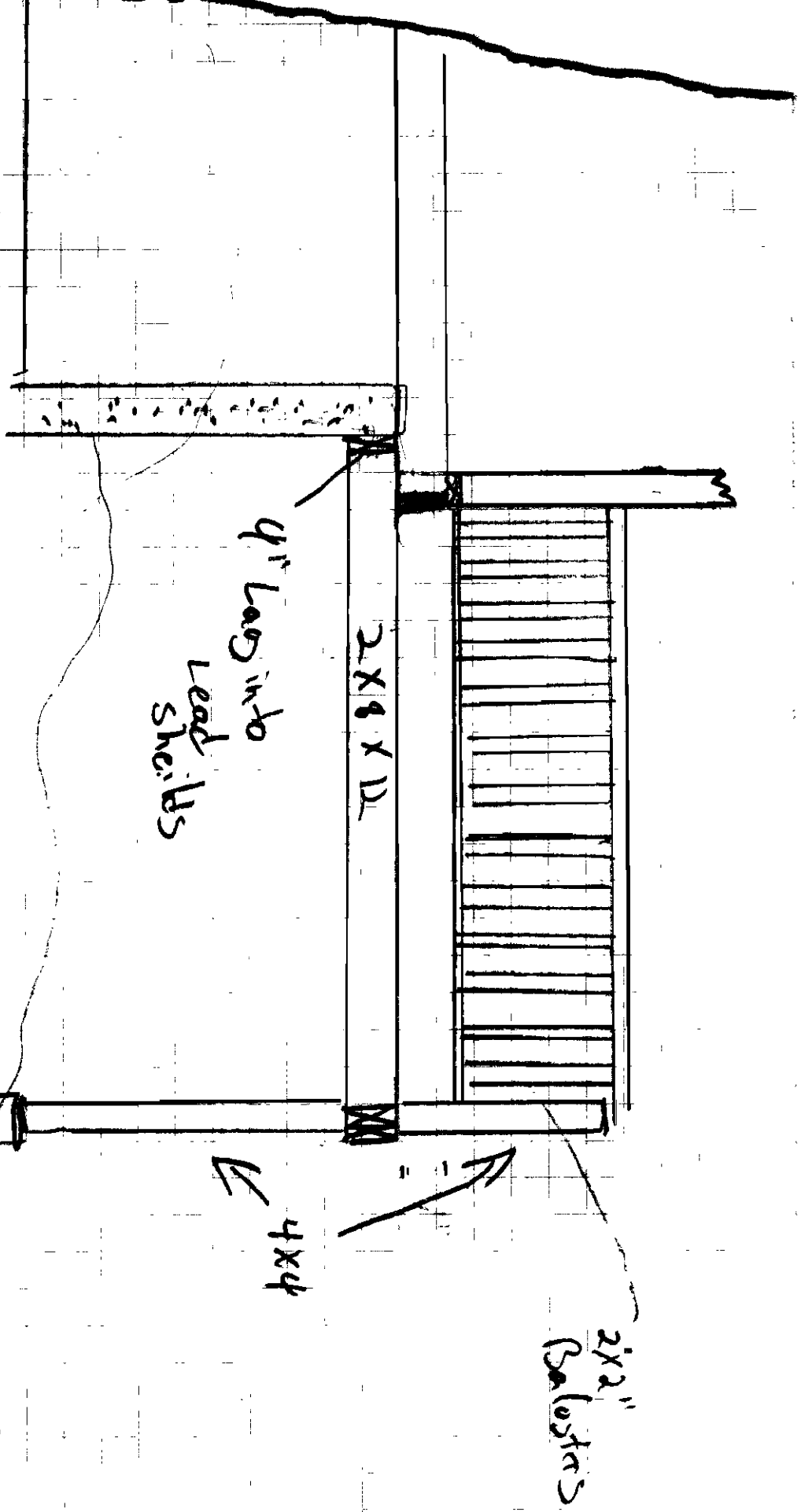

Hand rail
36" High Handrail
4" guard rail
4" Balusters Spacing

New Deck

4" Lead into Lead Sheets

2x2" Balusters

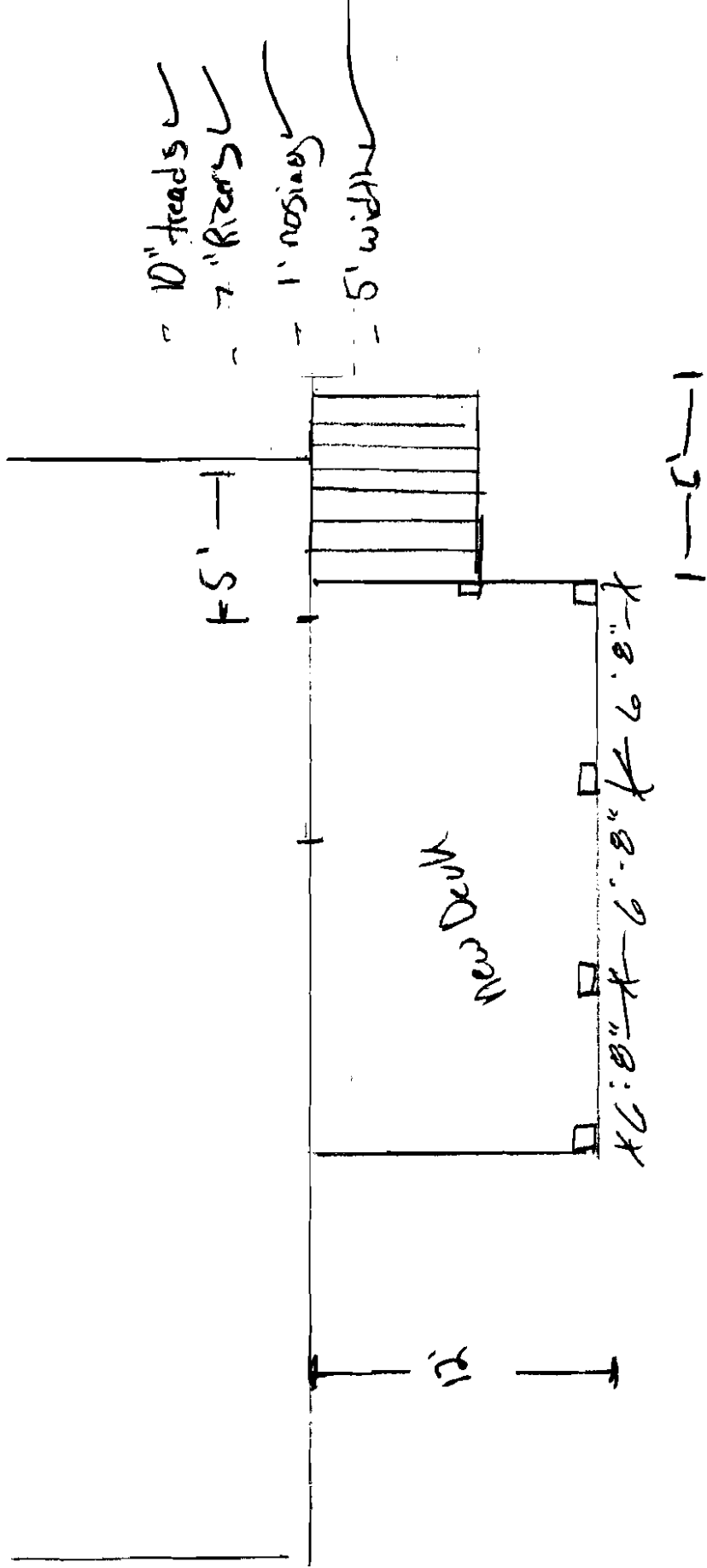

- 10" heads ✓
- 7" Riser ✓
- 1" nosing ✓
- 5" width ✓

- 1 20' 1
- ✓ 2x8 ledge - 6" Lags 14" centers
- ✓ 2x8 Joist 16" on centers 12' span
- ✓ 4x4 Post on 48" Piers 10" 5' on center, simpson bracket

1x5^h DC - 2-2x8's for beam
 are OK

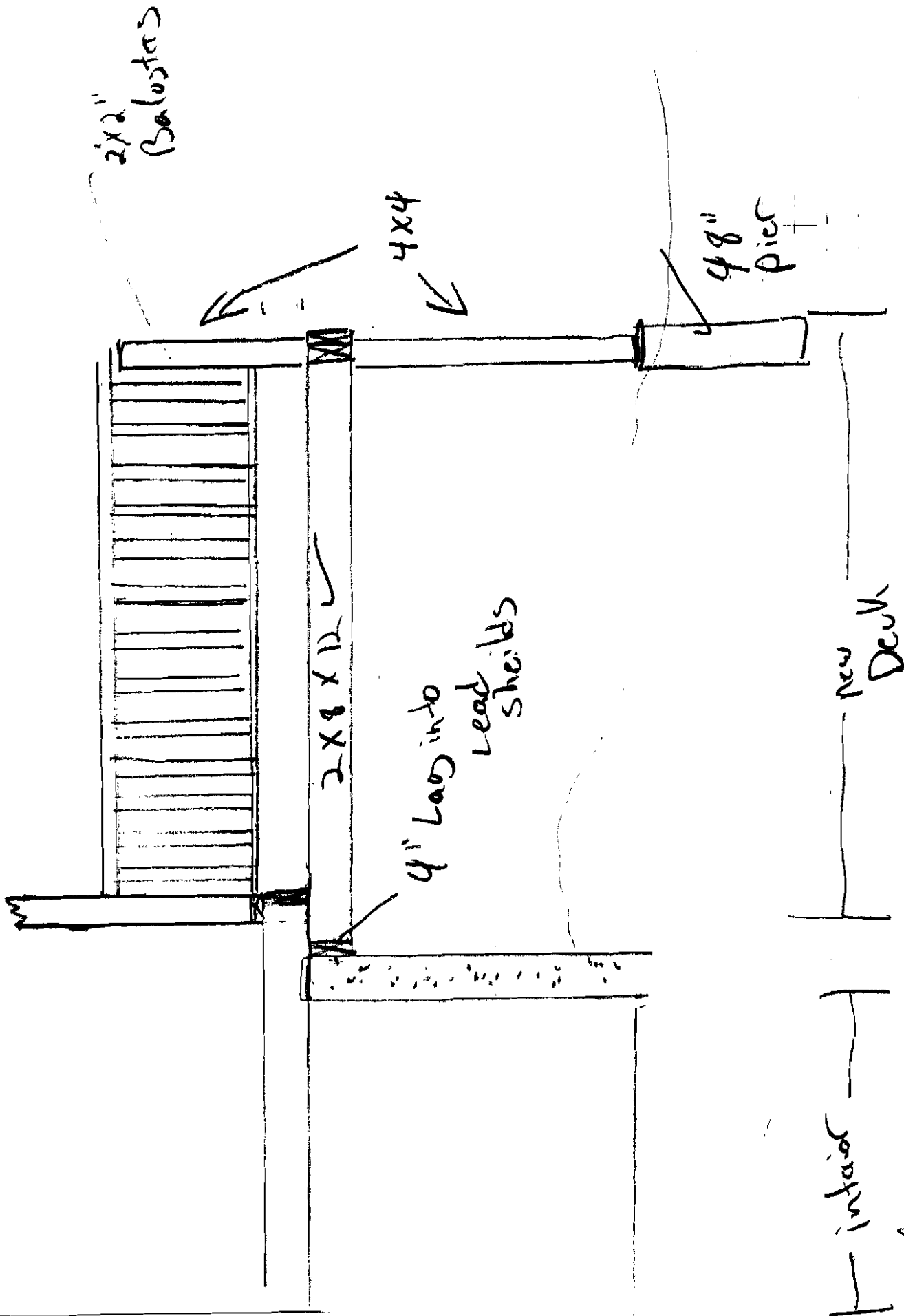

(Hand rail)
 36" High Handrail ✓
 4" square rail ✓
 4" Balusters spacing ✓
 New Deck

