

A PARAPET IS NOT REQUIRED WHEN THE ROOF IS COVERED WITH A MINIMUM CLASS C ROOF COVERING, AND THE ROOF DECKING OR SHEATHING IS A NON-COMBUSTIBLE MATERIAL OR APPROVED FIRE-RETARDANT-TREATED WOOD FOR A DISTANCE OF 4 FT. ON EACH SIDE OF THE WALLS, OR ONE LAYER 5/8" TYPE 'X' GYPSUM BOARD IS INSTALLED DIRECTLY BENEATH THE ROOF DECKING OR SHEATHING FOR A DISTANCE OF 4 FT. ON EACH SIDE OF WALLS. (IRC)

ROOF PLAN

SCALE : 1/4" = 1' - 0"

GENERAL NOTES:

- All work shall be in accordance with IBC Building Code, NFPA-70 National Electric Code, Maine State Plumbing Code, ASHRAE, U.L., NFPA Codes, Americans with Disabilities Act 1990 (ADA) and all local, State and Federal requirements.
- All applicable Federal, State and Municipal regulations shall be followed, including the Federal Department of Labor Occupational Safety and Health act.
- All required City and State permits must be obtained before any construction begins.
- It is the contractor's sole responsibility to determine erection procedures and sequence to ensure the safety of the building and its components during erection. This includes the addition of necessary shoring, sheeting, temporary bracing, guys or tie-downs. Such material shall remain the property of the contractor after completion of the project.
- Structural, Mechanical, Electrical and Plumbing design and installation by others shall be performed in accordance with local, State and Federal standards.
- All fire ratings indicated shall be continuous to underside of fire rated ceiling or underside of roof deck. Seal all openings & mechanical penetrations with approved fire rating material.
- Building shall be sprinklered in accordance with NFPA-13. Contractor shall submit plans for State Fire Marshal approval prior to construction in accordance to state law.
- Building shall have approved smoke detectors in accordance with NFPA-101 Life Safety Code. Smoke detectors shall initiate alarm that is audible in the sleeping rooms of each unit.
- Portable fire extinguishers shall be provided in all hazardous areas in accordance with NFPA-101. Local authority having jurisdiction needs to provide written requirements.
- Balconies must maintain a 42" guardrail height and shall be kept free and clear of ice and snow at all times to ensure the second means of egress.
- HVAC installation to be in accordance with ASHRAE, NFPA-90A, OR NFPA-90B and all federal, local and State codes. Ventilation or heat equipment shall be in accordance with NFPA-91, NFPA-211, NFPA-31, NFPA-54 and NFPA-70 as applicable.
- These plans are not to be duplicated or reproduced for multiple buildings. The stamped drawing set is for one constructed building.

FRAMING NOTES:

- ALL EXTERIOR WALLS TO BE 2X6 WOOD STUD WALLS @ 16" O.C. W/ 1/2" G.W.B. AND VAPOR BARRIER @ INSIDE FACE OF WALL, 6" BATT INSULATION (R-21), AND 7/16" APA RATED SHEATHING @ EXTERIOR FACE OF WALL.
- ALL INTERIOR WALLS TO BE 2X4 WOOD STUD WALLS (UNLESS NOTED OTHERWISE) W/ ONE LAYER 1/2" G.W.B. EACH SIDE.
- INSTALL BLOCKING BEHIND ALL SURFACE APPLIED FIXTURES, TRIM, AND SHELVES WHEN MOUNTED ON WALLS.
- THE LOCATION OF ALL DOOR FRAMES SHALL BE 4 1/2" (UNLESS NOTED OTHERWISE) FROM ADJACENT WALLS.

FOUNDATION NOTES:

- PROVIDE SILL SEALER ON TOP OF ALL FOUNDATION WALLS.
- FOUNDATION WALLS SHALL BE BACKFILLED SIMULTANEOUSLY ON BOTH SIDES.
- ALL STEEL REINFORCING IN FOOTINGS TO BE A MINIMUM 3" CLEAR FROM BOTTOM OF FOOTING.
- ALL STEEL REINFORCING IN FOUNDATION WALLS BELOW GRADE TO BE MINIMUM OF 2" CLEAR FROM FACE OF WALL.
- ALL WOOD IN CONTACT WITH CONCRETE SHALL BE PRESSURE PRESERVATIVE TREATED W/CCA TO 0.4#/CF RETENTION PER AWPA.
- ALL CONCRETE SURFACES SHALL HAVE A STEEL TROWEL & LIGHT BROOM FINISH.
- SET ALL FOOTINGS ON UNDISTURBED SOIL OR COMPACTED STRUCTURAL FILL.

NOTE: BUILDING TO BE SPRINKLERED PER NFPA-13

ROUGH OPENING	HEADER SIZE
0 - 3'-0"	(3) - 2x6
3'-1" - 4'-6"	(3) - 2x8
4'-7" - 5'-8"	(3) - 2x10
5'-9" - 7'-0"	(3) - 2x12

NOTE: PROVIDE JAMBS BOTH ENDS AS FOLLOWS:
 2x6 JACK PLUS 2x6 KING UP TO 4'-6" ROUGH OPENING
 (2) 2x6 JACKS PLUS (2) 2x6 KINGS UP TO 7'-0" ROUGH OPENING

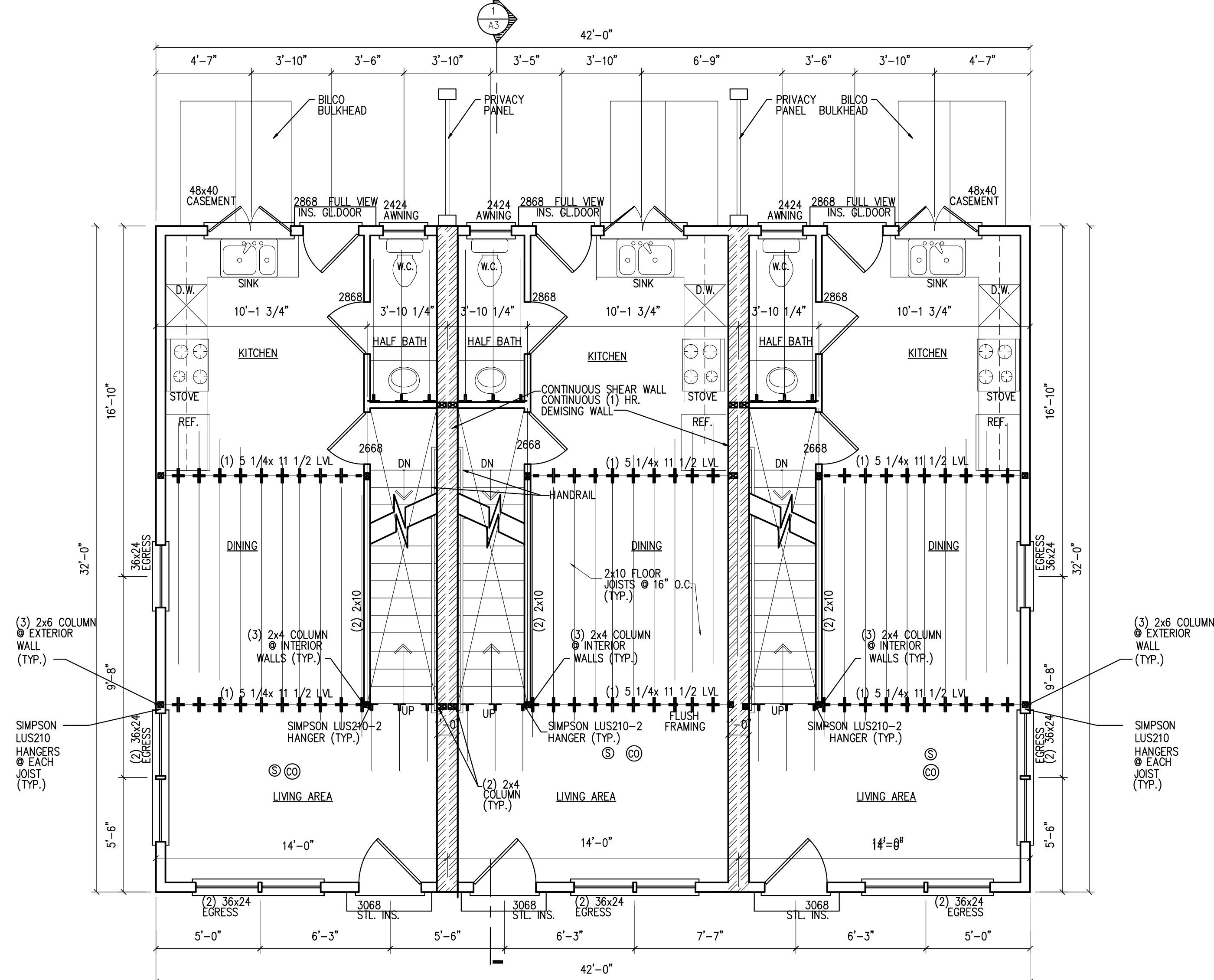

FIRST FLOOR PLAN

SCALE : 1/4" = 1' - 0"

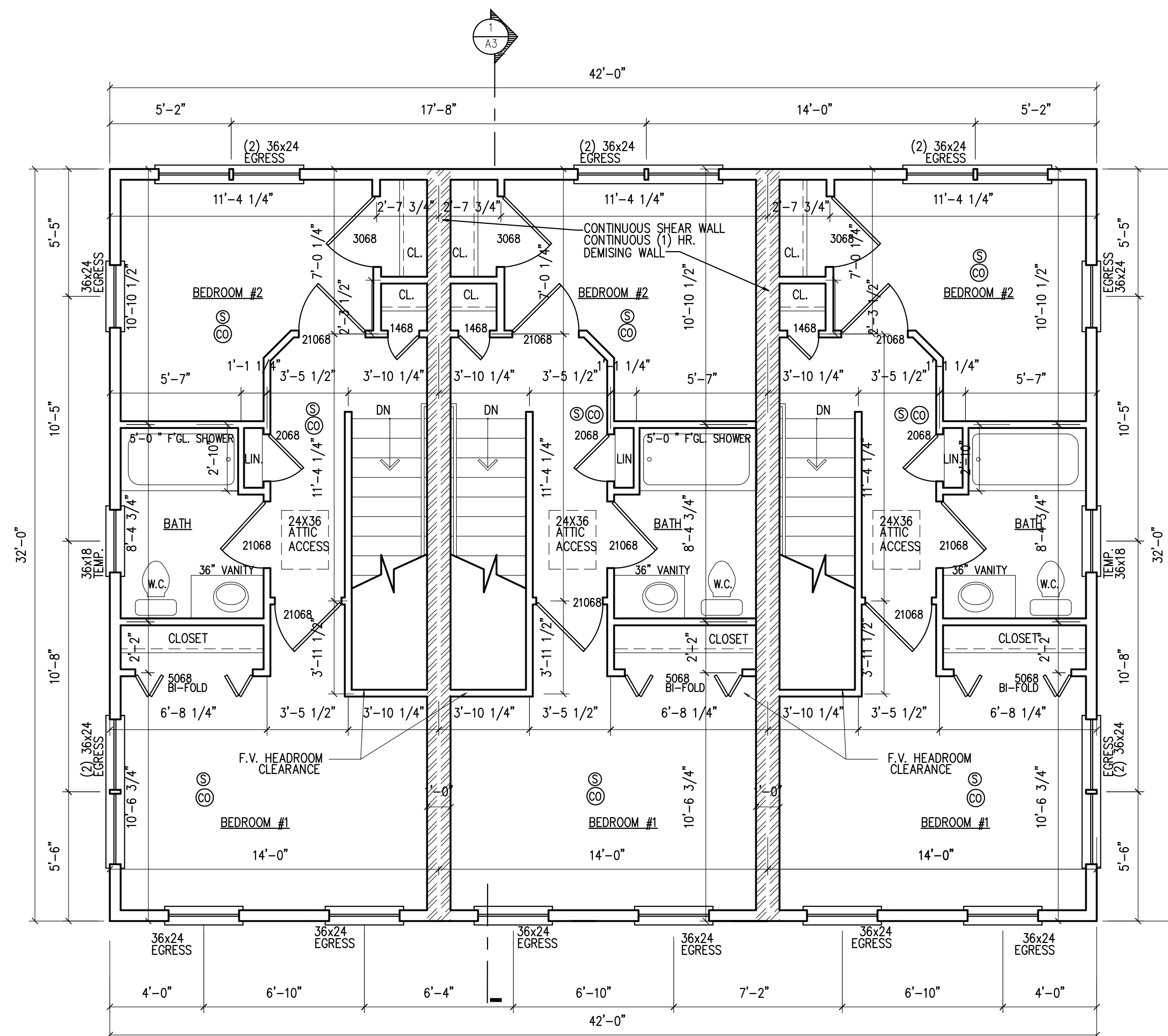

SECOND FLOOR PLAN

SCALE : 1/4" = 1' - 0"



42 x 32 UNIT
PORTLAND, MAINE

FLOORPLANS
NOTES

DATE
01/12/12

A2

DRAWINGS THIS SHEET