

# Safelite®

## AutoGlass

Safelite Repair, Safelite Replace



# 421 Warren Avenue Portland, Maine 04103

**PROJECT LOCATION:** 421 Warren Avenue  
Portland, Maine 04103

**SCOPE:** Remodel of Existing Lease Building

**NUMBER OF FLOORS:** One (1)

**BUILDING HEIGHT:** 21'-0"

**SQUARE FOOTAGE/  
OCCUPANT LOAD**  
Office: 3,230 S.F. (1/100 = 32 Occupants)  
Warehouse: 21,630 S.F. (1/500 = 44 Occupants)  
Service: 1,980 S.F. (1/500 = 4 Occupants)  
Total: 26,840 S.F. Total = 80 Occupants

**ACCESSIBILITY CODE:** 2010 ADA Standards for Accessible Design

**ADOPTED CODES:** MUBEC (Maine Uniform Building and Energy Code)  
2009 International Building Code  
2006 NFPA 1  
NFPA 10  
NFPA 13  
2009 NFPA 101

**OCCUPANCY TYPE:** 2009 International Energy Conservation Code  
NFPA 101-2009 (Business/S) Storage-Low Hazard Separated  
IBC-2009 (Business/S2) Storage-Low Hazard Nonseparated  
NFPA 101-2009 Type II(000) Non Combustible  
IBC-2009 Type 5B Any Type

### Project Information

1. ALL WORK SHALL BE CONDUCTED IN ACCORDANCE WITH ALL NATIONAL, STATE AND LOCAL CODES AND ORDINANCES. THE MORE STRINGENT OF THE BUILDING CODES SHALL APPLY.
  2. ELIMINATING ARCHITECTURAL BARRIERS. SEE THE 2010 VERSION OF "A.D.A." STANDARDS FOR ACCESSIBLE DESIGN.
  3. CONTRACTOR TO ERECT ON SITE, SAFELITE GLASS CORP. SUPPLIED "COMING SOON" SIGN. IF APPLICABLE. LOCATION TO BE DETERMINED BY SAFELITE'S CONSTRUCTION MANAGER. MOUNTING MATERIAL TO BE FURNISHED BY GENERAL CONTRACTOR.
  4. SHALL BE THE DUTY OF THE SUB-CONTRACTORS TO VERIFY ALL DIMENSIONS GIVEN TO THEM BY THE CONSTRUCTION MANAGER BEFORE COMMENCING WORK. IN SUBMITTING A PROPOSAL, IT WILL BE CONSIDERED THAT THE BIDDER HAS EXAMINED AND FAMILIARIZED HIMSELF WITH THE SITE AND HAS CAREFULLY CHECKED ALL THE DETAILS AND ASSURED HIMSELF THAT THEY CONFORM IN EVERY RESPECT WITH ALL APPLICABLE FEDERAL, STATE AND LOCAL REQUIREMENTS. IGNORANCE OR FAILURE ON THE PART OF THE SUB-CONTRACTOR TO EXAMINE OR FAMILIARIZE THEMSELVES WITH THE SITE, WILL NOT BE ACCEPTED AS AN EXCUSE FOR CLAIMS FOR EXTRA OR ADDITIONAL PAYMENT ABOVE THE CONTRACT PRICE.
  5. THE LOCALITY SHALL COMPATIBLE WITH THE APPROPRIATE SUB-CONTRACTOR AND THE LOCALITY SHALL COMPATIBLE WITH THE APPROPRIATE SUB-CONTRACTOR AND
  6. MAKE NO CORRECTIONS OR CHANGES TO THE DRAWINGS OR DOCUMENTS WITHOUT FIRST RECEIVING WRITTEN PERMISSION FROM SAFELITE'S CONSTRUCTION MANAGER.
  7. UNLESS OTHERWISE NOTED, ALL ELECTRICAL CONDUITS, PLUMBING LINES, ETC., SHALL BE RUN CONCEALED.
  8. VERIFY FINAL AMOUNT AND LOCATION OF FIRE EXTINGUISHERS WITH GOVERNING FIRE MARSHAL.
  9. STABILIZE ALL AIR & LIGHT REELS TO STRUCTURE.
  10. PROVIDE H.C. GRAPHS TO RESTROOM DOORS PER "A.D.A."
- ### General Notes

**DESIGN-BUILD GENERAL CONTRACTOR**  
The Sheridan Corporation, Inc.  
33 Sheridan Drive, P.O. Box 359, Fairfield, ME 04937  
(207) 453-9311, www.sheridancorp.com  
Structural Engineer: Dana Surevant, P.E.  
Project Manager: Gilbert Thihaeu

**DESIGN-BUILD MECHANICAL CONTRACTOR**  
W.H. Derrmons, Inc.  
93 Warren Avenue, Portland, ME 04103  
(207) 797-7468, www.wderrmons.com  
Mechanical Engineer: Doug Martin, P.E.

**DESIGN-BUILD ELECTRICAL CONTRACTOR**  
Electrical Systems of Maine, Inc.  
PO Box 1395, 1200 Milnot Avenue, Auburn, ME 04211  
(207) 783-7126, www.electricalsystemsofme.com  
Electrical Engineer: Will Bennett, P.E.  
Bennett Engineering, Inc.  
PO Box 297, Bennett Road, Freeport, ME 04032  
(207) 865-9475, www.bennettheengineering.net

**DESIGN-BUILD FIRE PROTECTION CONTRACTOR**  
Sprinkler Systems, Inc.  
PO Box 1285, Lewiston, ME 04243-1285  
(207) 689-9931, www.sprinklersystemsinc.com  
Fire Protection Designer: Clayton Saucier, NICET Level III #78833

**LESSEE/TENANT**  
Safelite AutoGlass Group  
7400 Safelite Way, Columbus, OH 43235  
Real Estate Manager: John Kraft, (239) 931-9903

**BUILDING OWNER**  
Peter Holmes  
c/o Harbour Auto Body, 402 Warren Avenue, Portland, ME 04103  
(207) 878-2121

### Project Directory

<b>CS</b>	COVER SHEET	M-0	COVER SHEET-MECHANICAL
<b>LSP</b>	LIFE SAFETY PLAN	M-1	DUCT PLAN
<b>C-3.0</b>	SITE LAYOUT & UTILITY PLAN	M-2	GAS PIPING PLAN
<b>A-1.1</b>	FULL FLOOR PLAN (3/32"), NOTES, ENLARGED PARTIAL FLOOR PLAN (1/4")	M-3	EQUIPMENT SCHEDULES & DETAILS
<b>A-1.2</b>	ENLARGED PARTIAL FLOOR PLAN (1/4"), NOTES, SCHEDULES, FINISH NOTES, HARDWARE SETS	M-4	MECHANICAL SPECS, P-1 PLUMBING PLAN
<b>A-2</b>	REFLECTED CEILING PLAN (3/32"), NOTES, ENLARGED PARTIAL FLOOR PLAN (1/4"), ELECTRICAL AND REFLECTED CEILING PLAN NOTES	E-1.0	LIGHTING-POWER FULL FLOOR PLAN
<b>A-3.1</b>	SECTION, DETAILS	E-1.1	ENLARGED LIGHTING PLAN
<b>A-3.2</b>	SECTION, DETAILS	E-2.0	ENLARGED LIGHTING PLAN & DETAILS
<b>A-4</b>	SECTION, DETAILS	E-3.0	FIRE ALARM LAYOUT & DETAILS
<b>A-5</b>	EXTERIOR ELEVATIONS	E-3.1	FIRE ALARM LAYOUT & RISER DIAGRAM
<b>A-6</b>	MILKWORK ELEVATIONS, INTERIOR ELEVATIONS	E-4.0	LEGEND, NOTES & ABBREVIATIONS
<b>A-7</b>	2010 ADA (STANDARDS FOR ACCESSIBLE DESIGN) FOUNDATION PLAN	E-4.1	PANEL SCHEDULES & ONE LINE DIAGRAM
<b>F-01</b>	FOUND. SECTIONS & DETAILS		
<b>F-02</b>	FOUND. SECTIONS & DETAILS		
<b>F-03</b>	FOUND. SECTIONS & DETAILS		
<b>F-04</b>	FOUND. SAW CUT PLAN		

### Sheet Index

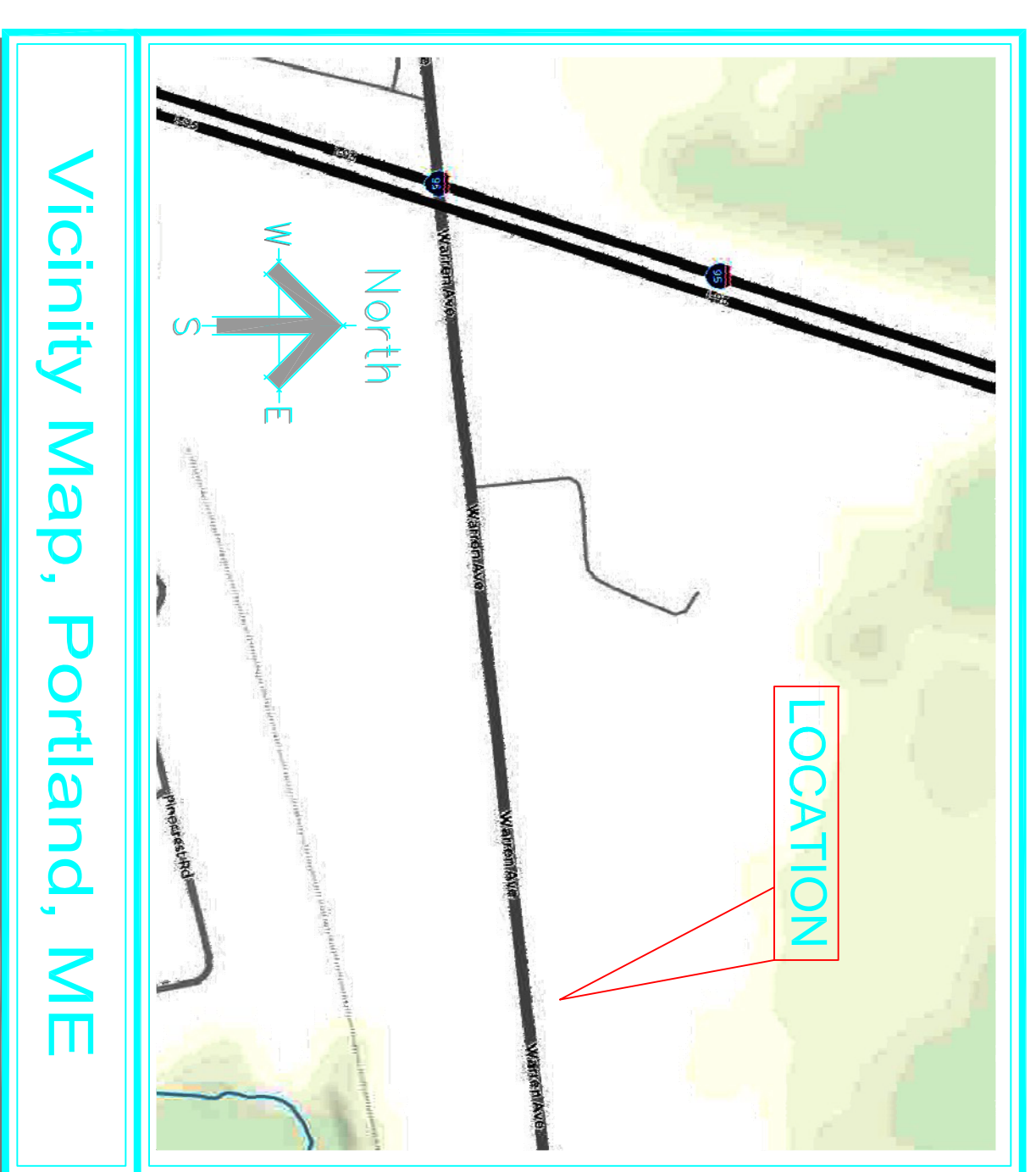

DATE	REVISION	DRAWING STATUS	EST. NO	ENGINEERING DESIGNS FOR	JOB NO.	ENGINEERING
3/21/16	City Change (Setback)			ENGINEERING DESIGNS FOR	16-1003	
4/22/16	Shepherd site block added & Information added			Safelite Auto Glass		
5/4/16	Information added			421 Warren Avenue		
6/15/16	Occupancy type changed			Portland, Maine		
6/17/16	Code designations changed			Cover Sheet		

**DISCLAIMER:**  
Drawings A-0.0, A-1.1, A-1.2, A-2.0, A-3.1, A-3.2, A-4.0, A-5.0, A-6.0, A-7.0 were drawn by Safelite AutoGlass. The original date of these drawings (Rev.) is 03/29/16. The Sheridan Corporation replaced Safelite's title with theirs and all revisions since Rev. 1 are by Sheridan's designers. All revisions/changes by Sheridan are noted in the applicable drawing(s) revision block.

**ENGINEERING DESIGNS FOR**  
Safelite Auto Glass  
421 Warren Avenue  
Portland, Maine

**JOB NO.** 16-1003  
**ENGINEERING** DWG. NO. CS

**DESIGN BUILDER**

MAINTAIN THE INTEGRITY OF THE PROFESSION AND UPHOLD THE HIGHEST STANDARDS OF ETHICS AND CONDUCT. THE PROFESSIONAL SEAL OF THE ENGINEER IS THE PROPERTY OF THE ENGINEER AND SHALL BE USED ONLY BY THE ENGINEER. THE SEAL SHALL BE USED ONLY IN CONNECTION WITH THE PROFESSIONAL SERVICES OF THE ENGINEER.

**STATE OF MAINE**  
DANA C. SHERIDAN  
No. 5107  
REGISTERED PROFESSIONAL ENGINEER

06-17-2016

**Sheridan**  
FAIRFIELD  
PORTLAND  
MAINE  
www.sheridancorp.com