



BISKUP CONSTRUCTION, INC.
 14 DANIELLE DRIVE
 WINDHAM, MAINE 04062
 TEL. (207) 892-1800
 FAX. (207) 892-9895

WWW.BISKUPCONSTRUCTION.COM

CONSULTANT
 ASSOCIATED DESIGN
 PARTNERS INC.
 81 Linden Road
 Portland, Maine 04105
 TEL. (207) 878-1700
 FAX. (207) 878-1700
 E-MAIL: adp@adpartners.com

STAMP

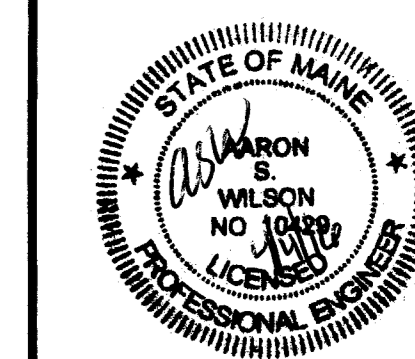

PROJECT:
 PROPOSED BUILDING
 ACADEMY FOR ACTIVE LEARNERS
 134 WARREN AVENUE
 PORTLAND, MAINE

REVISIONS	
DATE	DESCRIPTION

DATE: 4/1/2016
 SCALE: 1/8" = 1'-0"
 DESIGNER: AW
 CHECKED BY: JB

© COPYRIGHT
 BISKUP CONSTRUCTION, INC.

SHEET TITLE
**FOUNDATION
 PLAN**

SHEET NUMBER
S-1
 SHEET 1 OF 2

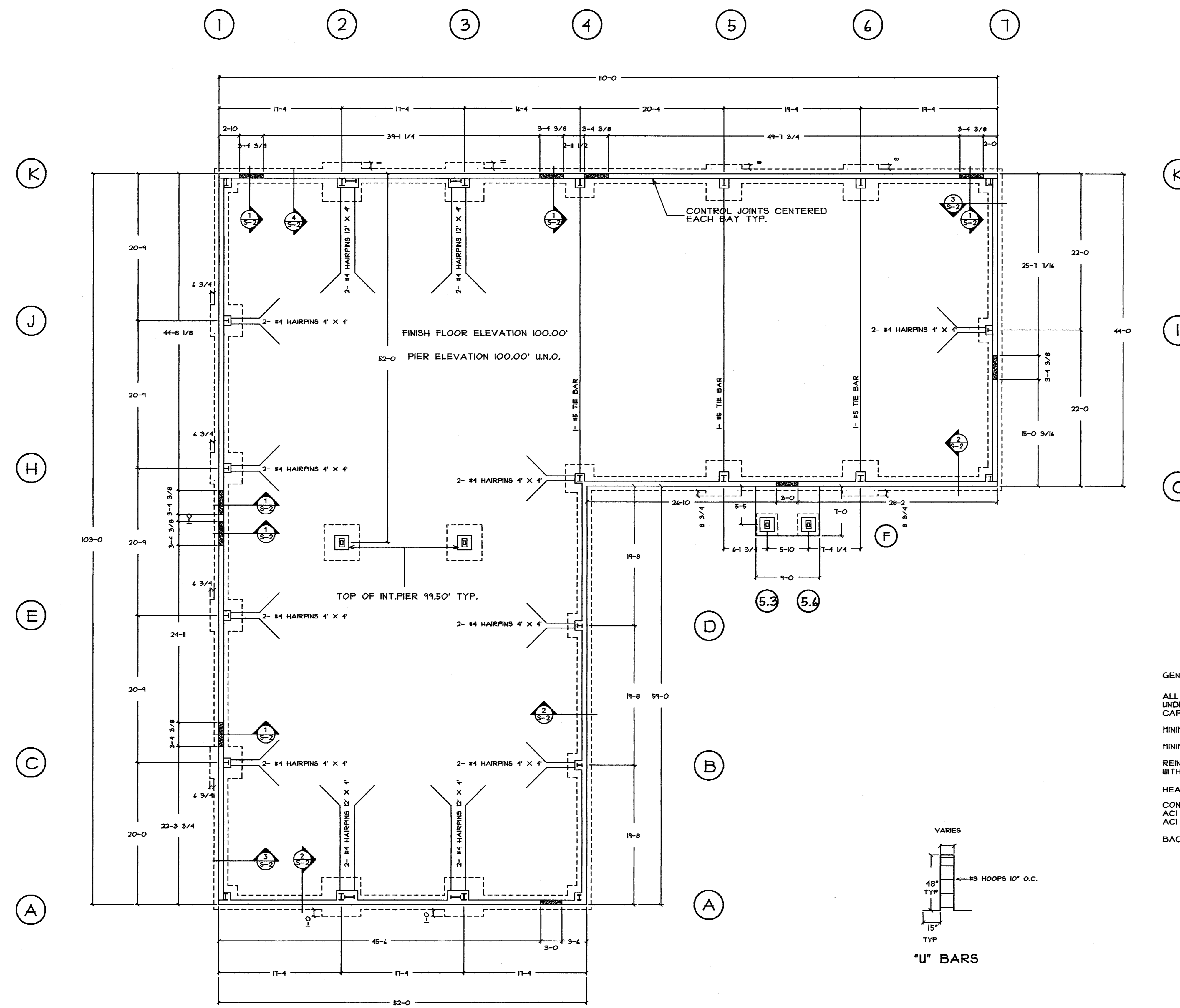

GENERAL NOTES:
 ALL FOOTINGS TO BEAR ON 12" OF 3/4" STONE ATOP UNDISTURBED SOIL, WITH MIN. ALLOWABLE NET BEARING CAPACITY OF 3,000 PSF, PER THE GEO-TECH REPORT.
 MINIMUM COMPRESSIVE STRENGTH OF CONCRETE, 28 DAYS = 3,000 PSI.
 MINIMUM YIELD STRENGTH OF REINF. STEEL = 60,000 PSI.
 REINF. STEEL SHALL BE FABRICATED AND INSTALLED IN ACCORDANCE WITH THE CRSI MANUAL OF STANDARD PRACTICE, LATEST EDITION.
 HEADED ANCHOR BOLTS TO BE A 307
 CONCRETE WORKMANSHIP SHALL CONFORM TO THE REQUIREMENTS OF ACI 318 AND SPECIFICATIONS FOR STRUCTURAL CONCRETE FOR BUILDINGS ACI 301, LATEST EDITION.
 BACKFILL BOTH SIDES OF ALL WALLS SIMULTANEOUSLY

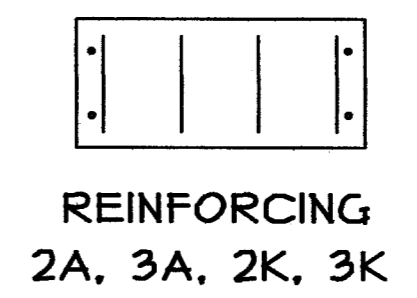
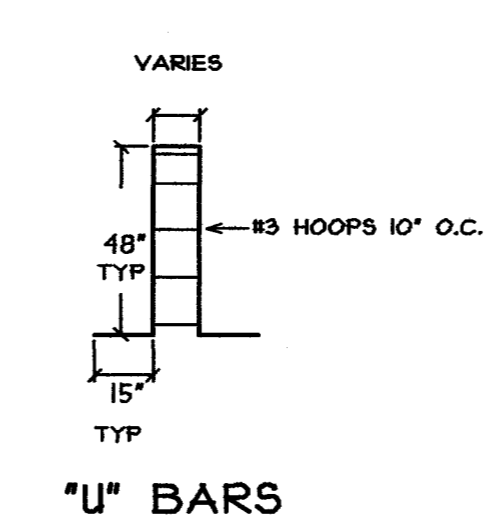

LOCATION	FOOTING SIZE	FOOTING REBAR	PIER SIZE	PIER REBAR	ANCHOR BOLTS
1A, 4A, 7G, 7K	3'-4" X 3'-4" X 1'-0"	4 #5 E.W. BOTT.	12" X 12"	2 #5 "U" BARS, 15" X 48" X 10"	3/4" X 18"
1K	3'-4" X 3'-4" X 1'-0"	4 #5 E.W. BOTT.	12" X 16"	2 #5 "U" BARS, 15" X 48" X 12"	3/4" X 18"
1C, 1E, 1H, 1J	4'-6" X 4'-6" X 1'-0"	4 #5 E.W. BOTT.	16" X 12"	2 #5 "U" BARS, 15" X 48" X 10"	3/4" X 18"
2A, 3A	5'-6" X 5'-6" X 1'-0"	4 #5 E.W. BOTT.	36" X 16"	4 #5 "U" BARS, 15" X 48" X 12" PLUS 4 #5 VERT.	3/4" X 18"
4B, 4D, 7I	3'-4" X 3'-4" X 1'-0"	4 #5 E.W. BOTT.	16" X 12"	2 #5 "U" BARS, 15" X 48" X 10"	3/4" X 18"
4G, 4K	4'-0" X 4'-0" X 1'-0"	5 #5 E.W. BOTT.	16" X 16"	4 #5 "U" BARS, 15" X 48" X 12"	3/4" X 18"
5G, 6G, 5K, 6K	5'-0" X 5'-0" X 1'-0"	5 #5 E.W. BOTT.	16" X 16"	4 #5 "U" BARS, 15" X 48" X 12"	3/4" X 18"
2K, 3K	5'-6" X 5'-6" X 1'-0"	4 #5 E.W. BOTT.	36" X 16"	4 #5 "U" BARS, 15" X 48" X 12"	3/4" X 18"
2 * 52', 3 * 52'	6'-0" X 6'-0" X 1'-0"	4 #5 E.W. BOTT.	24" X 24"	4 #5 "U" BARS, 15" X 48" X 16"	3/4" X 18"
5.3F, 5.4F	3'-0" X 3'-0" X 1'-0"	4 #5 E.W. BOTT.	24" X 24"	4 #5 "U" BARS, 15" X 48" X 16"	3/4" X 18"