

295 C 001

104 Avalon Rd., Portland, ME

A4.002. Second Floor Plan

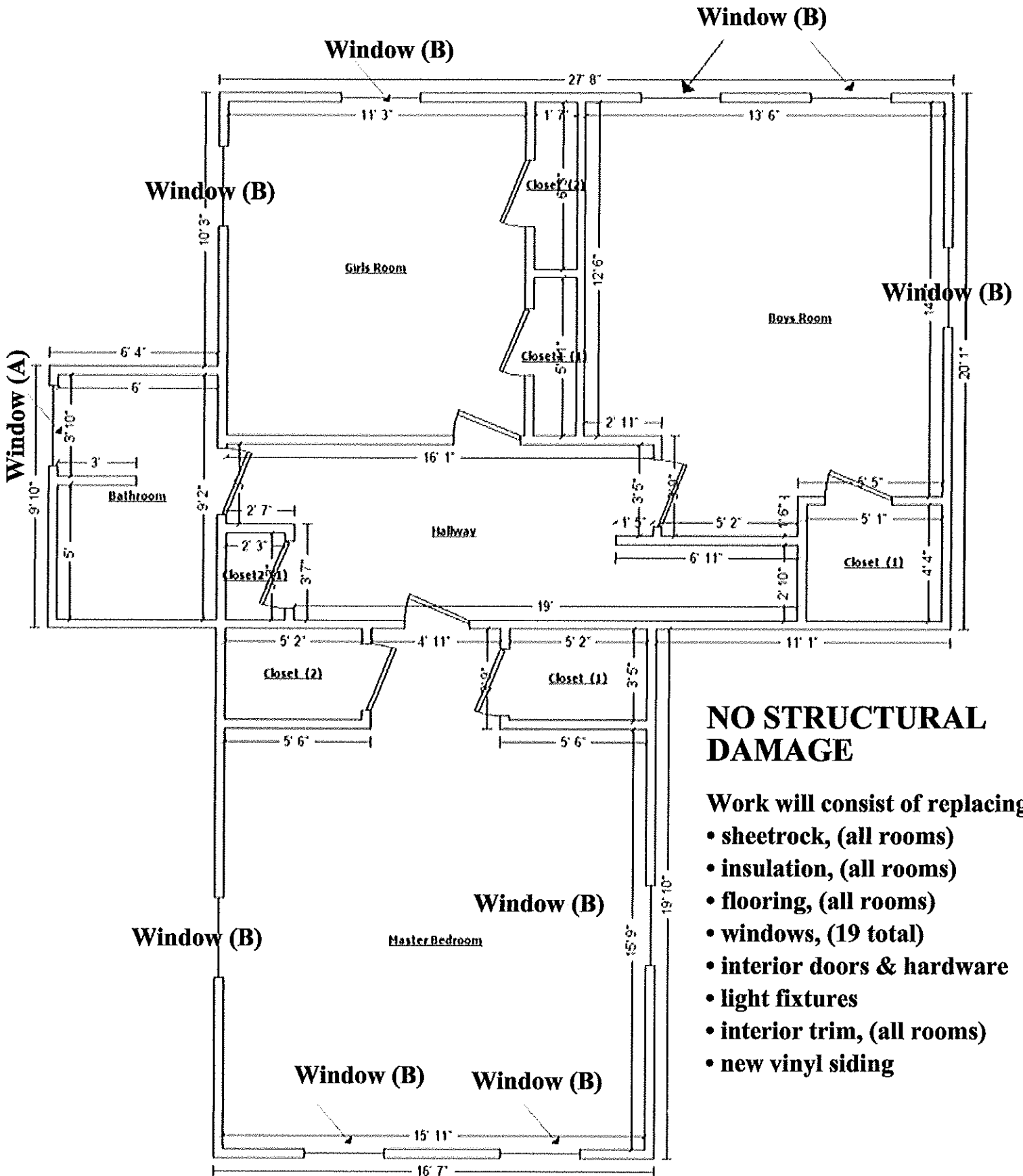

## NO STRUCTURAL DAMAGE

Work will consist of replacing:

- sheetrock, (all rooms)
- insulation, (all rooms)
- flooring, (all rooms)
- windows, (19 total)
- interior doors & hardware
- light fixtures
- interior trim, (all rooms)
- new vinyl siding