

DISPLAY THIS CARD ON PRINCIPAL FRONTAGE OF WORK



CITY OF PORTLAND

BUILDING PERMIT

This is to certify that Poulin Proerty Holdings, LLC

Located At 171 WARREN AVE

Job ID: 2011-09-2149-SIGN

CBL: 295 - - B - 001 - 001 - - - - -

has permission to install a 4'4" x 6' freestanding sign

provided that the person or persons, firm or corporation accepting this permit shall comply with all of the provisions of the Statues of Maine and of the Ordinances of the City of Portland regulating the construction, maintenance and use of the buildings and structures, and of the application on file in the department.

Notification of inspection and written permission procured before this building or part thereof is lathed or otherwise closed-in. 48 HOUR NOTICE IS REQUIRED.

A final inspection must be completed by owner before this building or part thereof is occupied. If a certificate of occupancy is required, it must be

N/A

[Signature] 9/2/11

Fire Prevention Officer

Code Enforcement Officer / Plan Reviewer

**THIS CARD MUST BE POSTED ON THE STREET SIDE OF THE PROPERTY
PENALTY FOR REMOVING THIS CARD**

BUILDING PERMIT INSPECTION PROCEDURES

Please call 874-8703 or 874-8693 (ONLY)

or email: buildinginspections@portlandmaine.gov

With the issuance of this permit, the owner, builder or their designee is required to provide adequate notice to the city of Portland Inspections Services for the following inspections. Appointments must be requested 48 to 72 hours in advance of the required inspection. The inspection date will need to be confirmed by this office.

- **Please read the conditions of approval that is attached to this permit!! Contact this office if you have any questions.**
- **Permits expire in 6 months. If the project is not started or ceases for 6 months.**
- **If the inspection requirements are not followed as stated below additional fees may be incurred due to the issuance of a "Stop Work Order" and subsequent release to continue.**

1. Call for final inspection when installation is complete.

The project cannot move to the next phase prior to the required inspection and approval to continue, REGARDLESS OF THE NOTICE OF CIRCUMSTANCES.

IF THE PERMIT REQUIRES A CERTIFICATE OF OCCUPANCY, IT MUST BE PAID FOR AND ISSUED TO THE OWNER OR DESIGNEE BEFORE THE SPACE MAY BE OCCUPIED.



PORTLAND MAINE

Strengthening a Remarkable City, Building a Community for Life • www.portlandmaine.gov

Director of Planning and Urban Development
Penny St. Louis

Job ID: 2011-09-2149-SIGN

Located At: 171 WARREN AVE

CBL: 295 - - B - 001 - 001 - - - -

Conditions of Approval:

Building

Signage Installation to comply with Chapters 31 & 32 of the IBC 2009 building code.

City of Portland, Maine - Building or Use Permit Application

389 Congress Street, 04101 Tel: (207) 874-8703, FAX: (207) 8716

Job No: 2011-09-2149-SIGN	Date Applied: 8/31/2011	CBL: 295 - - B - 001 - 001 - - - - -	
Location of Construction: 171 WARREN AVE	Owner Name: Poulin Property Holdings, LLC	Owner Address: 171 Warren Ave PORTLAND, ME 04103	Phone: 207-773-1040
Business Name:	Contractor Name: Deanna -Bailey Signs	Contractor Address: 9 Thomas Dr., Westbrook, ME 04092	Phone: 207-774-2843
Lessee/Buyer's Name:	Phone:	Permit Type: SIGN - PERM - Signage - Permanent	Zone: B-4
Past Use: Professional Offices	Proposed Use: Same - Professional Offices -- erect 4'4" x 6' freestanding sign	Cost of Work:	CEO District:
		Fire Dept: <input type="checkbox"/> Approved <input type="checkbox"/> Denied <input checked="" type="checkbox"/> N/A Signature: <i>ABM</i>	Inspection: Use Group: Type: <i>Sign</i> Signature: <i>ABM</i>
Proposed Project Description: 4'4" x 6' free standing sign		Pedestrian Activities District (P.A.D.)	

Permit Taken By:	Zoning Approval		
<p>1. This permit application does not preclude the Applicant(s) from meeting applicable State and Federal Rules.</p> <p>2. Building Permits do not include plumbing, septic or electrical work.</p> <p>3. Building permits are void if work is not started within six (6) months of the date of issuance. False informatin may invalidate a building permit and stop all work.</p>	Special Zone or Reviews <input type="checkbox"/> Shoreland <input type="checkbox"/> Wetlands <input type="checkbox"/> Flood Zone <input type="checkbox"/> Subdivision <input type="checkbox"/> Site Plan <input type="checkbox"/> Maj <input type="checkbox"/> Min <input type="checkbox"/> MM Date: <i>08 31/11 ABM</i>	Zoning Appeal <input type="checkbox"/> Variance <input type="checkbox"/> Miscellaneous <input type="checkbox"/> Conditional Use <input type="checkbox"/> Interpretation <input type="checkbox"/> Approved <input type="checkbox"/> Denied Date:	Historic Preservation <input checked="" type="checkbox"/> Not in Dist or Landmark <input type="checkbox"/> Does not Require Review <input type="checkbox"/> Requires Review <input type="checkbox"/> Approved <input type="checkbox"/> Approved w/Conditions <input type="checkbox"/> Denied Date: <i>ABM</i>
	CERTIFICATION		

I hereby certify that I am the owner of record of the named property, or that the proposed work is authorized by the owner of record and that I have been authorized by the owner to make this application as his authorized agent and I agree to conform to all applicable laws of this jurisdiction. In addition, if a permit for work described in the application is issued, I certify that the code official's authorized representative shall have the authority to enter all areas covered by such permit at any reasonable hour to enforce the provision of the code(s) applicable to such permit.

SIGNATURE OF APPLICANT ADDRESS DATE PHONE

RESPONSIBLE PERSON IN CHARGE OF WORK, TITLE DATE PHONE

2011 09 2149



Signage/Awning Permit Application

If you or the property owner owes real estate or personal property taxes or user charges on any property within the City, payment arrangements must be made before permits of any kind are accepted.

Location/Address of Construction: <u>171 Warren Ave</u>		
Tax Assessor's Chart, Block & Lot Chart# <u>295</u> Block# <u>B</u> Lot# <u>001</u>	Owner: <u>Powlin Property Holdings, LLC</u> <u>Powlin Financial Services, LLC</u> <u>Marc Powlin</u>	Telephone: <u>(207) 773-1040</u>
Lessee/Buyer's Name (If Applicable)	Contractor name, address & telephone: <u>Bailey Sign, Inc</u> <u>9 Thomas Dr.</u> <u>Westbrook, ME 04092</u>	Total s.f. of signage x \$2.00 Per sq. plus \$30.00/\$65.00 For H.D. signage= Total Fee: \$ <u>82</u> Awning Fee= cost of work Total Fee: \$
Who should we contact when the permit is ready: <u>Deanna@bailey</u> phone: <u>774-2813 x115</u> <u>Sign</u>		
Tenant/allocated building space frontage (feet): Length: _____ Height: _____ Lot Frontage (feet) <u>150'</u> Single Tenant or Multi Tenant Lot <u>Multi</u>		
Current Specific use: <u>Professional Offices</u> If vacant, what was prior use: _____ Proposed Use: <u>same</u>		
Information on proposed sign(s): Freestanding (e.g., pole) sign? Yes <input checked="" type="checkbox"/> No <input type="checkbox"/> Dimensions proposed: <u>44"x6'</u> Height from grade: <u>11'</u> Bldg. wall sign? (attached to bldg) Yes <input type="checkbox"/> No <input checked="" type="checkbox"/> Dimensions proposed: _____		
Proposed awning? Yes <input type="checkbox"/> No <input checked="" type="checkbox"/> Is awning backlit? Yes <input type="checkbox"/> No <input type="checkbox"/> Height of awning: _____ Length of awning: _____ Depth: _____ Is there any communication, message, trademark or symbol on awning? Yes <input type="checkbox"/> No <input type="checkbox"/> If yes, total s.f. of panels w/communications, message, trademark or symbol: _____		
Information on existing and previously permitted sign(s): Freestanding (e.g., pole) sign? Yes <input type="checkbox"/> No <input checked="" type="checkbox"/> Dimensions: _____ Bldg. wall sign? (attached to bldg) Yes <input type="checkbox"/> No <input type="checkbox"/> Dimensions: _____ Awning? Yes <input type="checkbox"/> No <input type="checkbox"/> Sq. ft. area of awning w/communication: _____		
A site sketch and building sketch showing exactly where existing and new signage is located must be provided. Sketches and/or pictures of proposed signage and existing building are also required.		

50" x 70" = 26 sq ft

RECEIVED

AUG 31 2011

Dept. of Building Inspections
City of Portland Maine

Please submit all of the information outlined in the Sign/Awning Application Checklist. Failure to do so may result in the automatic denial of your permit.

In order to be sure the City fully understands the full scope of the project, the Planning and Development Department may request additional information prior to the issuance of a permit. For further information visit us on-line at www.portlandmaine.gov, stop by the Building Inspections office, room 315 City Hall or call 874-8703.

I hereby certify that I am the Owner of record of the named property, or that the owner of record authorizes the proposed work and that I have been authorized by the owner to make this application as his/her authorized agent. I agree to conform to all applicable laws of this jurisdiction. In addition, if a permit for work described in this application is issued, I certify that the Code Official's authorized representative shall have the authority to enter all areas covered by this permit at any reasonable hour to enforce the provisions of the codes applicable to this permit.

Signature of applicant: Deanna Emery/Bailey Sign Date: 8-19-11

This is not a permit; you may not commence ANY work until the permit is issued.

B-4 mult-tenant

1-2 faces 10' x 4' x 6' = 26 sq ft
max height 25' - 11 sign
set back 15' sign



Signage/Awning Permit Application Checklist

All of the following information is required and must be submitted. Checking off each item as you prepare your application package will ensure your package is complete and will help to expedite the permitting process.

- Certificate of Liability listing the City as additional insured if any portion of the sign abuts or encroaches on any public right of way, or can fall into any public right of way.
- Letter of permission from the owner indicating the permissions granted and the tenant/space building frontage.
- A sketch plan of lot indicating location of buildings, driveways and any abutting streets or rights of way, lengths of building frontages, street frontages and all existing setbacks. Please indicate on the plan all existing and proposed signs with their dimensions and specific locations. Be sure to include distance from the ground and building façade dimensions for any signage attached to the building.
- A sketch or photo of any proposed sign(s) indicating content, dimensions, materials, source of illumination, construction method as well as specifics of installation/attachment.
- Certificate of flammability required for awning or canopy.
- A UL# is required for lighted signs at the time of final inspection.
- Pre-application questionnaire completed and attached.
- Photos of existing signage
- Details for sign fastening, attachment or mounung in the ground. *6" Steel poles direct set into concrete*

Permit fee for signage or awning-with-signage: \$30.00 plus \$2.00 per square foot of sign.

Permit fee for awning-without-signage is based on cost of work:
\$30.00 for the first \$1,000.00, \$10.00 per additional \$1,000.00 of cost.

Base application fee for any Historic District signage is \$65.00.

WRITTEN CONSENT AND AGREEMENT relating to a certain sign(s) proposed to be erected at/on a

building located at 171 Warren Avenue in Portland, Maine.
(Street Address) (City & State)

Poulin Property Holdings LLC being the owner of the premises hereby
(Property Owner)

gives consent to the erection of a certain sign(s) by Bailey Sign, Inc. of Westbrook, ME.

In witness whereof, the owner of said premises has signed this consent and agreement this

25th day of August, 2011.
(Day) (Month) (Year)

(Property Owner) 
(Witness)

Marc M. Poulin, Sole Member Lori L. Aliberti
print print



CITY OF PORTLAND, MAINE

Department of Building Inspections

Original Receipt

Aug 31 2011

Received from Bentley Sign

Location of Work 17th Street

Cost of Construction \$ _____ Building Fee: _____

Permit Fee \$ _____ Site Fee: _____

Certificate of Occupancy Fee: _____

Total: _____

Building (IL) Plumbing (IS) _____ Electrical (I2) _____ Site Plan (U2) _____

Other Sign

CBL: 995 P 001

Check #: 97590 Total Collected \$ 75.00

**No work is to be started until permit issued.
Please keep original receipt for your records.**

Taken by: [Signature]

WHITE - Applicant's Copy
YELLOW - Office Copy
PINK - Permit Copy

CONCEPT DRAWING FREE STANDING SIGN (1) D.F. 4'-0" X 6'-1" X 14" INTERNALLY ILLUMINATED SIGN

ROOF, 4'-4" X 6'-1" X 14" CABINET & 2 1/4" RETAINER: PAINT MATTHEWS TO MATCH PMS #425 GREY

6" SQ. POLES & TRIMWORK: WHITE

FACES: WHITE LEXAN

OPAQUE GREY VINYL TO MATCH ROOF AND CABINET

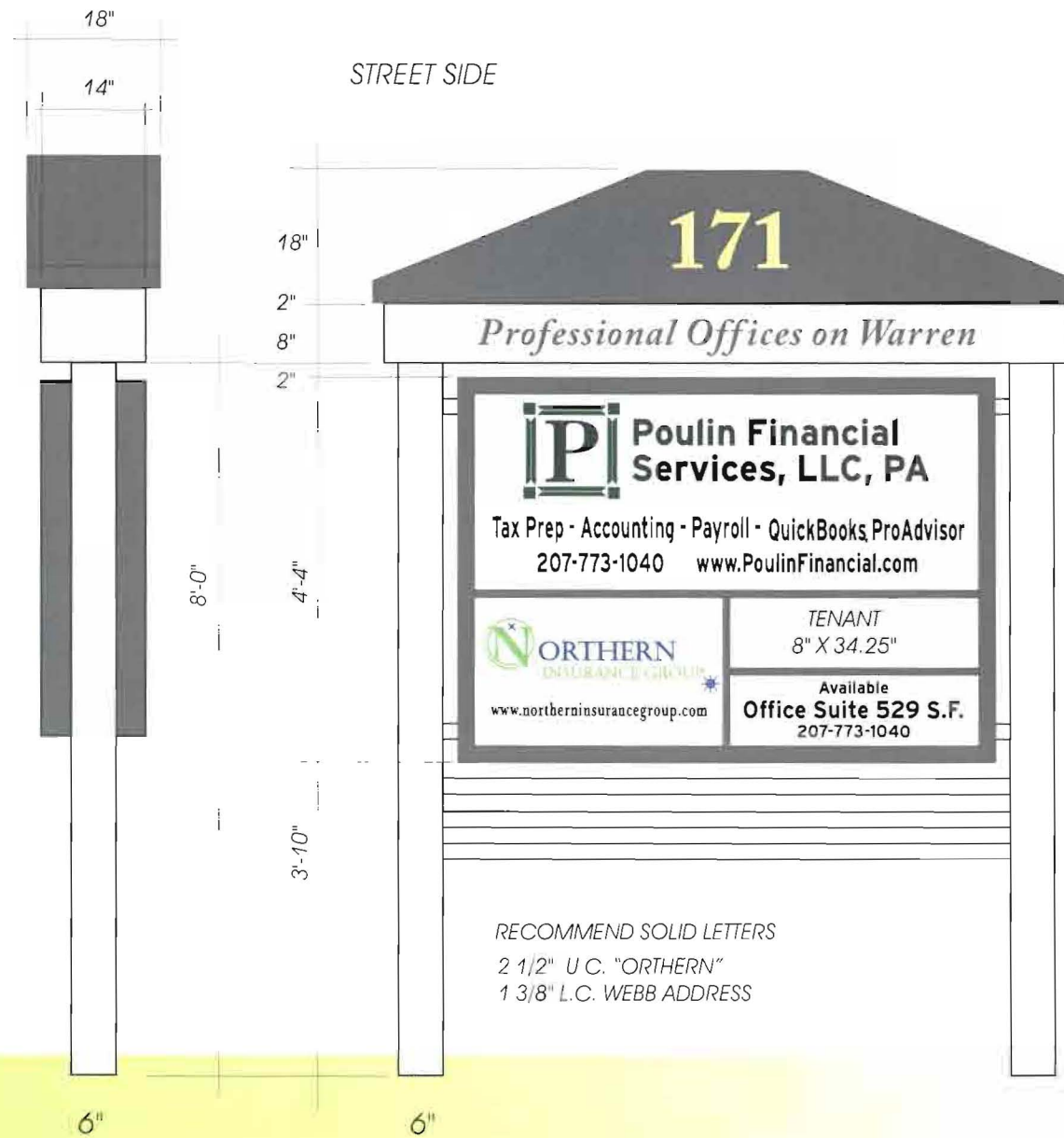
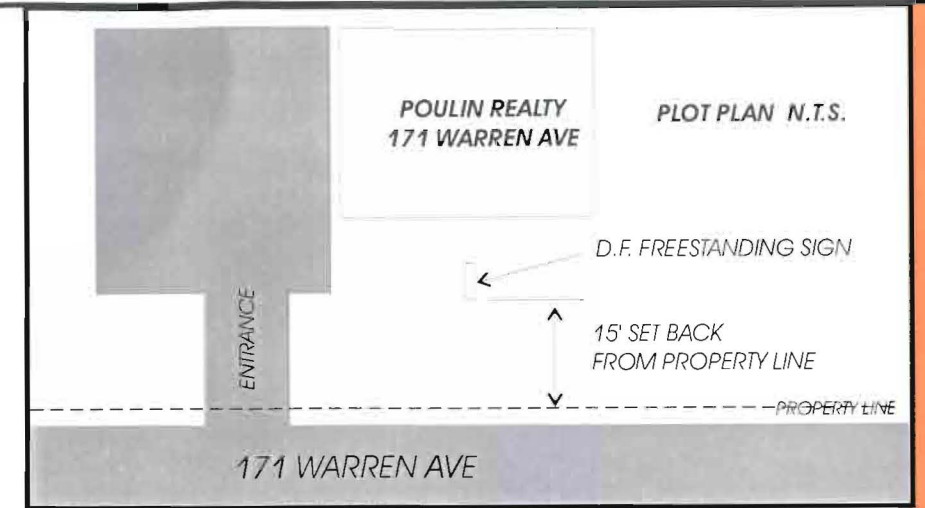

8" NUMERALS
OPAQUE GOLD METALLIC VINYL

3 1/2" VINYL LETTERS
GREY PMS #425

12.93" X 55"
BSI DIGITIZED ART

3" U.C.

1" VINYL DIVIDERS
GREY PMS #425

 PMS #530 (BSI MATCH)
BEST MATCH ARLON TRANS. GREEN VINYL

 BLACK
BEST MATCH ARLON TRANS. BLACK VINYL

LOW RESOLUTION ART RECEIVED FROM CUSTOMER SHOWN HERE
VECTOR ART AND COLOR SPECS ARE NEEDED FOR PRODUCTION

 CMYK 100/95/5/0
BEST MATCH ARLON TRANS. ROYAL BLUE VINYL

 CMYK 60/5/95/0
BEST MATCH ARLON TRANS BRILLIANT GREEN VINYL

RECOMMEND SOLID LETTERS
2 1/2" U.C. "ORTHERN"
1 3/8" L.C. WEBB ADDRESS

PLEASE NOTE:

THIS IS A PROGRESS PRINT - FIELD MEASUREMENTS MAY OR MAY NOT NEED TO BE VERIFIED.

THIS DESIGN IS THE EXCLUSIVE PROPERTY OF BAILEY SIGN INCORPORATED AND ALL RIGHTS TO ITS USE OR REPRODUCTION ARE RESERVED.

THE ACCURACY OF THIS COLOR RENDERING IS LIMITED BY MEDIA AND OUTPUT DEVICES AND IS INTENDED FOR REPRESENTATIONAL USE ONLY. ACTUAL MANUFACTURING/GRAPHIC COLORS ALSO VARY DEPENDING ON PROCESSES & MATERIALS USED. 100% COLOR MATCHES FOR SUBMITTED SPECIFICATIONS CAN NOT BE GUARANTEED.

IF AN ELECTRIC SIGN THEN INSTALLATION MUST BE ACCOMPLISHED IN TOTAL COMPLIANCE WITH ARTICLE 600 OF THE NATIONAL ELECTRIC CODE THE REQUIREMENTS OF UNDERWRITERS LABORATORY CANADIAN STANDARDS ASSOCIATION AND/OR ANY APPLICABLE LOCAL CODES THIS INCLUDES PROPER GROUNDING AND BONDING OF THE SIGN.

ALL ELECTRICAL SIGNS REQUIRE ROUTINE MAINTENANCE.

CLIENT

ACCEPTANCE SIGNATURE _____ DATE _____

BAILEY SIGN SALES REPRESENTATIVE

APPROVED _____ DATE _____



www.baileysign.com
9 Thomas Drive
Westbrook Executive Park
Westbrook, ME 04092
207-774-2843 / 1-800-539-SIGN
Fax: 774-1193
E-Mail: sales@baileysign.com

CUSTOMER / SIGN LOCATION

POULIN FINANCIAL SERVICES, LLC, PA

171 WARREN AVENUE
PORTLAND, MAINE

SALESPERSON: BB DRAWN BY: LWM

PS # D-916 WO #

SCALE 1/2"=1' DATE 7/1/11

REVISION # | DATE | NOTES | INITIALS

- R1 7/25/11 REVISE CAB. HT. & LAYOUT
- R2 7/27/11 LOGO.JPEG
- R3 8/10/11 TENANT COPY & AREA
- R4 8/10/11 NEW VECTOR ART AND BSI COLOR SPECS
- R5 8/17/11 ADD PLOT

DRAWING #

06644 R5



PERMIT DRAWING