

| | | | | | |
|-----|----------|------|----|----|------|
| NO. | REVISION | DATE | BY | CK | P.E. |
| | | | | | |
| | | | | | |
| | | | | | |

ENGINEERING CONSULTANT - LOGO - ADDRESS
 SCC ENGINEERING, LLC
 500 MARKET STREET
 HALLOWELL, ME 04347

THIS DRAWING SHALL BE REVISED ON THE CADD SYSTEM ONLY

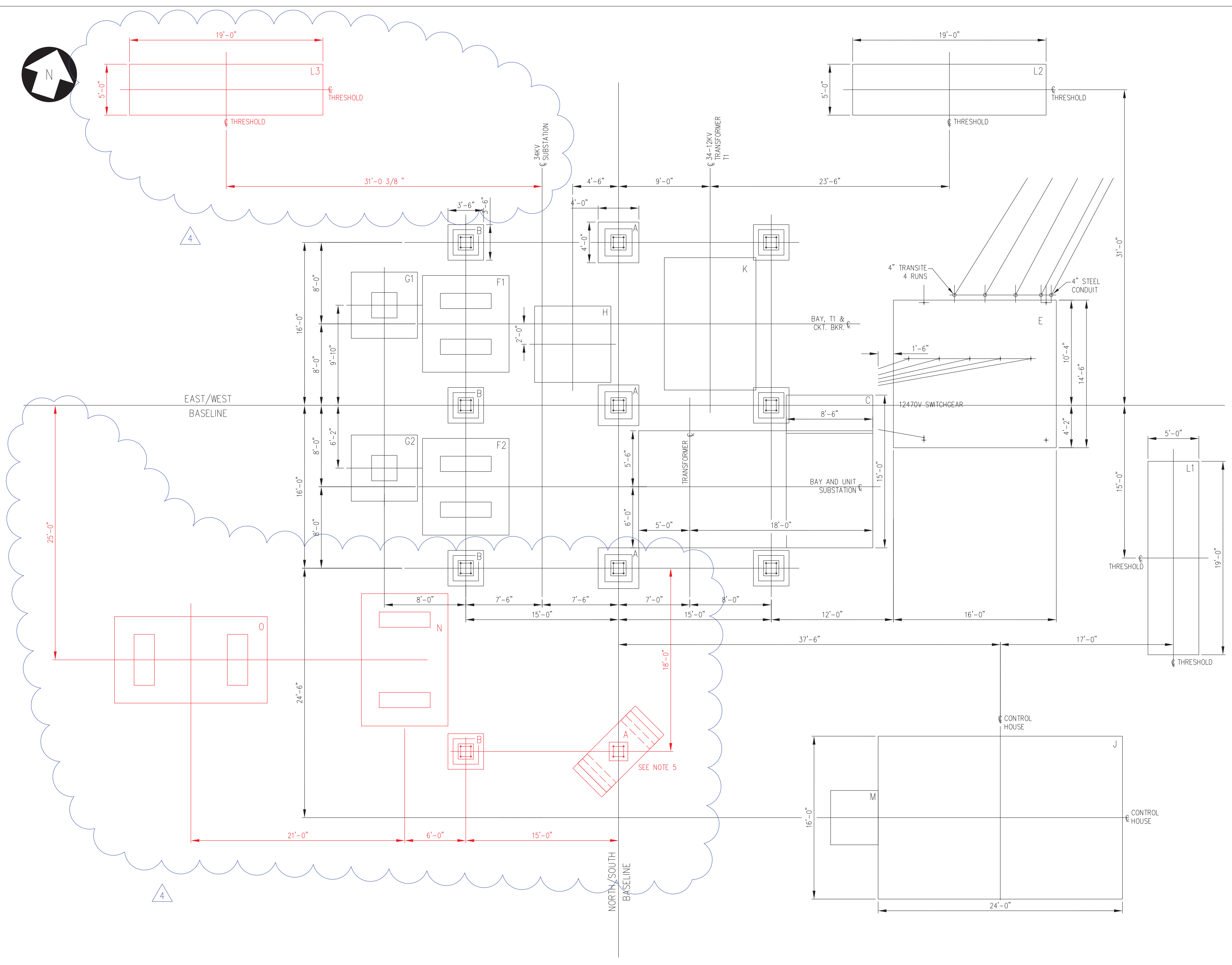

| MARK | REQ'D | FOUNDATION FOR | DWG. NO. | ELEV. | CONCRETE | |
|------|-------|--------------------|----------------|-------|-----------|-------|
| | | | | | EACH | TOTAL |
| A | 3 | 33KV BUS STRUCTURE | 25-80, FIG. 1 | | 37 | 111 |
| B | 6 | 33KV BUS STRUCTURE | 25-80, FIG. 2 | | 29 | 174 |
| C | 1 | UNIT SUBSTATION | 520-42, FIG. 1 | | | 408 |
| E | 1 | 12470V SWITCHGEAR | 520-40 | | 5.4 CU YD | |

| MARK | REQ'D | FOUNDATION FOR | DWG. NO. | ELEV. | CONC./CU. YD'S. | |
|------|-------|---------------------|----------|--------|-----------------|--------|
| | | | | | EACH | TOTAL |
| F | 2 | 72.5KV CKT. BREAKER | 520-3-2 | NOTE 1 | 6.1 | 12.2 |
| G | 2 | 34.5KV VT STAND | 520-3-3 | NOTE 1 | 3 | 6 |
| H | 1 | TRANSRUPTER | 520-3-4 | NOTE 1 | 3.2 | 3.2 |
| J | 1 | CONTROL HOUSE | 520-4-1 | NOTE 3 | 24 | 24 |
| K | 1 | TRANSFORMER T1 | 520-3-5 | NOTE 1 | 6.5 | 6.5 |
| L | 2 | GATE THRESHOLD | 520-6-7 | NOTE 2 | 2.7 | 5.4 |
| M | 1 | CABLE VAULT | 520-6-3 | NOTE 2 | NOTE 4 | NOTE 4 |

| MARK | REQ'D | FOUNDATION FOR | DWG. NO. | ELEV. | CONC./CU. YD'S. | |
|------|-------|-------------------------|-----------|--------|-----------------|-------|
| | | | | | EACH | TOTAL |
| A | 1 | 33KV BUS STRUCTURE | 520-03-17 | NOTE 6 | 2.25 | 2.25 |
| B | 1 | 33KV BUS STRUCTURE | 520-03-18 | NOTE 6 | 29 | 29 |
| L | 1 | GATE THRESHOLD | 520-6-7 | NOTE 2 | 2.7 | 2.7 |
| N | 1 | 34.5KV GAS CKT. BREAKER | 520-3-15 | NOTE 1 | 8.0 | 8.0 |
| O | 1 | 5.4MVAR CAP BANK | 520-3-16 | NOTE 1 | 10.2 | 10.2 |

- NOTES:
- INSTALL FOUNDATIONS 6" ABOVE FINISH GRADE.
 - REFER TO FOUNDATION DETAIL DRAWING FOR INSTALLATION DETAILS.
 - INSTALL FOUNDATION 8" ABOVE FINISH GRADE.
 - TO BE DETERMINED BY PRECAST CONCRETE MANUFACTURER.
 - CONTRACTOR TO DETERMINE WIDTH AND ROTATION ANGLE OF FOUNDATION.
 - PIER ELEVATION SHALL MATCH EXISTING STRUCTURE PIER ELEVATION.

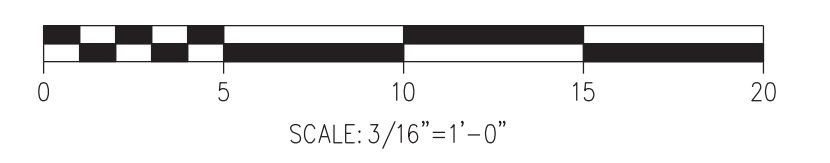

ADDITIONS
DRAWING

This document and any attachments are considered:
BUSINESS CONFIDENTIAL
PROTECTED CRITICAL INFRASTRUCTURE INFORMATION

REFERENCE DRAWINGS

| | |
|---------|-------------------------------------|
| 520-6-2 | CONDUIT PLAN |
| 520-6-1 | FENCE & GROUNDING PLAN |
| 520-42 | FOUNDATION FOR UNIT SUBSTATION |
| 520-38 | GENERAL ARRANGEMENT PLAN & SECTIONS |
| 520-38 | FOUNDATION SUMMARY |
| 520-36 | POWER ONE LINE DIAGRAM |

| NO. | REVISION | DATE | BY | CK | P. E. STAMPED BY | P. E. No. |
|-----|------------------------------|----------|-----|-----|------------------|-----------|
| 4 | RE-ISSUED FOR CONSTRUCTION | 12/22/16 | SGC | SGC | BJB | 12004 |
| 3 | RE-ISSUED FOR CONSTRUCTION | 08/26/16 | SGC | SGC | BJB | 12004 |
| 2 | ISSUED FOR CONSTRUCTION | 08/15/16 | SGC | SGC | BJB | 12004 |
| 1 | Record Drawing 2012 Const | 05/23/12 | TRC | TRC | | |
| 0 | Redrawn Issue For Const 2011 | 10/21/11 | TRC | TRC | MJS | 10130 |

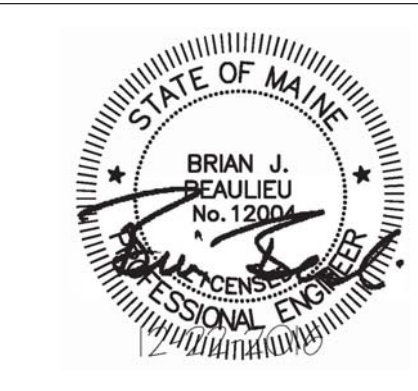

| | | |
|---------------------|--|--------|
| DESIGNED SGC/TDD | FOUNDATION PLAN BISHOP ST. SUBSTATION PORTLAND MAINE CENTRAL MAINE POWER COMPANY SYSTEM ENGINEERING DATE: 8/15/16 SCALE: 3/16" = 1'-0" | 520-37 |
| DRAWN SGC/TDD | | REV 4 |
| CHECKED SGC/TMH | | |
| APPROVED CMP | | |