

PLANT LIST

| KEY | QTY | BOTANICAL NAME | COMMON NAME | SIZE |
|--------------------------------|-----|-------------------------------------|-----------------------------|-------------------|
| TREES | | | | |
| A. CAN | 2 | AMELANCHIAR CANADENSIS | SHADBLOW | 5'-6" HT. (CLUMP) |
| A. PSE | 3 | ACER PSEUDOSIEBOLDIANUM | KOREAN MAPLE | #7 |
| A. RUB | 5 | ACER RUBRUM | RED MAPLE | 2" CAL |
| B. ALL | 1 | BETULA ALLEGHANIENSIS | YELLOW BIRCH | 2" CAL |
| C. OCC | 1 | CELTIS OCCIDENTALIS | HACKBERRY | 2" CAL |
| C. THY | 12 | CHAMAECYPARIS THYOIDES | ATLANTIC WHITE CEDAR | 5'-6" HT. |
| C. OBC | 3 | CHAMAECYPARIS OBTUSA 'COMPACTA' | COMPACT HINOKI FALSECYPRESS | 3'-4' HT |
| M. CAR | 4 | MALUS 'CARDINAL' | CARDINAL FLOWERING CRAB | 2" CAL |
| P. GLA | 3 | PICEA GLAUCA | WHITE SPRUCE | 5'-6" HT. |
| P. SAR | 4 | PRUNUS SARGENTII | SARGENT CHERRY | 2" CAL |
| Q. BIC | 7 | QUERCUS BICOLOR | SWAMP WHITE OAK | 2" CAL |
| Q. PAL | 1 | QUERCUS PALUSTRIS | PIN OAK | 2" CAL |
| T. CUS | 2 | TAXUS CUSPIDATA 'CAPITATA' | UPRIGHT JAPANESE YEW | 5'-6" HT. |
| SHRUBS | | | | |
| A. GIR | 26 | AZALEA GIRARD'S FUSCHIA | GIARDS FUSCHIA AZALEA | #3 |
| C. ALN | 2 | CLETHRA ALNIFOLIA 'RUBY SPICE' | RUBY SPICE SUMMERSWEET | #3 |
| C. SAF | 14 | CORNUS SERICEA 'ARCTIC FIRE' | RED TWIG DOGWOOD | #3 |
| D. BUR | 6 | DAPHNE BURKWOODII | CAROL MACKIE DAPHNE | 15-18" |
| H. PAN | 4 | HYDRANGEA PANICULATA 'QUICKFIRE' | QUICKFIRE HYDRANGEA | #3 |
| P. JAP | 3 | PIERIS JAPONICA | ANDOMEDA | #3 |
| R. HEL | 1 | RHODODENDRON 'HELLIKI' | HELLIKI RHODODENDRON | #3 |
| S. PMK | 2 | SYRINGA PATULA 'MISS KIM' | MISS KIM LILAC | 3' HT |
| V. COR | 3 | VACCINIUM CORYMBOSUM | HIGHBUSH BLUEBERRY | #3 |
| PERENNIALS/GROUNDCOVERS | | | | |
| A. UVA | 20 | ARCTOSTAPHYLOS UVA-URSI | BEARBERRY | 1 QT |
| A. ALI | 18 | ASTILBE 'ALIVE & KICKING' | FALSE SPIREA | 1 QT |
| C. MOR | 21 | CAREX MORROWII 'EVERGOLD & ICE MIX' | EVERGOLD & ICE MIX SEDGE | 1 QT |
| H. LS | 15 | HEMEROCALLIS 'LADY SCARLET' | LADY SCARLET DAYLILY | 1 QT |
| H. GUA | 32 | HOSTA 'GUACAMOLE' | GUACAMOLE HOSTA | 1 QT |
| FERNS | | | | |
| A. NIP | 18 | ATHYRIUM NIPONICUM 'PICTUM' | JAPANESE PAINTED FERN | POT |
| A. PED | 18 | ANDANTUM PEDATUM 'MAIDENHAIR' | MAIDENHAIR FERN | POT |
| D. ERB | 15 | DRYOPTERIS ERYTHROSRA 'BRILLIANCE' | WOOD FERN | POT |
| P. POL | 15 | POLYSTICHUM POLYBLEPHARUM | JAPANESE TASSEL FERN | POT |

*NOTE- PERENNIALS TO BE FIELD LOCATED-- COORDINATE WITH PROJECT LANDSCAPE ARCHITECT

LEGEND

| | EXISTING | PROPOSED |
|--------------------|----------|----------|
| PROPERTY LINE | [Symbol] | [Symbol] |
| IRON PIPE/MAG NAIL | [Symbol] | [Symbol] |
| GRANITE MONUMENT | [Symbol] | [Symbol] |
| CATCHBASIN | [Symbol] | [Symbol] |
| HYDRANT | [Symbol] | [Symbol] |
| UTILITY POLE | [Symbol] | [Symbol] |
| FENCE | [Symbol] | [Symbol] |
| DEC. TREE | [Symbol] | [Symbol] |
| EVERGREEN TREE | [Symbol] | [Symbol] |
| LIGHT POLE | [Symbol] | [Symbol] |
| CURB | [Symbol] | [Symbol] |
| OVERHEAD WIRES | [Symbol] | [Symbol] |
| WALL MOUNTED LIGHT | [Symbol] | [Symbol] |
| SOIL BORINGS | [Symbol] | [Symbol] |
| WATER VALVE | [Symbol] | [Symbol] |
| GAS VALVE | [Symbol] | [Symbol] |
| SIGN | [Symbol] | [Symbol] |
| WETLAND | [Symbol] | [Symbol] |

BISHOP STREET

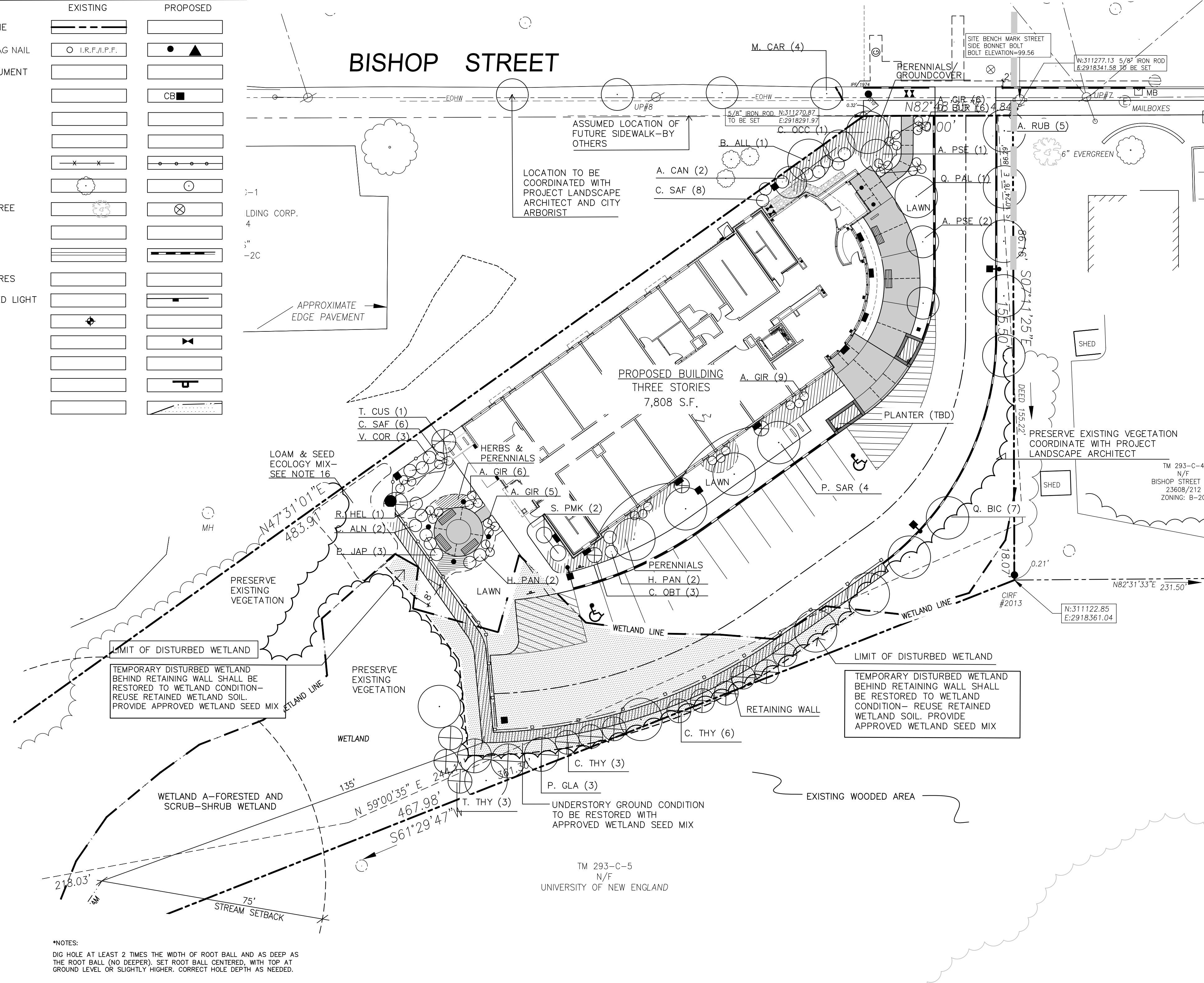

GENERAL PLANTING NOTES

- CALL DIG-SAFE (1-888-344-7233) PRIOR TO BEGINNING WORK. THE LANDSCAPE CONTRACTOR IS ADVISED OF THE PRESENCE OF UNDERGROUND UTILITIES AND SHALL VERIFY THE EXISTENCE AND LOCATION OF SAME BEFORE COMMENCING AND DIGGING OPERATIONS. THE LANDSCAPE CONTRACTOR SHALL REPLACE OR REPAIR UTILITIES PAVING, WALKS, CURBING, ETC. DAMAGED IN PERFORMANCE OF THIS JOB AT NO ADDITIONAL COST TO OWNER.
- CONTRACTOR SHALL THOROUGHLY FAMILIARIZE HIMSELF WITH ALL SITE CONDITIONS PRIOR TO CONSTRUCTION BIDDING.
- DO NOT SCALE FROM DRAWINGS. ANY OMISSIONS IN DIMENSIONING SHALL BE REPORTED IMMEDIATELY TO THE LANDSCAPE ARCHITECT. ANY DISCREPANCIES BETWEEN DRAWINGS, DETAILS, NOTES AND SPECS SHALL BE IMMEDIATELY REPORTED TO THE LANDSCAPE ARCHITECT FOR FURTHER DIRECTION AND RESOLUTION BEFORE ANY ADDITIONAL WORK PROCEEDS.
- PROVIDE SMOOTH TRANSITION WHERE NEW WORK MEETS EXISTING CONDITIONS.
- CONTRACTOR SHALL FURNISH AND PLACE 12 INCHES OF LOAM IN ALL SHRUB BEDS, 30 INCHES IN ALL TREE PITS, AND 6 INCHES UNDER ALL TURF AREAS. THE LANDSCAPE CONTRACTOR SHALL COORDINATE SUBGRADE PREPARATION WITH THE GENERAL CONTRACTOR PRIOR TO PLACING LOAM.
- ALL PLANT MATERIAL INSTALLED SHALL MEET THE SPECIFICATIONS OF "AMERICAN STANDARDS FOR NURSERY STOCK BY THE AMERICAN ASSOCIATION OF NURSERYMEN" LATEST EDITION.
- ALL PLANT MATERIAL SHALL BE FREE FROM INSECTS AND DISEASE.
- ALL PLANTING SHALL BE DONE IN ACCORDANCE WITH ACCEPTABLE HORTICULTURAL PRACTICES. THIS IS TO INCLUDE PROPER PLANTING MIX, PLANT BED AND TREE PIT PREPARATION, PRUNING, STAKING OR GUYING, WRAPPING, SPRAYING, FERTILIZATION, PLANTING AND ADEQUATE MAINTENANCE UNTIL ACCEPTANCE FROM THE OWNER.
- ALL GRASS, OTHER VEGETATION AND DEBRIS SHALL BE REMOVED FROM ALL PLANTING AREAS PRIOR TO PLANTING.
- PRIOR TO SITE CLEARING, CONTRACTOR SHALL COORDINATE WITH PROJECT LANDSCAPE ARCHITECT TO DEMARCATRE TREES FOR PROTECTION AND WETLAND AREAS TO BE PROTECTED. EXISTING TREES TO BE PRESERVED SHALL BE PROTECTED DURING CONSTRUCTION AND SHALL BE THE RESPONSIBILITY OF THE GENERAL CONTRACTOR.
- ALL SHRUB BEDS AND TREE PITS SHALL BE MULCHED WITH 3" CLEAN SHREDDED BLACK MULCH (DO NOT EXCEED 3" DEPTH).
- ANY DEVIATION FROM THE LANDSCAPE PLAN, INCLUDING PLANT LOCATION, SELECTION, SIZE, QUANTITY, OR CONDITION SHALL BE REVIEWED AND APPROVED BY THE OWNER AND LANDSCAPE ARCHITECT (AND MUNICIPAL AUTHORITY, IF APPLICABLE) PRIOR TO INSTALLATION ON SITE.
- WHERE INDICATED ON PLAN, PLANTING SOIL MIXTURE FOR GROUND COVER AND PERENNIAL BED AREAS SHALL CONSIST OF FOUR PARTS TOPSOIL, TWO PARTS SPHAGNUM PEAT MOSS, AND ONE PART HORTICULTURAL PERLITE BY VOLUME. PEAT MOSS MAY BE SUBSTITUTED WITH WELL-ROTTED OR DEHYDRATED MANURE OR COMPOST. ROTOTILL BEDS TO A DEPTH OF 8 INCHES.
- DAMAGE TO EXISTING SITE IMPROVEMENTS DURING INSTALLATION OF LANDSCAPE MATERIAL SHALL BE THE RESPONSIBILITY OF THE LANDSCAPE CONTRACTOR.
- ALL WORK WITHIN THE ROAD RIGHT-OF-WAY AND ALL UTILITIES CONNECTING TO INFRASTRUCTURE WITHIN THE ROAD SHALL MEET CITY OF PORTLAND TECHNICAL MANUAL STANDARDS.
- ECOLOGY SEED MIX: 80% HARD FESCUE, 20% CHEWINGS FESCUE
- REFER TO SHEET L1 FOR TREE PROTECTION NOTES.

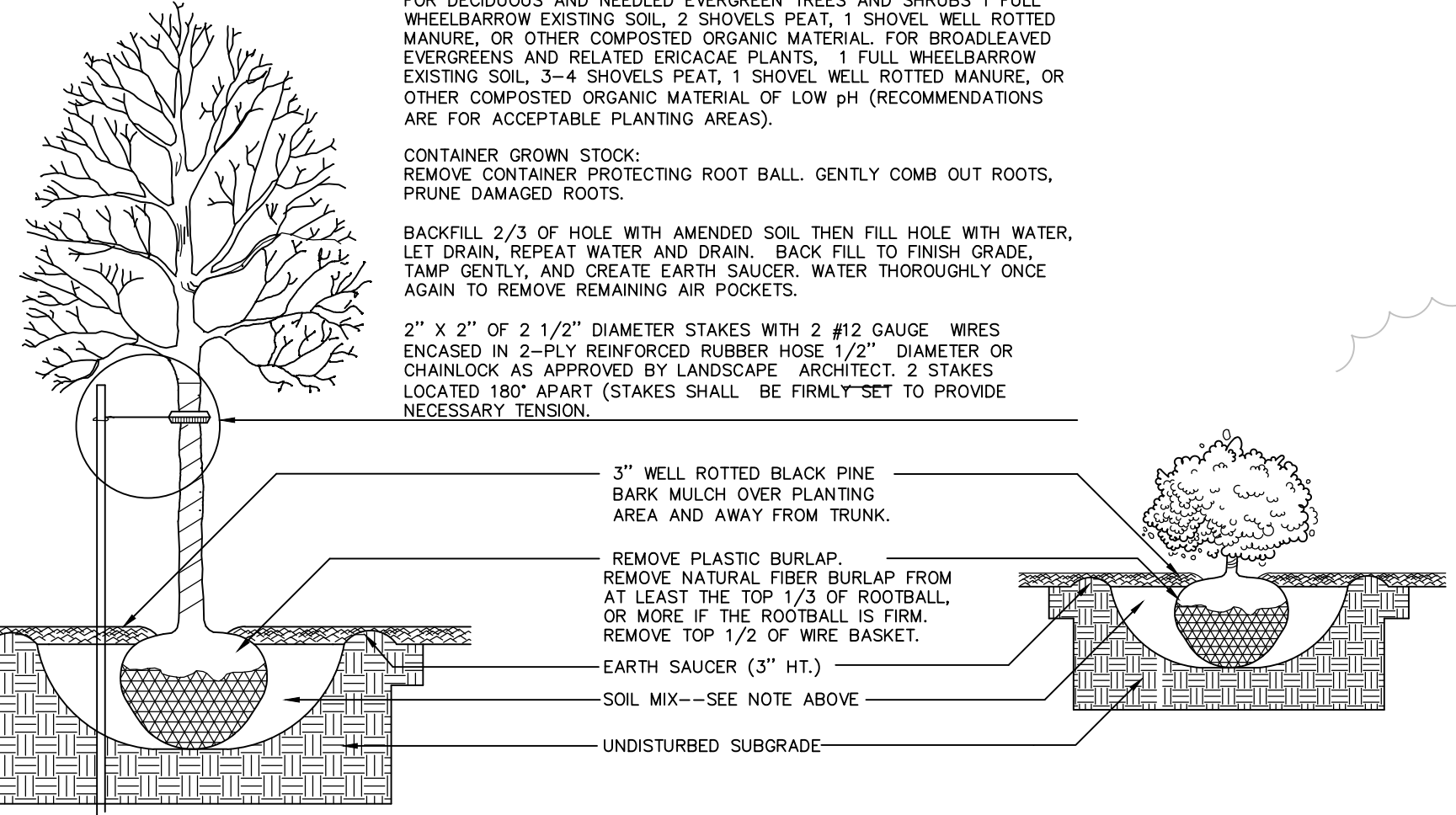

TREE AND SHRUB INSTALLATION
NOT TO SCALE

Prepared For:
 Owner:
 AVESTA BISHOP STREET LP
 307 Cumberland Avenue
 Portland, Maine 04101
 Tel.: 207-553-7777

Prepared By:
 MITCHELL & ASSOCIATES
 Landscape Architects
 The Staples School
 70 Center Street
 Portland, Maine 04101
 Tel.: 207-774-4427

72 BISHOP STREET

Portland, Maine

Bishop Street

Date: APRIL 10, 2015

Issued For: ISSUED FOR PERMITTING

Revisions:
 Rev: 5/22/15
 Rev: 6/22/15
 Rev: 12/23/15
 Rev: 02/05/16
 conditions of approval
 Rev: 03/07/16 planting plan

Reproduction or reuse of this document without the expressed written consent of Mitchell & Associates is prohibited.
© 2014

Title: PLANTING PLAN

Scale: 1"=20'

North: [North arrow symbol]

Sheet No.: L4

