

Prepared For:
 Owner:
 AVESTA BISHOP STREET LP
 307 Cumberland Avenue
 Portland, Maine 04101
 Tel.: 207-553-7777

Prepared By:
 MITCHELL & ASSOCIATES
 Landscape Architects
 The Staples School
 70 Center Street
 Portland, Maine 04101
 Tel.: 207-774-4427

72 BISHOP STREET
 Portland, Maine
 Bishop Street

1 SIDEWALK EXTENSION - L1
 SCALE: 1"=10'

- GENERAL NOTES:**
- EXISTING CONDITIONS AND BOUNDARY INFORMATION TAKEN FROM A PLAN ENTITLED 'BOUNDARY & TOPOGRAPHIC SURVEY AT 72 BISHOP STREET, PORTLAND, MAINE' PREPARED BY OWEN HASKELL, INC. DATED JULY 17, 2014.
 - BEARINGS ARE GRID NORTH AND ELEVATIONS ARE NAVD88 AS BASED ON STATIC GPS COLLECTION AND OPUS CORRECTION.
 - THE UNDERGROUND UTILITIES SHOWN HAVE BEEN LOCATED FROM FIELD SURVEY INFORMATION AND EXISTING DRAWINGS. THE SURVEYOR MAKES NO GUARANTEES THAT THE UNDERGROUND UTILITIES SHOWN COMPRISE ALL SUCH UTILITIES IN THE AREA, EITHER IN SERVICE OR ABANDONED. THE SURVEYOR FURTHER DOES NOT WARRANT THAT THE UNDERGROUND UTILITIES SHOWN ARE IN THE EXACT LOCATION INDICATED ALTHOUGH HE DOES CERTIFY THAT THEY ARE LOCATED AS ACCURATELY AS POSSIBLE FROM THE INFORMATION AVAILABLE. THE SURVEYOR HAS NOT PHYSICALLY LOCATED THE UNDERGROUND UTILITIES. CALL 1-800-DIGSAFE AT LEAST THREE BUSINESS DAYS BEFORE PERFORMING ANY CONSTRUCTION. DUE TO OSHA CONFINED SPACE REQUIREMENTS, ALL INVERTS AND PIPE SIZES MUST BE VERIFIED PRIOR TO ANY CONSTRUCTION.

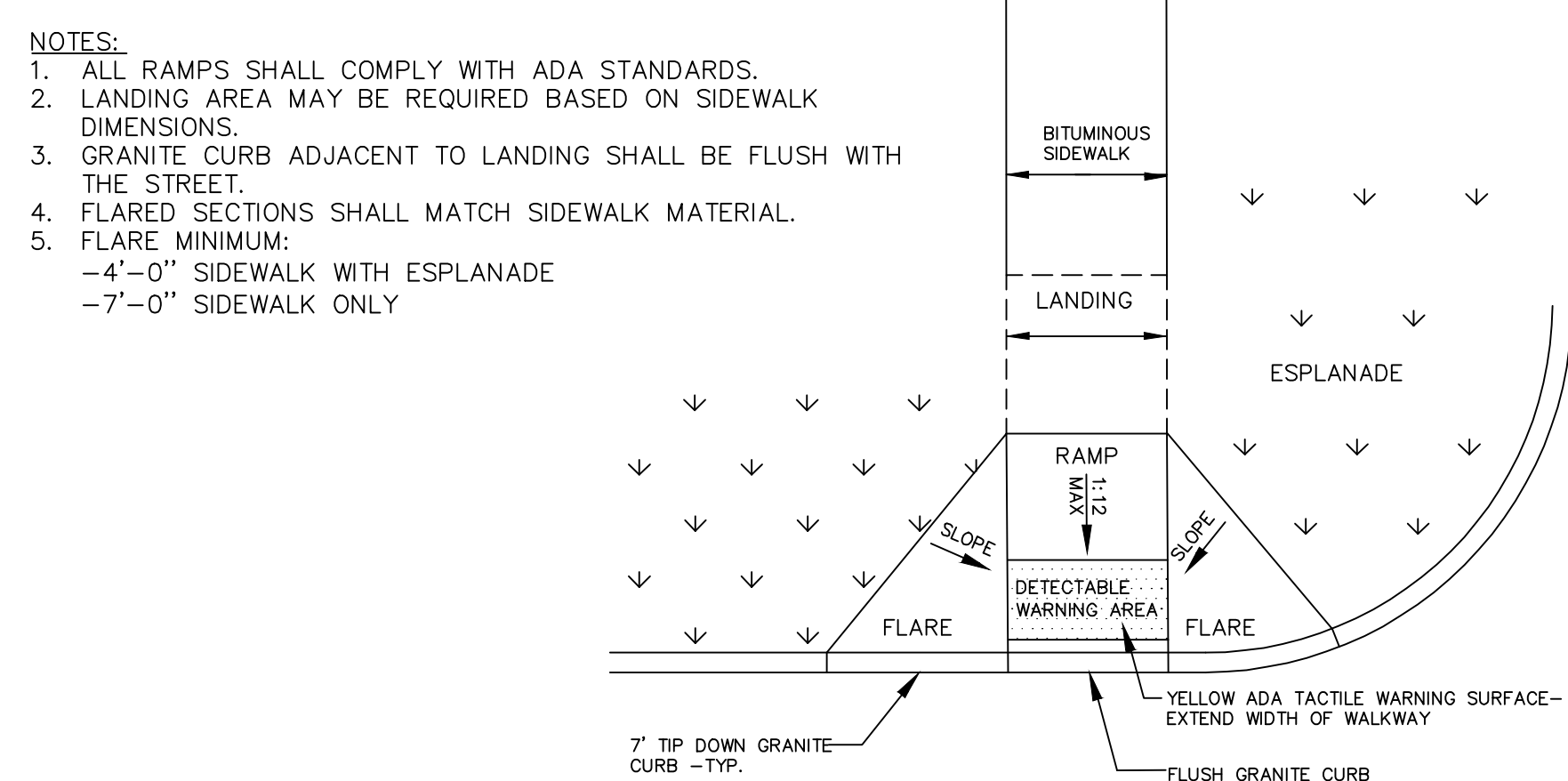

2 HANDICAP RAMP
 NOT TO SCALE

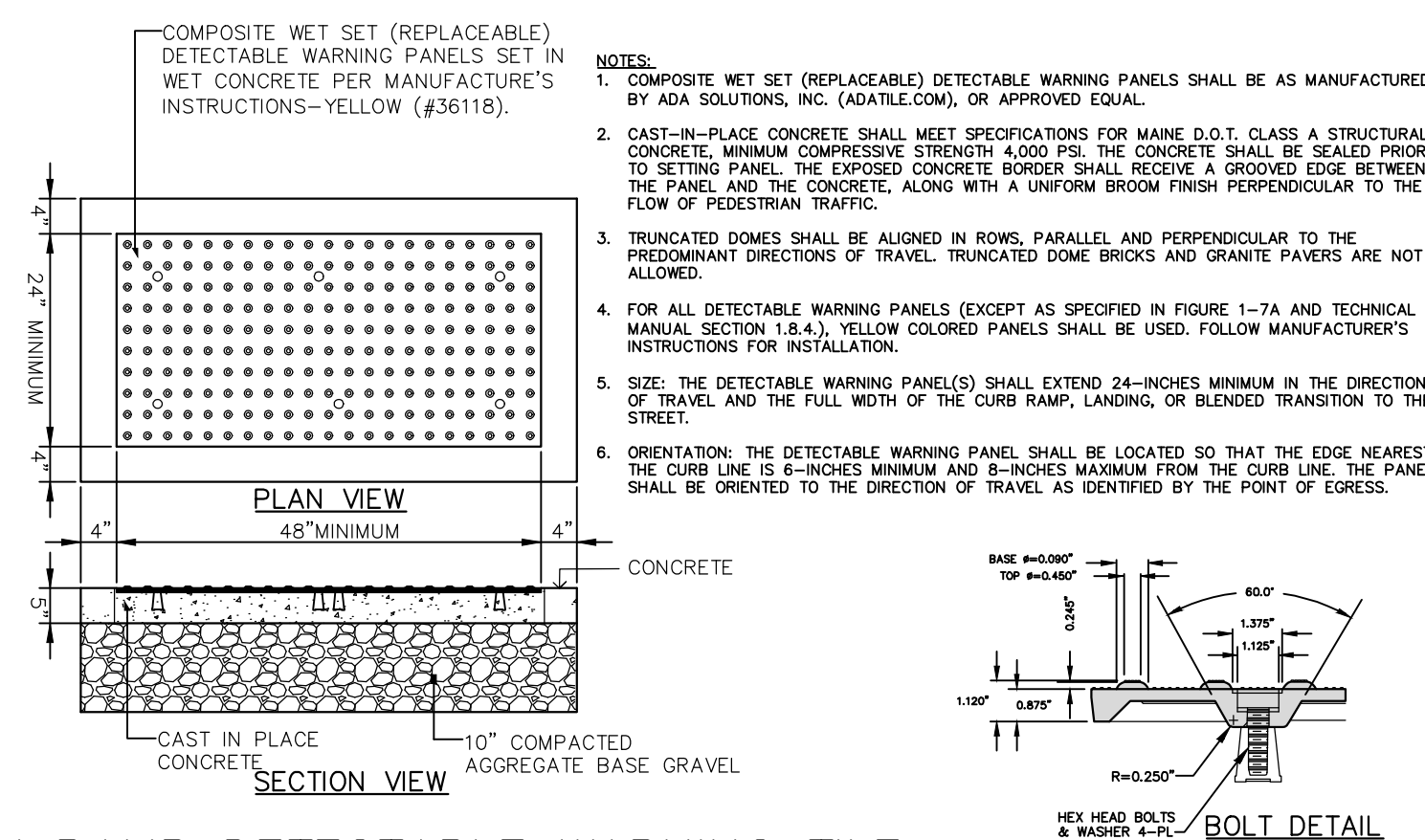

3 SIDEWALK RAMP DETECTABLE WARNING TILE
 NOT TO SCALE

Date:
 SEPTEMBER 9, 2015

Issued For:
 SITE PLAN AND SUBDIVISION
 PLAN REVIEW

Revisions:
 Rev. 5/22/15
 Rev. 7/09/15
 Rev. 9/09/15

Reproduction or reuse of this document without the expressed written consent of Mitchell & Associates is prohibited.
 © 2014

Title:
 BISHOP STREET
 SIDEWALK PLAN

Scale: 1"=10'

North:

Sheet No.:
L9

I:\ProjectDrawings\Bishop Street\150908 Bishop Street Sidewalk Extension.dwg skiball 9/30/15 1:35 PM

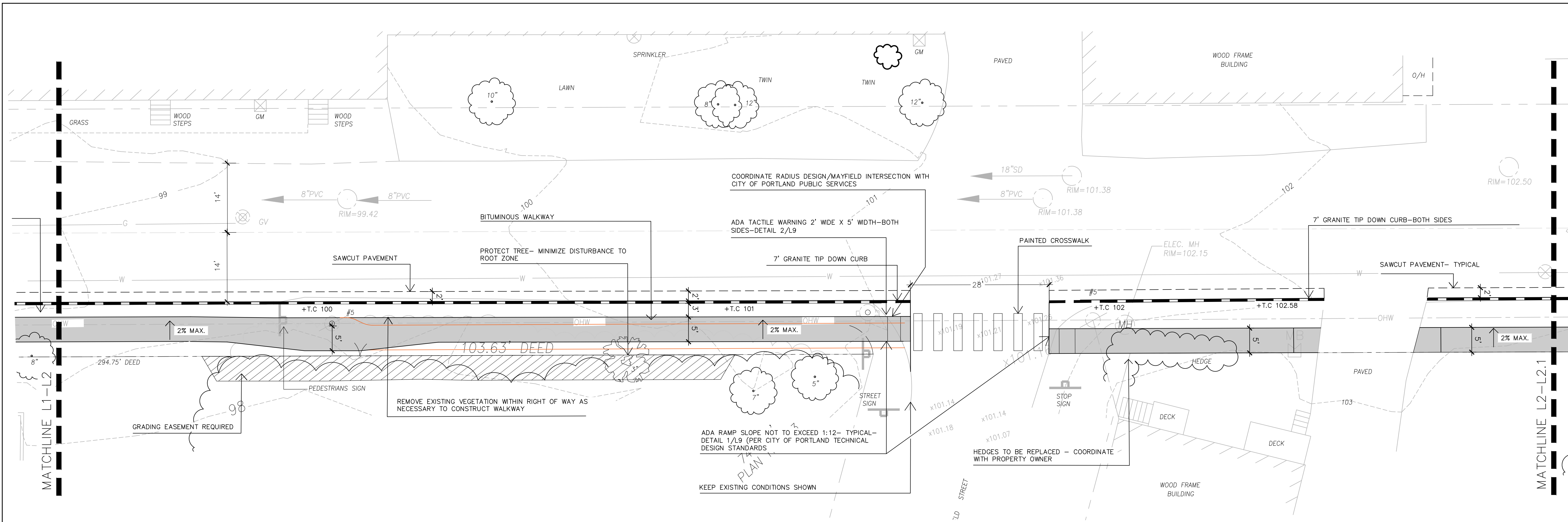

1 SIDEWALK EXTENSION - L2
SCALE: 1"=10'

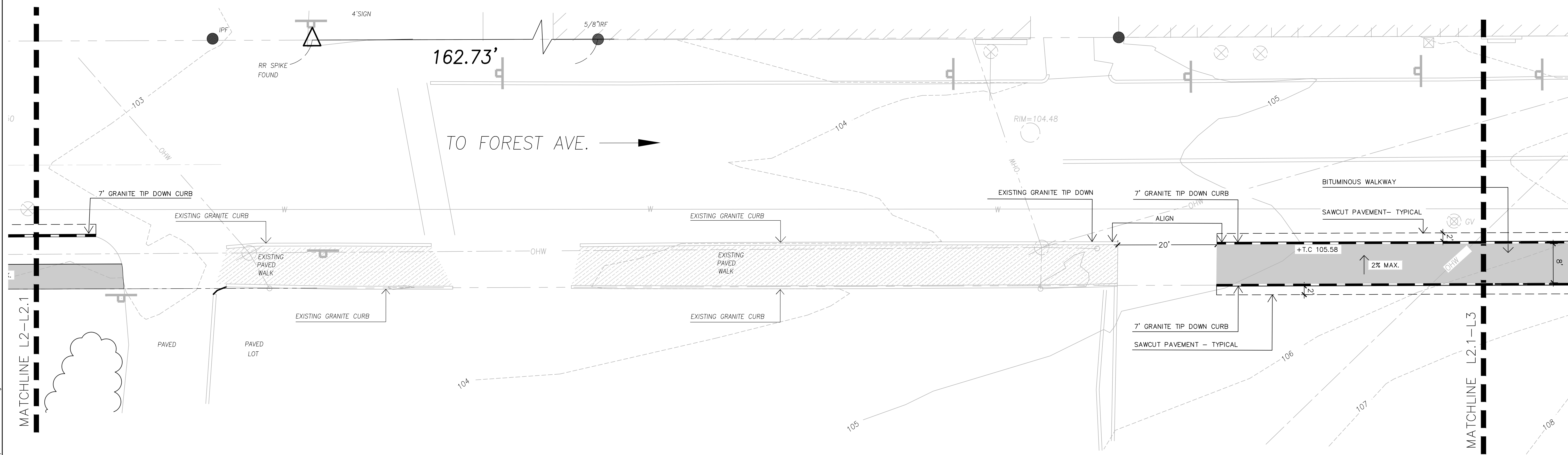

2 SIDEWALK EXTENSION - L2.1
SCALE: 1"=10'

Prepared For:
Owner:
AVESTA BISHOP STREET LP
307 Cumberland Avenue
Portland, Maine 04101
Tel.: 207-553-7777

Prepared By:
MITCHELL & ASSOCIATES
Landscape Architects
The Staples School
70 Center Street
Portland, Maine 04101
Tel.: 207-774-4427

72 BISHOP STREET
Portland, Maine
Bishop Street

Date:
SEPTEMBER 9, 2015

Issued For:
SITE PLAN AND SUBDIVISION
PLAN REVIEW

Revisions:
Rev. 5/22/15
Rev. 7/09/15
Rev. 9/09/15

Reproduction or reuse of this document
without the expressed written consent
of Mitchell & Associates is prohibited.
© 2014

Title:
BISHOP STREET
SIDEWALK PLAN

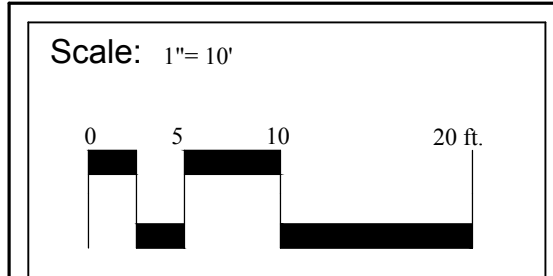

North:

Sheet No.:
L9.1

I:\ProjectDrawings\Bishop Street\150908 Bishop Street Sidewalk Extension.dwg skibaal 9/9/2015 1:36 PM

TREE PROTECTION REQUIREMENTS

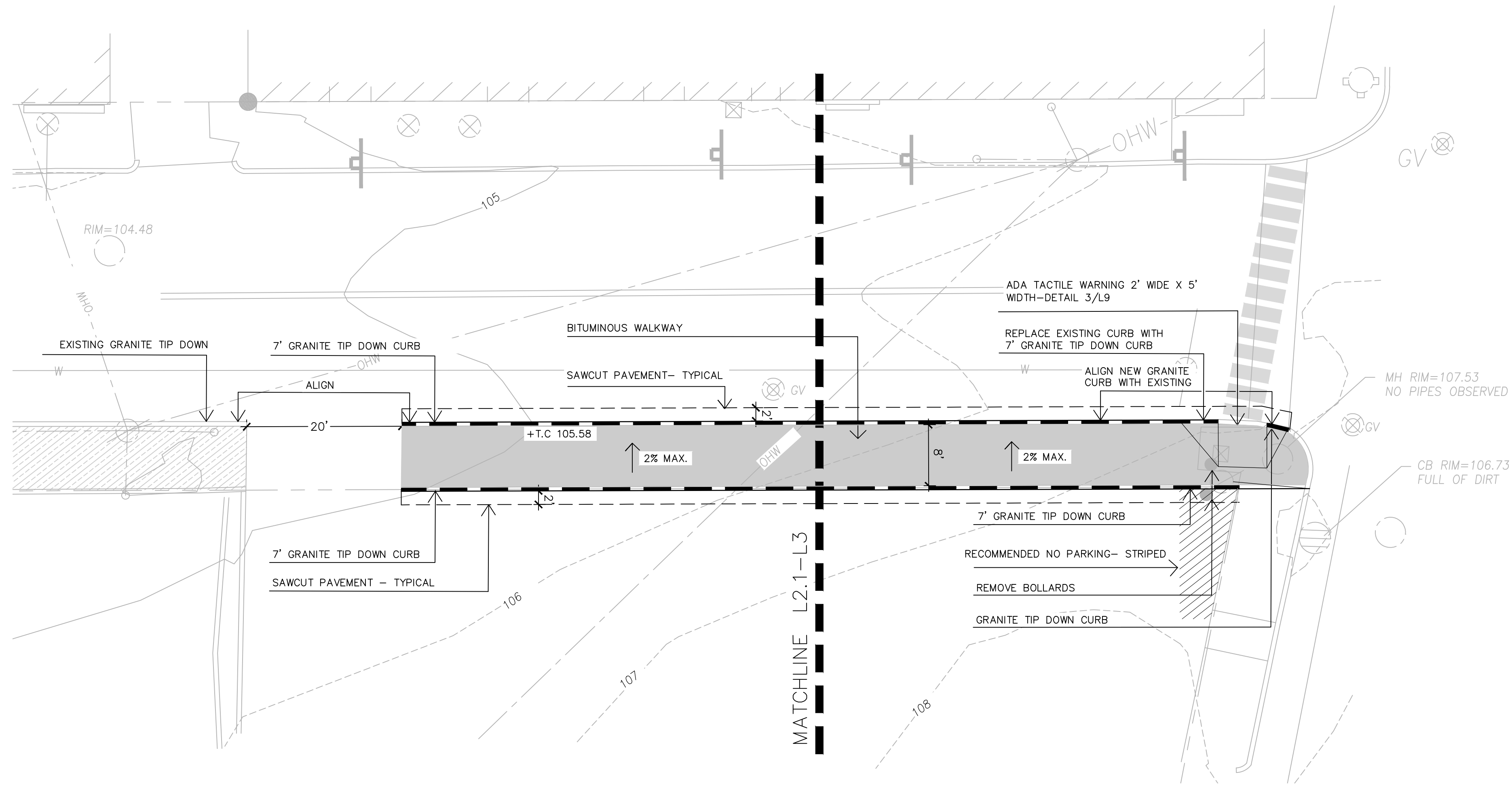

1 SIDEWALK EXTENSION - L3
SCALE: 1"=10'

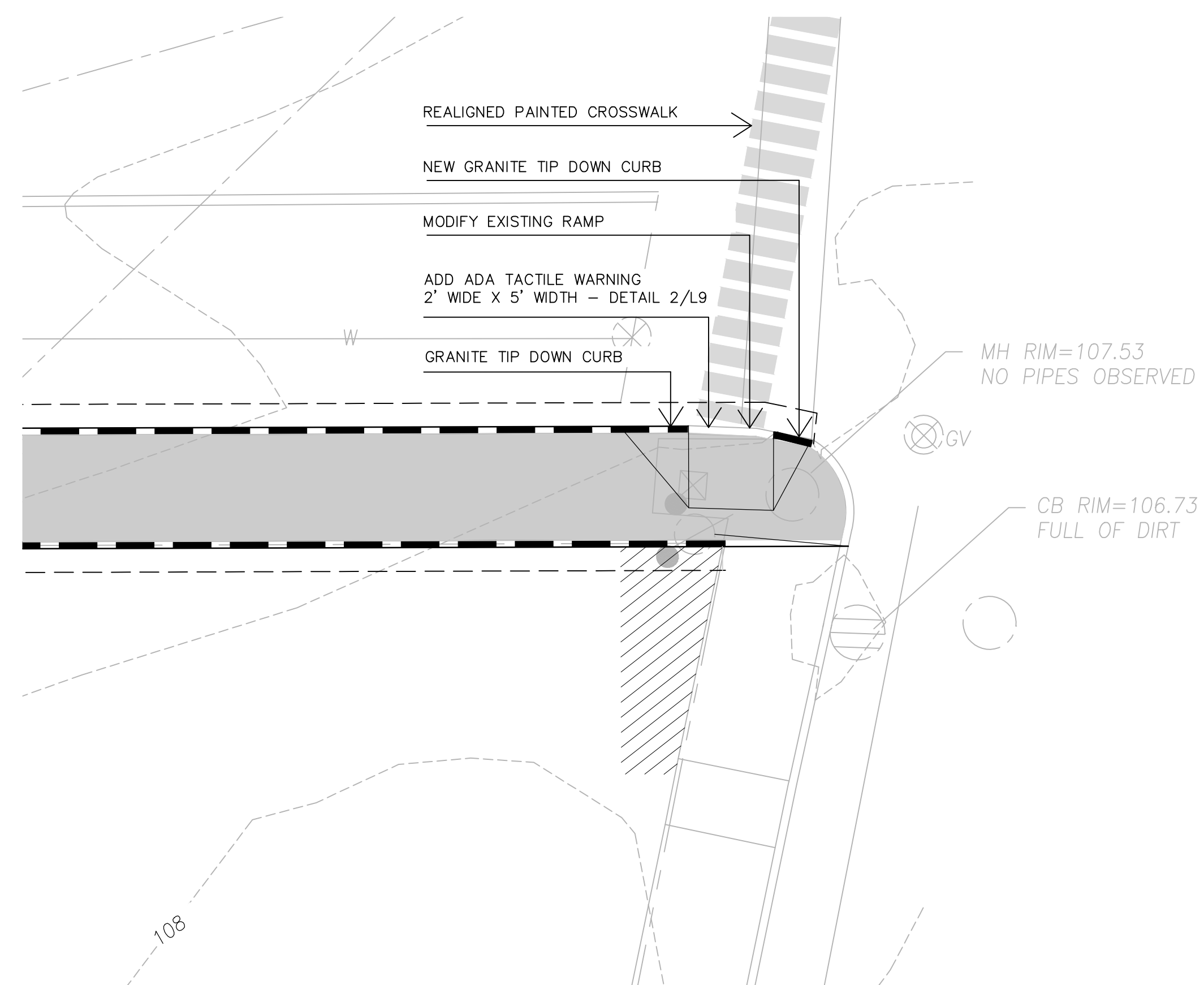

2 INTERSECTION HANDICAP RAMP - OPTION 1
SCALE: 1/8"=1'-0"

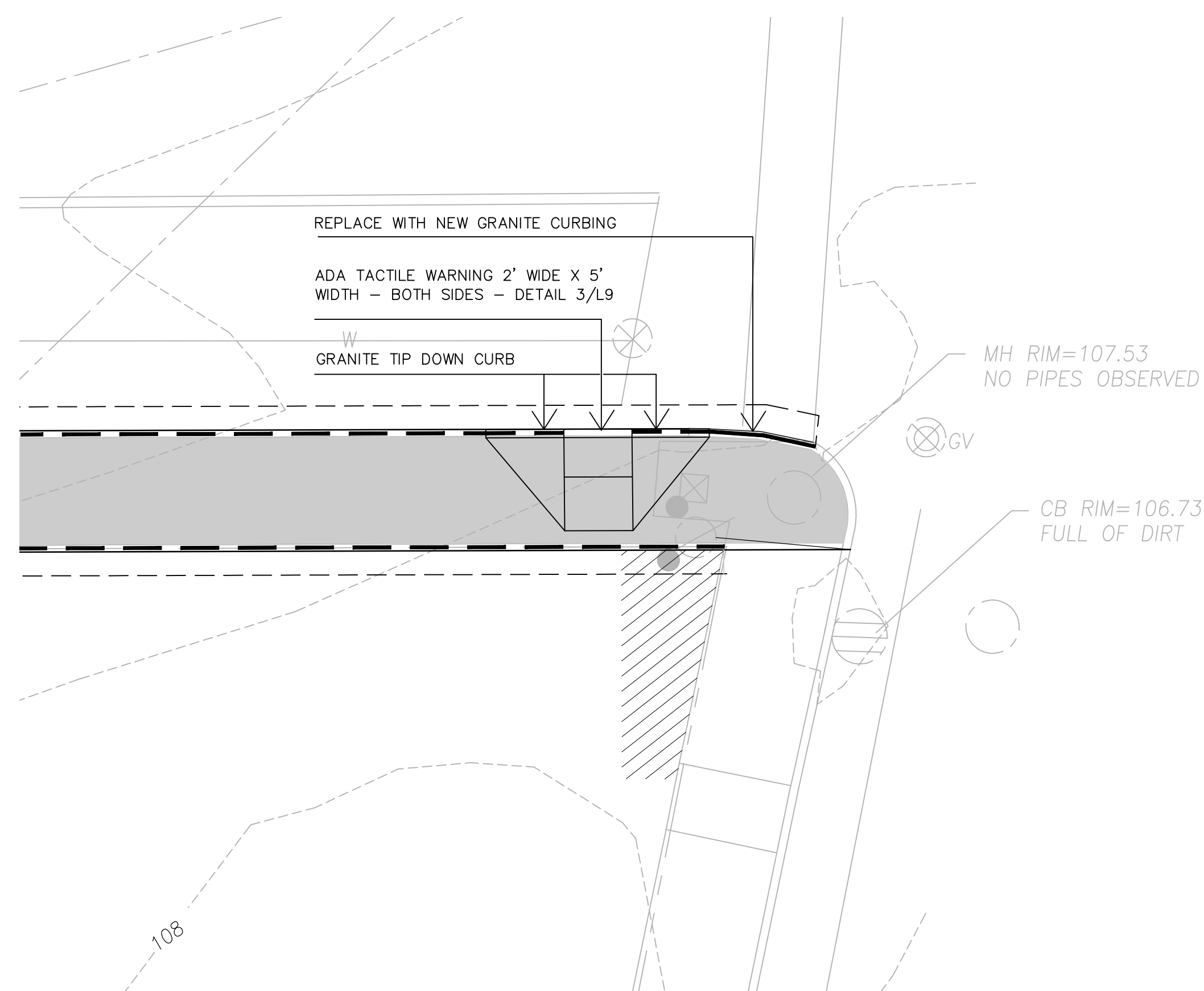

3 INTERSECTION HANDICAP RAMP - OPTION 2
SCALE: 1/8"=1'-0"

Prepared For:
Owner:
AVESTA BISHOP STREET LP
307 Cumberland Avenue
Portland, Maine 04101
Tel.: 207-553-7777

Prepared By:
MITCHELL & ASSOCIATES
Landscape Architects
The Staples School
70 Center Street
Portland, Maine 04101
Tel.: 207-774-4427

72 BISHOP STREET
Portland, Maine
Bishop Street

Date:
SEPTEMBER 9, 2015

Issued For:
SITE PLAN AND SUBDIVISION
PLAN REVIEW

Revisions:
Rev. 5/22/15
Rev. 7/09/15
Rev. 9/09/15

Reproduction or reuse of this document
without the expressed written consent
of Mitchell & Associates is prohibited.
© 2014

Title:
BISHOP STREET
SIDEWALK PLAN

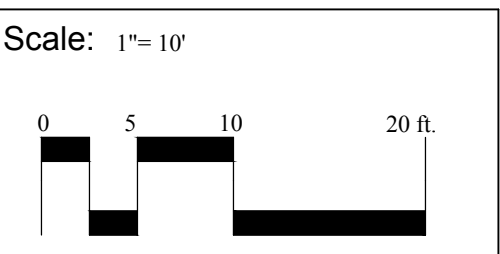

North:

Sheet No.:
L9.2