

Prepared For:
 Owner:
 AVESTA BISHOP STREET LP
 307 Cumberland Avenue
 Portland, Maine 04101
 Tel.: 207-553-7777

Prepared By:
 MITCHELL & ASSOCIATES
 Landscape Architects
 The Staples School
 70 Center Street
 Portland, Maine 04101
 Tel.: 207-774-4427

72 BISHOP STREET
 Portland, Maine
 Bishop Street

1 SIDEWALK EXTENSION - L1

SCALE: 1"=10'

GENERAL NOTES:

- EXISTING CONDITIONS AND BOUNDARY INFORMATION TAKEN FROM A PLAN ENTITLED 'BOUNDARY & TOPOGRAPHIC SURVEY AT 72 BISHOP STREET, PORTLAND, MAINE' PREPARED BY OWEN HASKELL, INC. DATED JULY 17, 2014.
- BEARINGS ARE GRID NORTH AND ELEVATIONS ARE NAVD88 AS BASED ON STATIC GPS COLLECTION AND OPUS CORRECTION.
- THE UNDERGROUND UTILITIES SHOWN HAVE BEEN LOCATED FROM FIELD SURVEY INFORMATION AND EXISTING DRAWINGS. THE SURVEYOR MAKES NO GUARANTEES THAT THE UNDERGROUND UTILITIES SHOWN COMPRISE ALL SUCH UTILITIES IN THE AREA, EITHER IN SERVICE OR ABANDONED. THE SURVEYOR FURTHER DOES NOT WARRANT THAT THE UNDERGROUND UTILITIES SHOWN ARE IN THE EXACT LOCATION INDICATED ALTHOUGH HE DOES CERTIFY THAT THEY ARE LOCATED AS ACCURATELY AS POSSIBLE FROM THE INFORMATION AVAILABLE. THE SURVEYOR HAS NOT PHYSICALLY LOCATED THE UNDERGROUND UTILITIES. CALL 1-800-DIGSAFE AT LEAST THREE BUSINESS DAYS BEFORE PERFORMING ANY CONSTRUCTION. DUE TO OSHA CONFINED SPACE REQUIREMENTS, ALL INVERTS AND PIPE SIZES MUST BE VERIFIED PRIOR TO ANY CONSTRUCTION.
- SITE CONTRACTOR SHALL COORDINATE WITH THE CITY OF PORTLAND TO ESTABLISH CONSTRUCTION MANAGEMENT REQUIREMENTS FOR INSTALLATION OF NEW SIDEWALK AND GRANITE CURBING ALONG BISHOP STREET AS SHOWN ON PLAN SHEETS L9, L9.1, L9.2.

NOTES:

- ALL RAMP SHALL COMPLY WITH ADA STANDARDS.
- LANDING AREA MAY BE REQUIRED BASED ON SIDEWALK DIMENSIONS.
- GRANITE CURB ADJACENT TO LANDING SHALL BE FLUSH WITH THE STREET.
- FLARED SECTIONS SHALL MATCH SIDEWALK MATERIAL.
- FLARE MINIMUM:
 -4'-0" SIDEWALK WITH ESPLANADE
 -7'-0" SIDEWALK ONLY

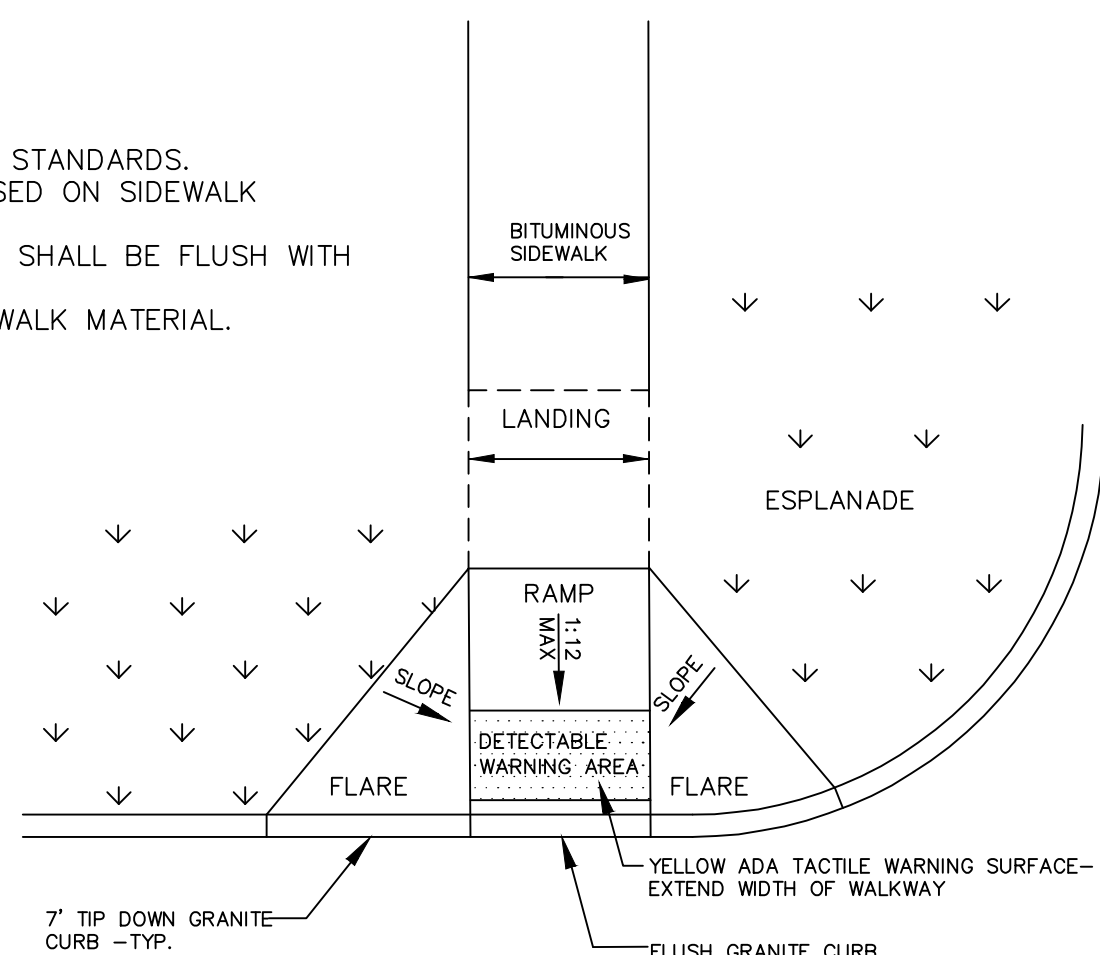

2 HANDICAP RAMP
 NOT TO SCALE

COMPOSITE WET SET (REPLACEABLE) DETECTABLE WARNING PANELS SET IN WET CONCRETE PER MANUFACTURER'S INSTRUCTIONS-YELLOW (#36118).

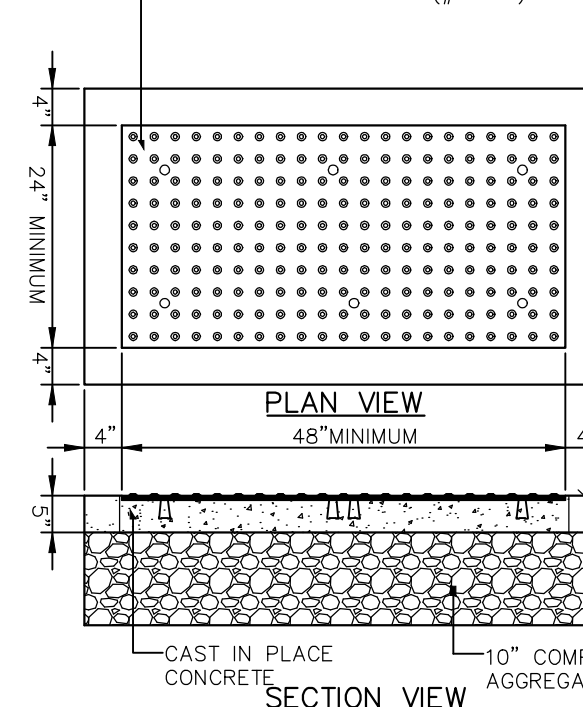

3 SIDEWALK RAMP DETECTABLE WARNING TILE
 NOT TO SCALE

Date:
 SEPTEMBER 9, 2015

Issued For:
 SITE PLAN AND SUBDIVISION PLAN REVIEW

Revisions:
 Rev. 5/22/15
 Rev. 7/09/15
 Rev. 9/09/15
 Issued for:
 90% Maine Housing Submission 11/25/15

Reproduction or reuse of this document without the expressed written consent of Mitchell & Associates is prohibited.
 © 2014

Title:
 BISHOP STREET SIDEWALK PLAN

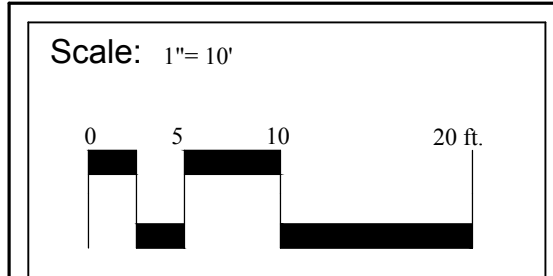

Scale: 1"=10'

North:

Sheet No.:
L9

I:\Projects\Drawings\2\Bishop Street Sidewalk Extension.dwg
 Project: 2015 Bishop Street Sidewalk Extension
 Date: 11/25/15 4:48 PM

GENERAL NOTES:

- EXISTING CONDITIONS AND BOUNDARY INFORMATION TAKEN FROM A PLAN ENTITLED "BOUNDARY & TOPOGRAPHIC SURVEY AT 72 BISHOP STREET, PORTLAND, MAINE" PREPARED BY OWEN HASKELL, INC. DATED JULY 17, 2014.
- BEARINGS ARE GRID NORTH AND ELEVATIONS ARE NAVD88 AS BASED ON STATIC GPS COLLECTION AND OPUS CORRECTION.
- THE UNDERGROUND UTILITIES SHOWN HAVE BEEN LOCATED FROM FIELD SURVEY INFORMATION AND EXISTING DRAWINGS. THE SURVEYOR MAKES NO GUARANTEES THAT THE UNDERGROUND UTILITIES SHOWN COMPRISE ALL SUCH UTILITIES IN THE AREA, EITHER IN SERVICE OR ABANDONED. THE SURVEYOR FURTHER DOES NOT WARRANT THAT THE UNDERGROUND UTILITIES SHOWN ARE IN THE EXACT LOCATION INDICATED ALTHOUGH HE DOES CERTIFY THAT THEY ARE LOCATED AS ACCURATELY AS POSSIBLE FROM THE INFORMATION AVAILABLE. THE SURVEYOR HAS NOT PHYSICALLY LOCATED THE UNDERGROUND UTILITIES. CALL 1-800-DIGSAFE AT LEAST THREE BUSINESS DAYS BEFORE PERFORMING ANY CONSTRUCTION. DUE TO OSHA CONFINED SPACE REQUIREMENTS, ALL INVERTS AND PIPE SIZES MUST BE VERIFIED PRIOR TO ANY CONSTRUCTION.
- SITE CONTRACTOR SHALL COORDINATE WITH THE CITY OF PORTLAND TO ESTABLISH CONSTRUCTION MANAGEMENT REQUIREMENTS FOR INSTALLATION OF NEW SIDEWALK AND GRANITE CURBING ALONG BISHOP STREET AS SHOWN ON PLAN SHEETS L9, L9.1, L9.2.

Prepared For:
Owner:
 AVESTA BISHOP STREET LP
 307 Cumberland Avenue
 Portland, Maine 04101
 Tel.: 207-553-7777

Prepared By:
MITCHELL & ASSOCIATES
 Landscape Architects
 The Staples School
 70 Center Street
 Portland, Maine 04101
 Tel.: 207-774-4427

72 BISHOP STREET

Portland, Maine

Bishop Street

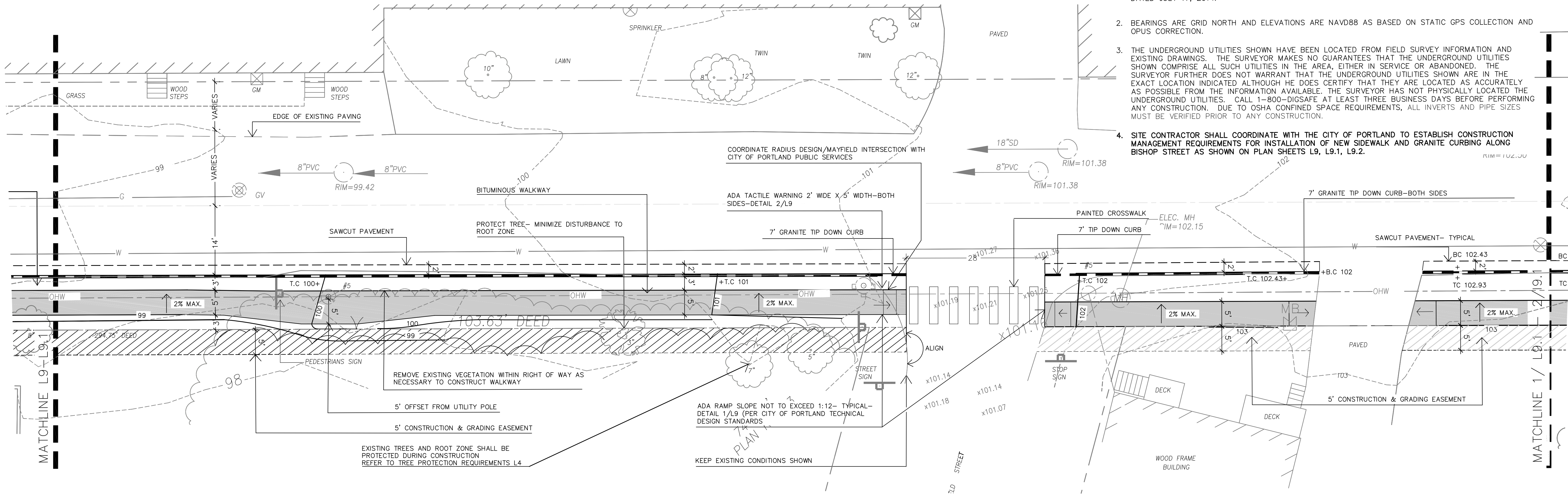

1 SIDEWALK EXTENSION
 SCALE: 1"=10'

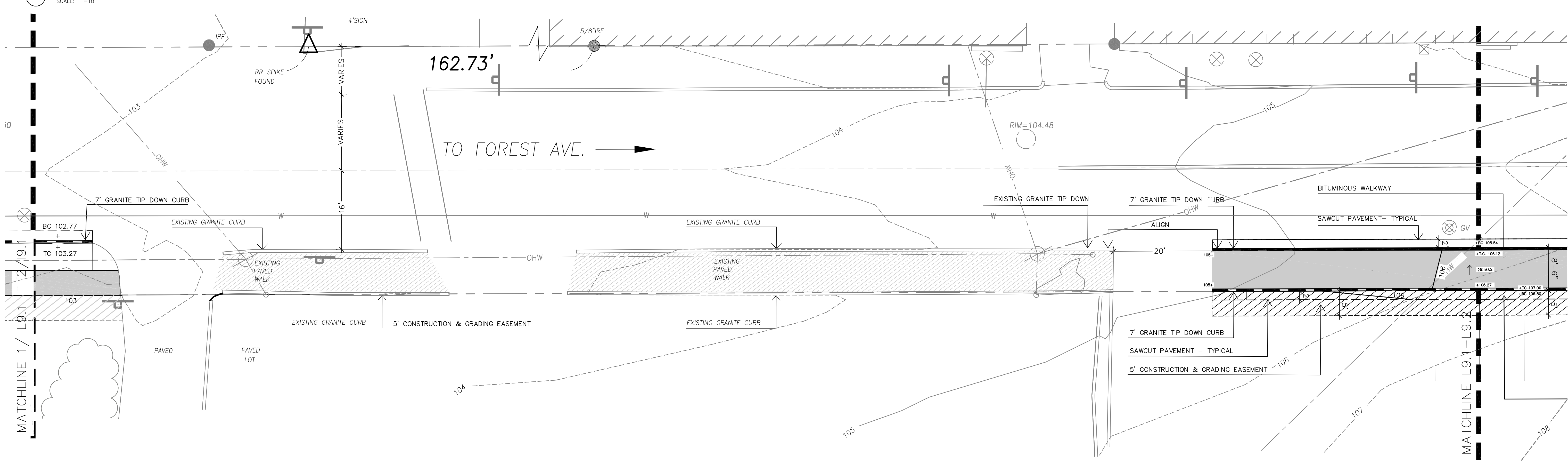

2 SIDEWALK EXTENSION
 SCALE: 1"=10'

Date:
 SEPTEMBER 9, 2015

Issued For:
 SITE PLAN AND SUBDIVISION
 PLAN REVIEW

Revisions:
 Rev. 5/22/15
 Rev. 7/09/15
 Rev. 9/09/15
Issued for:
 90% Maine Housing Submission
 11/25/15

Reproduction or reuse of this document
 without the expressed written consent
 of Mitchell & Associates is prohibited.
 © 2014

Title:
 BISHOP STREET
 SIDEWALK PLAN

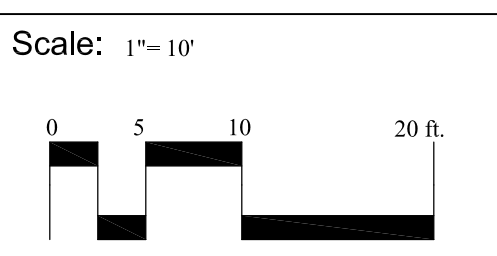

North:

Sheet No.:
L9.1

P:\ProductDrawings\Bishop Street Sidewalk Extension.dwg 9/9/2015 4:48 PM

