

NOTE:
STAMPED ENGINEERED SHOP DRAWINGS REQUIRED

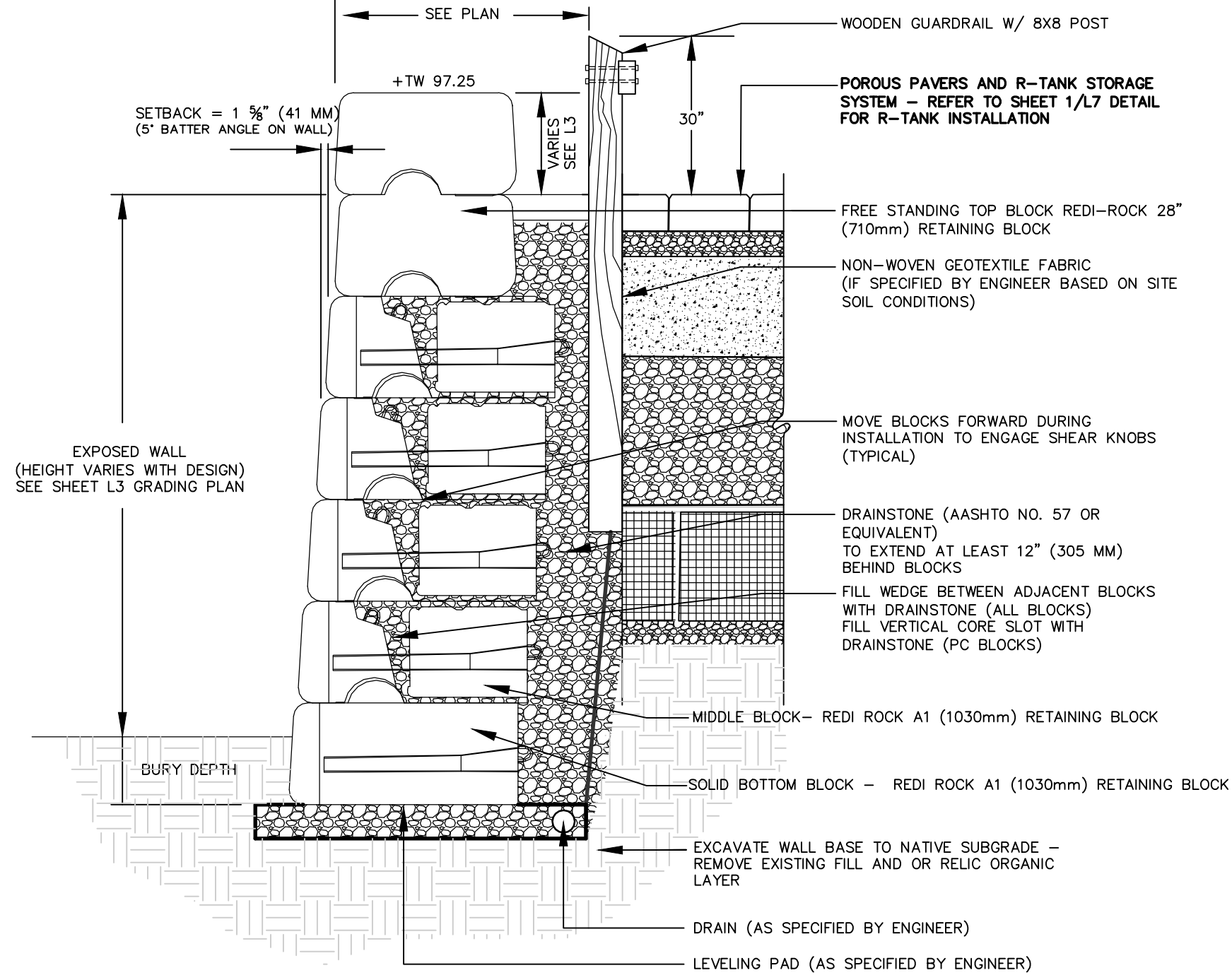

1 REDI-ROCK RETAINING WALL WITH GUARDRAIL
NOT TO SCALE

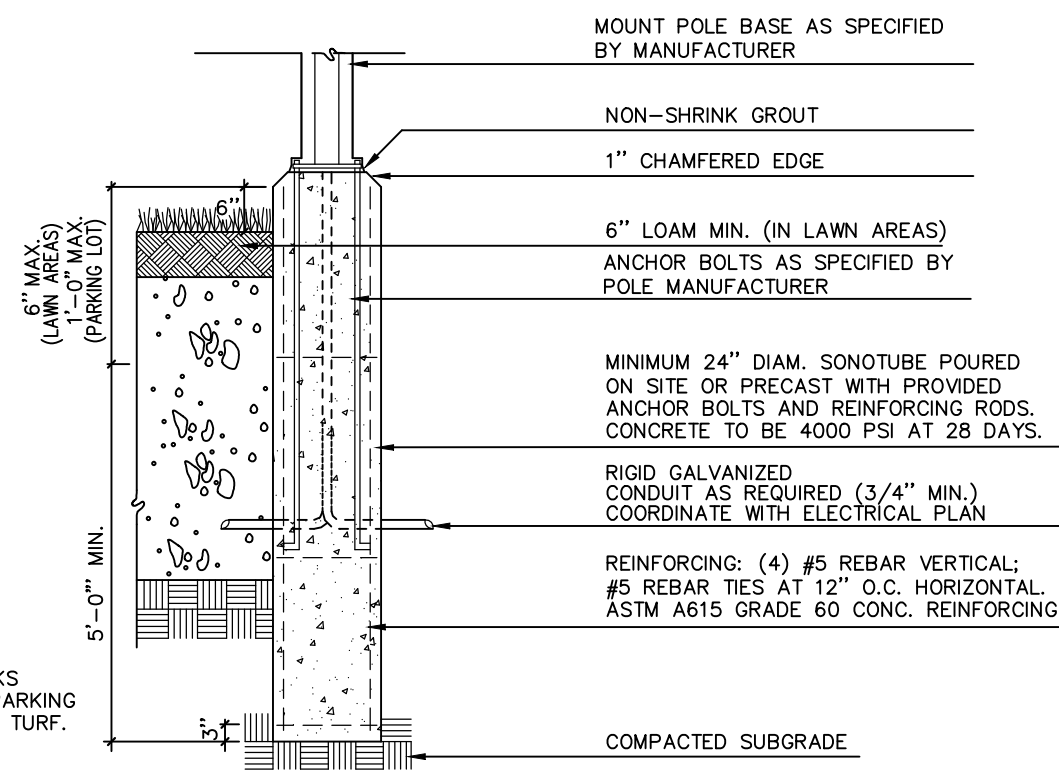

NOTES:
1. POLES MOUNTED IN PARKING AREAS SHALL HAVE A CONCRETE BASE SET 1'-0\"/>

2 LIGHT POLE BASE
NOT TO SCALE

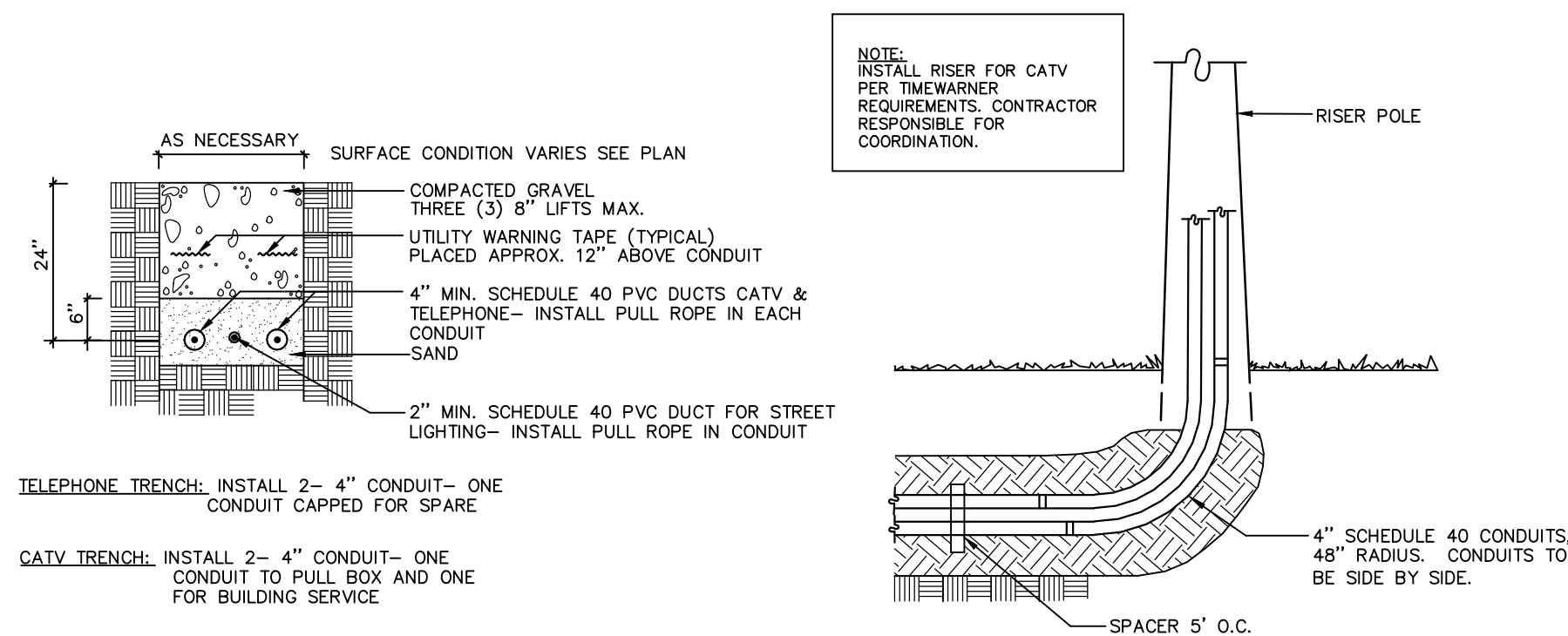

3 TELEPHONE / CABLE T.V. & STREET LIGHTING TRENCH
NOT TO SCALE

NOTES:
1. LOCATIONS AND ELEVATIONS OF STUBS ON THE PLANS ARE TO BE CONSIDERED AS APPROXIMATE AND MAY BE ADJUSTED AS DIRECTED TO SUIT FIELD CONDITIONS.
2. HOUSE CONNECTIONS AND CATCH BASIN CONNECTIONS TO BE MAIN LINE OF THE SEWER, SHALL CONSIST OF AN APPROPRIATE 'Y' BRANCH CONNECTION AS SHOWN ON THE PLANS, OR AS DIRECTED. ACTUAL 'Y' LOCATIONS FOR THE HOUSE CONNECTIONS AND CATCH BASIN CONNECTIONS SHALL BE DETERMINED DURING CONSTRUCTION. THE CONTRACTOR SHALL KEEP A COMPLETE RECORD OF 'Y' LOCATIONS WHICH SHALL BE GIVEN TO THE CITY OF PORTLAND UPON COMPLETION OF THE CONTRACT. ALL PVC TO PVC COUPLING SHALL BE 'SOLID PVC COUPLINGS'.

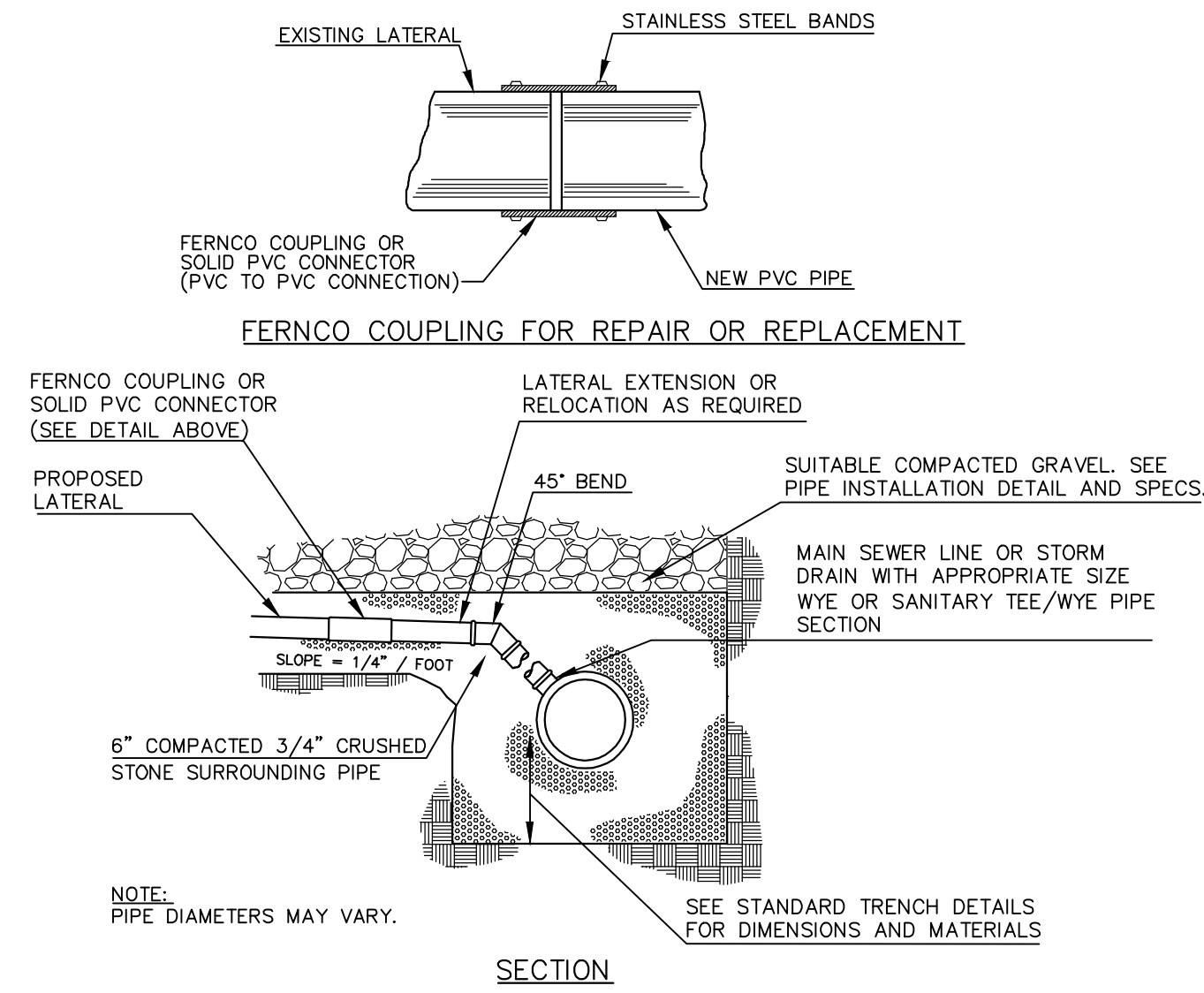

5 TYPICAL LATERAL WYE CONNECTION DETAIL
NOT TO SCALE

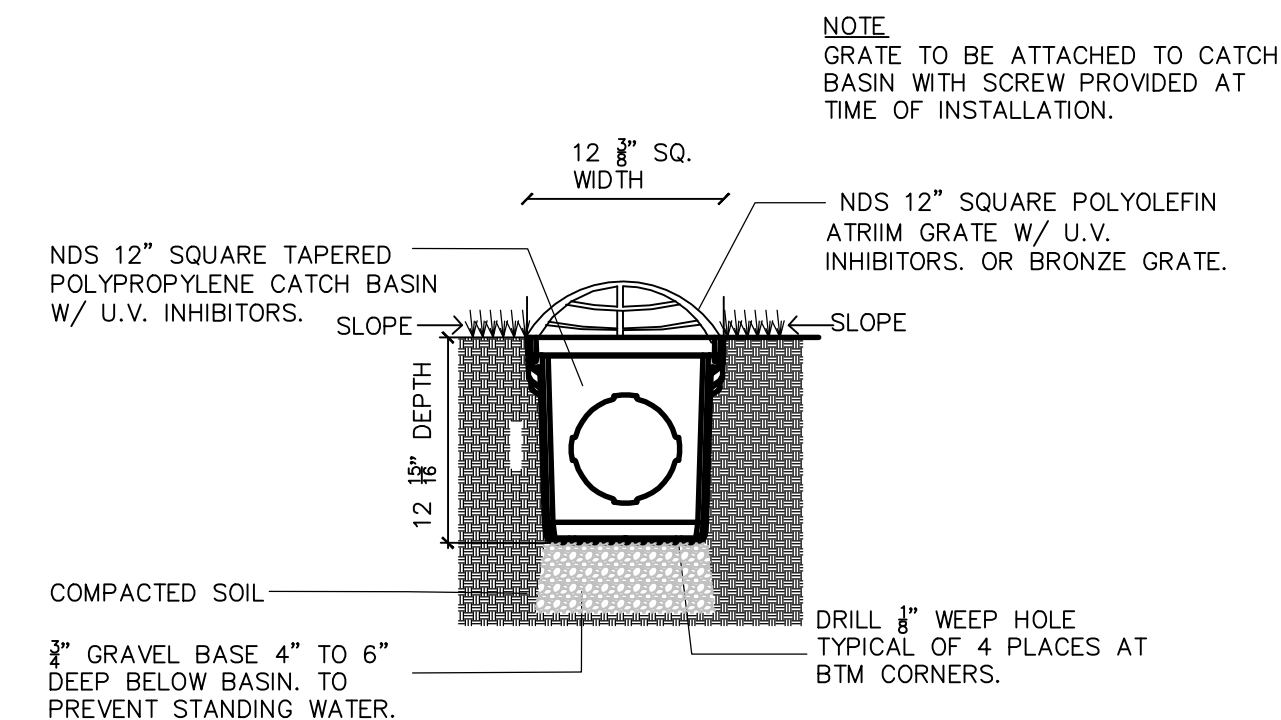

6 NDS 12" SQ. SHALLOW CATCHBASIN
NOT TO SCALE

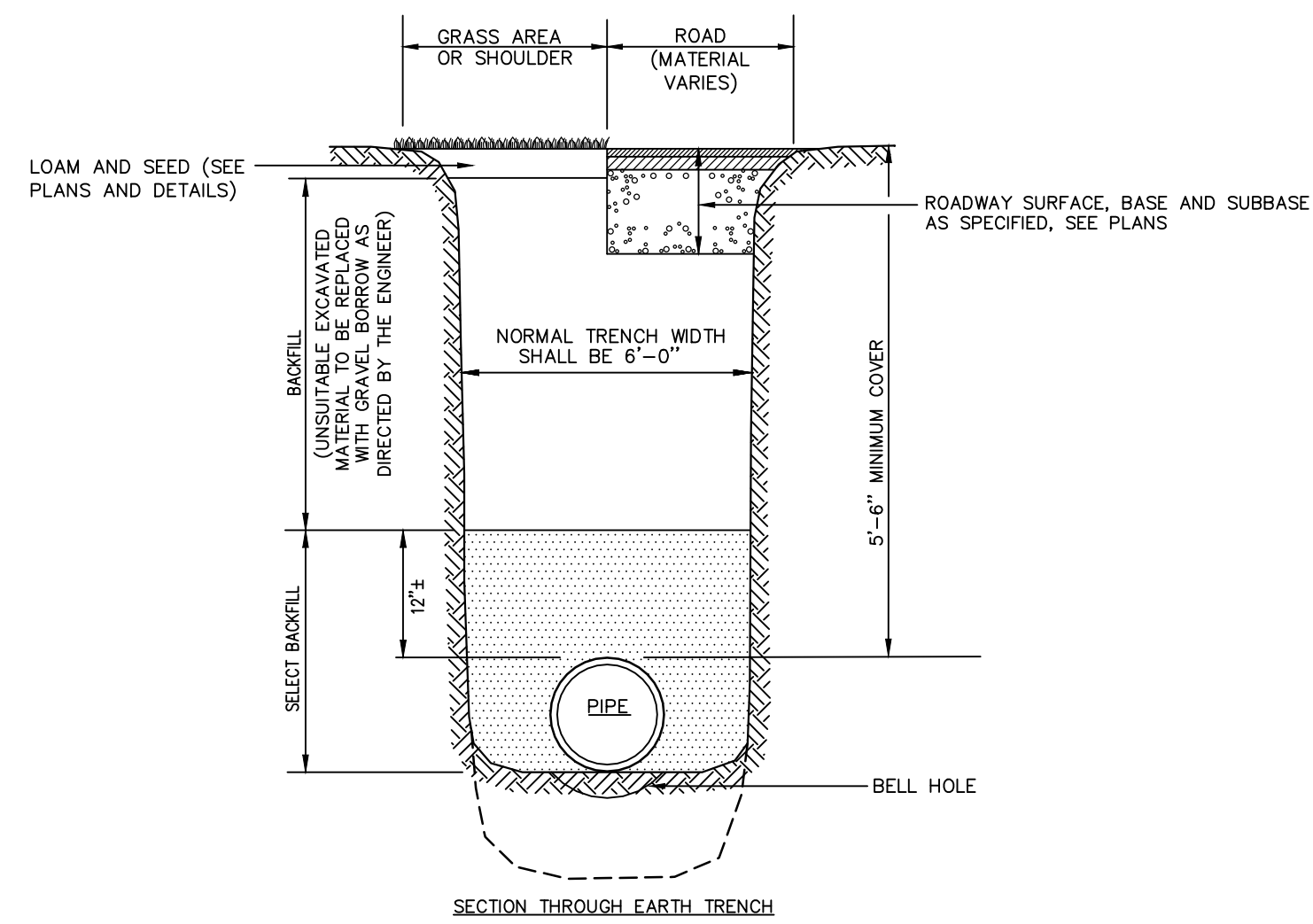

7 PORTLAND WATER DISTRICT PIPE TRENCH DETAIL
NOT TO SCALE

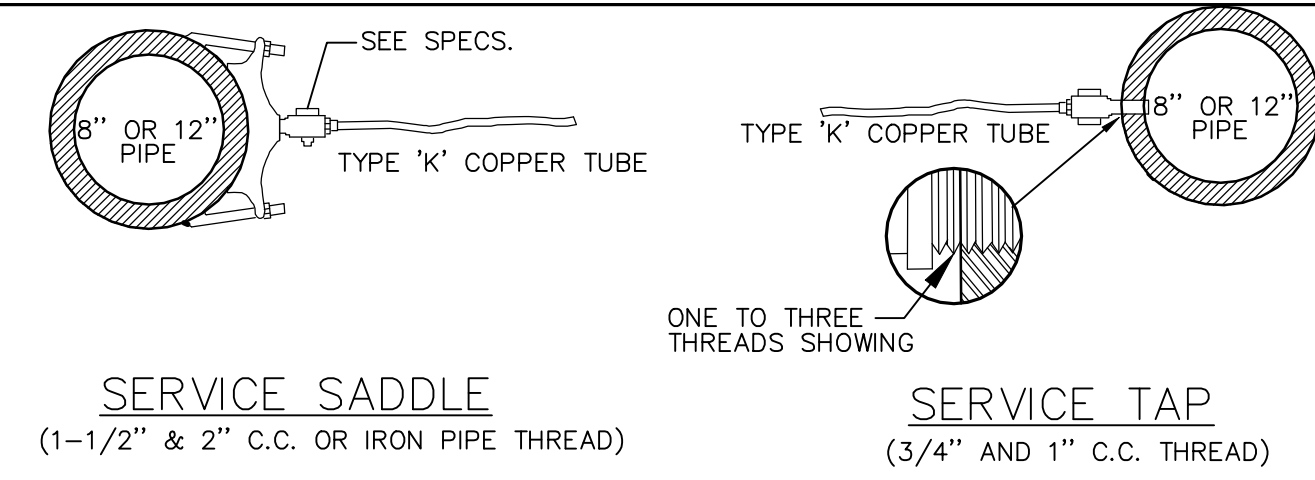

8 TYPICAL RESIDENTIAL WATER SERVICE CONNECTION
NOT TO SCALE

PIPE SIZE (IN)	TEE 90	45	22 1/2	11 1/4
2	1.0	1.0	1.0	1.0
3	1.0	1.0	1.0	1.0
4	1.2	1.0	1.0	1.0
6	2.6	1.4	1.0	1.0
8	4.6	2.5	1.4	1.0
10	7.2	3.9	2.0	1.0
12	10.4	5.6	2.8	1.5
14	14.2	7.7	3.9	2.0
16	18.5	10.0	5.0	2.5
18	23.4	12.7	6.4	3.3

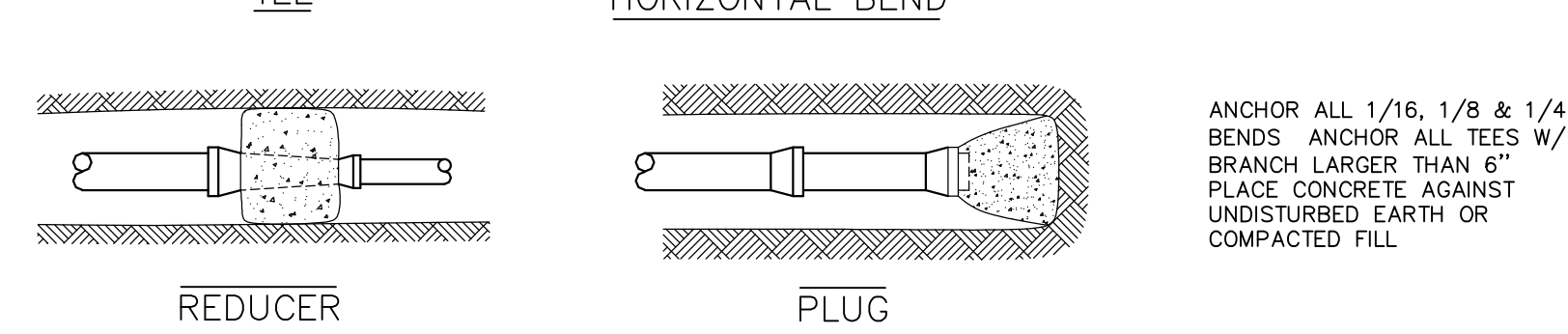

9 WATER MAIN ANCORAGE DETAILS
NOT TO SCALE

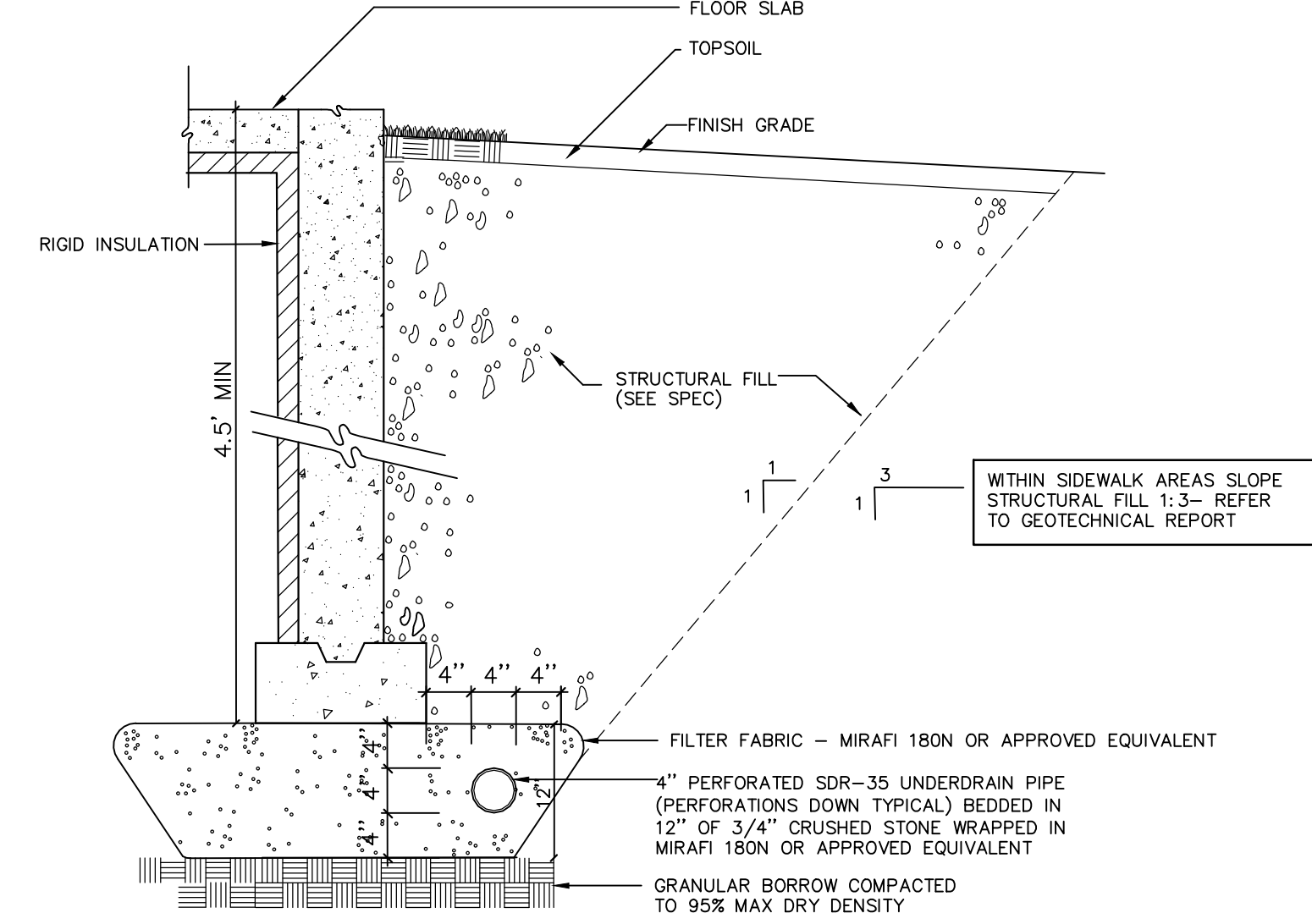

10 FOUNDATION UNDERDRAIN
NOT TO SCALE

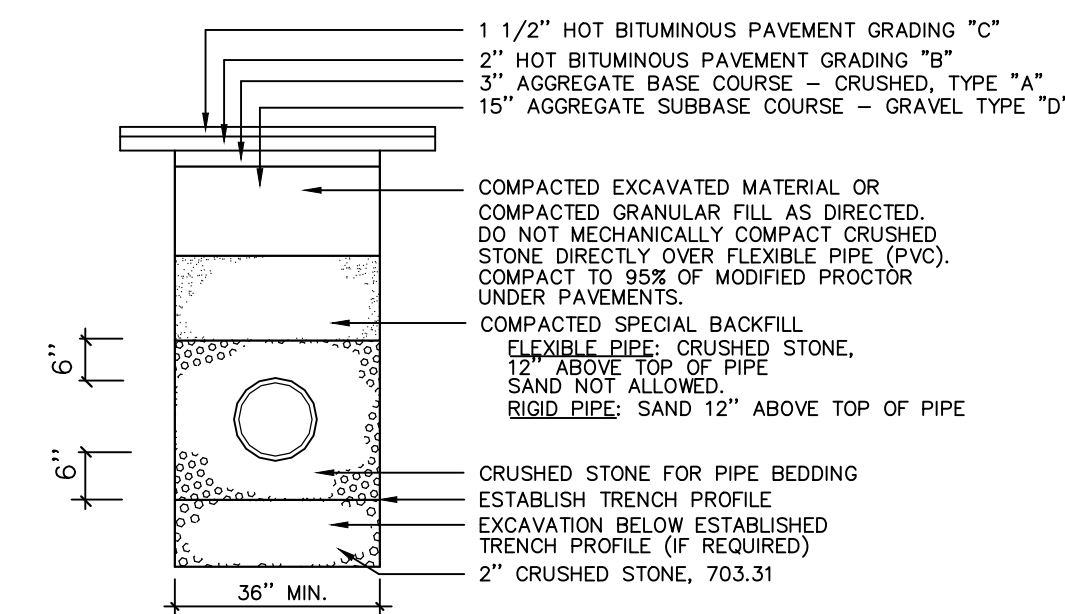

NOTES:
ANY ALTERNATE TRENCHING METHODS SHALL BE APPROVED IN ADVANCE BY THE CITY.
ALL TRENCH DIMENSIONS SHALL BE IN CONFORMANCE WITH THE CITY OF PORTLAND'S DETAIL FIGURE I-13 OF THE TECHNICAL AND DESIGN STANDARDS AND GUIDELINES.

11 PIPE TRENCH DETAIL
NOT TO SCALE

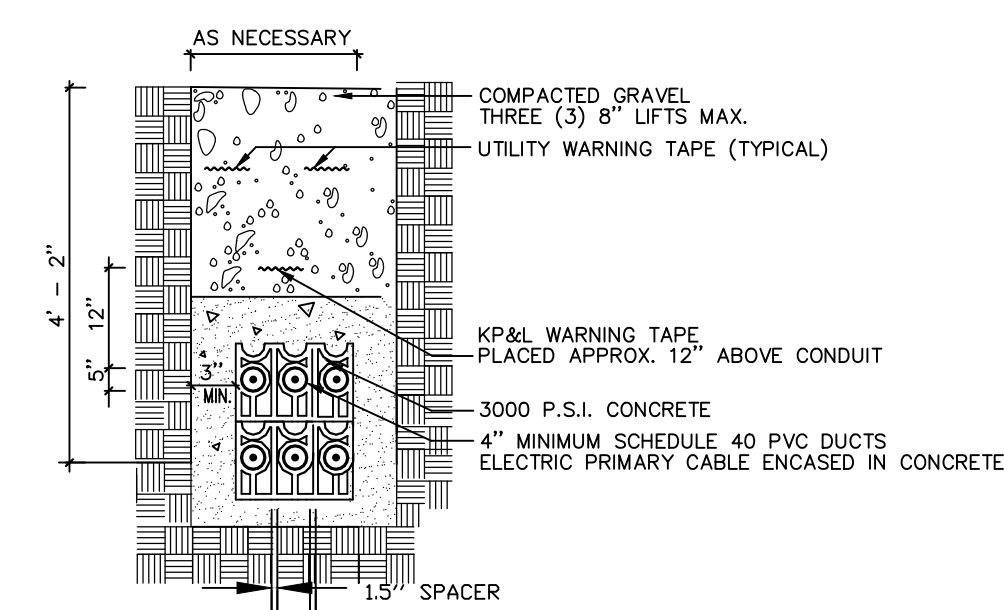

12 ELECTRIC TRENCH
NOT TO SCALE

Prepared For:
Owner:
AVESTA BISHOP STREET LP
307 Cumberland Avenue
Portland, Maine 04101
Tel: 207-553-7777

Prepared By:
MITCHELL & ASSOCIATES
Landscape Architects
The Staples School
70 Center Street
Portland, Maine 04101
Tel: 207-774-4427

72 BISHOP STREET
Portland, Maine
Bishop Street

Date:
APRIL 10, 2015

Issued For:
ISSUED FOR PERMITTING

Revisions:
Rev: 5/22/15
Rev: 6/22/15
Rev: 12/23/15
Rev: 02/05/16
conditions of approval

Reproduction or reuse of this document without the expressed written consent of Mitchell & Associates is prohibited.
© 2014

Title:
SITE DETAILS

Scale:
AS SHOWN

North CITY OF PORTLAND
APPROVED SITE PLAN
Subject to Conditions of Approval
and Standard Conditions
L6

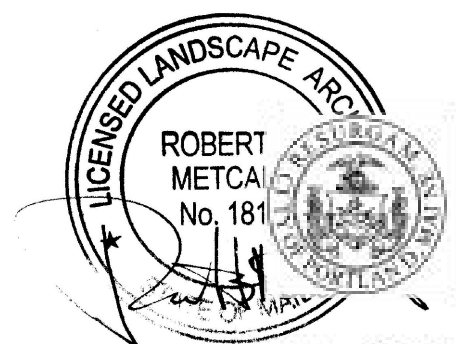

DATE OF APPROVAL: 7/14/2015
PLANNER: Nell Donaldson
PROJECT NO.: 2015-060