

IBC 2003 CODE DATA		
FIRST FLOOR AREA	7,016 SF	
SECOND FLOOR AREA	5,932 SF	
NUMBER OF STORIES	2 STORIES	
TYPE OF CONSTRUCTION - TABLE 601	VB	
USE AND OCCUPANCY CLASSIFICATION - SECTION 304.1	BUSINESS B	RESIDENTIAL R-4
AREA OF EACH USE	7,016 SF	5,932 SF
BUILDING HEIGHT LIMITATION - TABLE 503	2 STORIES	2 STORIES
BUILDING AREA LIMITATION PER FLOOR - TABLE 503	9,000 SF	7,000 SF
INCREASED AREA ALLOWED BY SPRINKLER SYSTEM	27,000 SF	21,000 SF
OCCUPANT LOAD	71	30
MAX. EXIT TRAVEL DISTANCE - TABLE 1015.1	300 FEET	250 FEET
ACTUAL EXIT TRAVEL DISTANCE	120 FEET	90 FEET
MINIMUM NUMBER OF EXITS - TABLE 1018.2	2	2
FIRE RESISTANT CONSTRUCTION:		
FIRE WALLS AND PARTY WALLS	N/A	N/A
STAIR ENCLOSURES	1 HR	1 HR
SHAFTS	1 HR	1 HR
EXIT ACCESS CORRIDORS	N/A	N/A
INTERIOR LOAD BEARING WALLS	N/A	N/A
STRUCTURAL MEMBER SUPPORTING WALLS	N/A	N/A
FLOOR CONSTRUCTION	N/A	N/A
ROOF CONSTRUCTION	N/A	N/A
INCIDENTAL SPACES	N/A	N/A
ACCESSORY USE	N/A	N/A
FIRE EXTINGUISHERS	AS SHOWN	
NOTES	1. UNSEPARATED MIXED USE. 2. AUTOMATIC, SUPERVISED SPRINKLER SYSTEM COVERING ENTIRE BUILDING. 3. FIRE ALARM SYSTEM COVERING ENTIRE BUILDING, WITH SLEEPING ROOM SMOKE DETECTORS.	

NFPA 101 2006 CODE DATA		
FIRST FLOOR AREA	7,016 SF	
SECOND FLOOR AREA	5,932 SF	
NUMBER OF STORIES	2 STORIES	
TYPE OF CONSTRUCTION - NFPA 220	V-000	
OCCUPANCY CLASSIFICATION - SECTION 3.3.152	BUSINESS	RESIDENTIAL BOARD & CARE
AREA OF EACH USE	7,016 SF	5,932 SF
OCCUPANT LOAD	71	30
MAX. EXIT TRAVEL DISTANCE	300 FEET	250 FEET
ACTUAL EXIT TRAVEL DISTANCE	120 FEET	90 FEET
MINIMUM NUMBER OF EXITS	2	2
FIRE RESISTANT CONSTRUCTION:		
FIRE WALLS AND PARTY WALLS	N/A	N/A
STAIR ENCLOSURES	1 HR	N/A
SHAFTS	1 HR	N/A
EXIT ACCESS CORRIDORS	N/A	N/A
INTERIOR LOAD BEARING WALLS	N/A	N/A
STRUCTURAL MEMBER SUPPORTING WALLS	N/A	N/A
FLOOR CONSTRUCTION	N/A	N/A
ROOF CONSTRUCTION	N/A	N/A
INCIDENTAL SPACES	N/A	N/A
ACCESSORY USE	N/A	N/A
FIRE EXTINGUISHERS	AS SHOWN	
NOTES	1. UNSEPARATED MIXED USE. 2. AUTOMATIC, SUPERVISED SPRINKLER SYSTEM COVERING ENTIRE BUILDING. 3. FIRE ALARM SYSTEM COVERING ENTIRE BUILDING, WITH SLEEPING ROOM SMOKE DETECTORS.	

DRAWING LIST

ARCHITECTURAL

- G1 Title Sheet
- D1 Demolition Plan
- D2 Ceiling Demolition Plan
- A1 Floor Plan
- A2 Reflected Ceiling Plan
- A3 Second Floor Plan
- A4 Finish and Door Schedules
- A5 Interior Elevations and Details

MECHANICAL

- M1 First Floor Mechanical Plan
- M2 Second Floor Mechanical Plan
- M3 Mechanical Equipment Schedules & Details

PLUMBING

- P1 Basement Plumbing Plan
- P2 First Floor Plumbing Plan
- P3 Plumbing Schedules & Details
- SP1 First Floor Sprinkler Plan

ELECTRICAL

- E0 Electrical Legend and General Notes
- E1 Electrical Demolition Plan
- E2 Electrical Power and Systems Plan
- E3 Electrical Lighting and Fire Alarm Plan
- E4 Electrical Panel Schedules and Riser Diagram

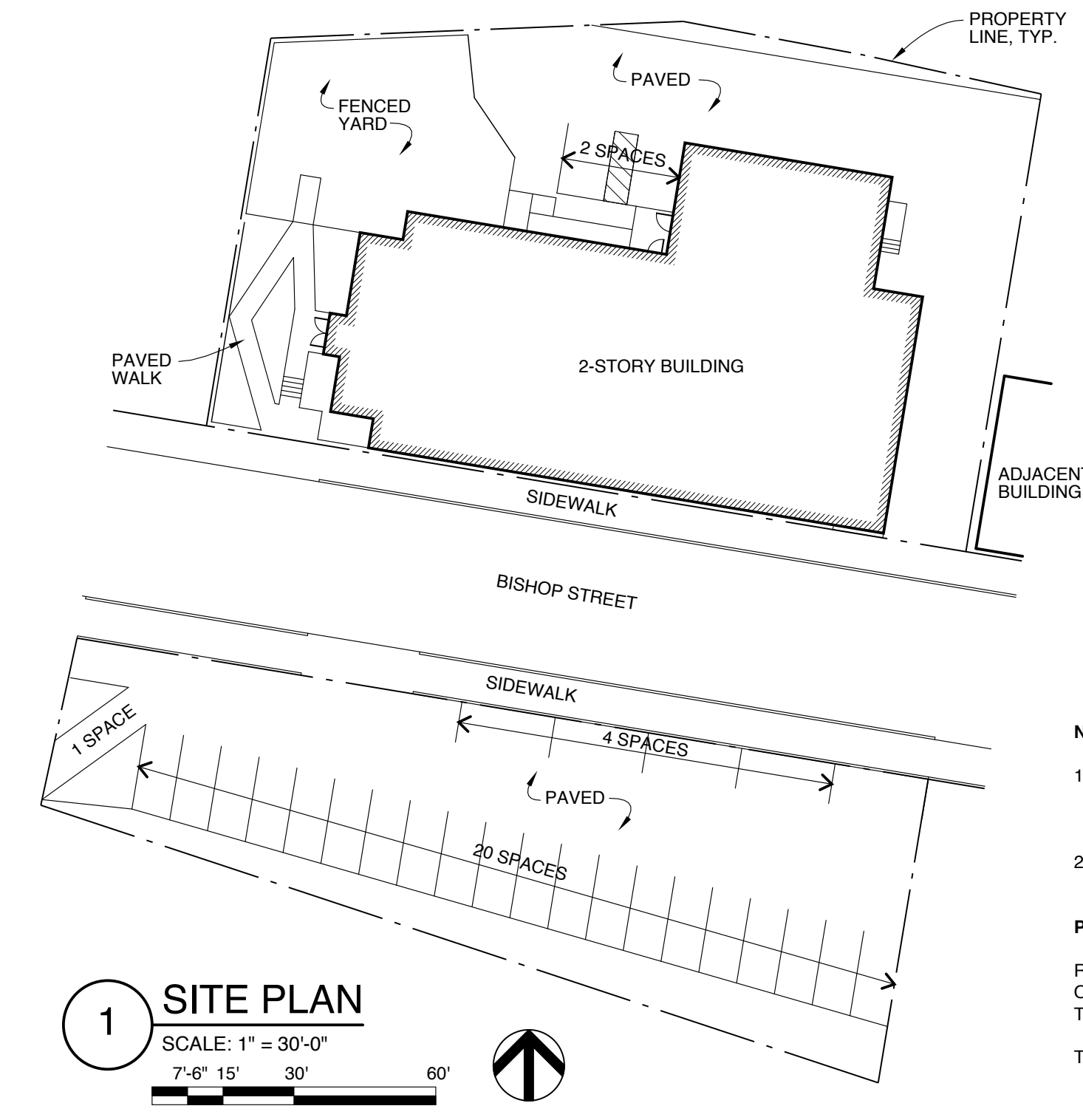

NOTES:

1. PLAN BASED ON DEED DESCRIPTION AND FIELD MEASUREMENTS.
2. ALL CONDITIONS SHOWN ARE EXISTING TO REMAIN.

PARKING

RESIDENTIAL: 2 UNITS	2
OFFICE & PROFESSIONAL:	21
TOTAL REQUIRED:	23
TOTAL EXISTING:	27

Michael Charek Architects

25 Hartley Street
Portland, Maine 04103
(207) 761-0556

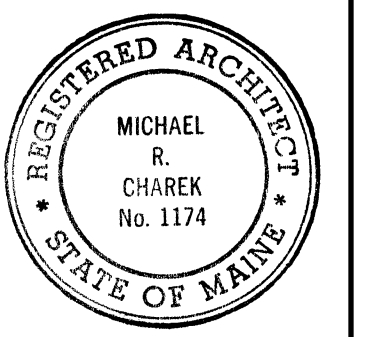

Spurwink Bishop Street

17 Bishop Street
Portland, ME 04103

Spurwink Bishop Street

17 Bishop Street
Portland, ME 04103

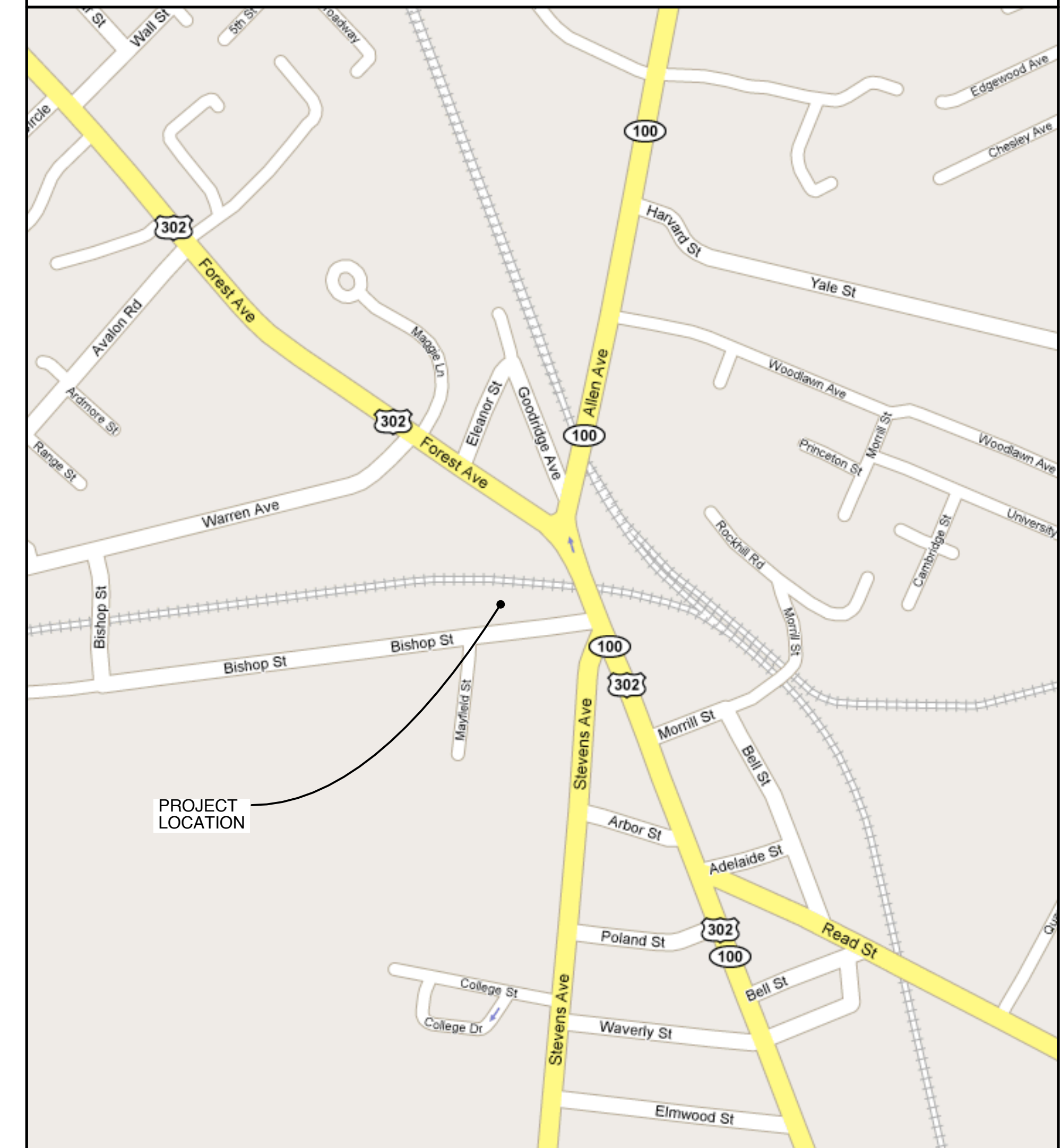

LOCATION MAP

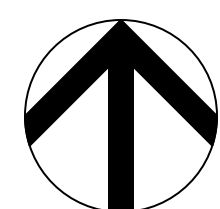

Title

COVER SHEET

Scale: AS NOTED

Date: 3/4/09

Revisions

ISSUED FOR PERMIT

Sheet

G1