

DEMOLITION GENERAL NOTES

- A. ITEMS INDICATED TO BE REMOVED AND SALVAGED WILL REMAIN OWNER'S PROPERTY. REMOVE, CLEAN, AND DELIVER TO OWNER'S DESIGNATED STORAGE AREA.
- B. COMPLY WITH EPA REGULATIONS AND HAULING AND DISPOSAL REGULATIONS OF AUTHORITIES HAVING JURISDICTION.
- C. OWNER WILL OCCUPY PORTIONS OF BUILDING IMMEDIATELY ADJACENT TO SELECTIVE DEMOLITION AREA. CONDUCT SELECTIVE DEMOLITION SO OWNER'S OPERATIONS WILL NOT BE DISRUPTED.
- D. IT IS NOT EXPECTED THAT HAZARDOUS MATERIALS WILL BE ENCOUNTERED IN THE WORK. IF MATERIALS SUSPECTED OF CONTAINING HAZARDOUS MATERIALS ARE ENCOUNTERED, DO NOT DISTURB; IMMEDIATELY NOTIFY ARCHITECT AND OWNER. OWNER WILL REMOVE HAZARDOUS MATERIALS UNDER A SEPARATE CONTRACT.
- E. MAINTAIN SERVICES/SYSTEMS INDICATED TO REMAIN AND PROTECT THEM AGAINST DAMAGE DURING SELECTIVE DEMOLITION OPERATIONS. BEFORE PROCEEDING WITH DEMOLITION, PROVIDE TEMPORARY SERVICES/SYSTEMS THAT BYPASS AREA OF SELECTIVE DEMOLITION AND THAT MAINTAIN CONTINUITY OF SERVICES/SYSTEMS TO OTHER PARTS OF THE BUILDING.
- F. LOCATE, IDENTIFY, SHUT OFF, DISCONNECT, AND CAP OFF UTILITY SERVICES AND MECHANICAL/ELECTRICAL SYSTEMS SERVING AREAS TO BE SELECTIVELY DEMOLISHED.
- G. PROVIDE TEMPORARY BARRICADES AND OTHER PROTECTION REQUIRED TO PREVENT INJURY TO PEOPLE AND DAMAGE TO ADJACENT BUILDINGS AND FACILITIES TO REMAIN.
- H. PROVIDE AND MAINTAIN SHORING, BRACING, AND STRUCTURAL SUPPORTS AS REQUIRED TO PRESERVE STABILITY AND PREVENT MOVEMENT, SETTLEMENT, OR COLLAPSE OF CONSTRUCTION AND FINISHES TO REMAIN OR CONSTRUCTION BEING DEMOLISHED.

- I. PROVIDE TEMPORARY WEATHER PROTECTION TO PREVENT WATER LEAKAGE AND DAMAGE TO STRUCTURE AND INTERIOR AREAS.
- J. PROTECT WALLS, CEILINGS, FLOORS, AND OTHER EXISTING FINISH WORK THAT ARE TO REMAIN. ERECT AND MAINTAIN DUSTPROOF PARTITIONS. COVER AND PROTECT FURNITURE, FURNISHINGS, AND EQUIPMENT THAT HAVE NOT BEEN REMOVED.
- K. NEATLY CUT OPENINGS AND HOLES PLUMB, SQUARE, AND TRUE TO DIMENSIONS REQUIRED. USE CUTTING METHODS LEAST LIKELY TO DAMAGE CONSTRUCTION TO REMAIN OR ADJOINING CONSTRUCTION.
- L. PROMPTLY REMOVE DEMOLISHED MATERIALS FROM OWNER'S PROPERTY AND LEGALLY DISPOSE OF THEM. DO NOT BURN DEMOLISHED MATERIALS.
- M. ITEMS TO BE REMOVED:
 1. FINISH FLOORING DOWN TO UNDERLAYMENT THROUGHOUT WORK AREA.
 2. SPECIFIC ITEMS AS INDICATED BY KEYNOTE AND LEGEND.
 3. EXISTING DOORS & FRAMES ARE TO BE REMOVED AS INDICATED AND SAVED FOR REUSE. SEE DOOR SCHEDULE FOR SPECIFIC LOCATIONS OF REUSED DOORS & FRAMES.
- N. SEE CEILING DEMOLITION PLAN FOR CEILING WORK.
- O. SEE MECHANICAL AND ELECTRICAL DRAWINGS FOR DEMOLITION WORK ON MECHANICAL AND ELECTRICAL SYSTEMS.

DEMOLITION PLAN KEYNOTES

- D001 REMOVE DOOR & FRAME
- D002 REMOVE PARTITION
- D003 CUT DOOR OPENING IN GWB PARTITION
- D004 CUT DOOR OPENING IN WOOD FRAME WALL
- D005 REMOVE FINISH FLOOR TO THIS LINE
- D006 REMOVE C.T. FLOORING TO JOINT AT THIS LINE
- D007 REMOVE PLUMBING FIXTURES
- D008 REMOVE CASEWORK
- D009 REMOVE LOUVER

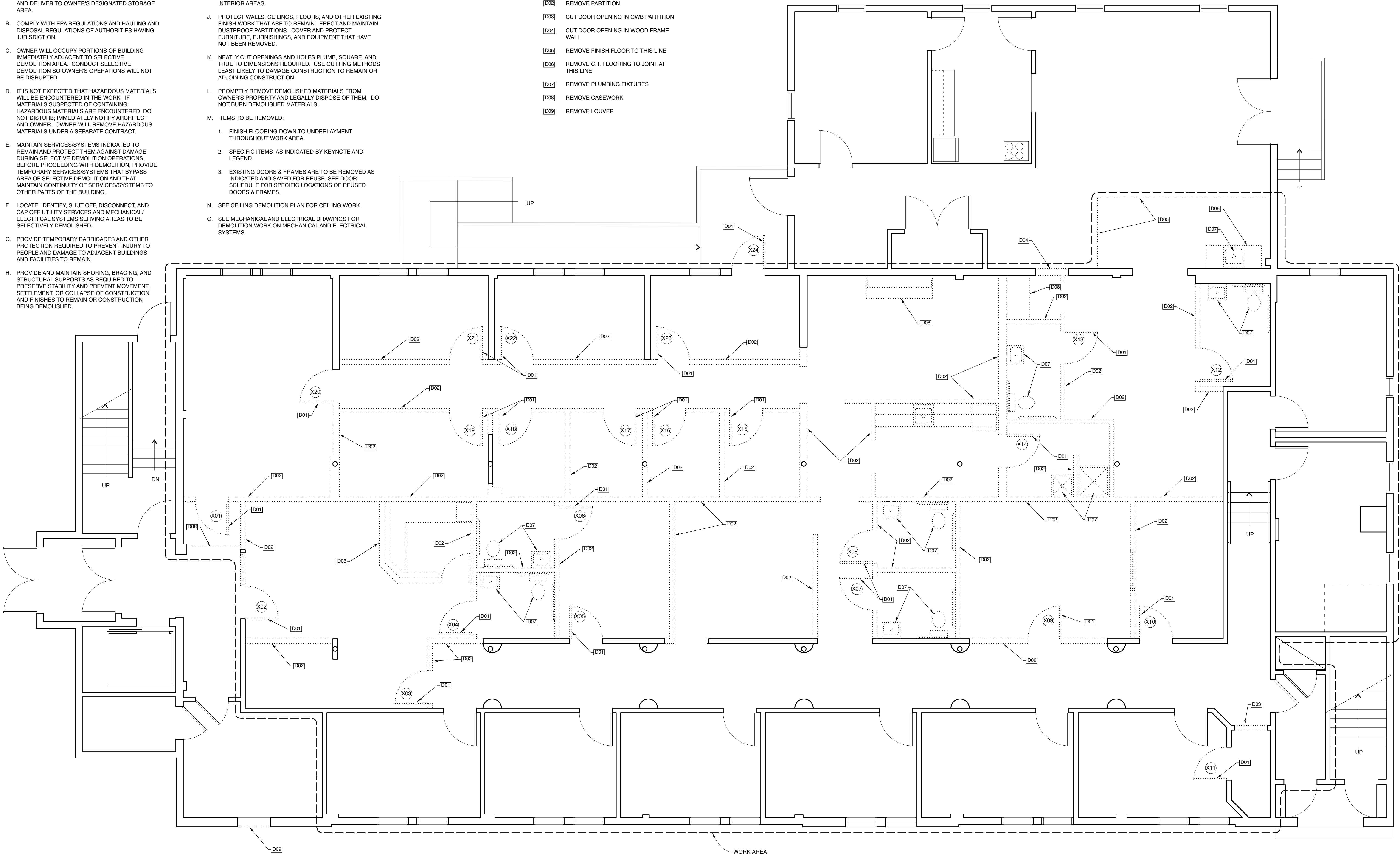

1 FIRST FLOOR DEMOLITION PLAN

SCALE: 1/4" = 1'-0"
 1" 2" 4" 8"

PARTITIONS/WALLS KEY

- EXISTING TO REMAIN
- - - EXISTING TO BE REMOVED

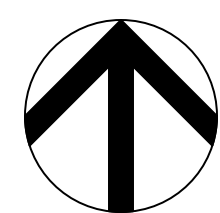

Michael Charek Architects

25 Hartley Street
 Portland, Maine 04103
 (207) 761-0556

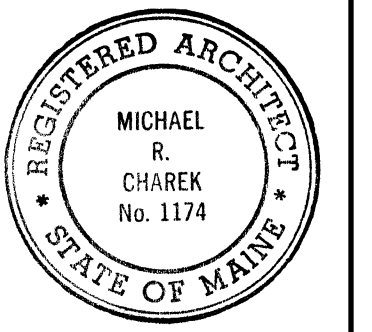

Spurwink Bishop Street

17 Bishop Street
 Portland, ME 04103

Title

FIRST FLOOR
 DEMOLITION
 PLAN

Scale: 1/4" = 1'-0"

Date: 3/4/09

Revisions

ISSUED FOR PERMIT

Sheet

D1