

NOTES:

1. SEE DRAWING E0 FOR GENERAL NOTES AND LEGEND.
2. INTENT OF THIS DESIGN IS TO ELIMINATE ALL POWER WIRING ON THE FIRST FLOOR THAT IS LOCATED ABOVE HUNG CEILING. FURNISH NEW CIRCUIT WIRING IN MC CABLE ASSEMBLIES FOR OFFICES 132 AND 133 TO EXISTING DEVICES.
3. ALL RECEPTACLES IN BEDROOMS, LIVING ROOMS, HALLWAYS, AND SENSORI SPACES SHALL BE FINISHED WITH AFC-F-AULT AND TAMPER RESISTANT TYPE AS PER NEC.

KEYED NOTES:

- ① MOUNT RECEPTACLE 6" ABOVE COUNTER TOP. COORDINATE WITH CASEWORK.
- ② REINSTALL ELECTRICAL PANEL ON WALL. REROUTE EXISTING WIRING AND RE-TERMINATE AT BREAKERS. STOVE TOP. COORDINATE LOCATION AND NEMA CONFIGURATION OF RECEPTACLE WITH EQUIPMENT FURNISHED.
- ③ OVEN. COORDINATE NEMA CONFIGURATION OF RECEPTACLE WITH EQUIPMENT FURNISHED.
- ④ UNDER COUNTER DISHWASHER.
- ⑤ RELOCATED HVAC UNIT. TO BE MOUNTED ABOVE CEILING.
- ⑥ NEW HVAC UNIT TO BE MOUNTED ABOVE SPACE.
- ⑦ STACKABLE WASHER/DRYER. MOUNT ONE RECEPTACLE AT 18" AFF AND SECOND AT 66" AFF.
- ⑧ EXISTING WATER HEATER TO REMAIN. DISCONNECT AND RECONNECT. IF EXISTING WIRING DOES NOT MEET CURRENT REQUIREMENTS OF NATIONAL ELECTRICAL CODE, REPLACE WIRING BACK TO MDP PANEL IN ELECTRICAL ROOM AND REMOVE ALL EXISTING WIRE.

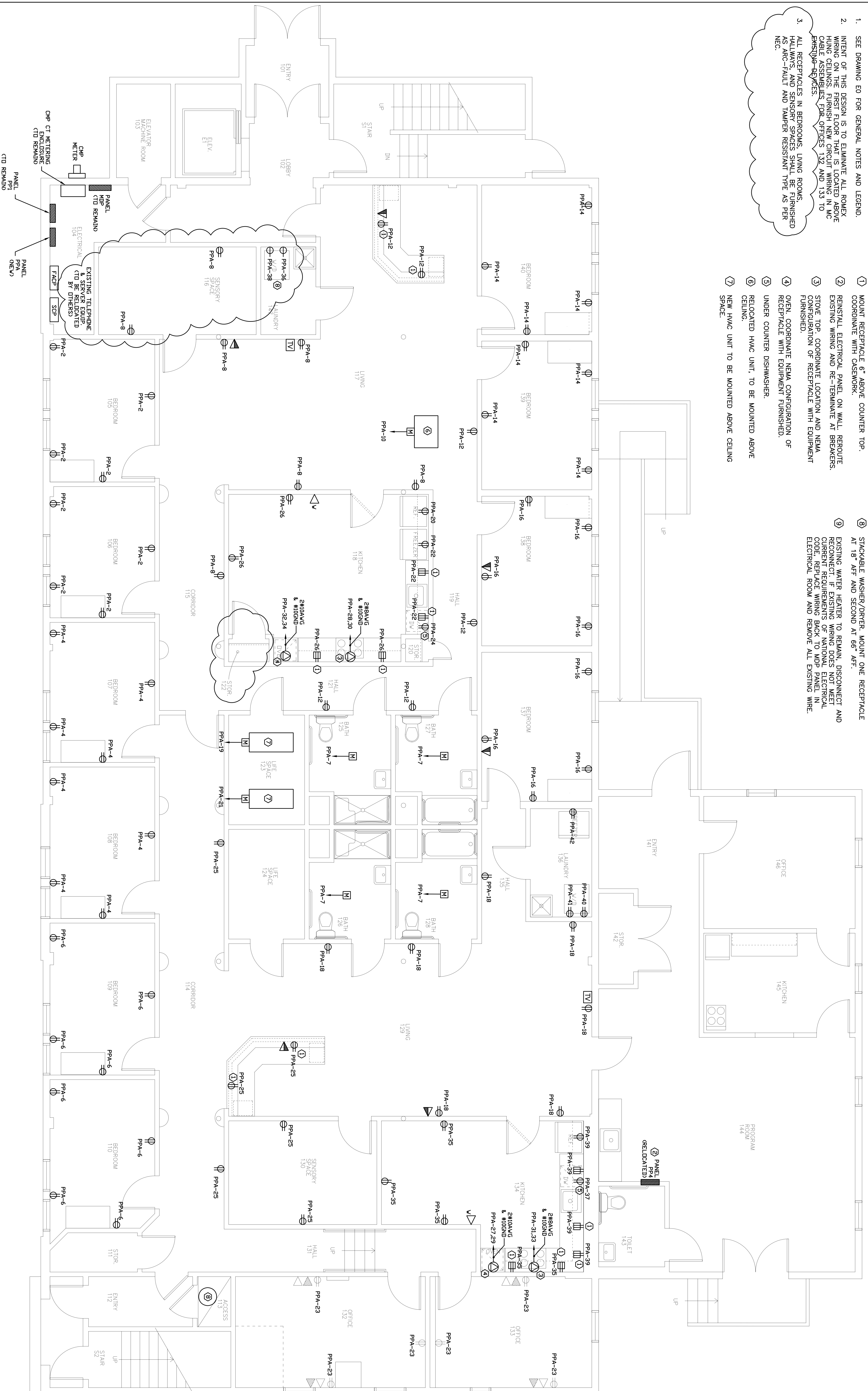

© 2009 Michael R. Charek, Architect

SWIFTCURRENT
 Engineering Services
 273 Main Street
 Yarmouth, ME 04096
 Tel: (207) 847-5280

Sheet	E2
Title	ELECTRICAL POWER AND SYSTEMS PLAN
Scale:	1/4"=1'-0"
Date:	2/6/09
Revisions	
Revision #1	3/16/09

Spurwink
 Bishop Street
 17 Bishop Street
 Portland, Maine 04103

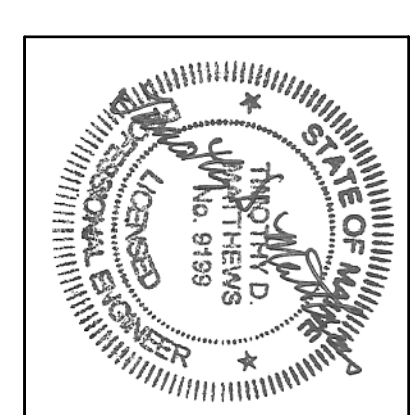

Michael Charek
 Architects
 25 Hartley Street
 Portland, Maine 04103
 (207) 761-0556