

WHIPPLE
 CALLENDER
 ARCHITECTS

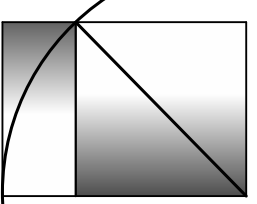

136 PLEASANT AVE.
 PORTLAND, ME 04103
 P 207.775.2696
 F 207.775.3631
 www.whipplecallender.com

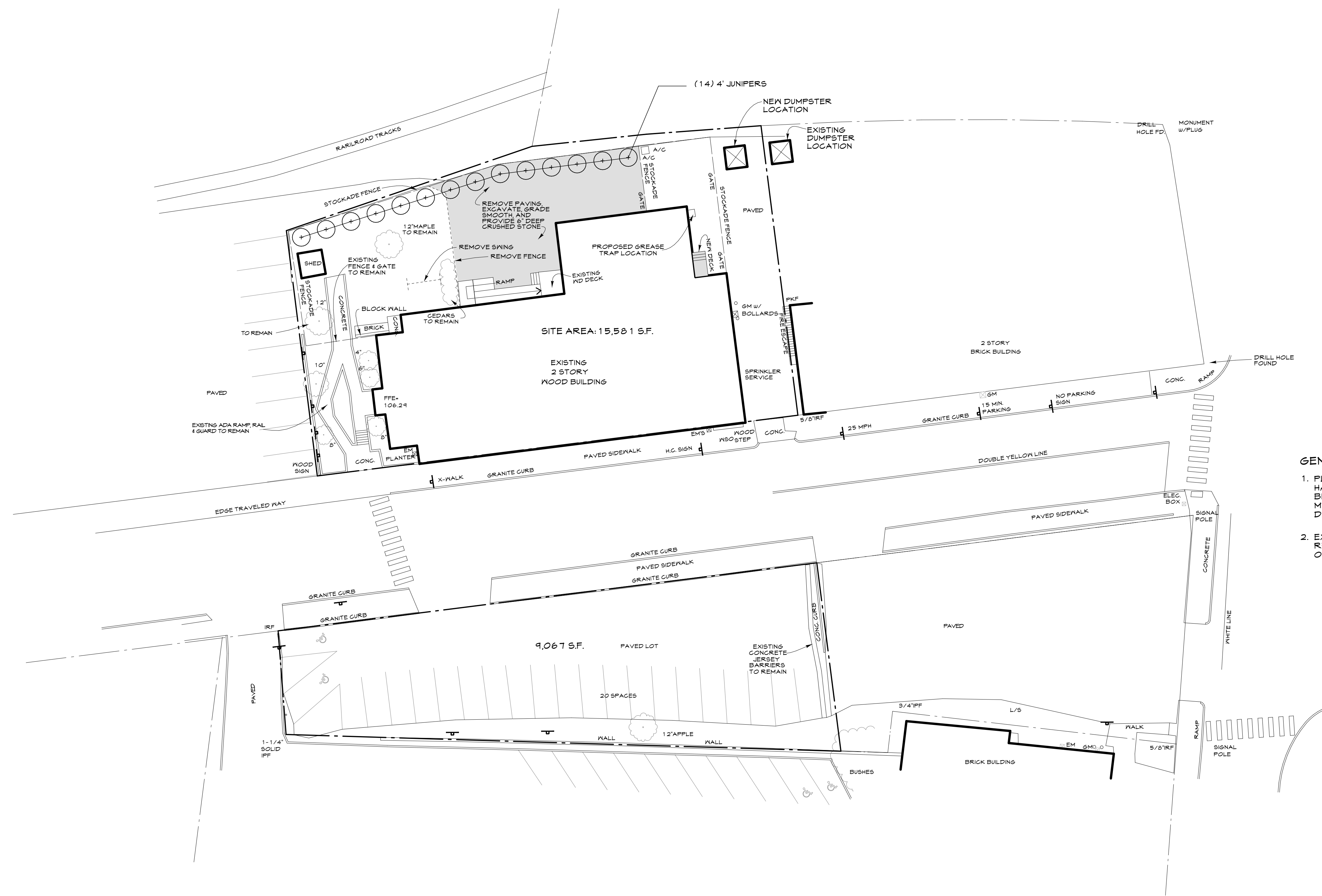

- GENERAL NOTES:**
1. PLAN BASED ON OWEN HASKELL'S SURVEY "12 & #17 BISHOP STREET, PORTLAND, MAINE" DATED 8.2.17
 2. EXISTING CONDITIONS TO REMAIN UNLESS NOTED OTHERWISE

LEGEND

- ELECTRIC METER SIGN
- DECIDUOUS TREE
- CURB
- PROPERTY LINE

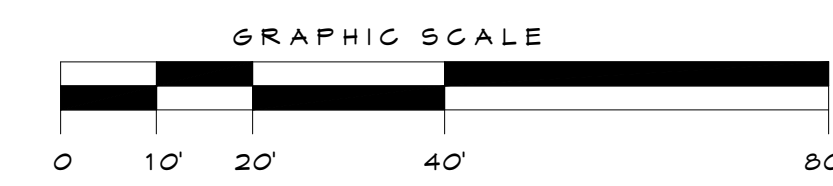

DATE	DESCRIPTION

DATE: 8/31/17
 CHECKED BY: JAD
 DRAWN BY: CJC
 JOB: 2017-BISHOP
 SHEET TITLE:

PROPOSED SITE PLAN