

Railing will be 3ft high with Wood Posts 1 foot apart.

1 Inch = 4 feet

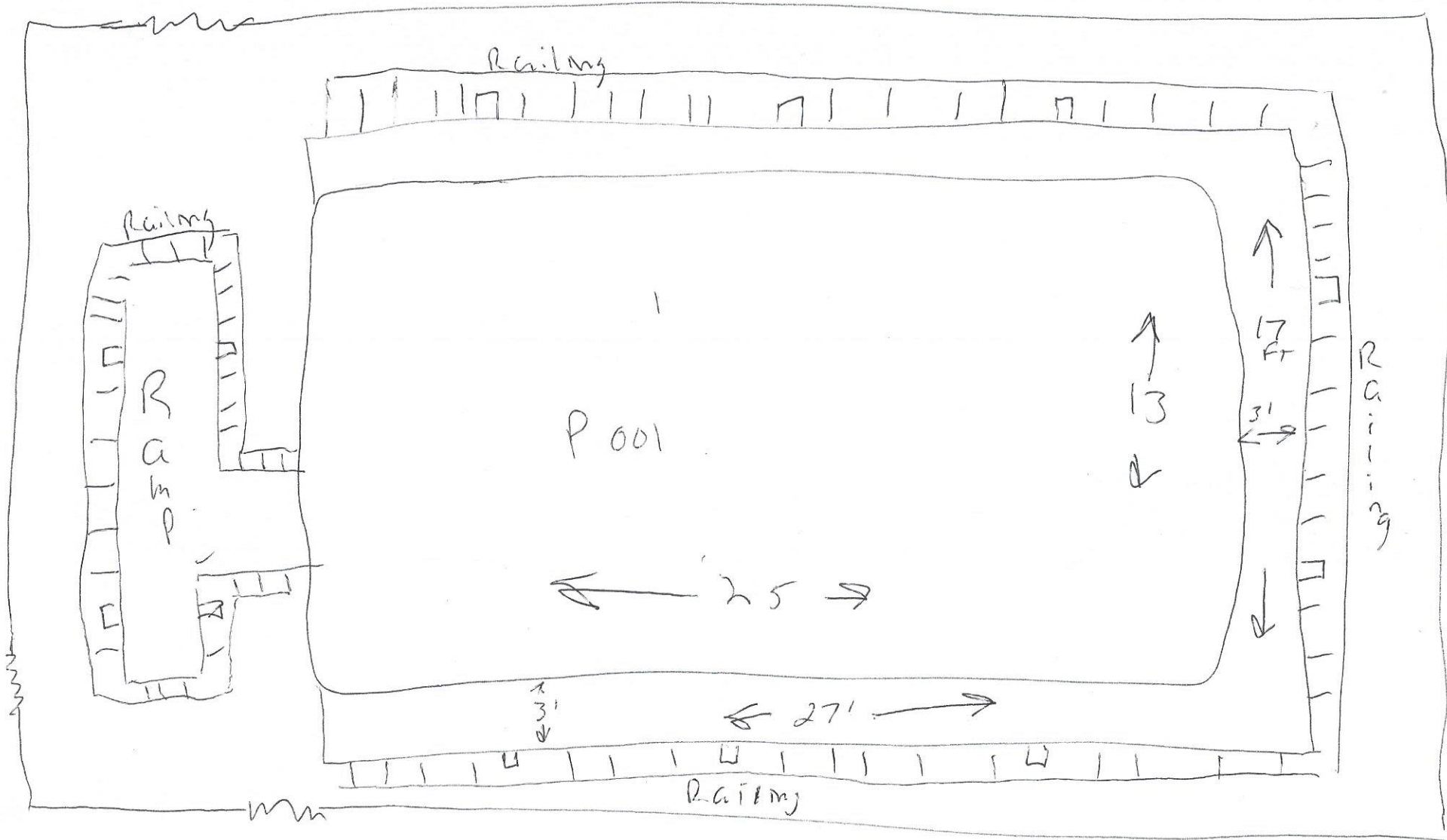

Deck will be constructed of 1x6 pressure treated for the deck surface. post will be 4x4 pressure treated Every 8 feet. materials will be attached by Lag bolts and support post will be tap canned into slab. Deck surface will be attached with standard Deck Bolts. Ramp will have textured surface to prevent slipping.
U = post