

DA2.1  
Drawing Number

Drawing Title:  
**REFLECTED CEILING  
REMOVALS PLANS**  
Scale: 3/8" = 1'-0"  
Date: September 20 2006  
DWG Proj. No.: 06491.dwg

Revisions	Description	Date

Owner:  
**HAPPY TAILS**  
150 ST. JOHN STREET  
PORTLAND, MAINE  
04102  
207-450-0924

Owner:  
**HAPPY TAILS  
DOG CENTER**  
119 BISHOP STREET  
PORTLAND, MAINE 04105

434 Cumberland Avenue  
Portland, ME 04101  
Phone: (207) 774-4441  
Fax: (207) 774-4016  
www.CWSarch.com

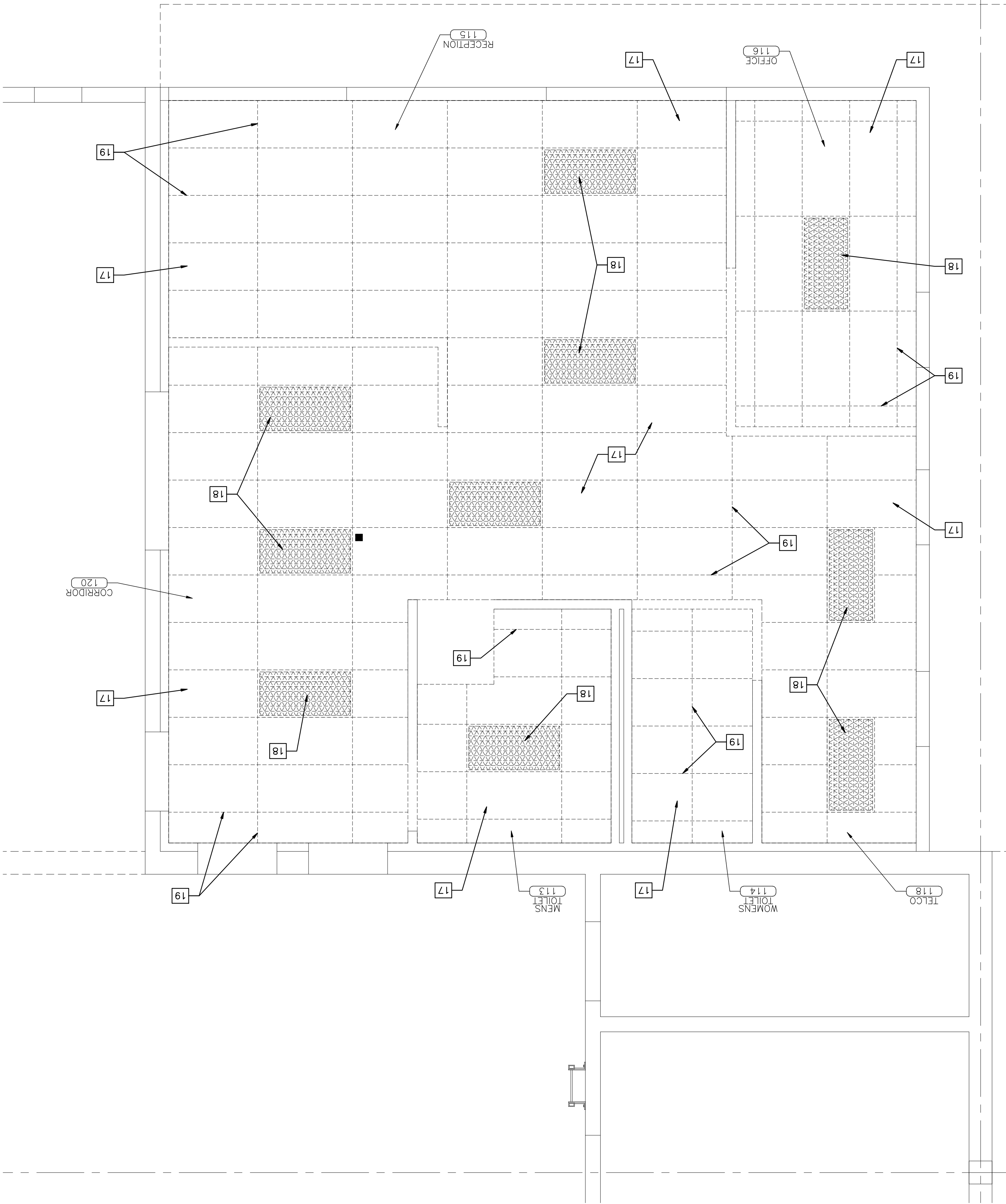
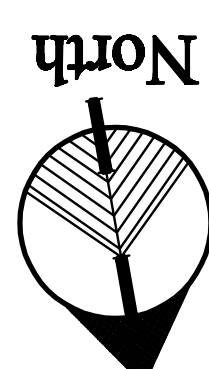

- GENERAL REMOVALS NOTES**
- REMOVE EXISTING BOLLARD ASSEMBLY COMPLETE. PATCH AND REPAIR FLOOR AS REQUIRED TO MATCH EXISTING.
  - REMOVE EXISTING MASONRY WALL ASSEMBLY WITHIN LIMITS SHOWN AND PREPARE OPENING FOR INSTALLATION OF NEW PAIR OF INSULATED HOLLOW METAL DOORS AND DOOR FRAME ASSEMBLY. PROVIDE GALVANIZED STEEL UNTELS AT HEAD CONDITION.
  - REMOVE EXISTING ROLL-UP DOOR ASSEMBLY COMPLETE.
  - REMOVE EXISTING OVERHEAD DOOR ASSEMBLY COMPLETE. PREPARE OPENING AS REQUIRED FOR INSTALLATION OF NEW EXTERIOR WALL ASSEMBLY.
  - REMOVE EXISTING STEEL POST COMPLETE. PATCH AND REPAIR FLOOR AS REQUIRED TO MATCH EXISTING.
  - REMOVE EXISTING WINDOW ASSEMBLY COMPLETE. REMOVE EXISTING MASONRY WALL ASSEMBLY COMPLETE BELOW EXISTING WINDOW. PREPARE OPENING FOR INSTALLATION OF NEW DOOR AND DOOR FRAME ASSEMBLY.
  - REMOVE EXISTING DOOR AND DOOR FRAME ASSEMBLY COMPLETE. INFILL OPENING TO MATCH EXISTING.
  - REMOVE EXISTING DOOR AND DOOR FRAME ASSEMBLY COMPLETE.
  - REMOVE EXISTING WALL ASSEMBLY COMPLETE WITHIN LIMITS SHOWN.
  - REMOVE EXISTING COUNTER/CASEWORK ASSEMBLY COMPLETE. PREPARE FINISH FLOORING COMPLETE. PREPARE SUBFLOOR FOR NEW FLOOR FINISHES AS RECOMMENDED BY FLOOR MANUFACTURER. REFERENCE ROOM FINISH SCHEDULE FOR MORE INFORMATION.
  - REMOVE EXISTING TOILET PARTITION ASSEMBLY COMPLETE.
  - REMOVE EXISTING WINDOW ASSEMBLY COMPLETE.
  - REMOVE EXISTING PLUMBING FIXTURE AND ASSOCIATED PIPING COMPLETE.
  - REMOVE EXISTING SHELVING COMPLETE.
  - PREPARE/CLEAN EXISTING CMU WALL ASSEMBLY FOR NEW PAINT APPLICATIONS PER PAINT MANUFACTURER'S RECOMMENDATIONS.
  - REMOVE ALL EXISTING ACOUSTICAL CEILING TILES COMPLETE. SALVAGE TILES IN GOOD CONDITION AND HOLD FOR REINSTALLATION IN NEW CEILING LAYOUT.
  - REMOVE AND SALVAGE ALL EXISTING LIGHTING FIXTURES COMPLETE. REPAIR OR REPLACE ALL BULBS, BALLASTS, ETC. AS REQUIRED TO ENSURE PROPER FUNCTIONALITY.
  - REINSTALL FIXTURES IN NEW CEILING LAYOUT. PROVIDE MATCHING FIXTURES IF/WHERE REQUIRED.
  - REMOVE EXISTING ACOUSTICAL CEILING TILE GRID SYSTEM COMPLETE.
  - TEMPORARILY RELOCATE EXISTING FIRE EXTINGUISHER UNTIL NEW WALL FURNISH IS INSTALLED. MOUNT EXISTING FIRE EXTINGUISHER ON NEW FURNISH.