

City of Portland, Maine – Building or Use Permit Application 389 Congress Street, 04101, Tel: (207) 874-8703, FAX: 874-8716

Location of Construction: 65 Warren Ave		Owner: Jeff Ray		Phone:		Permit No 960441 PERMIT ISSUED Permit Issued: MAY 22 1996 CITY OF PORTLAND Zone: EB CBL: 292-D-014 Zoning Approval: <i>OK - 5/21/96</i> Special Zone or Reviews: <input type="checkbox"/> Shoreland <input type="checkbox"/> Wetland <input type="checkbox"/> Flood Zone <input type="checkbox"/> Subdivision <input type="checkbox"/> Site Plan maj <input type="checkbox"/> minor <input type="checkbox"/> mm <input type="checkbox"/>		
Owner Address:		Leasee/Buyer's Name: Lifestyle Fitness Center		Phone:			BusinessName:	
Contractor Name: Sign Solutions		Address: 75 Bishop St Ptld, ME 04103		Phone: XXXXXX 878-8000			COST OF WORK: \$ PERMIT FEE: \$ 44.40 FIRE DEPT. <input type="checkbox"/> Approved <input type="checkbox"/> Denied INSPECTION: Use Group: Type: Signature: <i>[Signature]</i> Signature: <i>[Signature]</i>	
Past Use: Fitness Center		Proposed Use: Same w/signage		PEDESTRIAN ACTIVITIES DISTRICT (P.A.D.) Action: Approved <input type="checkbox"/> Approved with Conditions: <input type="checkbox"/> Denied: <input type="checkbox"/> Signature: Date:			Proposed Project Description: Erect Signage (97 sq ft) UL# E167560	
Permit Taken By: Mary Gresik		Date Applied For: 17 May 1996						

1. This permit application doesn't preclude the Applicant(s) from meeting applicable State and Federal rules.
2. Building permits do not include plumbing, septic or electrical work.
3. Building permits are void if work is not started within six (6) months of the date of issuance. False information may invalidate a building permit and stop all work..

CERTIFICATION

I hereby certify that I am the owner of record of the named property, or that the proposed work is authorized by the owner of record and that I have been authorized by the owner to make this application as his authorized agent and I agree to conform to all applicable laws of this jurisdiction. In addition, if a permit for work described in the application issued, I certify that the code official's authorized representative shall have the authority to enter all areas covered by such permit at any reasonable hour to enforce the provisions of the code(s) applicable to such permit

SIGNATURE OF APPLICANT: *Kyle Noyes* ADDRESS: _____ DATE: 17 May 1996 PHONE: _____
 RESPONSIBLE PERSON IN CHARGE OF WORK, TITLE: _____ PHONE: _____

White-Permit Desk Green-Assessor's Canary-D.P.W. Pink-Public File Ivory Card-Inspector

Historic Preservation
 Not in District or Landmark
 Does Not Require Review
 Requires Review
Action:
 Approved
 Approved with Conditions
 Denied
 Date: *5/20/96*
D. Andrews
CEO DISTRICT 7
D. Jordan

City of Portland, Maine – Building or Use Permit Application 389 Congress Street, 04101, Tel: (207) 874-8703, FAX: 874-8716

Location of Construction: 65 Warren Ave		Owner: Jeff Ray		Phone:		Permit No: 960441	
Owner Address:		Leasee/Buyer's Name: Lifestyle Fitness Center		Phone:		Business Name:	
Contractor Name: Sign Solutions		Address: 75 Bishop St Portland, ME 04103		Phone: 875-8000		Permit Issued: MAY 22 1996 3	
Past Use: Fitness Center		Proposed Use: Same w/signage		COST OF WORK: \$		PERMIT FEE: \$ 44.40	
Proposed Project Description: Erect Signage (97 sq ft) UL# E167560				FIRE DEPT. <input type="checkbox"/> Approved <input type="checkbox"/> Denied		INSPECTION: Use Group: Type:	
				Signature:		Signature:	
Permit Taken By: Mary Cresik				Date Applied For: 17 May 1996			

PERMIT ISSUED
MAY 22 1996 3
CITY OF PORTLAND

Zone: CBL: 292-D-014
Zoning Approval:
Special Zone or Reviews:
 Shoreland
 Wetland
 Flood Zone
 Subdivision
 Site Plan maj minor mm

Zoning Appeal
 Variance
 Miscellaneous
 Conditional Use
 Interpretation
 Approved
 Denied

Historic Preservation
 Not in District or Landmark
 Does Not Require Review
 Requires Review

Action:
 Approved
 Approved with Conditions
 Denied
Date: 5/20/96
D. Andrews

1. This permit application doesn't preclude the Applicant(s) from meeting applicable State and Federal rules.
2. Building permits do not include plumbing, septic or electrical work.
3. Building permits are void if work is not started within six (6) months of the date of issuance. False information may invalidate a building permit and stop all work..

CERTIFICATION

I hereby certify that I am the owner of record of the named property, or that the proposed work is authorized by the owner of record and that I have been authorized by the owner to make this application as his authorized agent and I agree to conform to all applicable laws of this jurisdiction. In addition, if a permit for work described in the application issued, I certify that the code official's authorized representative shall have the authority to enter all areas covered by such permit at any reasonable hour to enforce the provisions of the code(s) applicable to such permit

SIGNATURE OF APPLICANT: *Kyle Noyes* ADDRESS: DATE: 17 May 1996 PHONE:

RESPONSIBLE PERSON IN CHARGE OF WORK, TITLE PHONE:

White-Permit Desk Green-Assessor's Canary-D.P.W. Pink-Public File Ivory Card-Inspector

CEO DISTRICT

COMMENTS

5-23-96 No Signage yet / 5-29-96 no. Sign yet / 6-3-96 no sign yet.
6-19-95 - Signage is up OK per plans & PA. / Close

Inspection Record

Type	Date
Foundation: _____	_____
Framing: _____	_____
Plumbing: _____	_____
Final: _____	_____
Other: _____	_____

ELECTRICAL PERMIT

City of Portland, Me.

6/24/96



To the Chief Electrical Inspector, Portland Maine:
 The undersigned hereby applies for a permit to make electrical installations
 in accordance with the laws of Maine, the City of Portland Electrical Ordinance,
 National Electrical code and the following specification:

Date 19 June 1996

LOCATION: 65 Warren Ave

Permit # 13851

OWNER Bently Holdings Inc. ADDRESS LifeStyle Fitness

							TOTAL EACH FEE		
OUTLETS									
		Receptacles		Switches		Smoke Detector		.20	
FIXTURES		(number of)							
		incandescent		fluorescent				.20	
		fluorescent strip						.20	
SERVICES									
		Overhead			TTL AMPSTO	800		15.00	
		Underground				800		15.00	
TEMPORARY SERV.									
		Overhead			AMPS OVER	800		25.00	
		Underground				800		25.00	
METERS		(number of)						1.00	
MOTORS		(number of)						2.00	
RESID/COM		Electric units						1.00	
HEATING		oil/gas units						5.00	
APPLIANCES		Ranges		Cook Tops		Wall Ovens		2.00	
		Water heaters		Fans		Dryers		2.00	
Disposals		Dishwasher		Compactors		Others (denote)		2.00	
MISC. (number of)		Air Cond/win						3.00	
		Air Cond/cent						10.00	
		Signs					2	5.00	
		Pools						10.00	
		Alarms/res						5.00	
		Alarms/com						15.00	
		Heavy Duty						2.00	
		Outlets							
		Circus/Carnv						25.00	
		Alterations						5.00	
		Fire Repairs						15.00	
		E Lights						1.00	
		E Generators						20.00	
TRANSFORMER		Panels						4.00	
		0-25 Kva						5.00	
		25-200 Kva						8.00	
		Over 200 Kva						10.00	
							TOTAL AMOUNT DUE		
							MINIMUM FEE/COMMERCIAL 35.00	MINIMUM FEE 25.00	25.00

INSPECTION: Will be ready Ready 6/24 or will call _____

CONTRACTORS NAME The Electrician Theodore Hassapelis
 ADDRESS 1231 Forest Ave
 TELEPHONE 878-0006
 MASTER LICENSE No. 13851
 LIMITED LICENSE No. _____

SIGNATURE OF CONTRACTOR

UL

90 DAY FEES

DEPT. OF BUILDING INSPECTION
CITY OF PORTLAND, ME

15'-7"

3'-0"

Lifestyle

5'-4"

17 59/64 FT.

15"

FITNESS CENTER

0'-8 1/2"

15'-2"

* lifestyle on Raceway

65 Warren Ave. Portland Owner Jeff Ray
Primary Frontage 16' x 110'



DATE: 5/18/95	SCALE: 1/8" = 1'-0"
DWG NO: 1	DESIGNER: Steve Emma
CLIENT: Lifestyle Fitness Center	
LOCATION: Warren Ave. Portland, ME	

REVISION:
2

APPROVED:

© Copyright 1996

- 1 - Set of Channel Neon Letters w/ Illuminated Cabinet
- Faces: Black, Dk. Green & Ivory
- Cans: Black
- Materials: ~~36" Channel Neon Letters~~
- 36" Channel Neon Letters
- Ballasts & Misc. Electrical Parts
- Internally Illuminated Cabinet ~~with neon~~

DEPT. OF BUILDING INSPECTION
CITY OF PORTLAND, ME
MAY 17 1996
RECEIVED

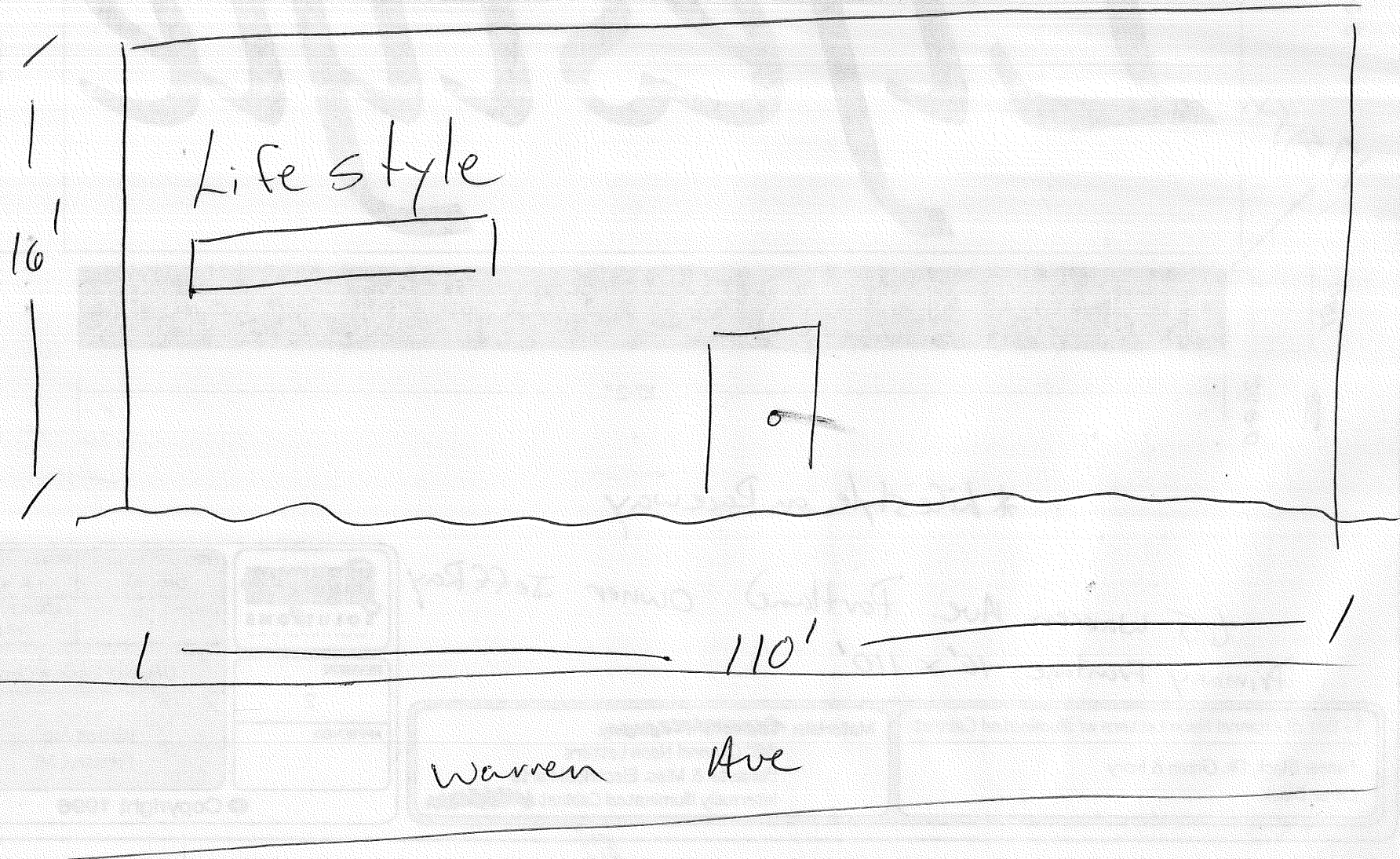

INFORMATION REQUIREMENTS FOR SIGN PERMIT APPLICATION

APPLICANTS FOR A SIGN PERMIT WILL BE ASKED TO SUBMIT THE FOLLOWING INFORMATION TO THE CODE ENFORCEMENT OFFICE:

1. PROOF OF INSURANCE
2. LETTER OF PERMISSION FROM THE OWNER
3. A SKETCH PLAN OF THE LOT, INDICATING LOCATION OF BUILDINGS, DRIVEWAYS AND ANY ABUTTING STREETS OR RIGHT OF WAYS. LENGTHS OF BUILDING FRONTAGES AND STREET FRONTAGES SHOULD BE NOTED (SEE ATTACHED)
4. INDICATE ON THE PLAN ALL EXISTING AND PROPOSED SIGNS
5. COMPUTATION OF THE FOLLOWING:
 - A) SIGN AREA OF EACH EXISTING AND PROPOSED BUILDING SIGN
 - B) SIGN AREA HEIGHT AND SETBACK OF EACH EXISTING AND PROPOSED FREESTANDING SIGN

A SKETCH OF ANY PROPOSED SIGN(S), INDICATING DIMENSIONS, MATERIALS, SOURCE OF ILLUMINATION AND CONSTRUCTION METHOD (SEE ATTACHED)

FEE FOR PERMIT - \$25.00 PLUS \$0.20 PER SQUARE FOOT

NOTE: ONCE A SKETCH PLAN HAS BEEN FILED FOR A PROPERTY, THE CODE ENFORCEMENT OFFICE WILL KEEP A RECORD OF THE PLAN SO THAT A NEW SKETCH PLAN WILL NOT BE REQUIRED FOR LATER CHANGES TO SIGNAGE ON THE PROPERTY. IN SUCH AN INSTANCE, APPLICANTS WILL ONLY BE REQUIRED TO SUBMIT INFORMATION APPLICABLE TO THE NEW SIGNS.

